

NOTES:
 Based upon the Ordnance Survey map with permission of The Controller of Her Majesty's Stationery Office, © Crown Copyright.
 Aspect Landscape Planning Ltd, West Court, Hardwick Business Park, Noral Way, Banbury OX16 2AF.
 Licence 10004545
 Copyright reserved
 1:100 @ A1

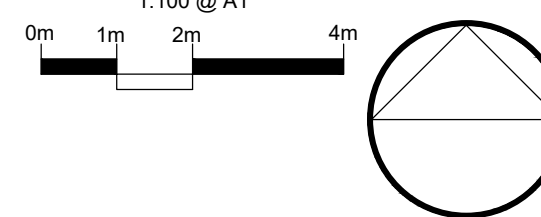

- KEY:**
- Site Boundary
 - Proposed Trees
(to be positioned 2m from highway boundary and 1m from kerb edge)
 - Proposed Native Hedge
(Caned and Rabbit guards added with 50mm bark mulch)
 - Proposed Ornamental Shrubs
(50mm Bark mulch to be included around planting)
 - Proposed Amenity Grass Seed
(Emergence EL1 Flowering Lawn Mixture. Sown at 40g/m²)
 - Broxap Lakeside Seat
Frame Finish: Cast Iron Black Powder Coated
Jet Black RAL 9005
Fixing: Set of 4 Ground Bolts into concrete pad
Timber: Hardwood -11 Treated Iroko Slats
Size: L1800 x W605 x H840mm
Code: BX 2060
 - Derby Standard Litter Bin
with self closing ashtray
Supplier: Broxap
Size: D536mm W536mm H1011mm
Finish: Galvanised steel Black Powder Coated
Jet Black RAL 9005
Fixing: Set of 4 Shield Anchor Bolts
for Installation Fixed onto concrete pad
Capacity: 120 Litres
Code: BX45G 2550
 - Proposed Wet Pour Play Surface
Rubber crumb safety surface
Edge: Aluminium edged
Colour: Yellow/Green
 - Proposed Play Area Gate
Supplier: Jacksons Fencing
Product: Anti Neck Trap Single Gate
Size: 1200mm H
Colour: Red
 - Proposed Play Area Fencing
Supplier: Jacksons Fencing
Product: Anti Neck Trap Bowtop fence
Size: 1200mm H
Colour: Black
 - Proposed Root Barrier
(ReRoot 1000 or equivalent)
 - Tar & Chip Surfacing
Located on recreational footpaths

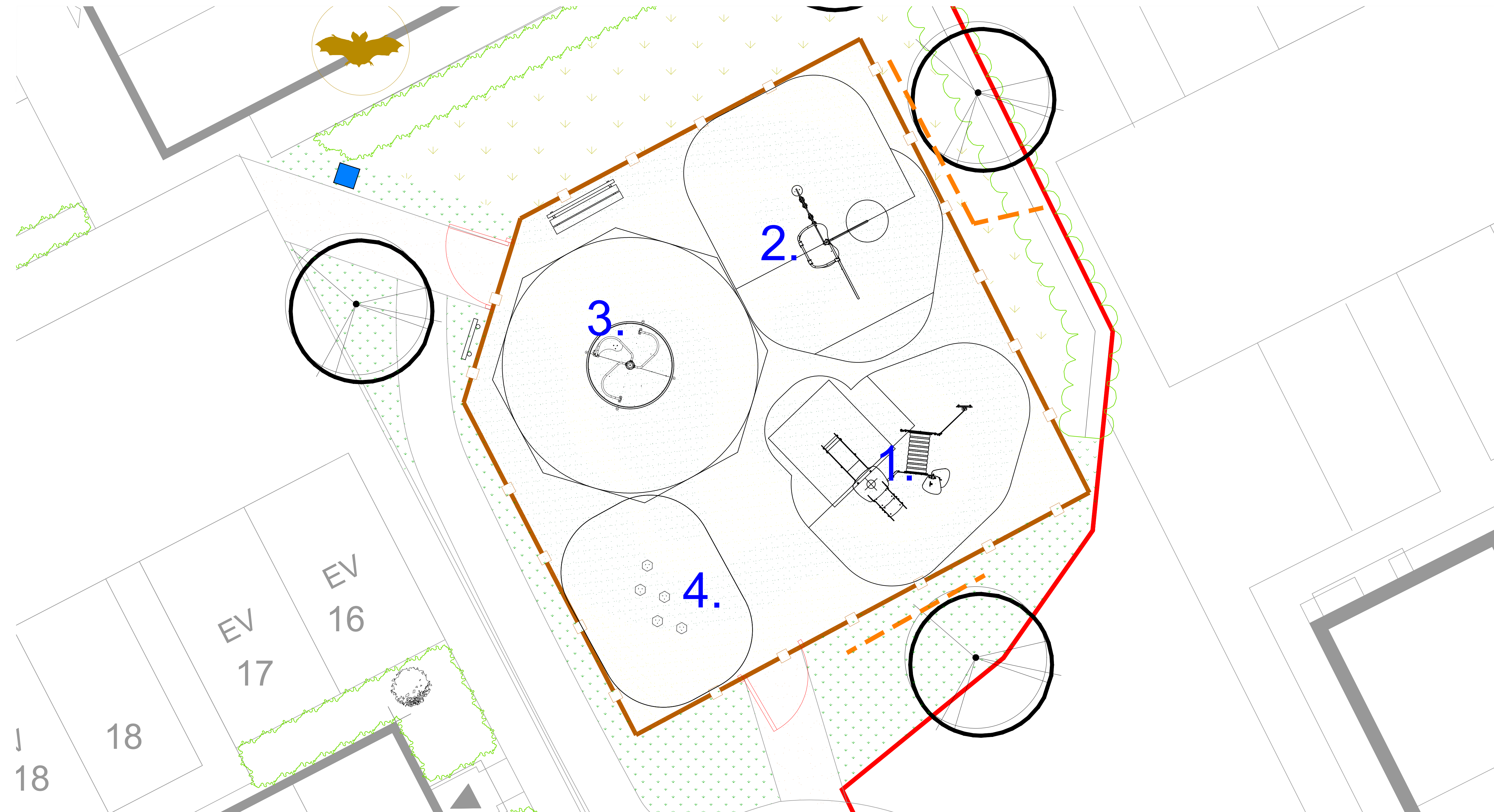

1. Product: Playhouse
 Supplier: Proludic
 Size: 3.39mW, 2.77m.D, 2.12m.H.
 Weight: 200.25kg
 Product Code: J38706



2. Product: Climbing equipment
 Supplier: Proludic
 Size: 1.68mW, 3.09m.D, 3.00m.H.
 Weight: 142.3kg
 Product Code: J410



3. Product: Roundabout
 Supplier: Proludic
 Size: 2.10mW, 2.10mD, 1.0mH.
 Weight: 304kg
 Product Code: J2409



4. Product: Steps
 Supplier: Proludic
 Size: 1.95mW, 0.70mD, 0.27mH.
 Weight: 31kg
 Product Code: J5903

NOTE: Planting plan detail see Aspect drawing 8123.PP.1.0

A	30 11 2023	Updated to GST comments	PC	PC
REV	DATE	NOTE	Drawn	Chk'd

aspect landscape planning

TITLE
 Woodside Conference Centre, Kenilworth
 Playspace Plan-LAP

CLIENT
 Vistry West Midlands

SCALE	DATE	DRAWN	CHK'D
1:50@A1	MAY 2023	PC	CW
DRAWING NUMBER	REVISION		
8123.PSD.5.0	A		