

THIS DRAWING IS TO BE READ IN CONJUNCTION WITH SEPARATE GROUP / SITE SPECIFIC CONSTRUCTION NOTES AND MATERIALS SPECIFICATION.

**DRAWING NOTES**  
 All tree and shrub locations and species must be taken into consideration by the project Structural Engineer to ensure that foundation design accords with the specifications set out in Chapter 4 of the NHBC Standards. The Landscape Contractor must ensure that plant material is planted in the locations shown and with NO SUBSTITUTIONS made without consulting the Group Landscape Design Department. It is the Landscape Contractor's responsibility to ensure that all underground services have been located and identified in advance of tree pit excavation so that no services are damaged or compromised by tree planting. Any changes to tree positions, species or specifications must be approved by the Group Landscape Design Department. Underground service strips are to be kept free of all plant material. Contractors must comply with all Health and Safety regulations and be aware of project/site specific information including referring to the information set out in the CDM drawings.

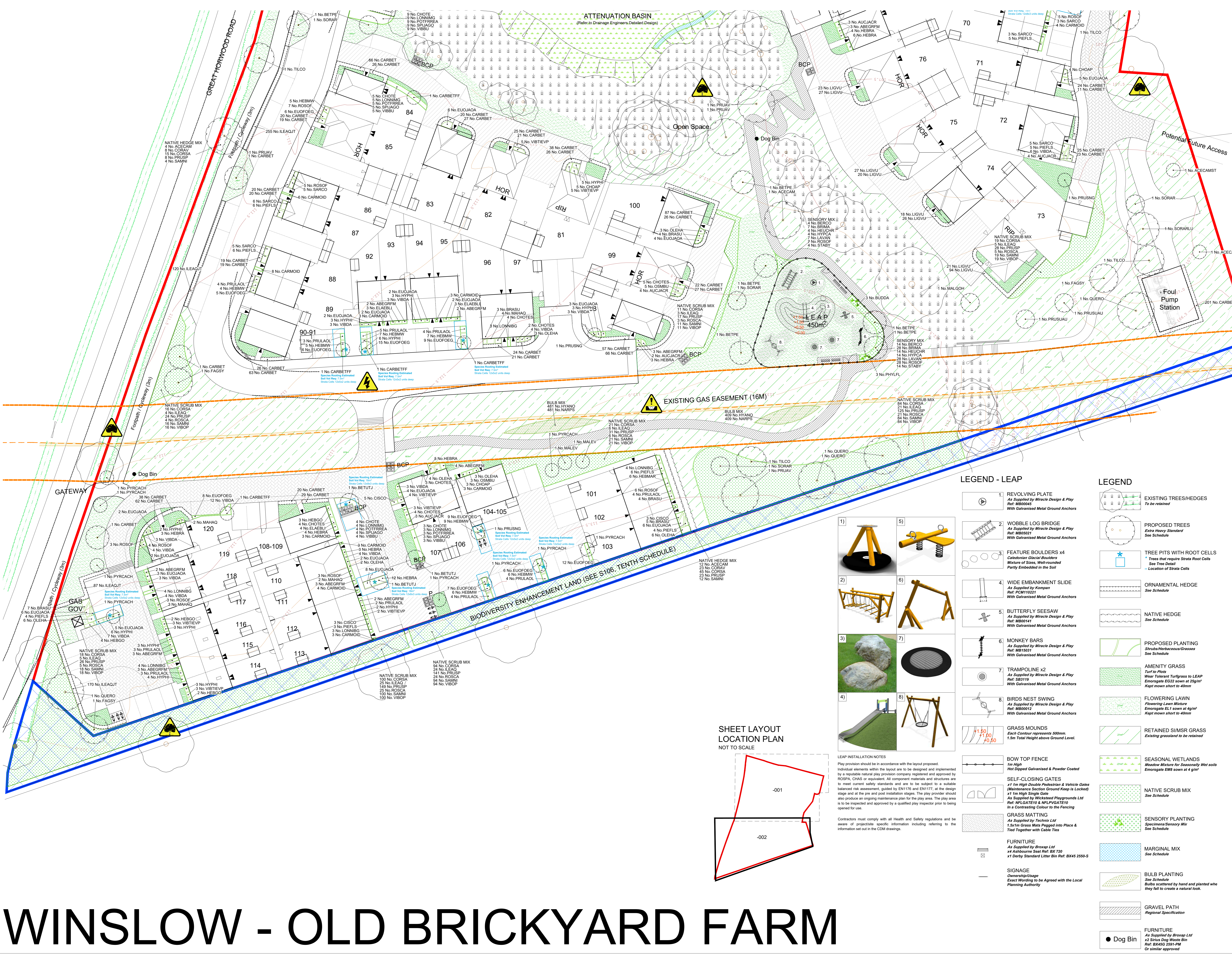

**CDM LEGEND**

	Brief description of risk
	Caution over/underground services
	Gas easement
	Trees have protection order in place, guarding required

NOTES:  
 The landscape contractor to ensure all health and safety procedures are being correctly followed in relation to all temporary works.

**PLOT NUMBER SHEET REF.**

SHEET 001 (1-70,78-80)  
 SHEET 002 (71-77,81-120)

**FOR SPECIFICATION, PLANTING DETAILS & SCHEDULE SEE DRAWING SM5145-LS-003**

Revision	Date
a	18/02/22
b	27/04/22
c	21/07/22
d	28/10/22
e	28/10/22
f	31/10/22
g	24/11/22
h	19/01/23
i	23/02/23
j	28/03/23
k	07/03/23
l	30/03/23

Job:	Winslow - Old Brickyard Farm
Title:	Site Landscaping
Scale:	1:250 @A0
Date:	Nov 2021
Drawn:	LP
Checked:	FmJ

THIS DRAWING AND THE BUILDING WORKS DEFINED ARE THE COPYRIGHT OF J.S. BLOOR (SERVICES) LIMITED. NO PART OF THIS DRAWING OR THE INFORMATION CONTAINED HEREIN IS TO BE REPRODUCED OR TRANSMITTED IN ANY FORM OR BY ANY MEANS, ELECTRONIC OR MECHANICAL, WITHOUT PERMISSION IN WRITING FROM J.S. BLOOR (SERVICES) LIMITED. MEMBERSHIP MADE BY OTHER PERSONS.

**BLOOR HOMES**

J.S. BLOOR (SERVICES) LIMITED  
 ASHBY ROAD, MEASHAM, SWALWOLNTOE, LEICESTERSHIRE DE12 7JF  
 TELEPHONE 01530 271000 FACSIMILE 01530 272006

Drawing No: **SM5145-LS-002I**

**LEGEND - LEAP**

- REVOLVING PLATE**  
As Supplied by *Miracle Design & Play* Ref: MB00045  
With Galvanised Metal Ground Anchors
- WOBBLE LOG BRIDGE**  
As Supplied by *Miracle Design & Play* Ref: MB05021  
With Galvanised Metal Ground Anchors
- FEATURE BOULDERS x4**  
Caledonian Global Boulders  
Mixture of Sizes, Well-rounded  
Partly Embedded in the Soil
- WIDE EMBANKMENT SLIDE**  
As Supplied by *Konpaan* Ref: PCM110221  
With Galvanised Metal Ground Anchors
- BUTTERFLY SEESAW**  
As Supplied by *Miracle Design & Play* Ref: MB00141  
With Galvanised Metal Ground Anchors
- MONKEY BARS**  
As Supplied by *Miracle Design & Play* Ref: MB15031  
With Galvanised Metal Ground Anchors
- TRAMPOLINE x2**  
As Supplied by *Miracle Design & Play* Ref: MB00012  
With Galvanised Metal Ground Anchors
- BIRDS NEST SWING**  
As Supplied by *Miracle Design & Play* Ref: MB00012  
With Galvanised Metal Ground Anchors
- GRASS MOUNDS**  
Each Contour represents 500mm.  
1.5m Total Height above Ground Level.
- BOW TOP FENCE**  
1m High  
Hot Dipped Galvanised & Powder Coated
- SELF-CLOSING GATES**  
x1 1m High Double Pedestrian & Vehicle Gates (Maintenance Section Ground Keep is Locked)  
x1 1m High Single Gate  
As Supplied by *Wickstead Playgrounds Ltd* Ref: NPLGATE10 & NPLPGATE10  
In a Contrasting Colour to the Fencing
- GRASS MATTING**  
As Supplied by *Technic Ltd*  
1.5x1m Grass Mats Pegged into Place & Tied Together with Cable Ties
- FURNITURE**  
As Supplied by *Bravap Ltd*  
x4 Ashbourne Seat Ref: BK 720  
x1 Derby Standard Litter Bin Ref: BK45 2550-S
- SIGNAGE**  
Ownership/Usage  
Exact Wording to be Agreed with the Local Planning Authority

**LEGEND**

- EXISTING TREES/HEDGES**  
To be retained
- PROPOSED TREES**  
Extra Heavy Standard  
See Schedule
- TREE PITS WITH ROOT CELLS**  
Trees that require Strata Root Cells  
See Tree Detail  
Location of Strata Cells
- ORNAMENTAL HEDGE**  
See Schedule
- NATIVE HEDGE**  
See Schedule
- PROPOSED PLANTING**  
Turf or Plants  
Overseeds/Perennials/Grasses  
See Schedule
- AMENITY GRASS**  
Wear Tolerant Turfgrass to LEAP  
Emergate EG22 sown at 25g/m²  
Kempt mown short to 40mm
- FLOWERING LAWN**  
Flowering Lawn Mixture  
Emergate EL1 sown at 4g/m²  
Kempt mown short to 40mm
- RETAINED SIMSR GRASS**  
Existing grassland to be retained
- SEASONAL WETLANDS**  
Meadow Mixture for Seasonally Wet soils  
Emergate EM3 sown at 4g/m²
- NATIVE SCRUB MIX**  
See Schedule
- SENSORY PLANTING**  
Specimens/Sensory Mix  
See Schedule
- MARGINAL MIX**  
See Schedule
- BULB PLANTING**  
Bulbs scattered by hand and planted where they fall to create a natural look.
- GRAVEL PATH**  
Regional Specification
- FURNITURE**  
As Supplied by *Bravap Ltd*  
x2 Status Dog Waste Bin Ref: BK45G 2591-PM  
Or similar approved
- Dog Bin**

**SHEET LAYOUT LOCATION PLAN**  
NOT TO SCALE

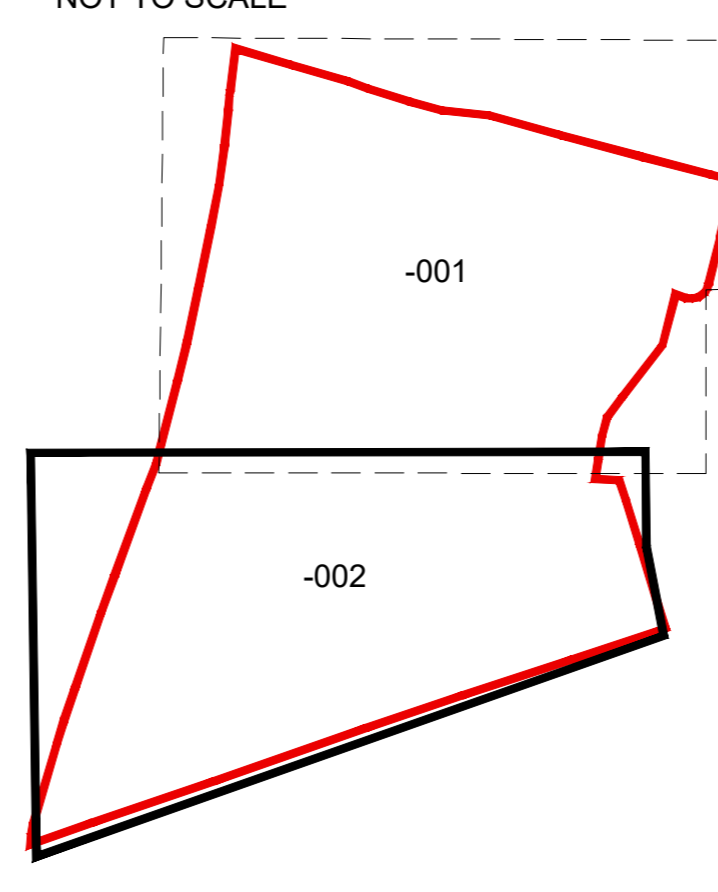

**LEAP INSTALLATION NOTES**

Play provision should be in accordance with the layout proposed. Individual elements within the layout are to be designed and implemented by a reputable natural play provision company registered and approved by ROSPA, CHAS or equivalent. All component materials and structures are to meet current safety standards and are to be subject to a suitable balanced risk assessment, guided by EN1176 and EN1177, at the design stage and at the pre and post installation stages. The play provider should also produce an ongoing maintenance plan for the play area. The play area is to be inspected and approved by a qualified play inspector prior to being opened for use.

Contractors must comply with all Health and Safety regulations and be aware of project/site specific information including referring to the information set out in the CDM drawings.

**WINSLOW - OLD BRICKYARD FARM**