

OPTIONAL  
no sub cill

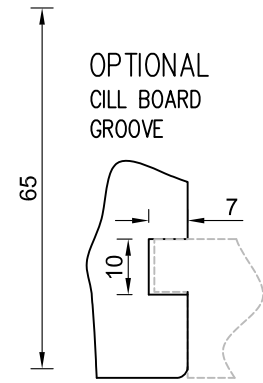
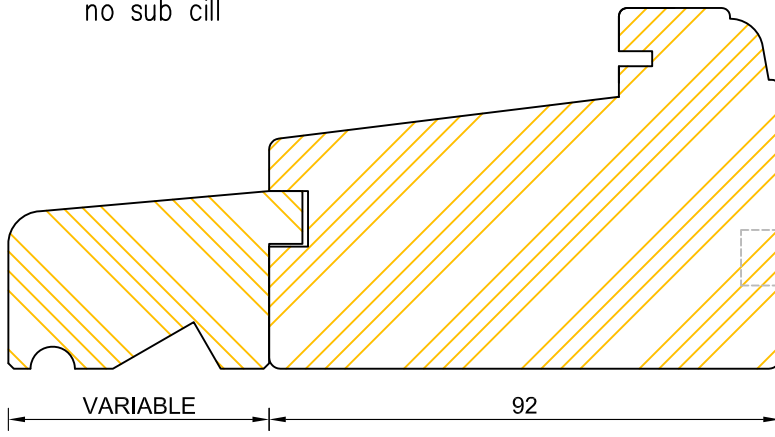

CILL EXTENSION – available options:

- |                      |                       |                       |
|----------------------|-----------------------|-----------------------|
| 25mm (117mm overall) | 87mm (179mm overall)  | 125mm (217mm overall) |
| 47mm (139mm overall) | 100mm (192mm overall) | 140mm (232mm overall) |
| 62mm (154mm overall) | 114mm (205mm overall) |                       |

STANDARD  
one piece subcill

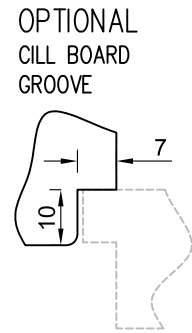
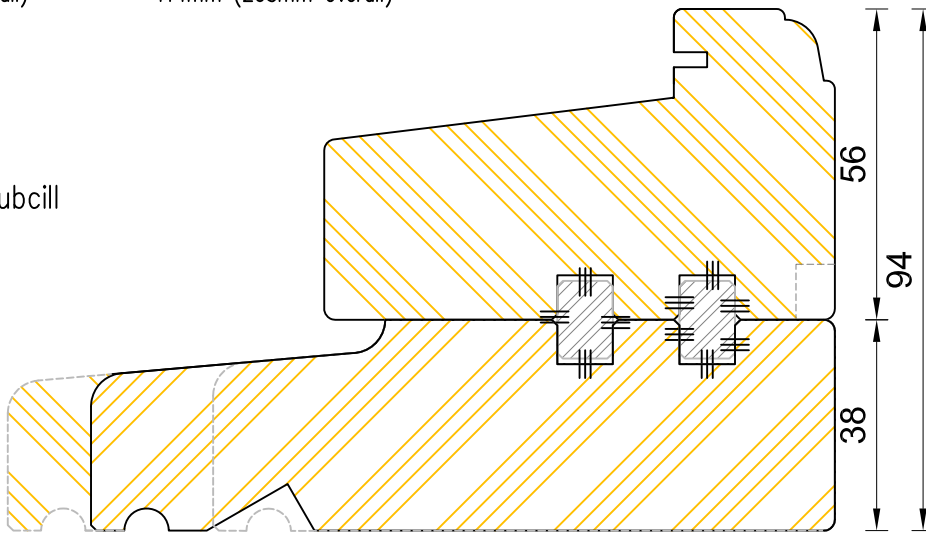

SUBCILL SIZES – 112mm / 134mm / 149mm overall

STANDARD  
subcill with cill extension

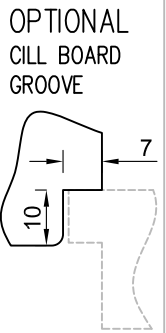
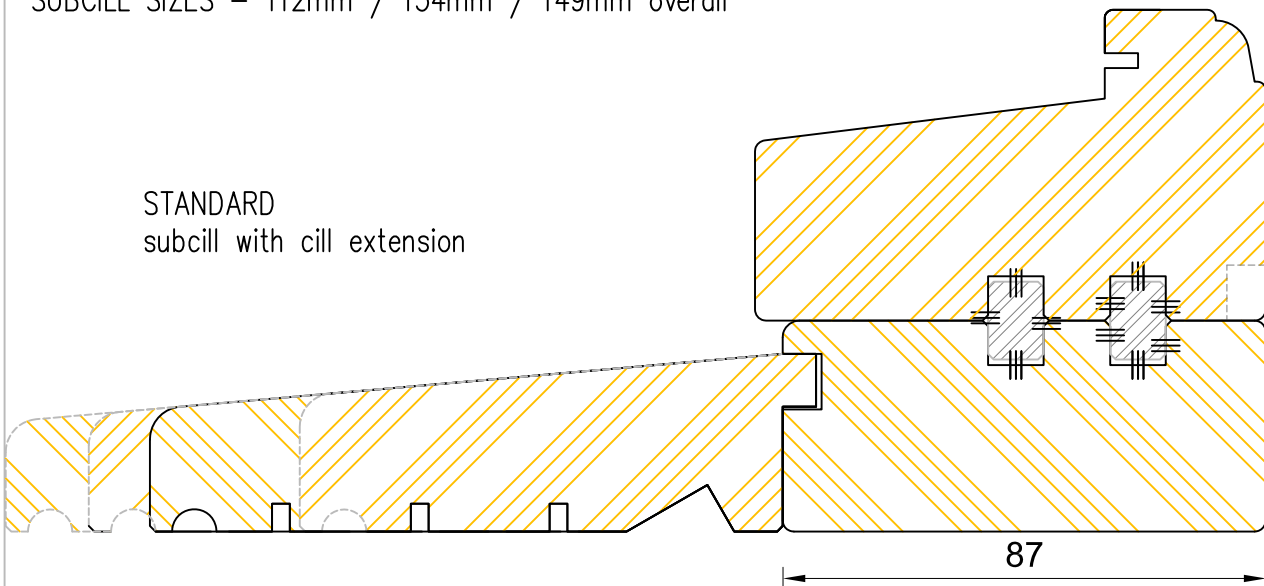

- CILL EXTENSION – available options:
- |                       |
|-----------------------|
| 87mm (174mm overall)  |
| 114mm (201mm overall) |
| 125mm (212mm overall) |
| 140mm (227mm overall) |



### Traditional Flush Casement Window Cill Options

DIMENSIONS	PLOT SIZE	SCALE	DATE	REV	DWG NO.
MM	A3	1:1	15.04.2011	A	<b>1801.1</b>
Please consider the environment before printing					

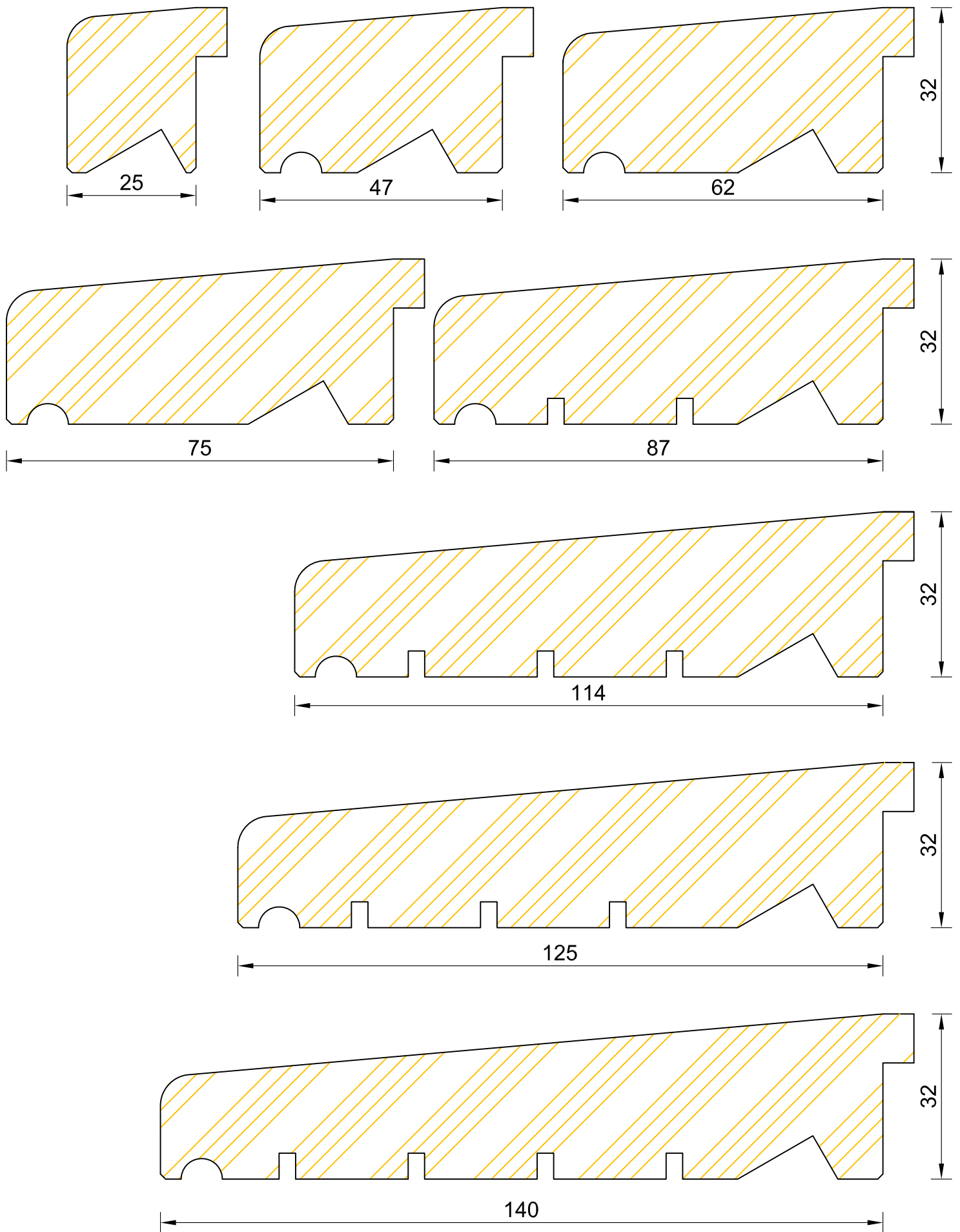

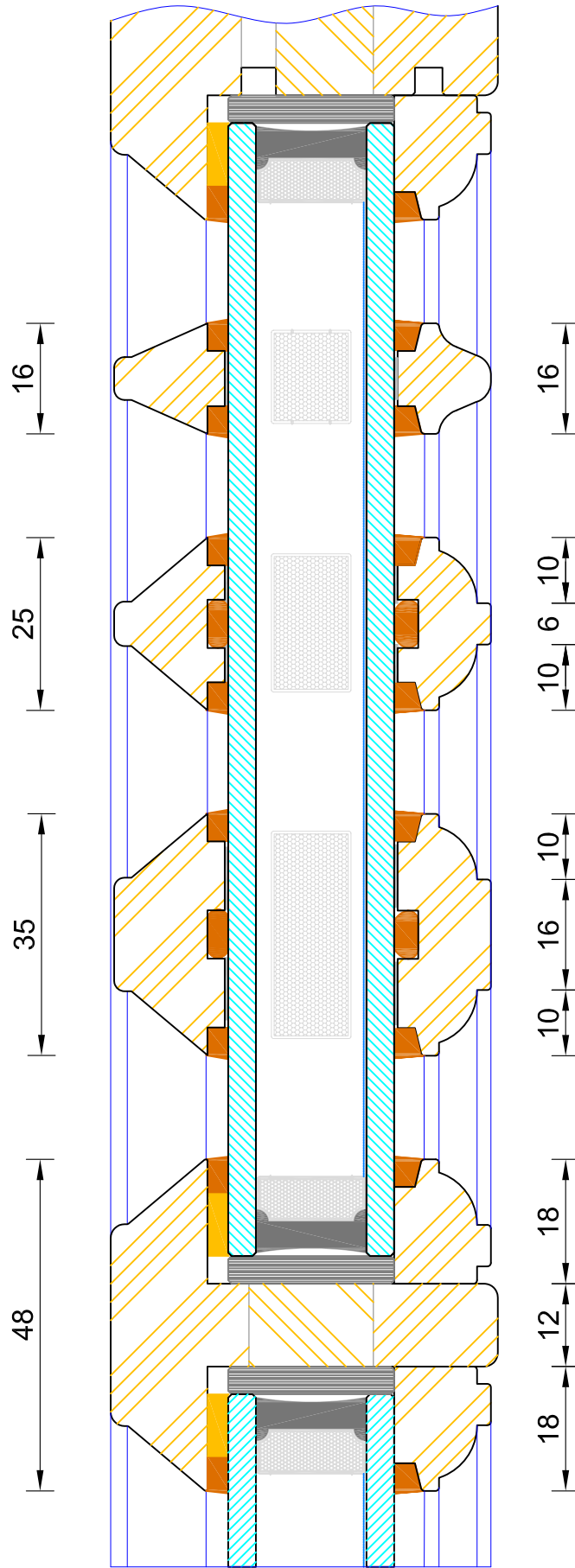

### Traditional Flush Casement Window Bar Options

DIMENSIONS	PLOT SIZE	SCALE	DATE	REV	DWG NO.
MM	A4	1:1	01.01.2019	B	<b>1802</b>
Please consider the environment before printing					

HEAD DRIP - Included only if vents are required

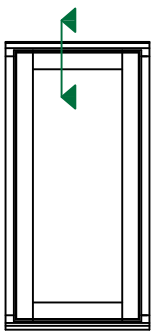
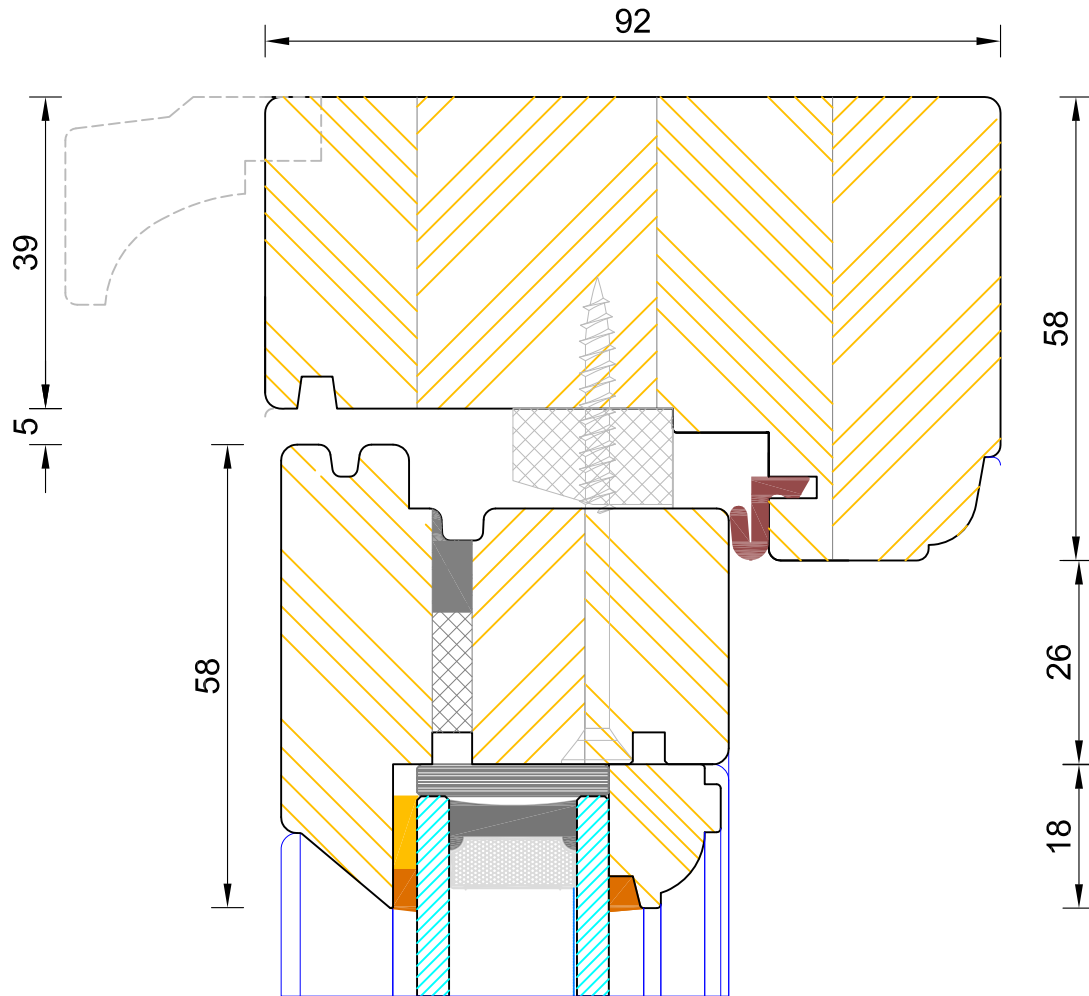

**Traditional Flush Casement Window  
Frame & Sash Head (Fixed Sash)**

DIMENSIONS	PLOT SIZE	SCALE	DATE	REV	DWG NO.
MM	A4	1:1	20.02.2018	B	<b>1803</b>
Please consider the environment before printing					

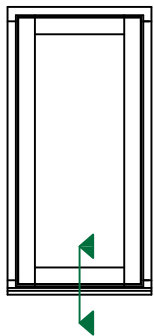
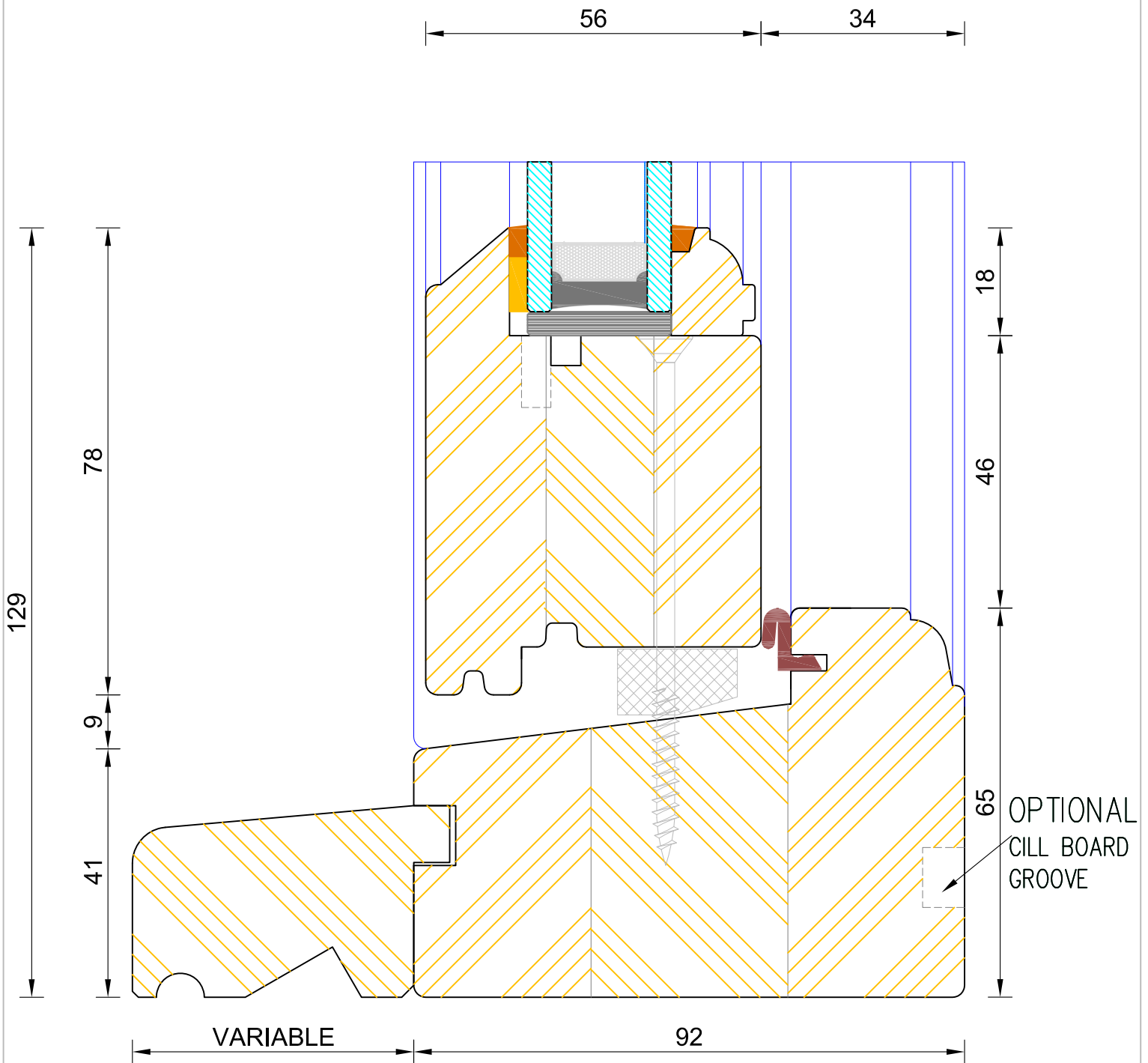

CILL EXTENSION - available options:  
 25mm (112mm o/a) / 47mm (134mm o/a) / 62mm (149mm o/a) /  
 87mm (174mm o/a) / 100mm (192mm o/a) / 114mm (201mm o/a) /  
 125mm (212mm o/a) / 140mm (227mm o/a)

**Traditional Flush Casement Window  
 Frame & Sash Cill (Fixed Sash)**

DIMENSIONS	PLOT SIZE	SCALE	DATE	REV	DWG NO.
MM	A4	1:1	15.04.2011	A	<b>1804.1</b>

Please consider the environment before printing

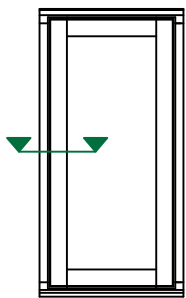
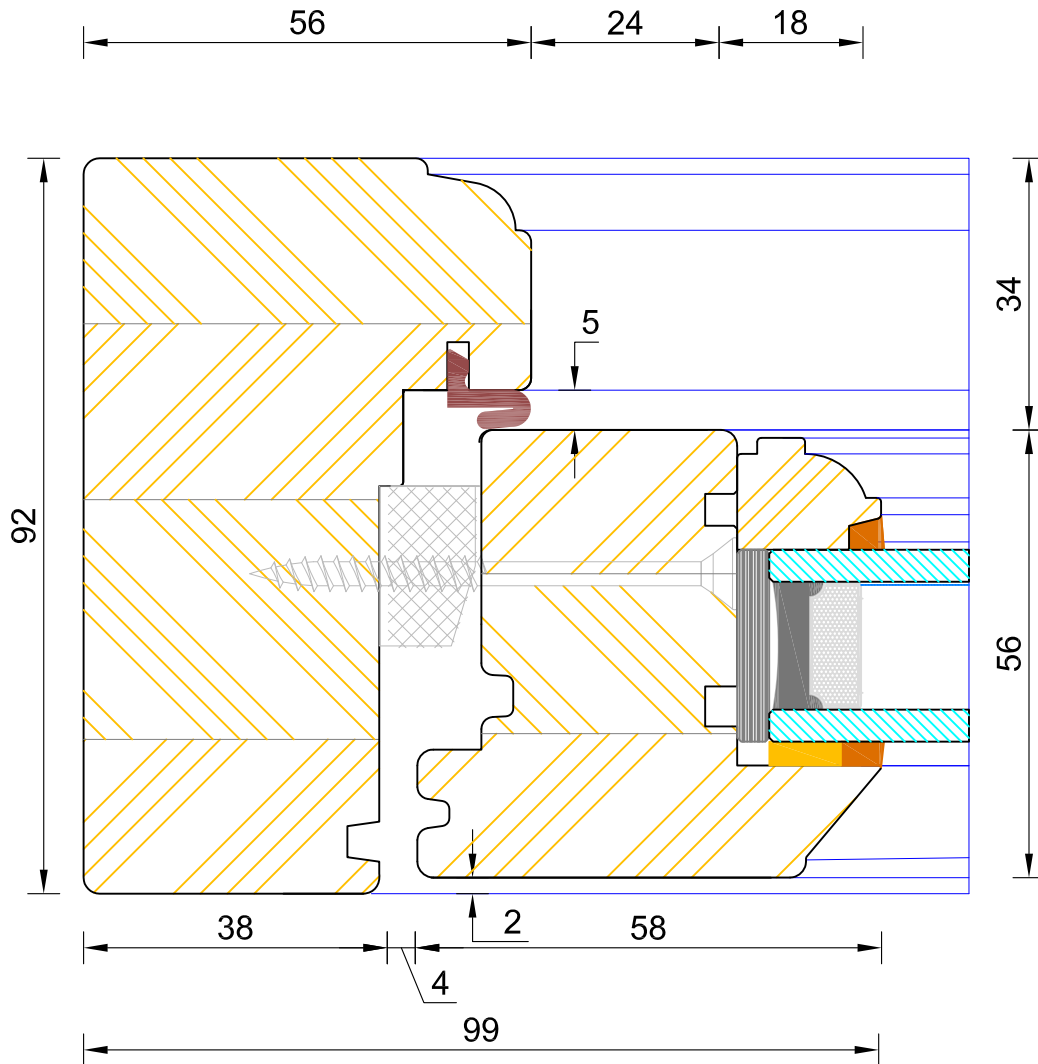

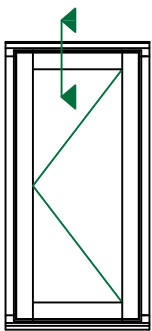
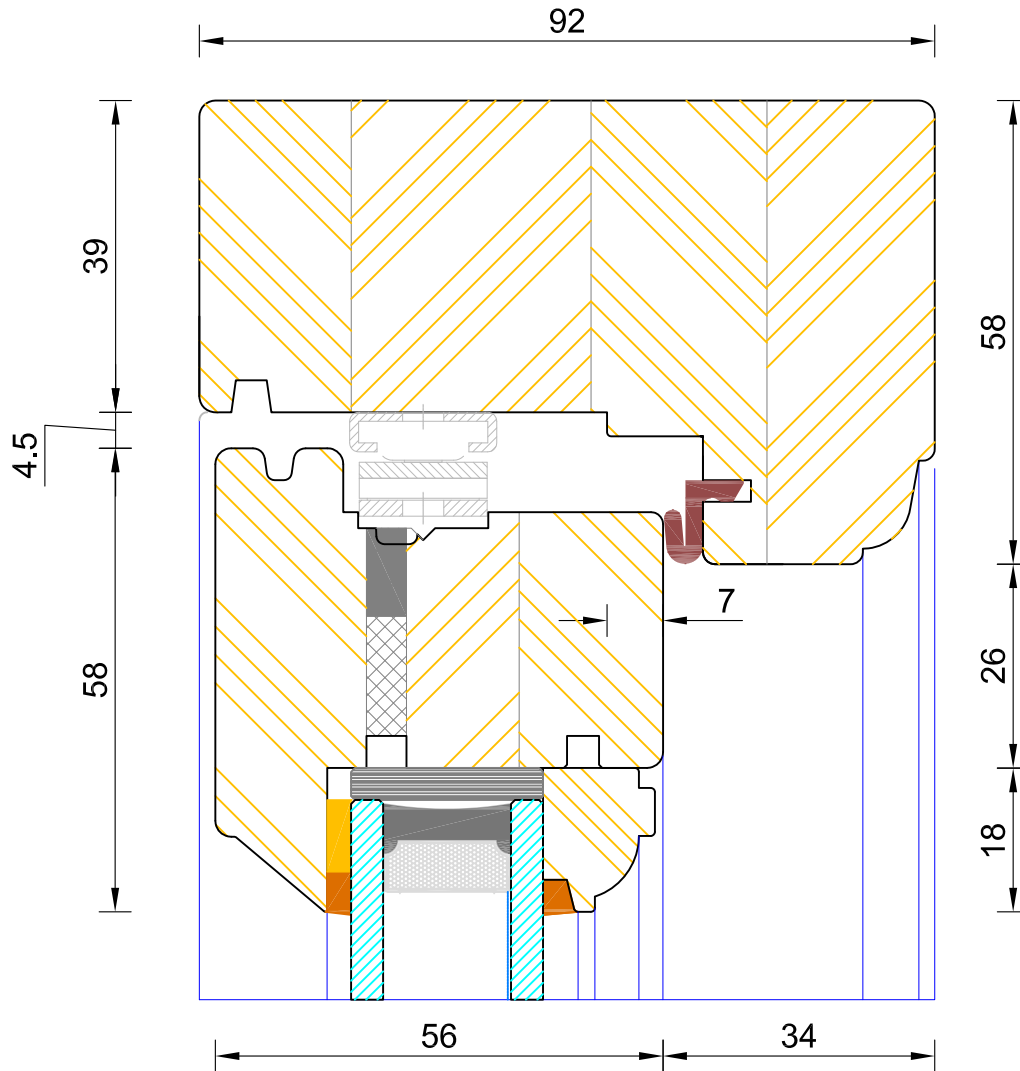

**Traditional Flush Casement Window  
Frame & Sash Head (Without Vent)**

DIMENSIONS	PLOT SIZE	SCALE	DATE	REV	DWG NO.
MM	A4	1:1	20.02.2018	A	<b>1806</b>
Please consider the environment before printing					

HEAD DRIP - Included only if vents are required

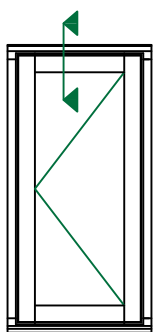
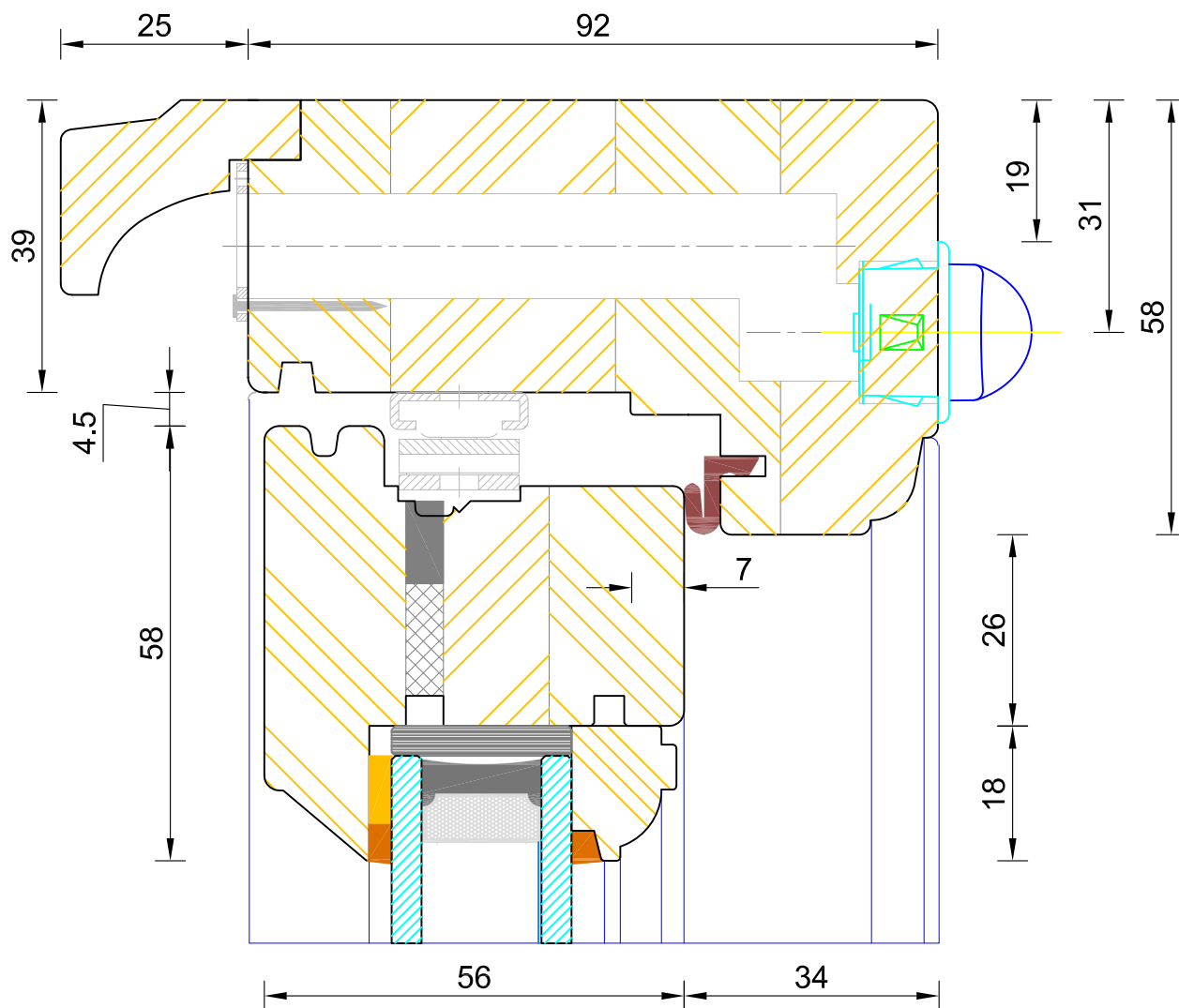

**Traditional Flush Casement Window**  
 Frame & Sash Head (Standard 58mm Head With Vent)

DIMENSIONS	PLOT SIZE	SCALE	DATE	REV	DWG NO.
MM	A4	1:1	20.02.2018	-	1806.1

Please consider the environment before printing



HEAD DRIP - Included only if vents are required

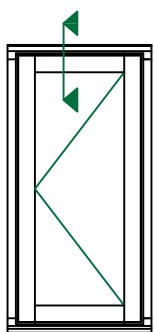
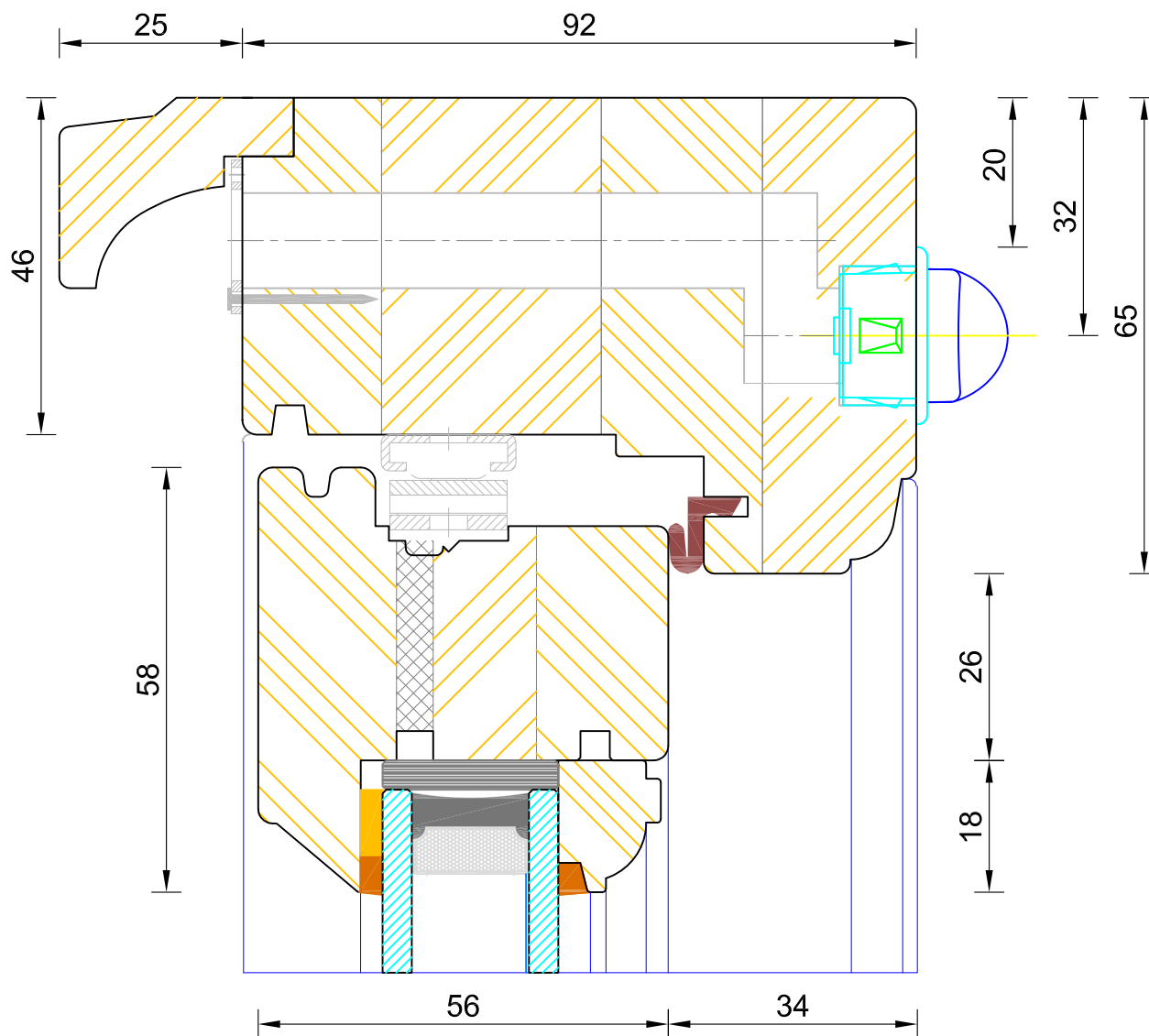

**Traditional Flush Casement Window**  
 Frame & Sash Head (Optional 65mm Head With Vent)

DIMENSIONS	PLOT SIZE	SCALE	DATE	REV	DWG NO.
MM	A4	1:1	20.02.2018	B	1806.2

Please consider the environment before printing

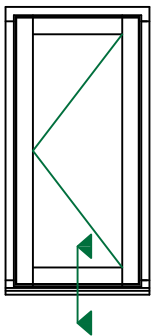
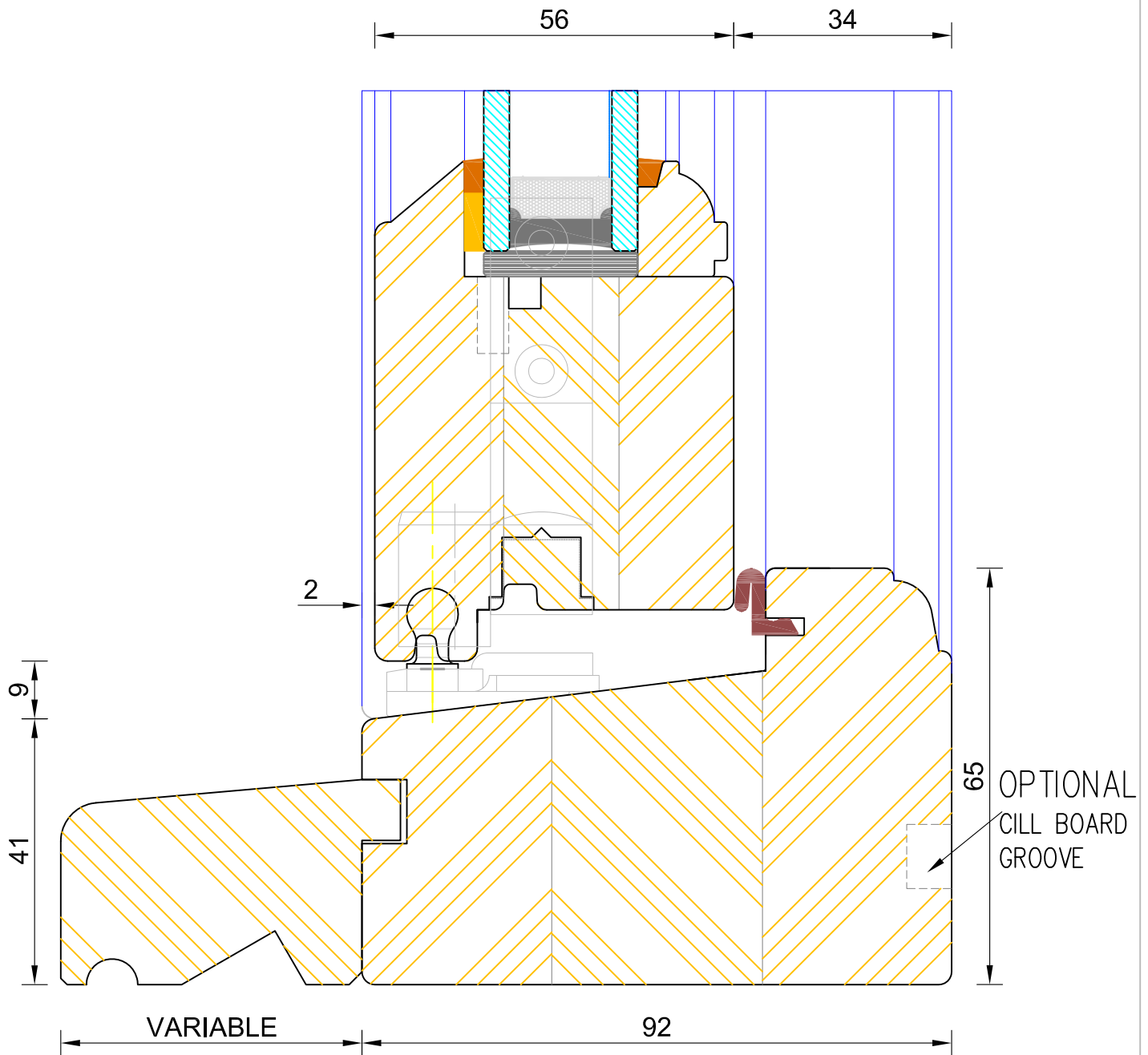

CILL EXTENSION - available options:  
 25mm (112mm o/a) / 47mm (134mm o/a) / 62mm (149mm o/a) /  
 87mm (174mm o/a) / 100mm (192mm o/a) / 114mm (201mm o/a) /  
 125mm (212mm o/a) / 140mm (227mm o/a)



### Traditional Flush Casement Window Frame & Sash Cill

DIMENSIONS	PLOT SIZE	SCALE	DATE	REV	DWG NO.
MM	A4	1:1	15.04.2011	A	<b>1807.1</b>
Please consider the environment before printing					

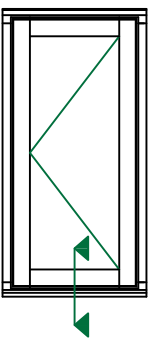
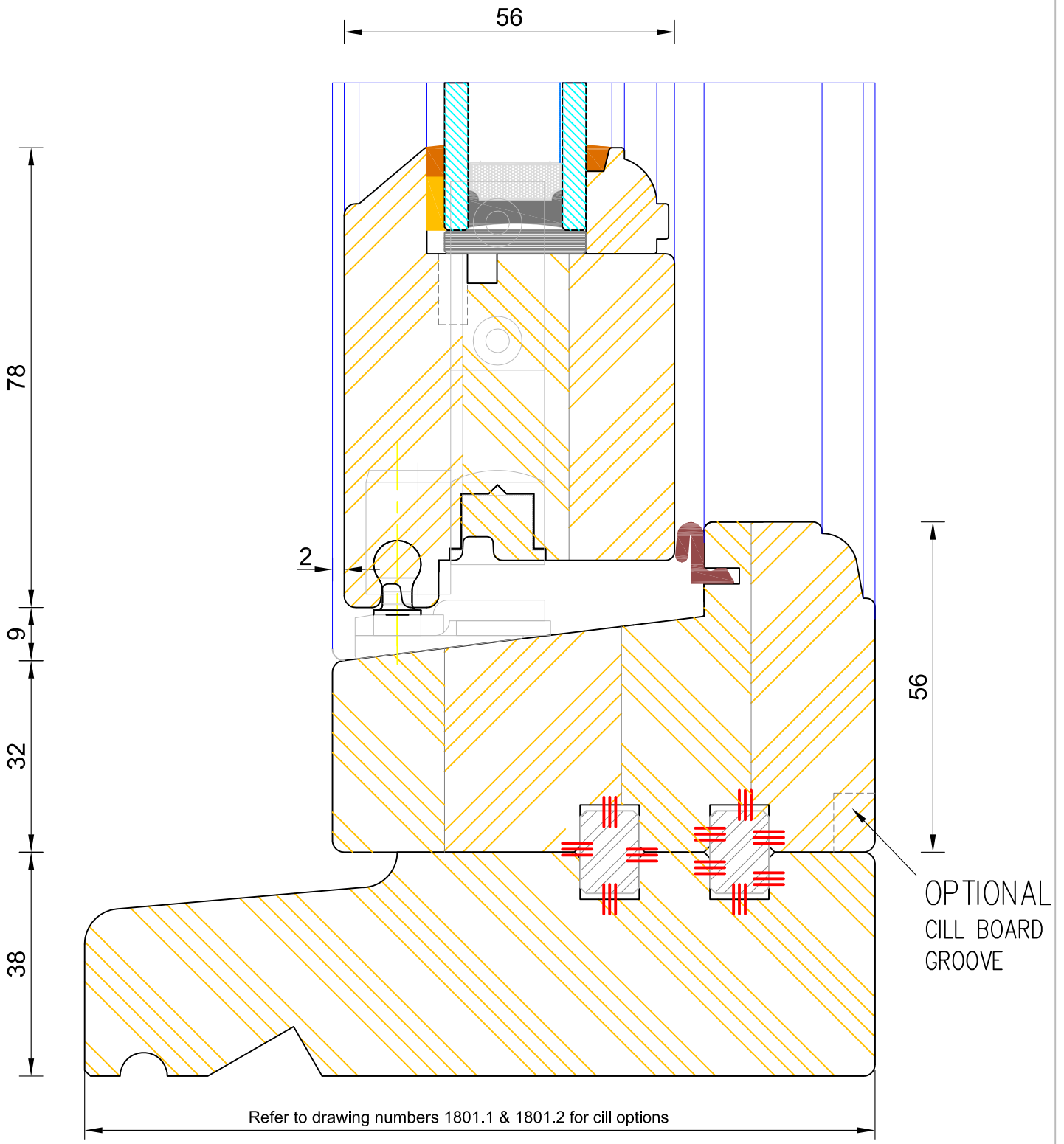

**Traditional Flush Casement Window  
Frame & Sash Cill (With Subcill)**

DIMENSIONS	PLOT SIZE	SCALE	DATE	REV	DWG NO.
MM	A4	1:1	15.04.2011	A	<b>1807</b>

Please consider the environment before printing

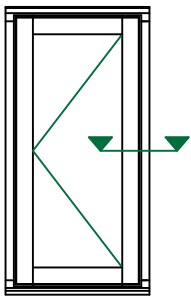
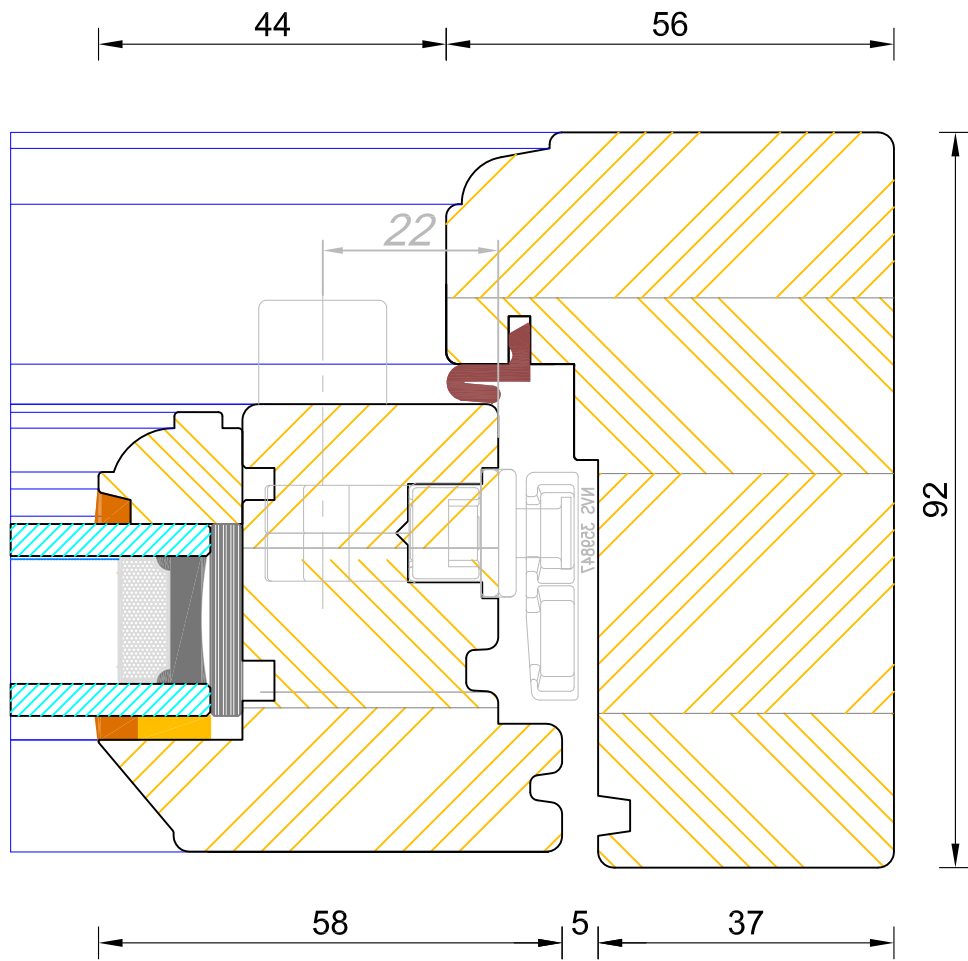

**Traditional Flush Casement Window  
Frame & Sash Jamb (handle Side)**

DIMENSIONS	PLOT SIZE	SCALE	DATE	REV	DWG NO.
MM	A4	1:1	15.04.2011	A	<b>1808</b>

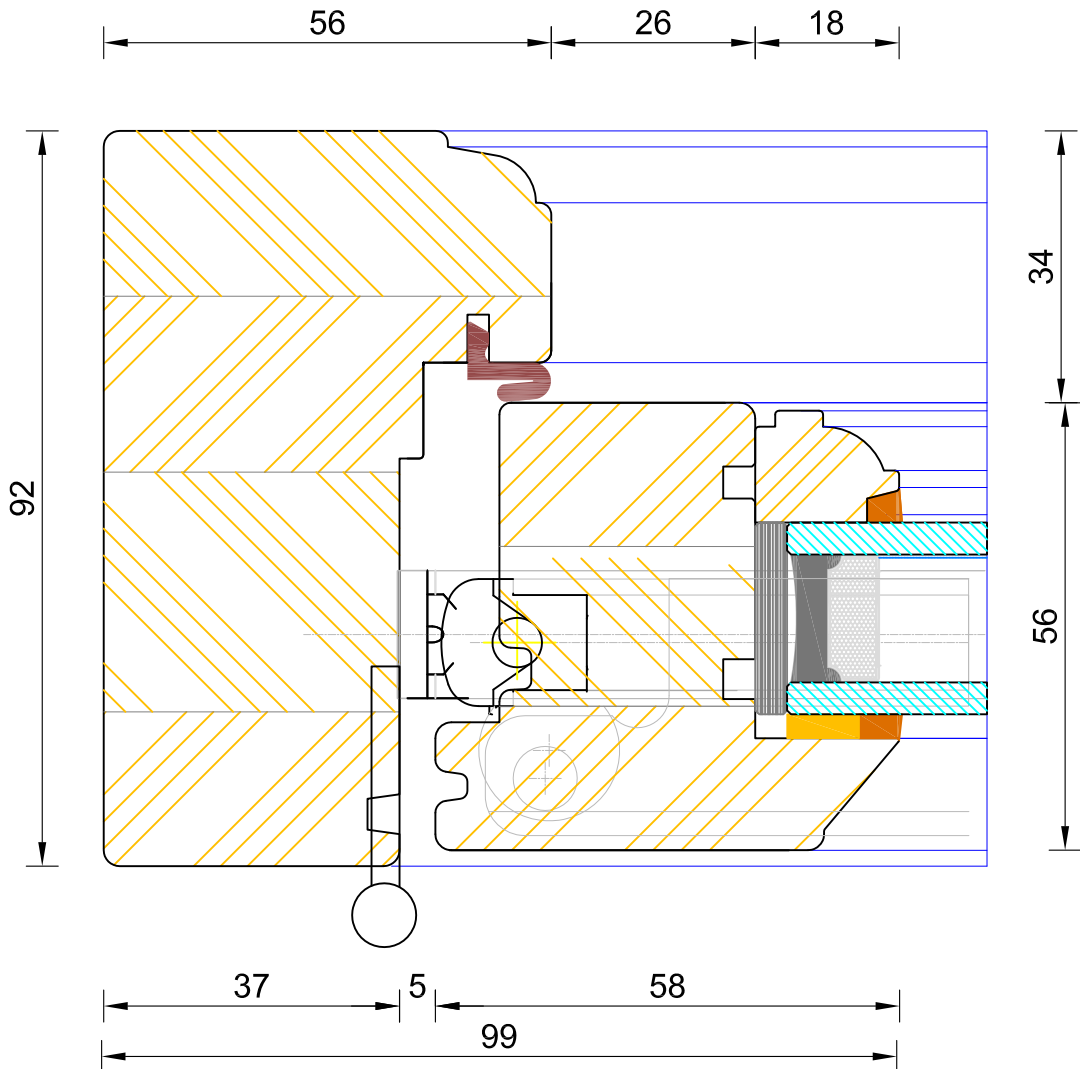

Note:  
 Jamb section shown with GU Hinge  
 Dummy Butt Hinge - Optional

Available Hinge Options  
 GU (as shown) Dummy Butt Hinge Optional  
 Easy Clean  
 Egress Easy Clean  
 Casp  
 Defender Plus

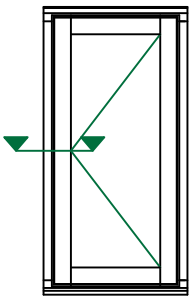

### Traditional Flush Casement Window Frame & Sash Jamb (Hinge Side)

DIMENSIONS	PLOT SIZE	SCALE	DATE	REV	DWG NO.
MM	A4	1:1	15.04.2011	A	<b>1809</b>
Please consider the environment before printing					



# Bereco

## Traditional Flush Casement Window Flying Mullion (Lead / Slave Sash )

DIMENSIONS	PLOT SIZE	SCALE	DATE	REV	DWG. NO.
MM	A1	1:1	15.04.2011	A	<b>1813.1</b>

Please consider the environment before printing

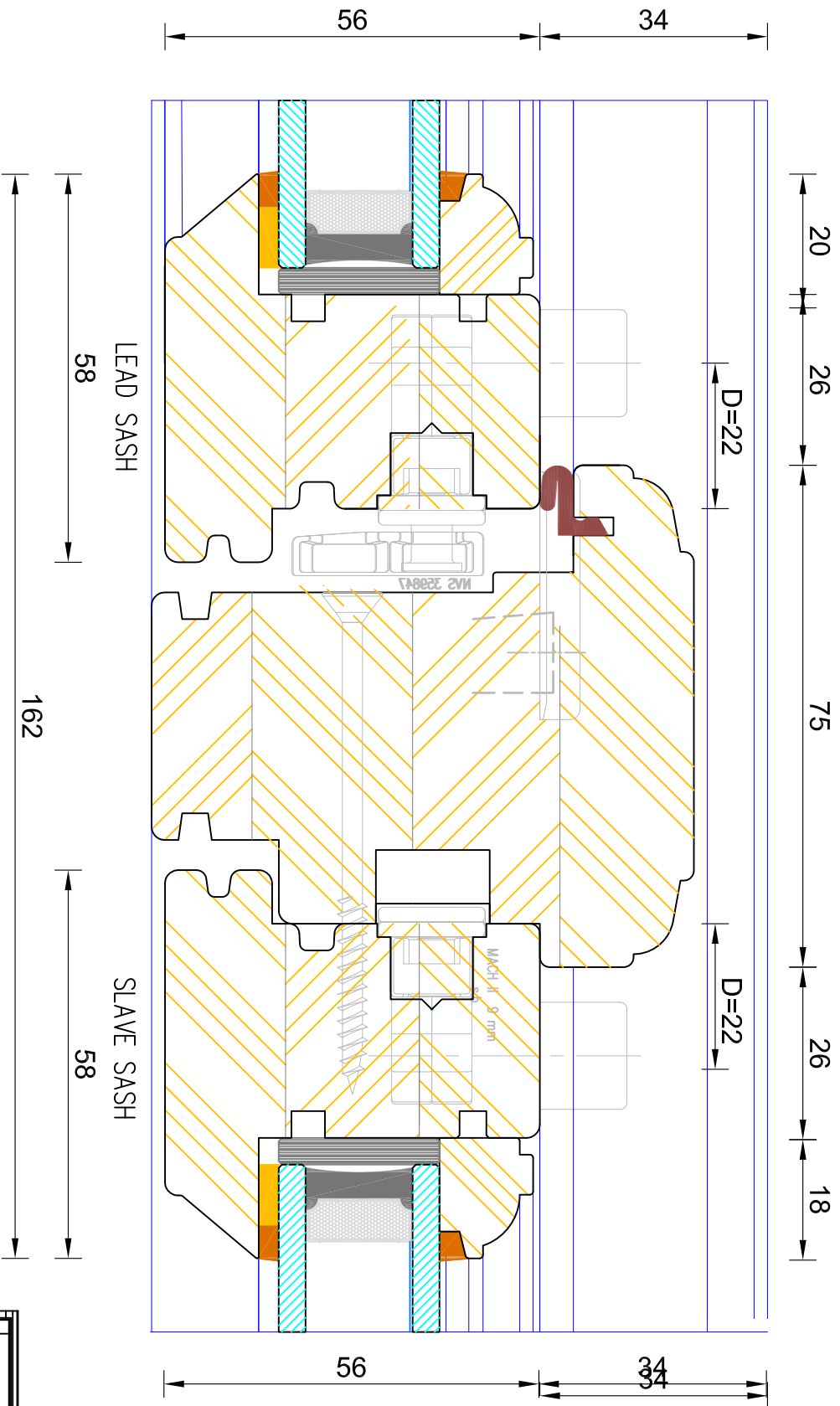
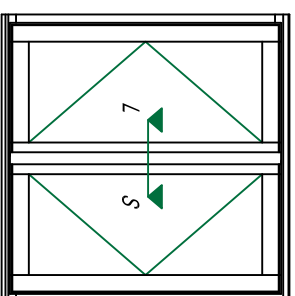



# Bereco

## Traditional Flush Casement Window Solid Mullion (Fixed Sash / Fixed Sash )

DIMENSIONS	PLOT SIZE	SCALE	DATE	REV	DWG. NO.
MM	A1	1:1	15.04.2011	A	<b>1812</b>

Please consider the environment before printing

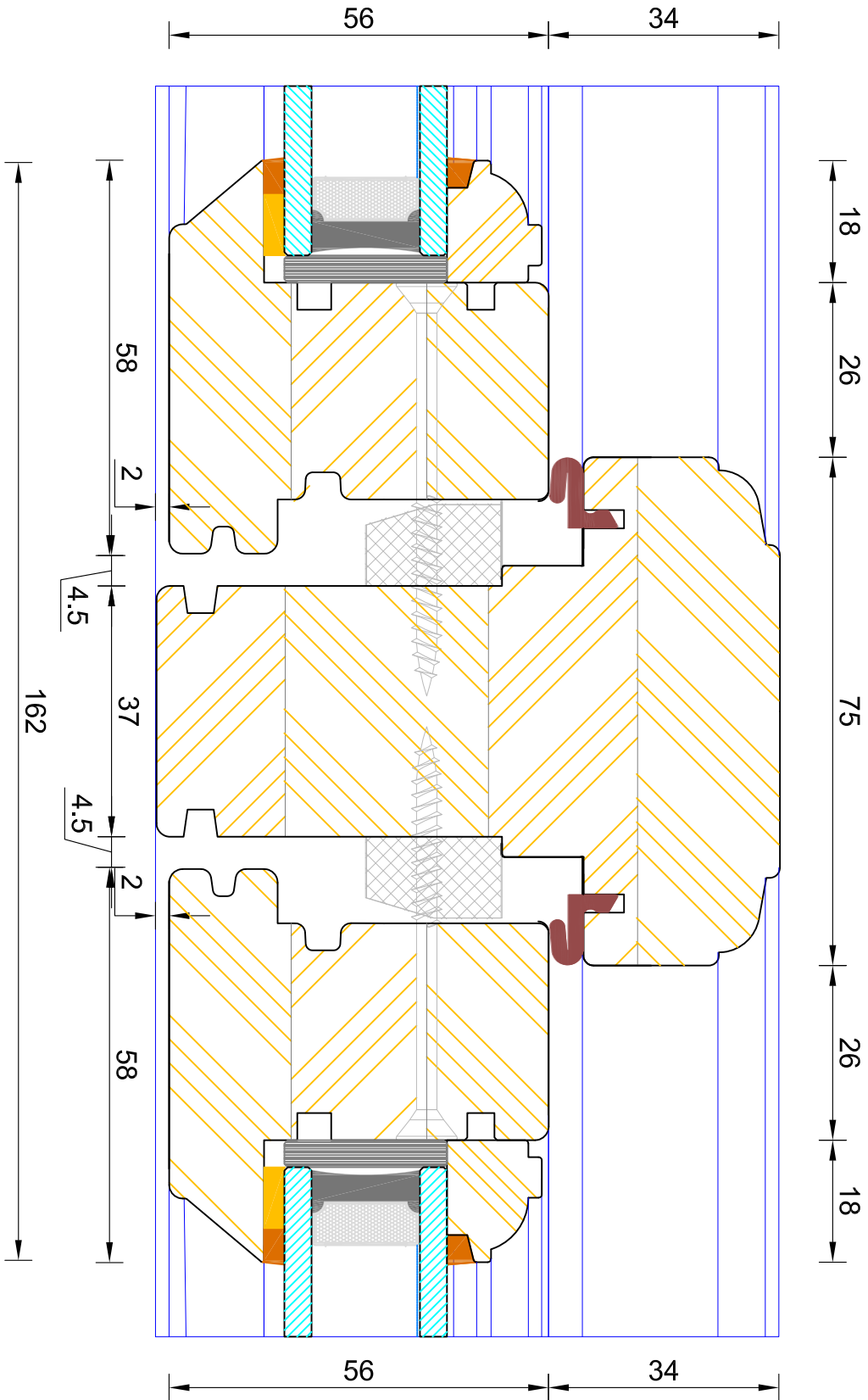
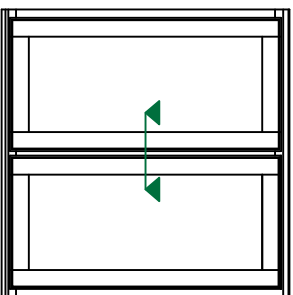



# Bereco

## Traditional Flush Casement Window Solid Mullion (Sash / Sash )

DIMENSIONS	PLOT SIZE	SCALE	DATE	REV	DWG. NO.
MM	A1	1:1	15.04.2011	A	<b>18111</b>

Please consider the environment before printing

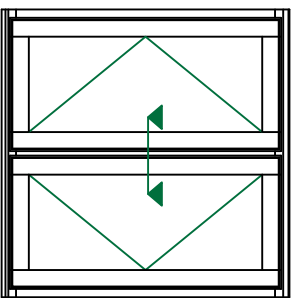
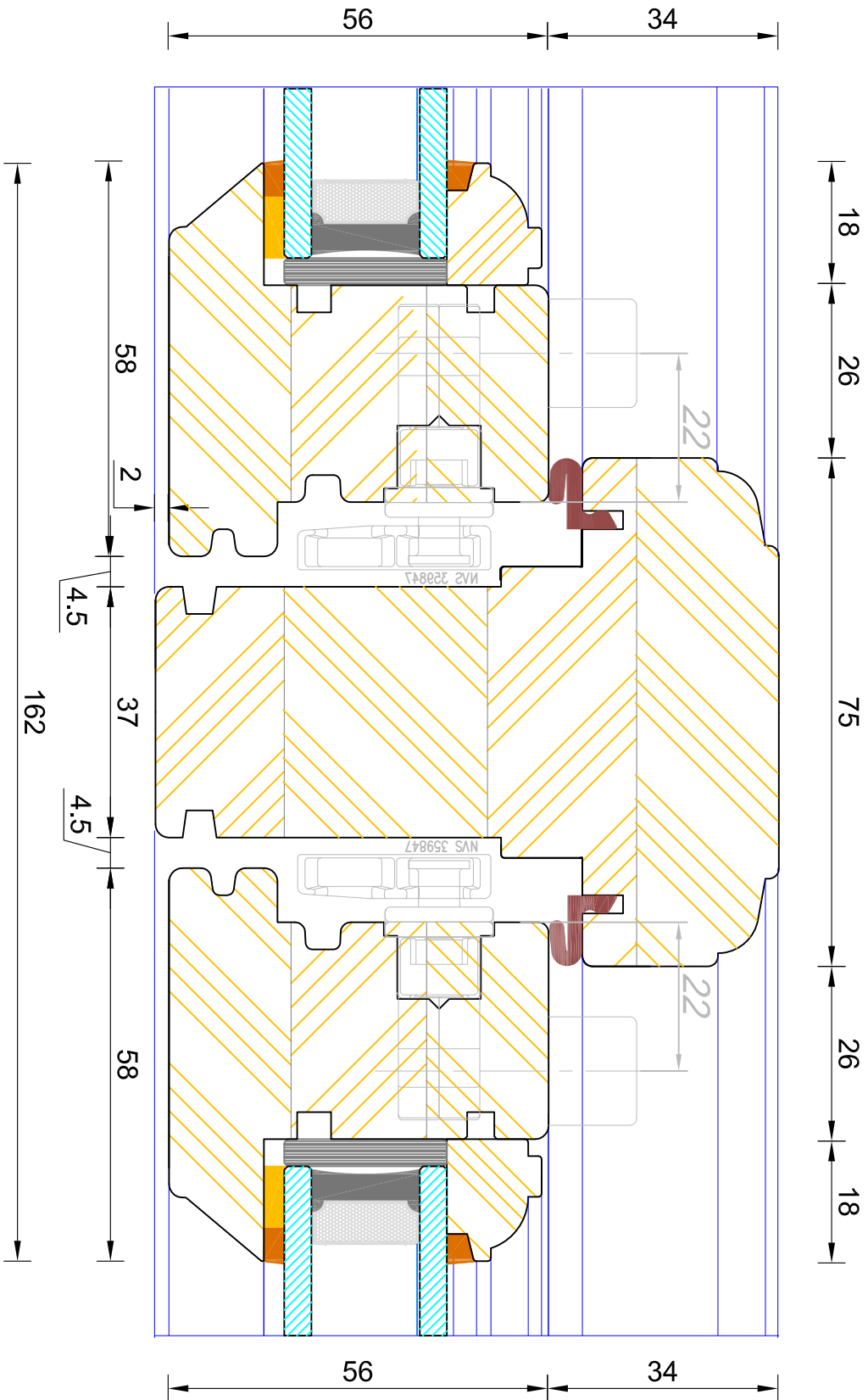





# Bereco

## Traditional Flush Casement Window Solid Mullion (Fixed Sash / Sash )

DIMENSIONS	PLOT SIZE	SCALE	DATE	REV	DWG. NO.
MM	A1	1:1	15.04.2011	A	<b>1810</b>

Please consider the environment before printing

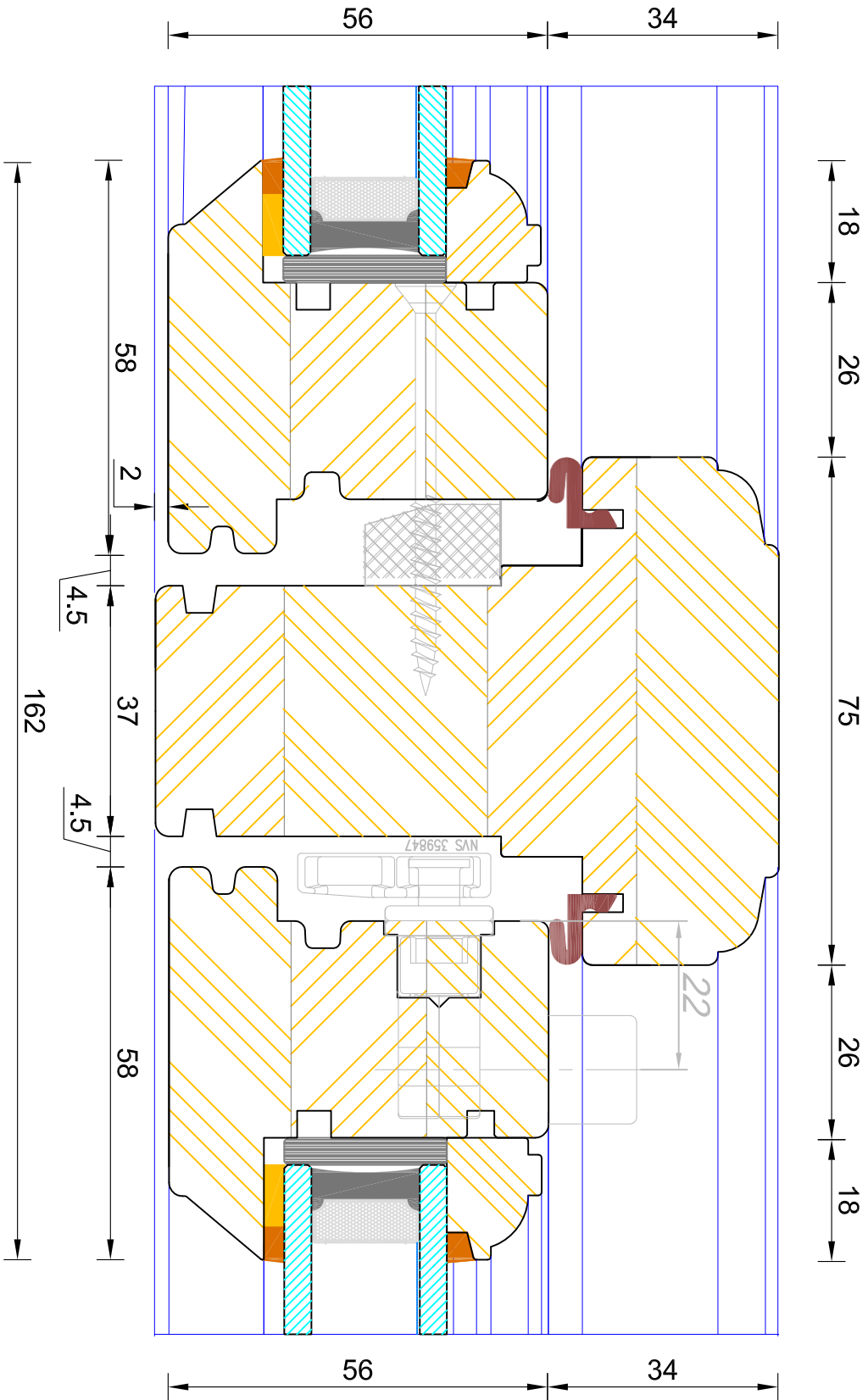
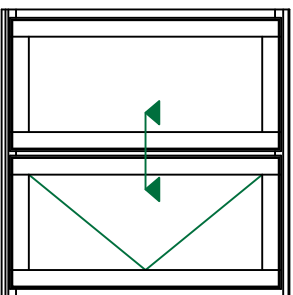

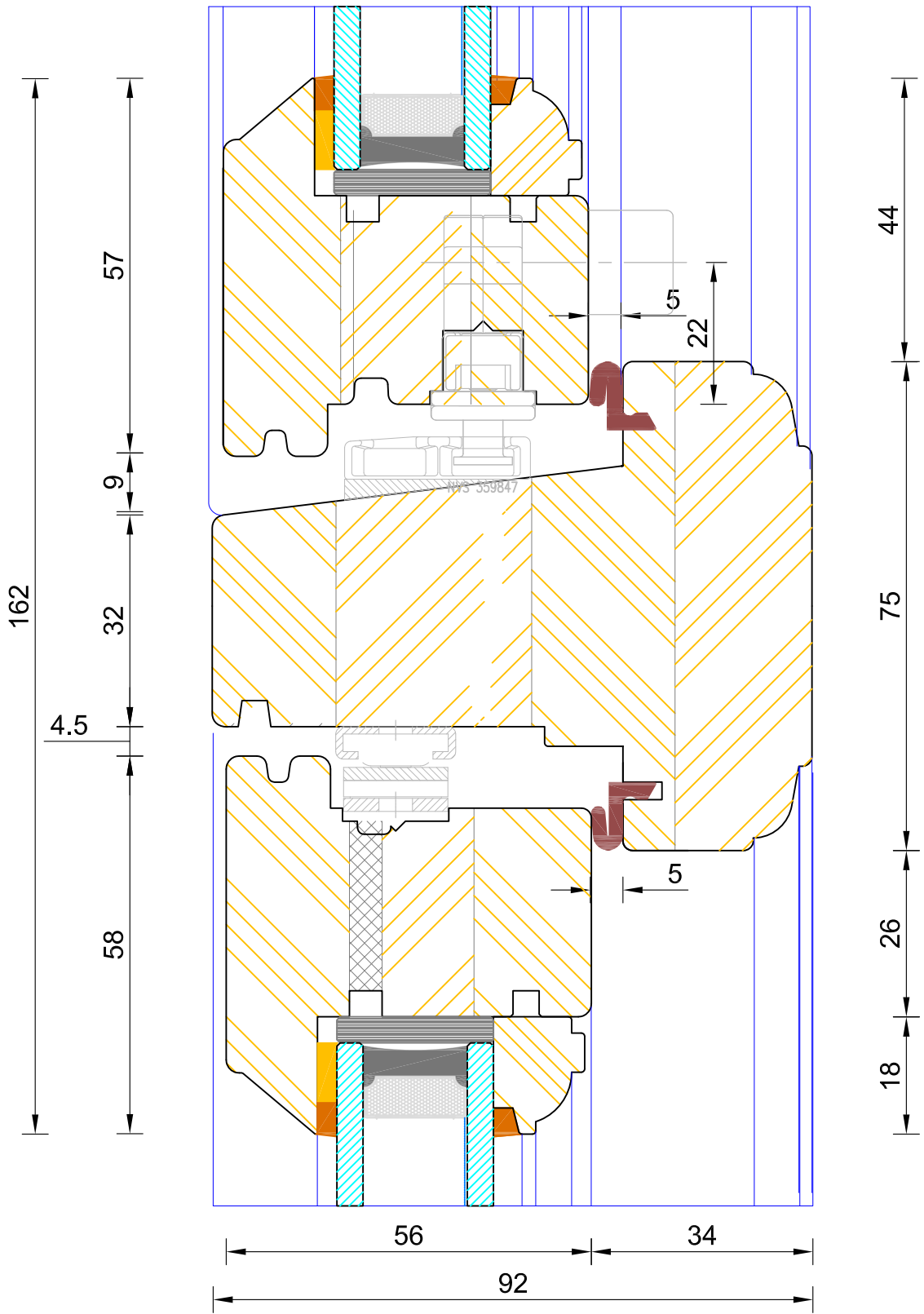
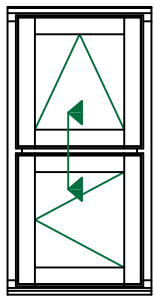

**Traditional Flush Casement Window**  
**Solid Transom (Sash / Sash)**

DIMENSIONS	PLOT SIZE	SCALE	DATE	REV	DWG NO.
MM	A4	1:1	15.04.2011	A	<b>1817</b>
Please consider the environment before printing					

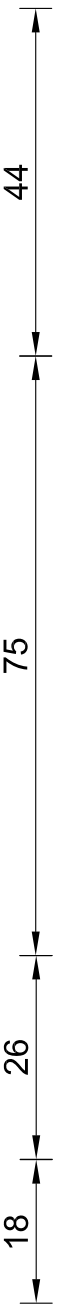
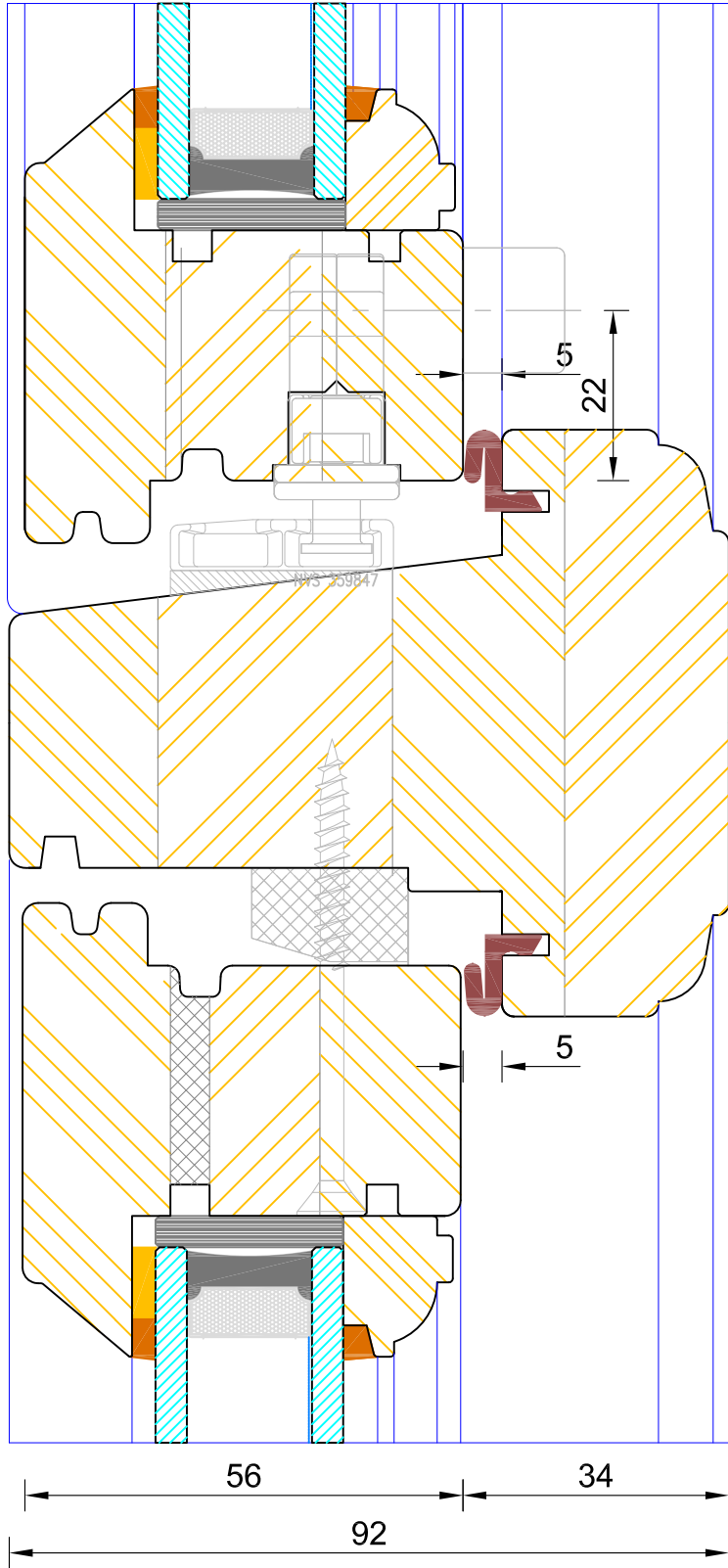
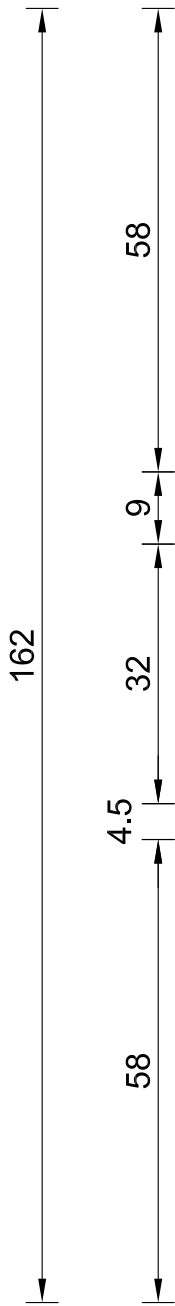
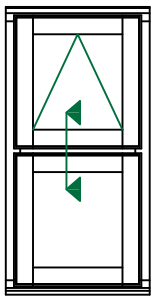

**Traditional Flush Casement Window**  
**Solid Transom (Sash / Fixed Sash)**

DIMENSIONS	PLOT SIZE	SCALE	DATE	REV	DWG NO.
MM	A4	1:1	15.04.2011	A	<b>1816</b>

Please consider the environment before printing

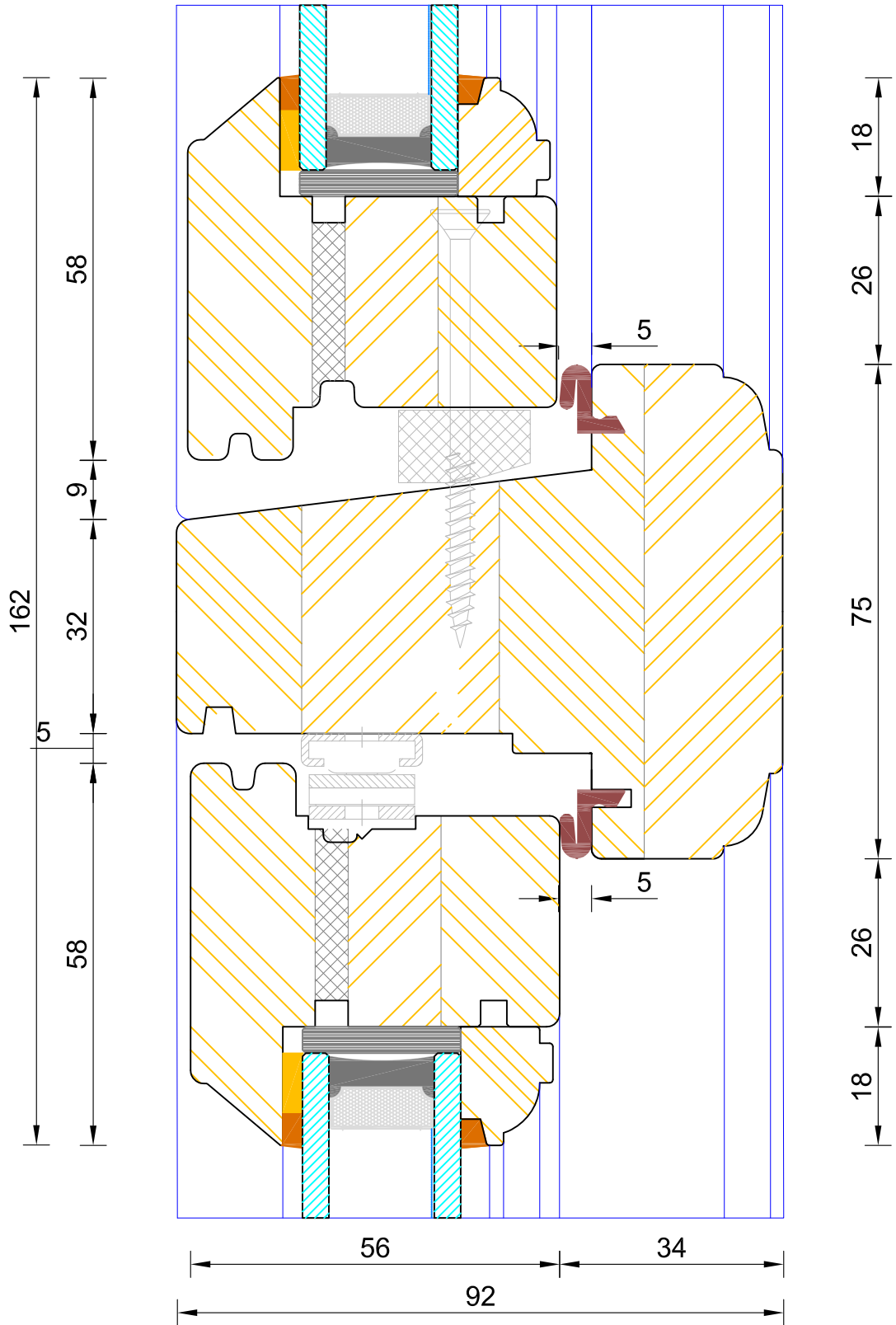
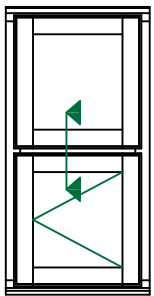

### Traditional Flush Casement Window Solid Transom (Fixed Sash / Sash)

DIMENSIONS	PLOT SIZE	SCALE	DATE	REV	DWG NO.
MM	A4	1:1	15.04.2011	A	<b>1815</b>

Please consider the environment before printing

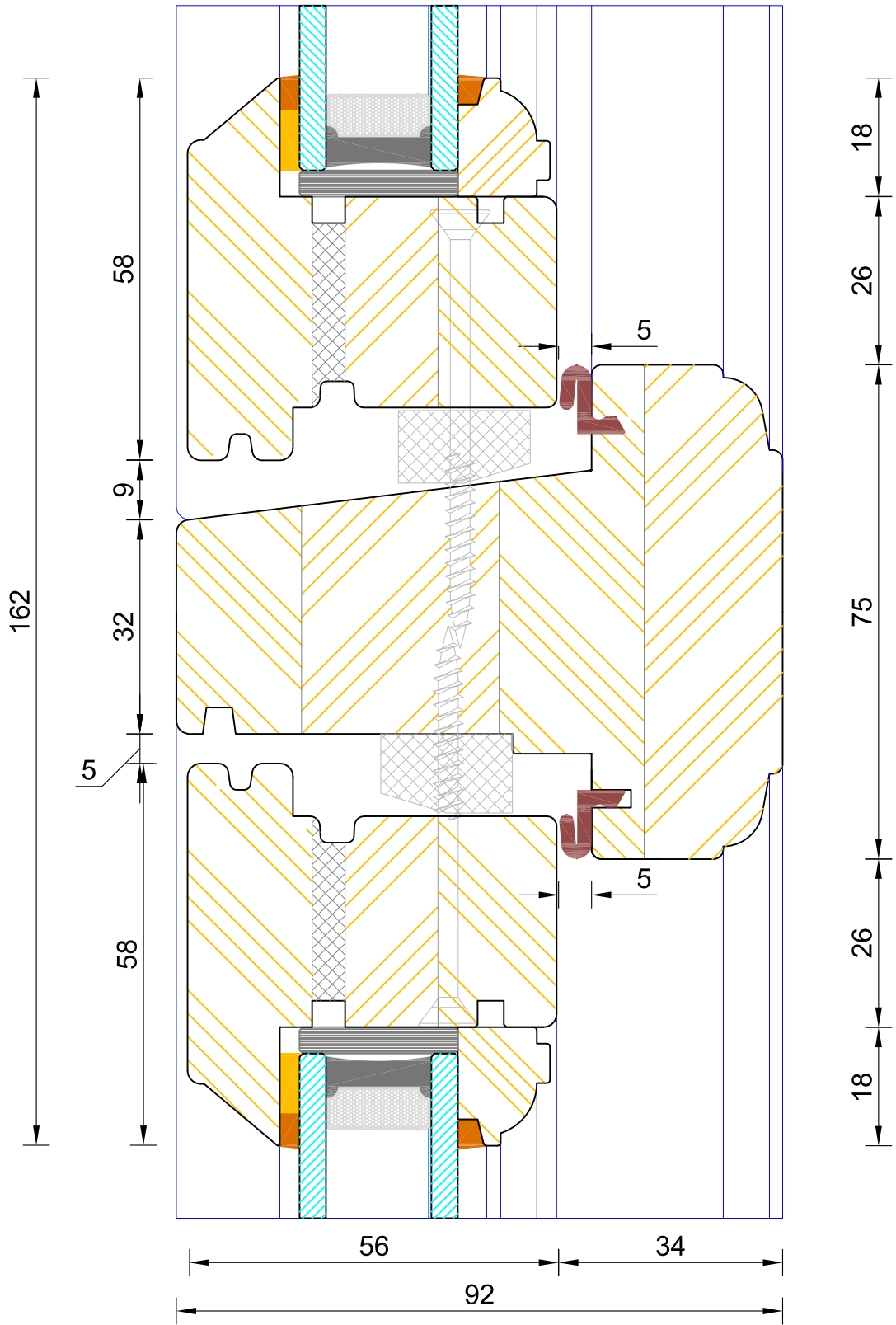
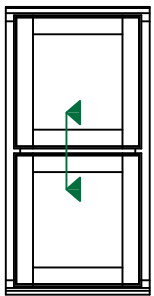

**Traditional Flush Casement Window  
Solid Transom (Fixed Sash / Fixed Sash)**

DIMENSIONS	PLOT SIZE	SCALE	DATE	REV	DWG NO.
MM	A4	1:1	15.04.2011	A	<b>1814</b>

Please consider the environment before printing