

SW Drainage Manhole Schedule

Structure Name	Chamber Diameter (mm)	Cover Level	Invert Level	Depth (m)	Easting	Northing
SW MH 1	1200	60.711	59.355	1.356	603786.994	243501.976
SW MH 2	1200	61.054	59.040	2.014	603818.707	243501.956
SW MH 3	1200	60.716	59.361	1.355	603784.449	243484.277
SW MH 4	1200	60.793	59.190	1.602	603792.823	243477.986
SW MH 5	1200	60.499	58.730	1.769	603818.714	243475.943
SW MH 6	1500	60.578	58.655	1.923	603818.714	243468.356
SW MH 7	1200	60.550	58.545	2.005	603815.767	243458.102
SW MH 8	1200	60.750	58.275	2.475	603839.461	243445.069

FW Drainage Manhole Schedule

Structure Name	Chamber Diameter (mm)	Cover Level	Invert Level	Depth (m)	Easting	Northing
FW IC 1	450	60.881	60.225	0.656	603786.666	243487.536
FW IC 2	315	60.895	60.290	0.605	603789.109	243487.631
FW IC 3	450	60.898	60.155	0.743	603789.109	243486.107
FW IC 4	315	60.965	60.360	0.605	603802.573	243487.378
FW IC 5	450	60.956	59.755	1.201	603802.573	243486.107
FW MH 1	1200	60.431	59.080	1.351	603817.395	243473.018
FW MH 2	1200	60.535	58.870	1.665	603812.611	243456.784
FW MH 3	1200	60.791	58.640	2.151	603829.058	243449.085
FW MH 4	1200	59.695	58.345	1.350	603845.296	243431.691

DRAINAGE LEGEND

- EXISTING SURFACE WATER SEWER AND MANHOLE
- PROPOSED FOUL SEWER AND MANHOLE
- PROPOSED FOUL DRAINAGE
- PROPOSED SURFACE WATER DRAINAGE
- LINEAR DRAINAGE - LEAD 1500 U.N.O
- PROPOSED ROAD GULLY

NOTE: ALL PRIVATE DRAINAGE TO BE 100mm RIGID PIPE OR 110mm FLEXIBLE PIPE UNLESS OTHERWISE SHOWN. ALL DRAINAGE / PIPE WORK TO BE INSTALLED IN ACCORDANCE WITH BUILDING REGULATIONS APPROVED DOCUMENT PART H 2010, NHBC STANDARDS 2015 AND RELATIVE GUIDANCE DOCUMENTS, MANUFACTURERS INSTALLATION LITERATURE AND NOTES.

GENERAL NOTES:

- THIS DRAWING IS BASED ON ORDINANCE SURVEY AND TOPOGRAPHICAL SURVEY INFORMATION RECEIVED. WE CAN ACCEPT NO LIABILITY FOR DESIGN BASED ON INFORMATION RECEIVED.
- THIS DESIGN HAS BEEN CARRIED OUT TO APPROPRIATE STANDARDS BUT IT IS TO BE CHECKED IN ACCORDANCE WITH PRECEDENT AND REQUIREMENTS PRIOR TO THE COMMENCEMENT OF WORKS.
- ALL LEVELS, DIMENSIONS AND DETAILS TO BE CONFIRMED BY THE CONTRACTOR PRIOR TO THE COMMENCEMENT OF CONSTRUCTION OR FABRICATION.
- NO EXISTING BELOW GROUND CONDITIONS HAVE BEEN PROVIDED. THEREFORE ALL INFORMATION IS TO BE VERIFIED FURTHER TO ANY SITE WORKS.
- NO EXISTING SERVICES INFORMATION HAS BEEN PROVIDED. THEREFORE ALL INFORMATION IS TO BE VERIFIED FURTHER TO ANY SITE WORKS.
- EXISTING GROUND LEVELS AND GROUND PROFILES HAVE BEEN TAKEN FROM THE INFORMATION PROVIDED AND AS SUCH ARE TO BE VERIFIED BY THE CONTRACTOR PRIOR TO THE COMMENCEMENT OF WORKS. ANY DISCREPANCIES TO BE BROUGHT TO THE ATTENTION OF THE ENGINEER.

HEALTH & SAFETY AND CDM:

(THE FOLLOWING ARE TO BE READ IN CONJUNCTION WITH CONTRACTORS RISK ASSESSMENTS)

- CONTRACTOR TO UNDERTAKE ALL POSSIBLE PRECAUTIONS WHEN EXCAVATING. ALL EXISTING SERVICES INFORMATION TO BE OBTAINED PRIOR TO THE COMMENCEMENT OF WORKS AND IDENTIFIED ON SITE USING CAT SCANNERS. EXCAVATION TO BE UNDERTAKEN WITH DUE DILIGENCE AND HAND DIGGING TO BE ADOPTED WHERE APPROPRIATE.
- CONTRACTOR TO MINIMISE THE AMOUNT OF TIME ANY EXCAVATIONS REMAIN EXPOSED AND COMPLY WITH LEGISLATIVE AND GOOD PRACTICE GUIDELINES.
- ALL TASKS TO BE UNDERTAKEN BY SUITABLY TRAINED AND EXPERIENCED OPERATIVES FOLLOWING APPROVED METHOD STATEMENTS WITH ADEQUATE RESOURCE ALLOCATED TO EACH TASK.
- FOR ANY WORK REQUIRING COMPACTING OF MATERIALS AND CONCRETE, PERSONNEL TO USE SUITABLE PIPE AND USE ONLY LOW VIBRATION EQUIPMENT. AMOUNT OF TIME OF USE TO BE LIMITED TO SAFE LEVELS IN ACCORDANCE WITH CONTRACTORS APPROVED METHOD STATEMENTS.
- APPROPRIATE MANAGEMENT SAFETY PLAN TO BE IN PLACE FOR DEALING WITH POTENTIAL GROUND CONTAMINATION.
- IN ORDER TO ENSURE THAT THE SIDE EXCAVATIONS REMAIN STABLE DURING EXCAVATIONS, CONTRACTOR TO ASSESS STABILITY AND PROVIDE TEMPORARY SHIELDING TO ENSURE SAFE WORKING AREA.

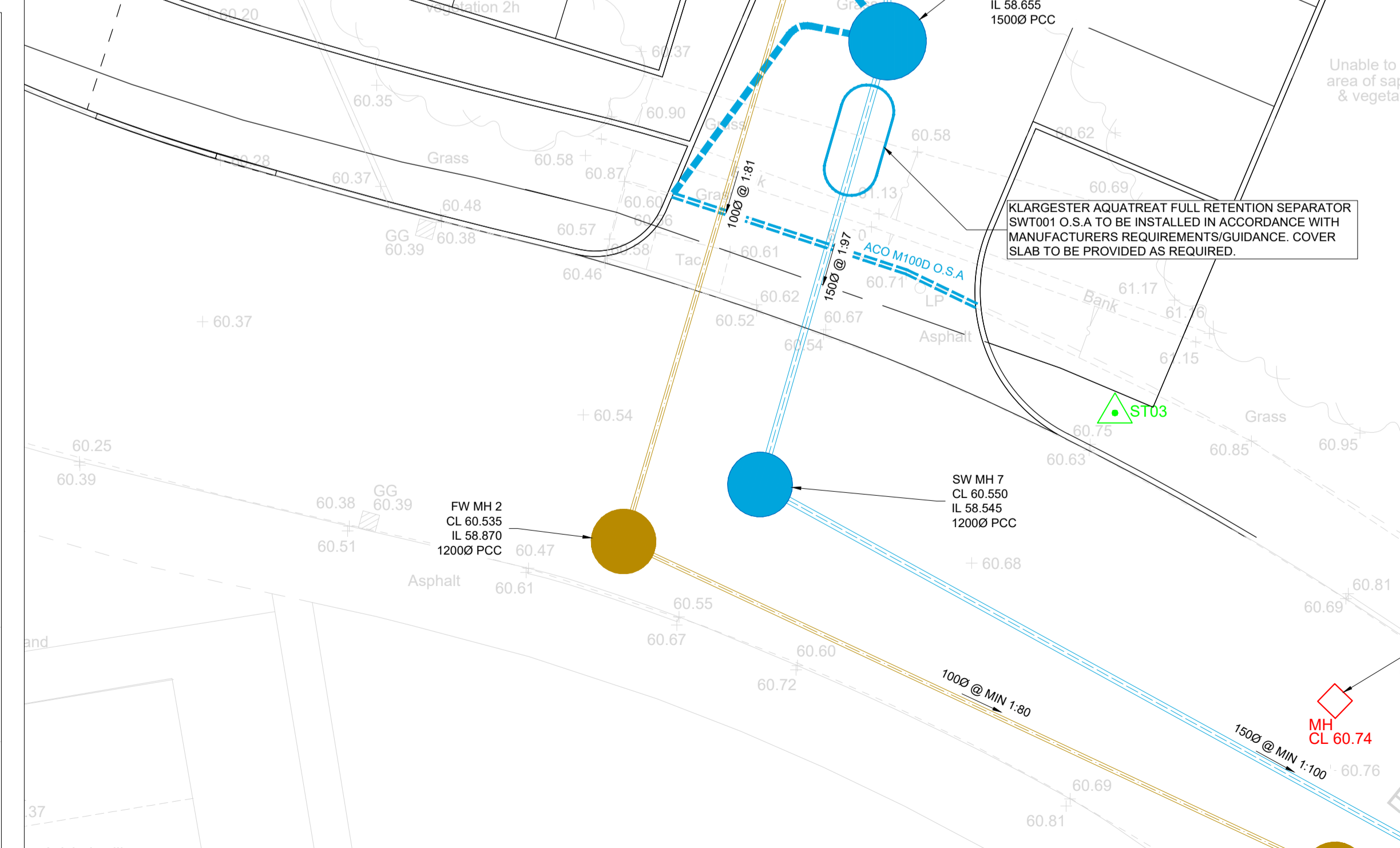
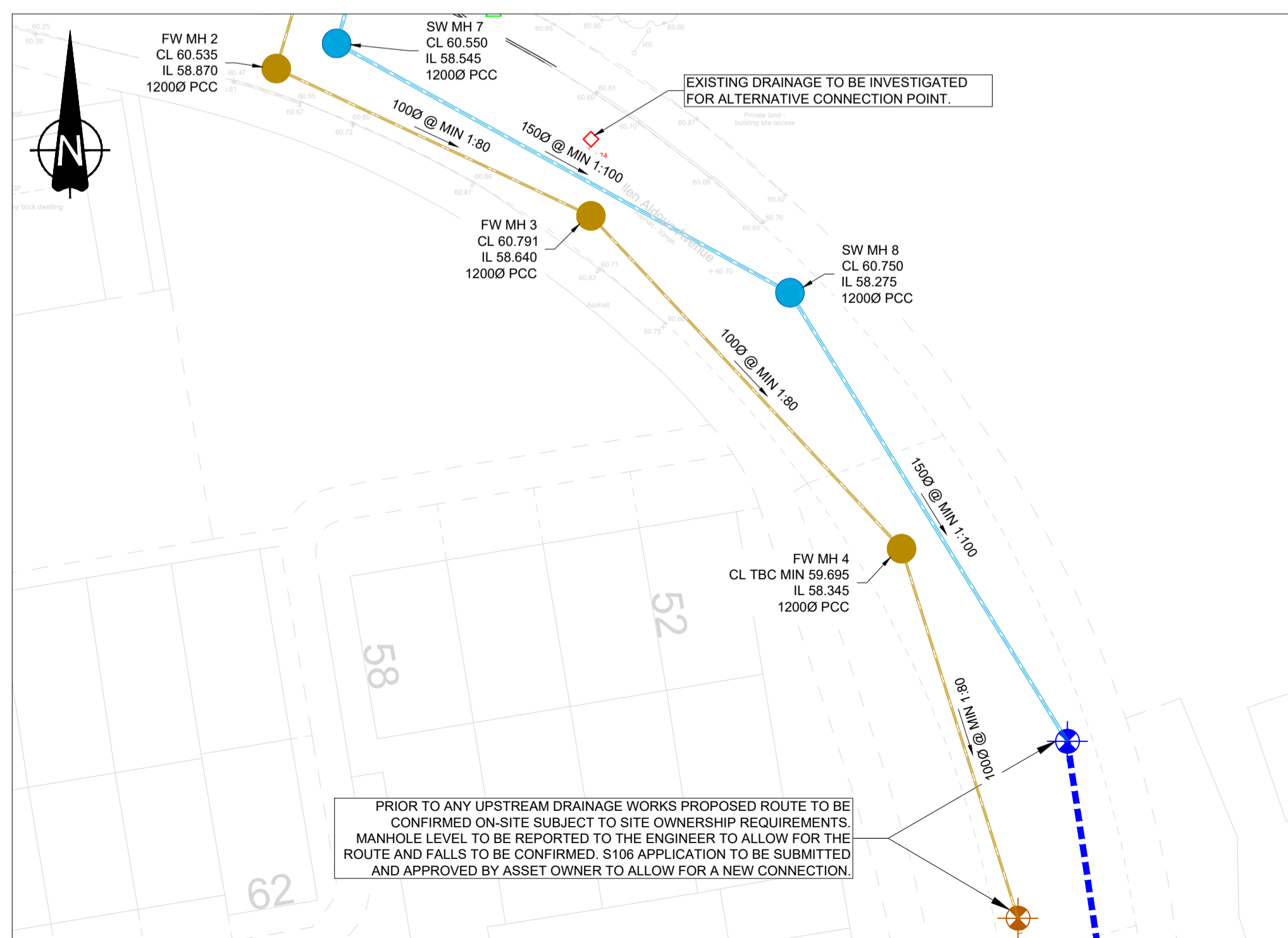

Revision Table:

Revision	Date	Drawn	Description
T1	26/01/24	RL	Issued for Tender

Client & Project:
Burney Estates Ltd
 Proposed Starbucks Store

Address:
Land at Weavers Meadow
 Hadleigh,
 Ipswich,
 IP7 6FD

Drawing Title:
Proposed Drainage Arrangement

Status / Stage: D2
 Sheet: 1 of 1
 Scale @ A1: 1:100
 Drawn: JDJ
 Checked: AW

Drawing Number: S4431-BDN-XX-XX-DR-C-0101
 Revision: T1

Scale: 1:250 (Inset 1), 1:100 (Inset 2), 1:100 (Main)

Established 1983.
 T: 0191555189 E: admin@bdnrd.com W: www.bdnrd.com
 North East (Head Office): The Old School, Simpson Street, Sunderland, SR4 6DR
 North West: Room 107, Ulverston Business Centre, Ulverston, LA12 7UG

BuildingDesignNorthern