

Rear 3D - Proposed

Proposed Extension

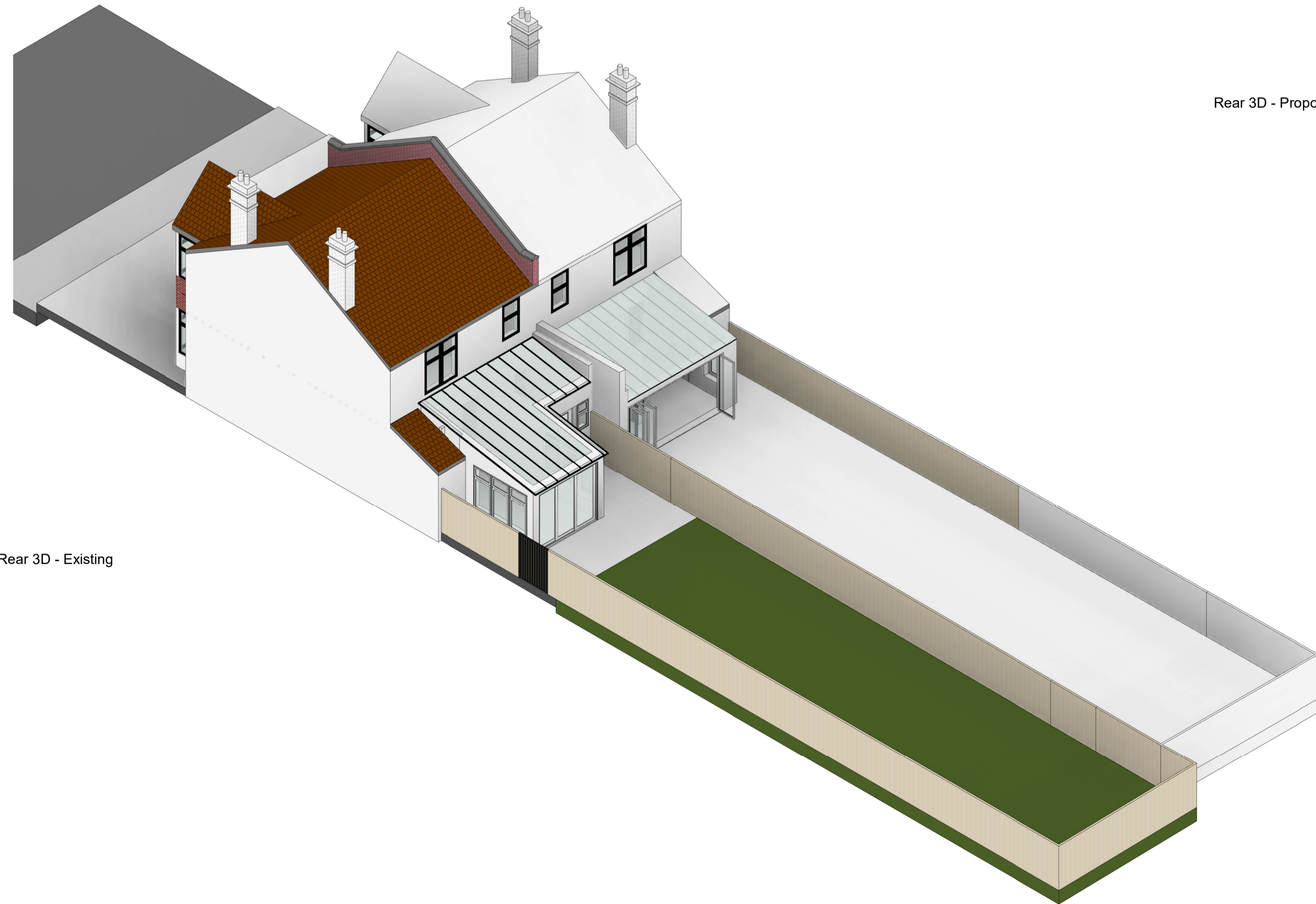

Rear 3D - Existing

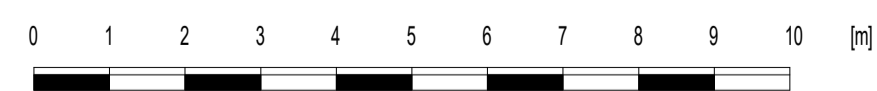

Scale Bar 1:100 @ A1

MM PLANNING & ARCHITECTURE
 892 LONDON ROAD, CR7 7PB
 EMAIL INFO@MMPLANNING-ARCHITECTURE.CO.UK
 CONTACT 02086840333

Scale(@ A1):



Project
 194-NORBURY CRESCENT

Client
 SW16-4JY

Drawing
 3D Rear Existing and Proposed

Number:
 A104

Date:
 28/02/24