

Rev	Change	Date

Stocton Close

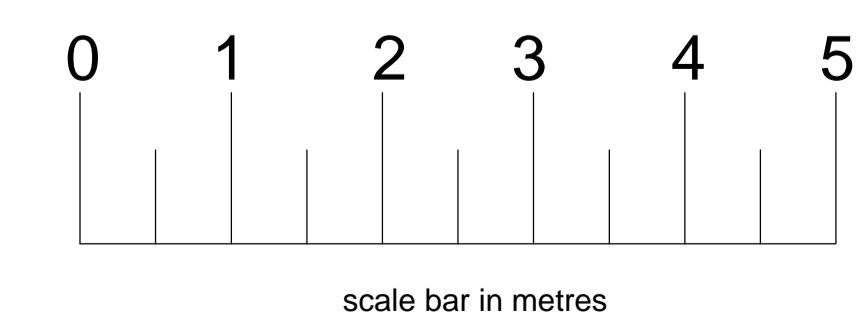
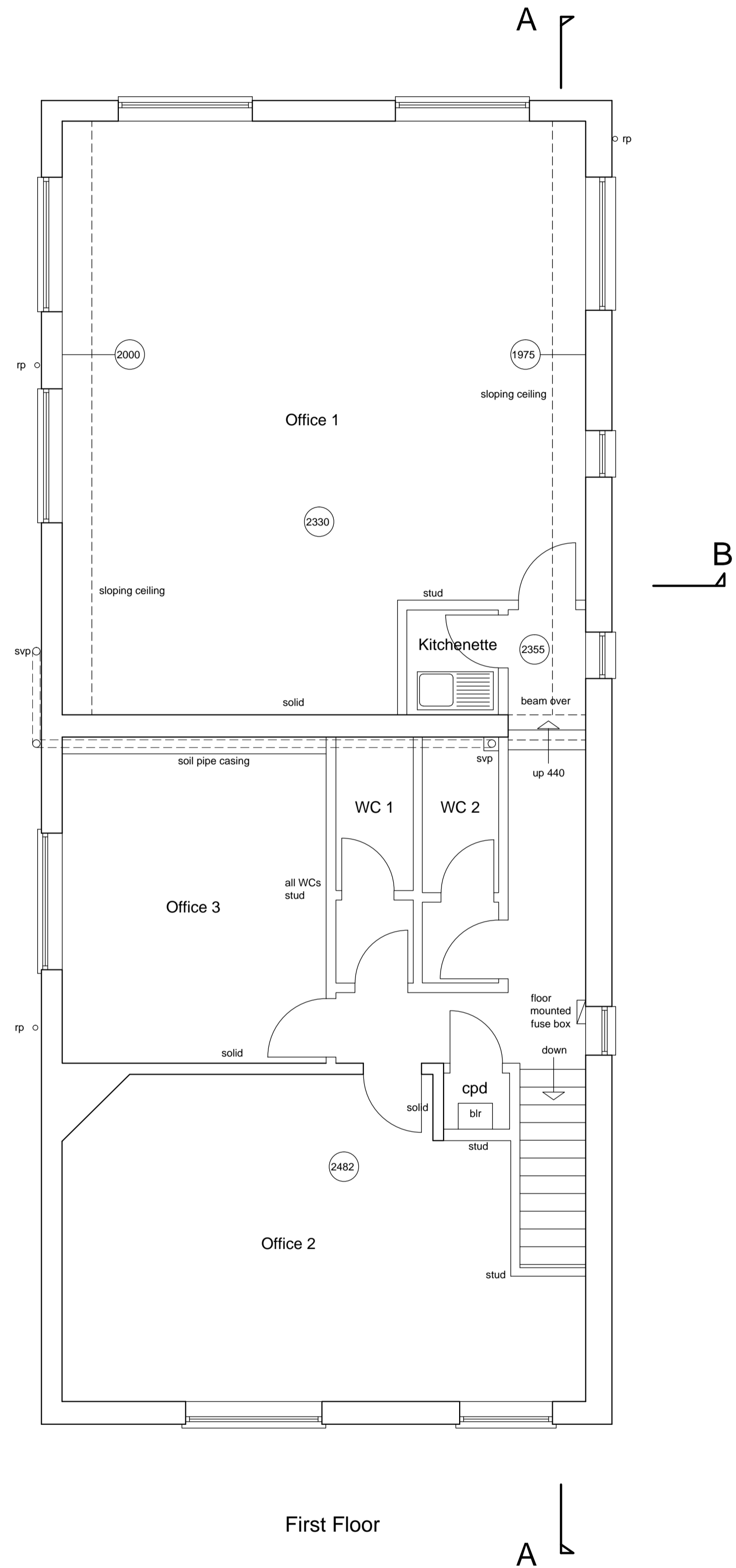
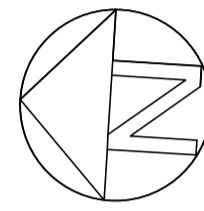

Existing

**Marshall Macvean**  
CHARTERED BUILDING SURVEYORS

23 Stoke Manor Close  
Sedford  
East Sussex  
BN25 3RE  
Telephone: 01323 892532  
Email: admin@marshallmacvean.co.uk

Client: Mr G Pitt

Site: 14 and 14A The Broadway  
Woodbridge Road  
Guildford GU1 1DY

Project: Proposed Conversion of  
First Floor into Two Flats

Title: Existing Floor Plans

Date: 4.9.23 Scale: 1/50  
Drawn By: 376.1 Rev. Drawn By: AM