

The historical maps shown were reproduced from maps predominantly held at the scale adopted for England, Wales and Scotland in the 1840's. In 1854 the 1:2,500 scale was adopted for mapping urban areas; these maps were used to update the 1:10,560 maps. The published date given therefore is often some years later than the surveyed date. Before 1938, all OS maps were based on the Cassini Projection, with independent surveys of a single county or group of counties, giving rise to significant inaccuracies in outlying areas. In the late 1940's, a Provisional Edition was produced, which updated the 1:10,560 mapping from a number of sources. The maps appear unfinished - with all military camps and other strategic sites removed. These maps were initially overprinted with the National Grid. In 1970, the first 1:10,000 maps were produced using the Transverse Mercator Projection. The revision process continued until recently, with new editions appearing every 10 years or so for urban areas.

Map Name(s) and Date(s)

010SE	1938	1:10,560
019NE	1938	1:10,560

Historical Map - Slice A

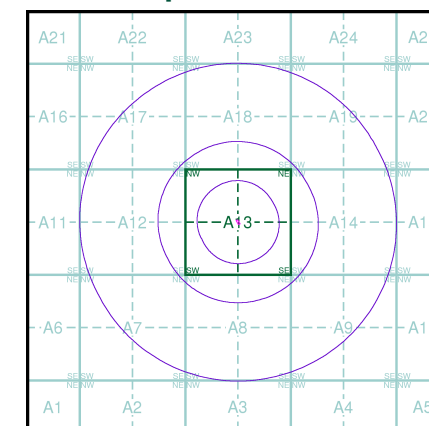

Order Details

Order Number: 321316062\_1\_1  
 Customer Ref: LKC 23 1319  
 National Grid Reference: 389560, 390460  
 Slice: A  
 Site Area (Ha): 0.04  
 Search Buffer (m): 1000

Site Details

51a, Great Underbank, Stockport, SK1 1NE

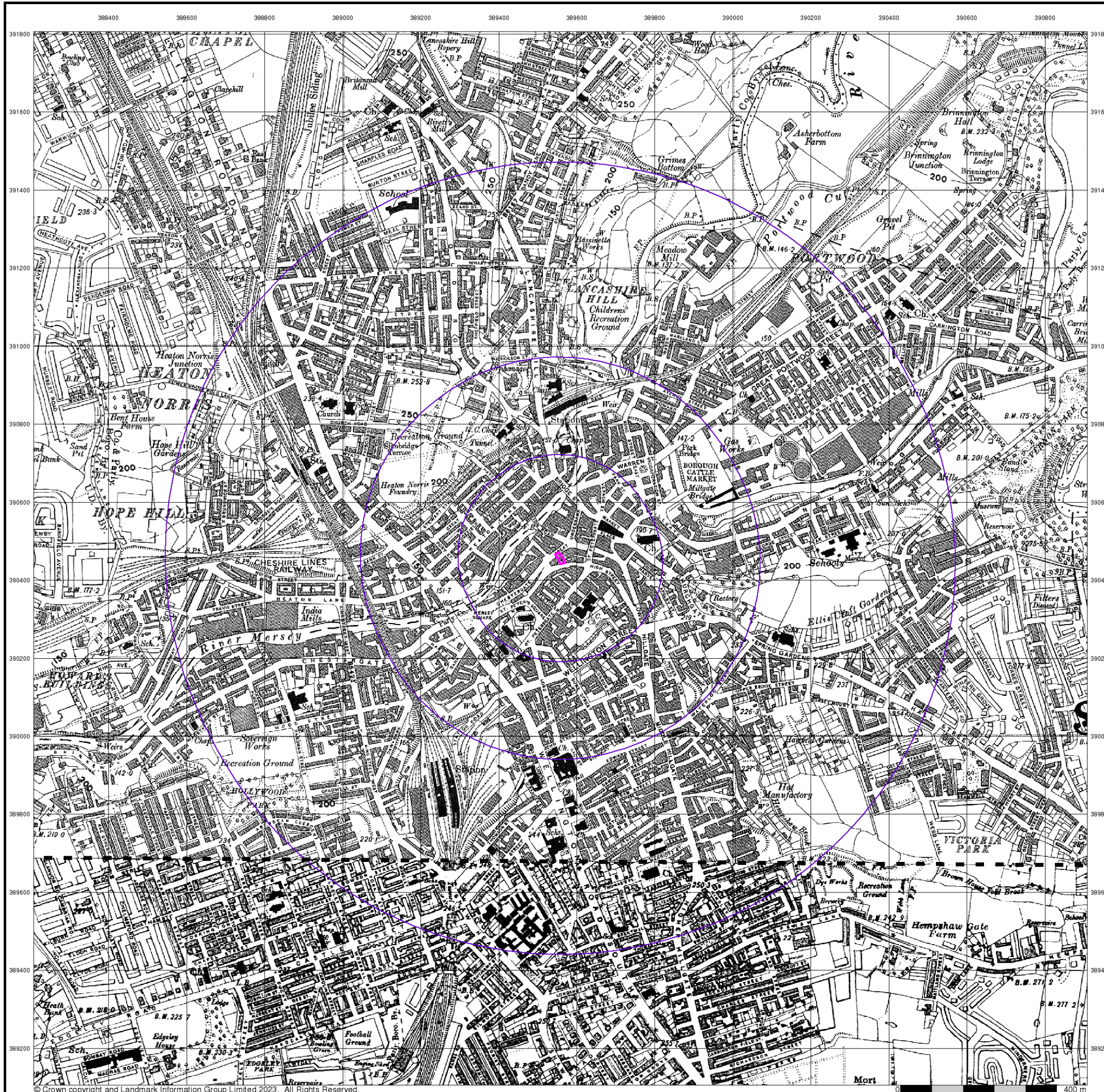

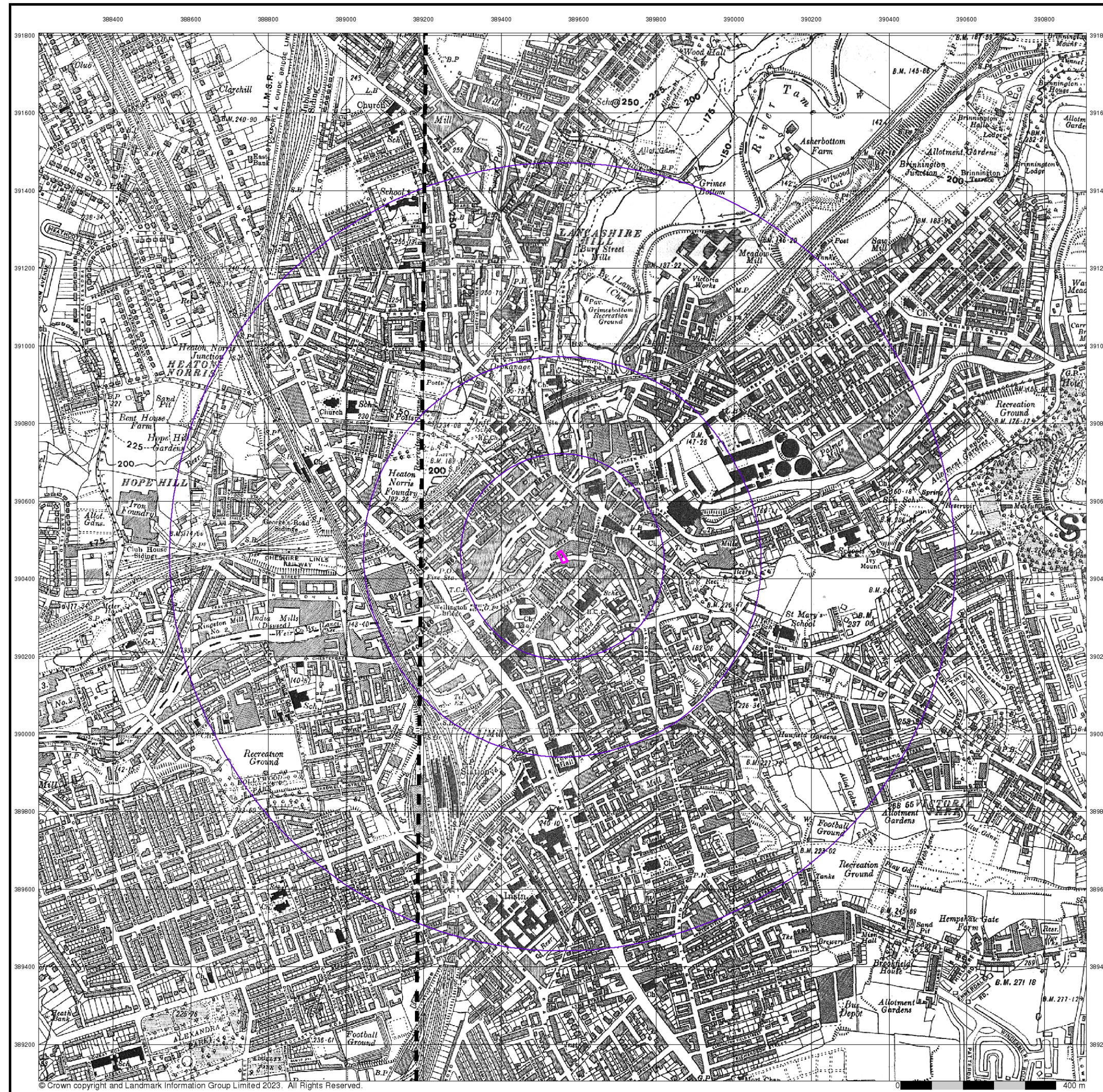

**LK**  
**GROUP**  
**Lancashire And Furness**  
**Published 1938**  
**Source map scale - 1:10,560**

The historical maps shown were reproduced from maps predominantly held at the scale adopted for England, Wales and Scotland in the 1840's. In 1854 the 1:2,500 scale was adopted for mapping urban areas; these maps were used to update the 1:10,560 maps. The published date given therefore is often some years later than the surveyed date. Before 1938, all OS maps were based on the Cassini Projection, with independent surveys of a single county or group of counties, giving rise to significant inaccuracies in outlying areas. In the late 1940's, a Provisional Edition was produced, which updated the 1:10,560 mapping from a number of sources. The maps appear unfinished - with all military camps and other strategic sites removed. These maps were initially overprinted with the National Grid. In 1970, the first 1:10,000 maps were produced using the Transverse Mercator Projection. The revision process continued until recently, with new editions appearing every 10 years or so for urban areas.

**Map Name(s) and Date(s)**

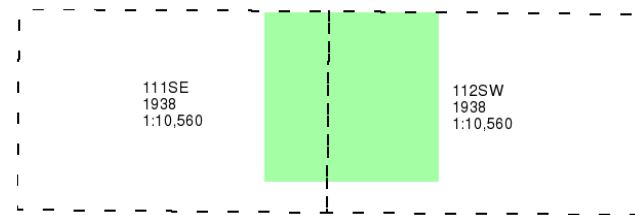

**Historical Map - Slice A**

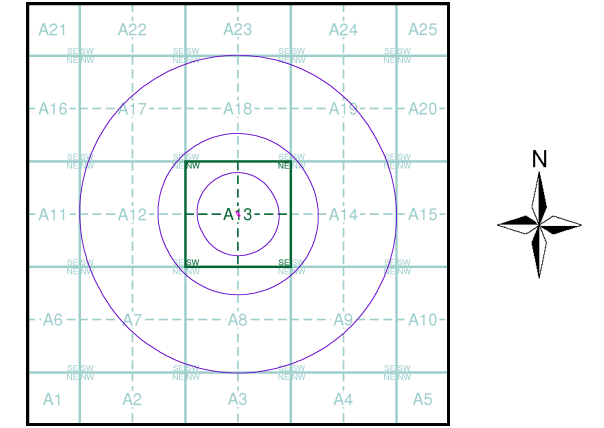

**Order Details**  
 Order Number: 321316062\_1\_1  
 Customer Ref: LKC 23 1319  
 National Grid Reference: 389560, 390460  
 Slice: A  
 Site Area (Ha): 0.04  
 Search Buffer (m): 1000

**Site Details**  
 51a, Great Underbank, Stockport, SK1 1NE

**Landmark**  
 INFORMATION GROUP  
 Tel: 0844 844 9952  
 Fax: 0844 844 9951  
 Web: www.envirocheck.co.uk

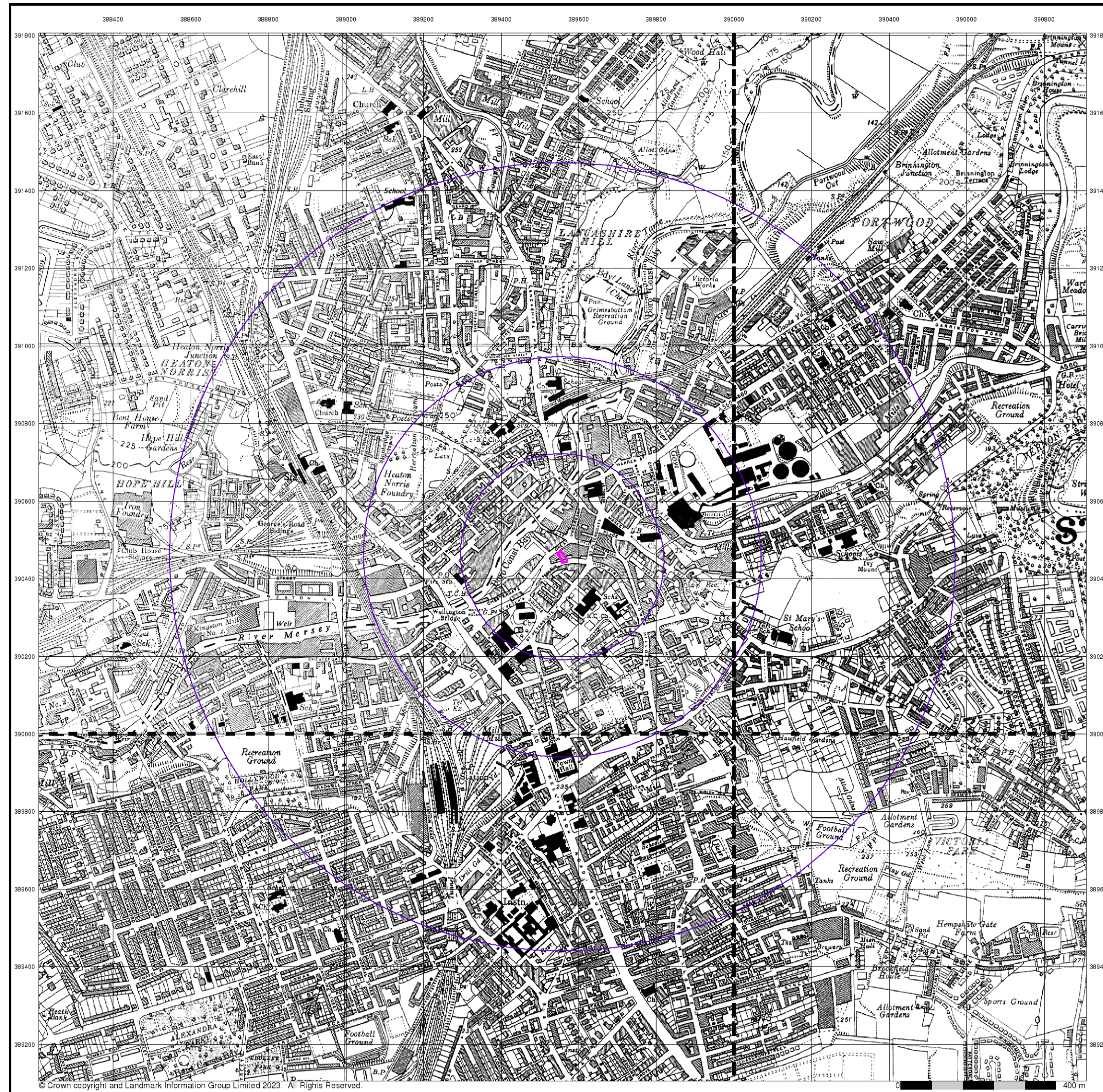

**Ordnance Survey Plan**

**Published 1954 - 1955**

**Source map scale - 1:10,000**

The historical maps shown were reproduced from maps predominantly held at the scale adopted for England, Wales and Scotland in the 1840's. In 1854 the 1:2,500 scale was adopted for mapping urban areas; these maps were used to update the 1:10,560 maps. The published date given therefore is often some years later than the surveyed date. Before 1938, all OS maps were based on the Cassini Projection, with independent surveys of a single county or group of counties, giving rise to significant inaccuracies in outlying areas. In the late 1940's, a Provisional Edition was produced, which updated the 1:10,560 mapping from a number of sources. The maps appear unfinished - with all military camps and other strategic sites removed. These maps were initially overprinted with the National Grid. In 1970, the first 1:10,000 maps were produced using the Transverse Mercator Projection. The revision process continued until recently, with new editions appearing every 10 years or so for urban areas.

**Map Name(s) and Date(s)**

SJ89SE	SJ99SW
1955	1954
1:10,560	1:10,560
SJ88NE	SJ98NW
1954	1954
1:10,560	1:10,560

**Historical Map - Slice A**

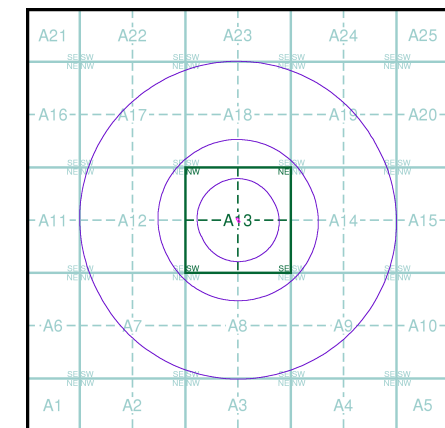

**Order Details**

Order Number: 321316062\_1\_1  
 Customer Ref: LKC 23 1319  
 National Grid Reference: 389560, 390460  
 Slice: A  
 Site Area (Ha): 0.04  
 Search Buffer (m): 1000

**Site Details**

51a, Great Underbank, Stockport, SK1 1NE



Tel: 0844 844 9952  
 Fax: 0844 844 9951  
 Web: www.envirocheck.co.uk

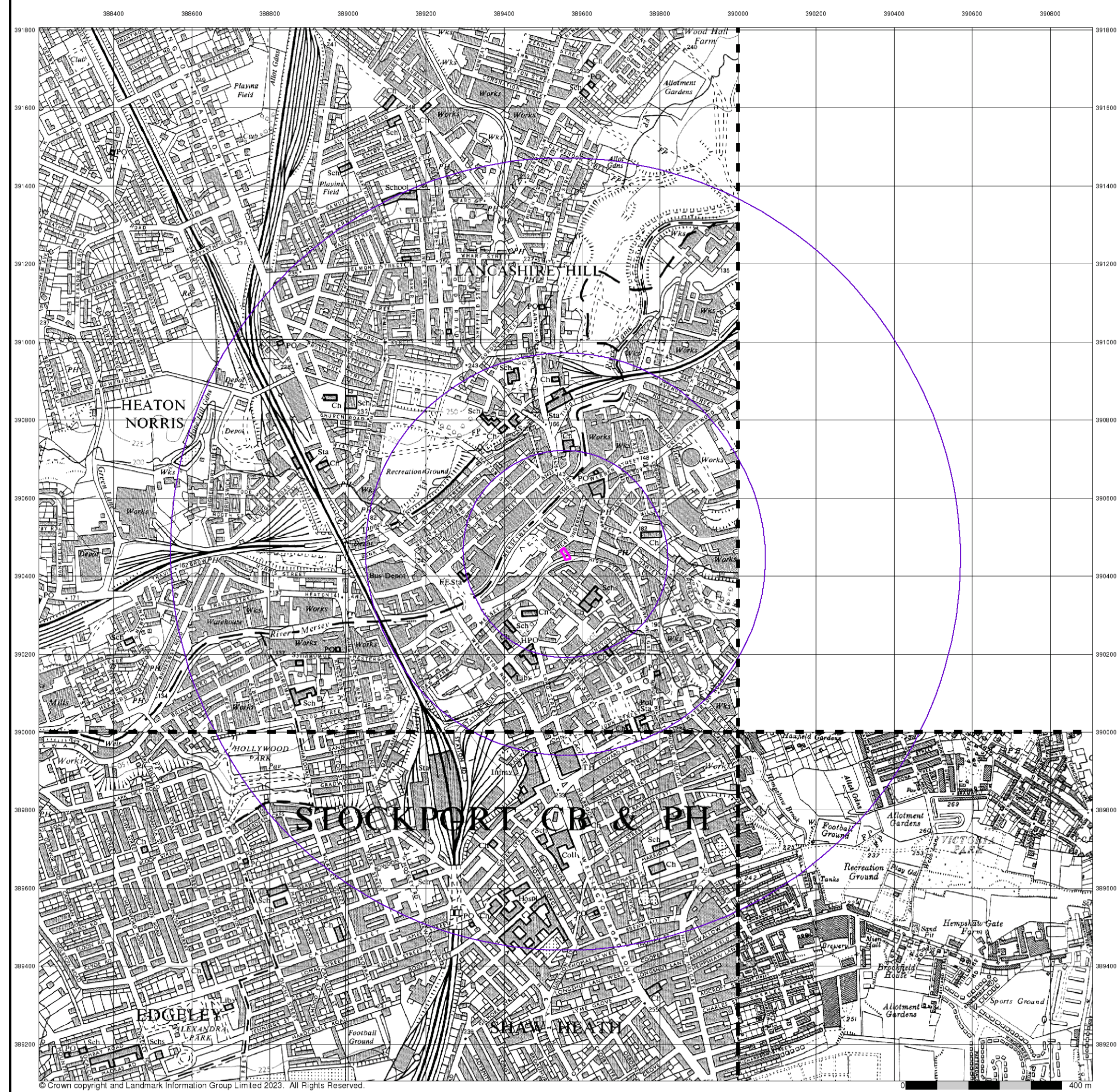

**LK**  
**GROUP**  
**Ordnance Survey Plan**  
**Published 1965 - 1969**  
**Source map scale - 1:10,000**

The historical maps shown were reproduced from maps predominantly held at the scale adopted for England, Wales and Scotland in the 1840's. In 1854 the 1:2,500 scale was adopted for mapping urban areas; these maps were used to update the 1:10,560 maps. The published date given therefore is often some years later than the surveyed date. Before 1938, all OS maps were based on the Cassini Projection, with independent surveys of a single county or group of counties, giving rise to significant inaccuracies in outlying areas. In the late 1940's, a Provisional Edition was produced, which updated the 1:10,560 mapping from a number of sources. The maps appear unfinished - with all military camps and other strategic sites removed. These maps were initially overprinted with the National Grid. In 1970, the first 1:10,000 maps were produced using the Transverse Mercator Projection. The revision process continued until recently, with new editions appearing every 10 years or so for urban areas.

**Map Name(s) and Date(s)**

SJ89SE	1965	1:10,560
SJ88NE	1966	1:10,560
SJ98NW	1969	1:10,560

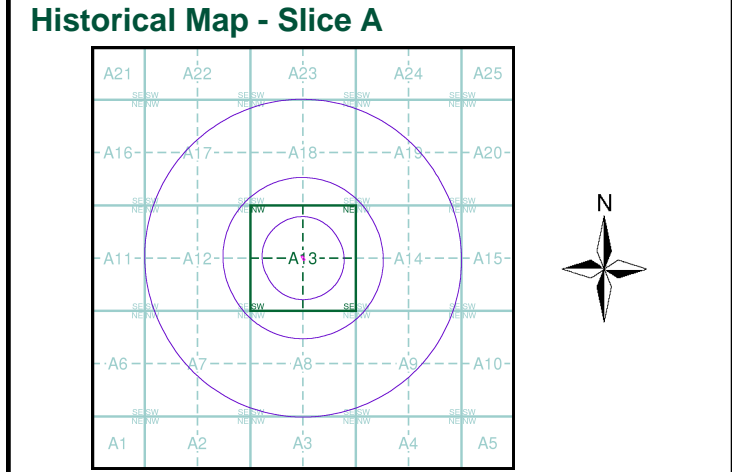

**Order Details**

Order Number: 321316062\_1\_1  
 Customer Ref: LKC 23 1319  
 National Grid Reference: 389560, 390460  
 Slice: A  
 Site Area (Ha): 0.04  
 Search Buffer (m): 1000

**Site Details**  
 51a, Great Underbank, Stockport, SK1 1NE

**Landmark**  
 INFORMATION GROUP

Tel: 0844 844 9952  
 Fax: 0844 844 9951  
 Web: www.envirocheck.co.uk



# GROUP Ordnance Survey Plan

Published 1971 - 1978

Source map scale - 1:10,000

The historical maps shown were reproduced from maps predominantly held at the scale adopted for England, Wales and Scotland in the 1840's. In 1854 the 1:2,500 scale was adopted for mapping urban areas; these maps were used to update the 1:10,560 maps. The published date given therefore is often some years later than the surveyed date. Before 1938, all OS maps were based on the Cassini Projection, with independent surveys of a single county or group of counties, giving rise to significant inaccuracies in outlying areas. In the late 1940's, a Provisional Edition was produced, which updated the 1:10,560 mapping from a number of sources. The maps appear unfinished - with all military camps and other strategic sites removed. These maps were initially overprinted with the National Grid. In 1970, the first 1:10,000 maps were produced using the Transverse Mercator Projection. The revision process continued until recently, with new editions appearing every 10 years or so for urban areas.

### Map Name(s) and Date(s)

SJ89SE	SJ99SW
1976	1971
1:10,000	1:10,560
■	
SJ88NE	SJ98NW
1978	1977
1:10,000	1:10,000

### Historical Map - Slice A

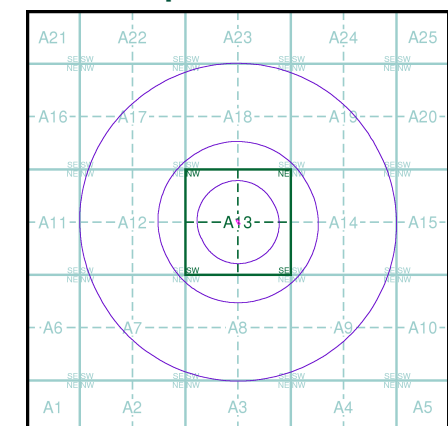

### Order Details

Order Number: 321316062\_1\_1  
 Customer Ref: LKC 23 1319  
 National Grid Reference: 389560, 390460  
 Slice: A  
 Site Area (Ha): 0.04  
 Search Buffer (m): 1000

### Site Details

51a, Great Underbank, Stockport, SK1 1NE



Tel: 0844 844 9952  
 Fax: 0844 844 9951  
 Web: www.envirocheck.co.uk

