

© Crown Copyright. All Rights Reserved. License Number 100022432.



Combined Surface Geology

The Combined Surface Geology map combines all the previous maps into one combined geological overview of your site.

Please consult the legends to the previous maps to interpret the Combined "Surface Geology" map.

Additional Information

More information on 1:50,000 Geological mapping and explanations of rock classifications can be found on the BGS website. Using the LEX Codes in this report, further descriptions of rock types can be obtained by interrogating the 'BGS Lexicon of Named Rock Units'. This database can be accessed by following the 'Information and Data' link on the BGS website.

Contact

British Geological Survey
 Kingsley Dunham Centre
 Keyworth
 Nottingham
 NG12 5GG
 Telephone: 0115 936 3143
 Fax: 0115 936 3276
 email: enquiries@bgs.ac.uk
 website: www.bgs.ac.uk

Combined Geology Map - Slice A

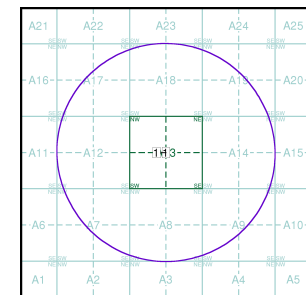

Order Details:

Order Number: 321316062_1_1
 Customer Reference: LKC 23 1319
 National Grid Reference: 389560, 390460
 Slice: A
 Site Area (Ha): 0.04
 Search Buffer (m): 1000

Site Details:

51a, Great Underbank, Stockport, SK1 1NE



Tel: 0844 844 9952
 Fax: 0844 844 9951
 Web: www.envirocheck.co.uk

Historical Mapping Legends

Ordnance Survey County Series 1:10,560

	Gravel Pit		Sand Pit		Other Pits
	Quarry		Shingle		Orchard
	Osiers		Reeds		Marsh
	Mixed Wood		Deciduous		Brushwood
	Fir		Furze		Rough Pasture
	Arrow denotes flow of water		Trigonometrical Station		
	Site of Antiquities		Bench Mark		
	Pump, Guide Post, Signal Post		Well, Spring, Boundary Post		
	-285 Surface Level				
	Sketched Contour		Instrumental Contour		
	Main Roads		Minor Roads		
	Sunken Road		Raised Road		
	Road over Railway		Railway over River		
	Railway over Road		Level Crossing		
	Road over River or Canal		Road over Stream		
	Road over Stream				
	County Boundary (Geographical)				
	County & Civil Parish Boundary				
	Administrative County & Civil Parish Boundary				
	County Borough Boundary (England)				
	County Burgh Boundary (Scotland)				
	Rural District Boundary				
	Civil Parish Boundary				

Ordnance Survey Plan 1:10,000

	Chalk Pit, Clay Pit or Quarry		Gravel Pit
	Sand Pit		Disused Pit or Quarry
	Refuse or Slag Heap		Lake, Loch or Pond
	Dunes		Boulders
	Coniferous Trees		Non-Coniferous Trees
	Orchard		Scrub
	Coppice		
	Bracken		Heath
	Rough Grassland		
	Marsh		Reeds
	Saltings		
	Building		Glasshouse
	Sloping Masonry		Pylon
	Electricity Transmission Line		Pole
	Cutting		Embankment
	Standard Gauge Multiple Track		
	Standard Gauge Single Track		
	Siding, Tramway or Mineral Line		
	Narrow Gauge		
	Geographical County		
	Administrative County, County Borough or County of City		
	Municipal Borough, Urban or Rural District, Burgh or District Council		
	Borough, Burgh or County Constituency Shown only when not coincident with other boundaries		
	Civil Parish Shown alternately when coincidence of boundaries occurs		
	BP, BS Boundary Post or Stone		Pol Sta Police Station
	Ch Church		PO Post Office
	CH Club House		PC Public Convenience
	F E Sta Fire Engine Station		PH Public House
	FB Foot Bridge		SB Signal Box
	Fn Fountain		Spr Spring
	GP Guide Post		TCB Telephone Call Box
	MP Mile Post		TCP Telephone Call Post
	MS Mile Stone		W Well

1:10,000 Raster Mapping

	Gravel Pit		Refuse tip or slag heap
	Rock		Rock (scattered)
	Boulders		Boulders (scattered)
	Shingle		Mud
	Sand		Sand Pit
	Slopes		Top of cliff
	General detail		Underground detail
	Overhead detail		Narrow gauge railway
	Multi-track railway		Single track railway
	County boundary (England only)		Civil, parish or community boundary
	District, Unitary, Metropolitan, London Borough boundary		Constituency boundary
	Area of wooded vegetation		Non-coniferous trees
	Non-coniferous trees (scattered)		Coniferous trees
	Coniferous trees (scattered)		Positioned tree
	Orchard		Coppice or Osiers
	Rough Grassland		Heath
	Scrub		Marsh, Salt Marsh or Reeds
	Water feature		Flow arrows
	MHW(S) Mean high water (springs)		MLW(S) Mean low water (springs)
	Telephone line (where shown)		Electricity transmission line (with poles)
	Bench mark (where shown)		Triangulation station
	Point feature (e.g. Guide Post or Mile Stone)		Pylon, flare stack or lighting tower
	Site of (antiquity)		Glasshouse
	General Building		Important Building



GROUP

Historical Mapping & Photography included:

Mapping Type	Scale	Date	Pg
Lancashire And Furness	1:10,560	1848	3
Cheshire	1:10,560	1882	4
Lancashire And Furness	1:10,560	1895	5
Cheshire	1:10,560	1899	6
Lancashire And Furness	1:10,560	1910 - 1911	7
Cheshire	1:10,560	1911	8
Lancashire And Furness	1:10,560	1923	9
Lancashire And Furness	1:10,560	1934	10
Cheshire	1:10,560	1938	11
Lancashire And Furness	1:10,560	1938	12
Ordnance Survey Plan	1:10,000	1954 - 1955	13
Ordnance Survey Plan	1:10,000	1965 - 1969	14
Ordnance Survey Plan	1:10,000	1971 - 1978	15
Manchester	1:25,000	1975	16
Ordnance Survey Plan	1:10,000	1980 - 1985	17
Ordnance Survey Plan	1:10,000	1989	18
Ordnance Survey Plan	1:10,000	1990 - 1995	19
10K Raster Mapping	1:10,000	1999	20
10K Raster Mapping	1:10,000	2006	21
VectorMap Local	1:10,000	2023	22

Historical Map - Slice A

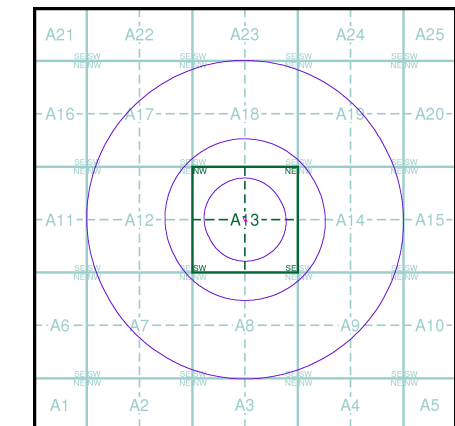

Order Details

Order Number: 321316062_1_1
 Customer Ref: LKC 23 1319
 National Grid Reference: 389560, 390460
 Slice: A
 Site Area (Ha): 0.04
 Search Buffer (m): 1000

Site Details

51a, Great Underbank, Stockport, SK1 1NE



Tel: 0844 844 9952
 Fax: 0844 844 9951
 Web: www.envirocheck.co.uk

Russian Military Mapping Legends

1:5,000 and 1:10,000 mapping

a. Not drawn to scale b. Drawn to scale

	Government and Administrative Buildings		Military and Industrial Buildings
	Military and Communication Areas		Subway Entrance
	Fireproof Building		Prominent Fireproof Building
	Non-fireproof Building		Non-fireproof Building (non-dwelling)
	Factory, mill, and flour mill, with chimneys		Factory, mill, and flour mill, without chimneys
	Power Station, drawn to scale		Hydroelectric Power Station
	Radio Station, drawn to scale		Telephone Station, drawn to scale
	Abandoned Open-pit Mine or Quarry		Open-pit Salt Mine
	Pit		Oil Deposit or Well
	Oil Seepage		Natural Gas Tank
	Tailings Pile		Fuel Storage Tanks
	Bench Mark		Drill Hole
	Burial Mound		Triangulation Point on Burial Mound
	Single-track Railroad		Double-track Railroad
	Small Bridge		Tunnel
	Railroad and Station Building		Pipe (Culvert)
	Coniferous Forest		Deciduous Forest
	Mixed Forest		Lawns
	Citrus Orchard		Wet Ground
	Scattered Vegetation		

243,8 Values for prominent elevations
 186.0 Numbers for spot elevations, depth soundings, contour lines, etc.
 0,2 Velocity of the current, width of river bed, depth of river
 180/12 Fractional terms: length and capacity of bridges; depth of fords and condition of the river bottom; height of forest and the diameter of trees

Russian Alphabet (For reference and phonetic interpretation of map text)

А а (A)	З з (Z)	П п (P)	Ч ч (CH)
Б б (B)	И и (I)	Р р (R)	Ш ш (SH)
В в (V)	Й й (Y)	С с (S)	Щ щ (SHCH)
Г г (G)	К к (K)	Т т (T)	Ъ (-)
Д д (D)	Л л (L)	У у (U)	Ы (Y)
Е е (E)	М м (M)	Ф ф (F)	Ь (')
Ё ё (YO)	Н н (N)	Х х (KH)	Э э (E)
Ж ж (ZH)	О о (O)	Ц ц (TS)	Ю ю (YU or IU)
			Я я (YA or IA)

1:25,000 mapping

a. Not drawn to scale b. Drawn to scale

	Government and Administrative Buildings		Military and Industrial Buildings
	Military and Communication Areas		Subway Entrance
	Partly Demolished Buildings		Demolished Buildings
	Built-Up Area with Fireproof Buildings Predominant		Built-Up Area with Non-Fireproof Buildings Predominant
	Individual Fireproof Building		Prominent Industrial Building
	Individual Dwelling, Fireproof		Ruins of an Individual Dwelling
	Factory or Mill Chimney		Factory or Mill with Chimney
	Factory or Mill without Chimney		Salt Mine
	Operating Shaft or Mine		Non-Operating Shaft or Mine
	Pit		Stone Quarry
	Gas Pump or Service Station		Fuel Storage or Natural Gas Tank
	Oil or Natural Gas Derrick		Small Hydroelectric Power Station
	Power Station		Transformer Station
	Cemetery		Burial Mound (height in metres)
	Triangulation Point on Burial Mound		Triangulation Point
	Bench Mark		Bench Mark (monumented)
	Telegraph Office		Telephone Station
	Radio Station		Radio Tower
	Airfield or Seaplane Base		Landing Strip
	Cut		Fill
	Main Highway		Highway under Construction
	Improved Dirt Road (former truck road)		Steep Grade
	Small Bridge		Pipe (Culvert)
	Tunnel		Dismantled Railroad
	Double-track Railroad with First Class Station		Railroad Under Construction
	Shore Embankment		River or Ditch with Embankment
	Water Reservoir or Rain Water Pit		Spring
	Well		Isobath with value
	Heavy (Index) Contour Line		Contour Line and Value
	Half Contour Line		Spot Elevation Value
	Coniferous		Deciduous
	Mixed		Scrub

Key to Numbers on Mapping

SJ88_Manchester

No.	Description
192	Railway Station

SJ89_Manchester

No.	Description
68	Factory (Gas)
220	Factory (Use Unknown)
237	Factory (Textiles)



GROUP

Historical Mapping & Photography included:

Mapping Type	Scale	Date	Pg
Lancashire And Furness	1:10,560	1848	3
Cheshire	1:10,560	1882	4
Lancashire And Furness	1:10,560	1895	5
Cheshire	1:10,560	1899	6
Lancashire And Furness	1:10,560	1910 - 1911	7
Cheshire	1:10,560	1911	8
Lancashire And Furness	1:10,560	1923	9
Lancashire And Furness	1:10,560	1934	10
Cheshire	1:10,560	1938	11
Lancashire And Furness	1:10,560	1938	12
Ordnance Survey Plan	1:10,000	1954 - 1955	13
Ordnance Survey Plan	1:10,000	1965 - 1969	14
Ordnance Survey Plan	1:10,000	1971 - 1978	15
Manchester	1:25,000	1975	16
Ordnance Survey Plan	1:10,000	1980 - 1985	17
Ordnance Survey Plan	1:10,000	1989	18
Ordnance Survey Plan	1:10,000	1990 - 1995	19
10K Raster Mapping	1:10,000	1999	20
10K Raster Mapping	1:10,000	2006	21
VectorMap Local	1:10,000	2023	22

Russian Map - Slice A

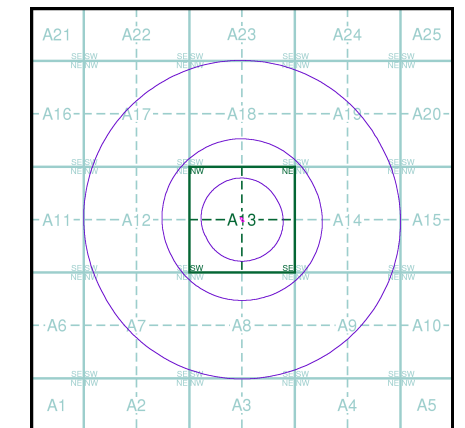

Order Details

Order Number: 321316062_1_1
 Customer Ref: LKC 23 1319
 National Grid Reference: 389560, 390460
 Slice: A
 Site Area (Ha): 0.04
 Search Buffer (m): 1000

Site Details

51a, Great Underbank, Stockport, SK1 1NE



Tel: 0844 844 9952
 Fax: 0844 844 9951
 Web: www.envirocheck.co.uk

Published 1848
Source map scale - 1:10,560

The historical maps shown were reproduced from maps predominantly held at the scale adopted for England, Wales and Scotland in the 1840's. In 1854 the 1:2,500 scale was adopted for mapping urban areas; these maps were used to update the 1:10,560 maps. The published date given therefore is often some years later than the surveyed date. Before 1938, all OS maps were based on the Cassini Projection, with independent surveys of a single county or group of counties, giving rise to significant inaccuracies in outlying areas. In the late 1940's, a Provisional Edition was produced, which updated the 1:10,560 mapping from a number of sources. The maps appear unfinished - with all military camps and other strategic sites removed. These maps were initially overprinted with the National Grid. In 1970, the first 1:10,000 maps were produced using the Transverse Mercator Projection. The revision process continued until recently, with new editions appearing every 10 years or so for urban areas.

Map Name(s) and Date(s)

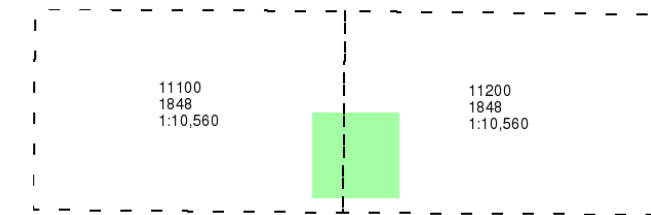

Historical Map - Slice A

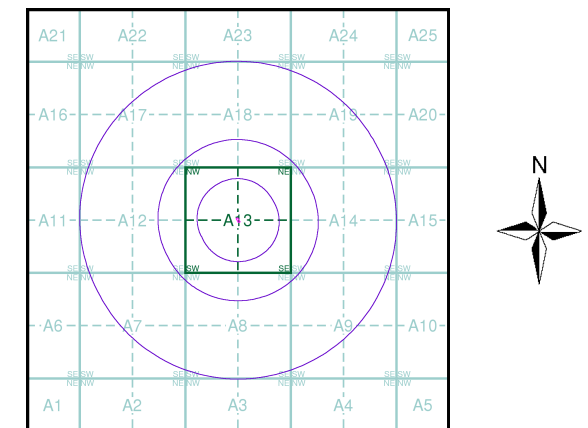

Order Details

Order Number: 321316062_1_1
Customer Ref: LKC 23 1319
National Grid Reference: 389560, 390460
Slice: A
Site Area (Ha): 0.04
Search Buffer (m): 1000

Site Details

51a, Great Underbank, Stockport, SK1 1NE



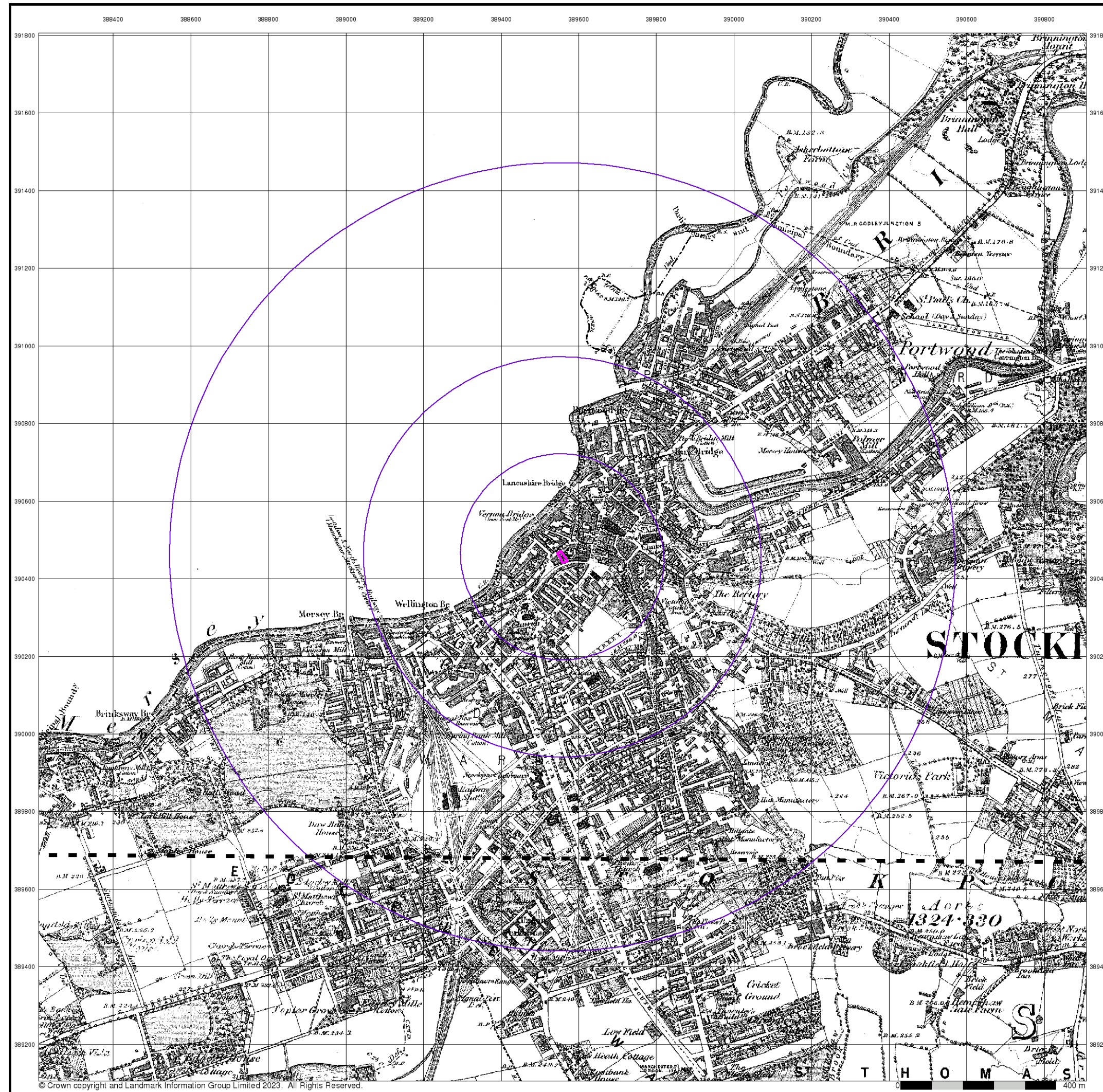

The historical maps shown were reproduced from maps predominantly held at the scale adopted for England, Wales and Scotland in the 1840's. In 1854 the 1:2,500 scale was adopted for mapping urban areas; these maps were used to update the 1:10,560 maps. The published date given therefore is often some years later than the surveyed date. Before 1938, all OS maps were based on the Cassini Projection, with independent surveys of a single county or group of counties, giving rise to significant inaccuracies in outlying areas. In the late 1940's, a Provisional Edition was produced, which updated the 1:10,560 mapping from a number of sources. The maps appear unfinished - with all military camps and other strategic sites removed. These maps were initially overprinted with the National Grid. In 1970, the first 1:10,000 maps were produced using the Transverse Mercator Projection. The revision process continued until recently, with new editions appearing every 10 years or so for urban areas.

Map Name(s) and Date(s)

01000	1882	1:10,560
01900	1882	1:10,560

Historical Map - Slice A

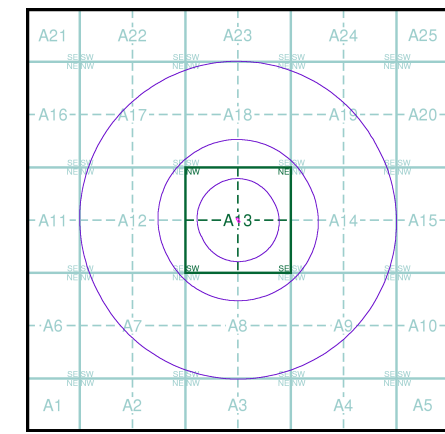

Order Details

Order Number: 321316062_1_1
 Customer Ref: LKC 23 1319
 National Grid Reference: 389560, 390460
 Slice: A
 Site Area (Ha): 0.04
 Search Buffer (m): 1000

Site Details

51a, Great Underbank, Stockport, SK1 1NE

The historical maps shown were reproduced from maps predominantly held at the scale adopted for England, Wales and Scotland in the 1840's. In 1854 the 1:2,500 scale was adopted for mapping urban areas; these maps were used to update the 1:10,560 maps. The published date given therefore is often some years later than the surveyed date. Before 1938, all OS maps were based on the Cassini Projection, with independent surveys of a single county or group of counties, giving rise to significant inaccuracies in outlying areas. In the late 1940's, a Provisional Edition was produced, which updated the 1:10,560 mapping from a number of sources. The maps appear unfinished - with all military camps and other strategic sites removed. These maps were initially overprinted with the National Grid. In 1970, the first 1:10,000 maps were produced using the Transverse Mercator Projection. The revision process continued until recently, with new editions appearing every 10 years or so for urban areas.

Map Name(s) and Date(s)

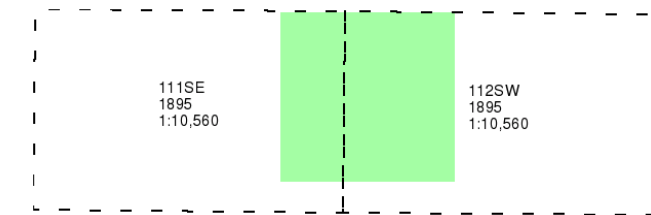

Historical Map - Slice A

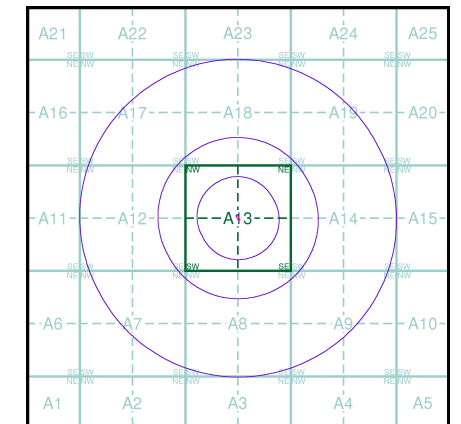

Order Details

Order Number: 321316062_1_1
Customer Ref: LKC 23 1319
National Grid Reference: 389560, 390460
Slice: A
Site Area (Ha): 0.04
Search Buffer (m): 1000

Site Details

51a, Great Underbank, Stockport, SK1 1NE

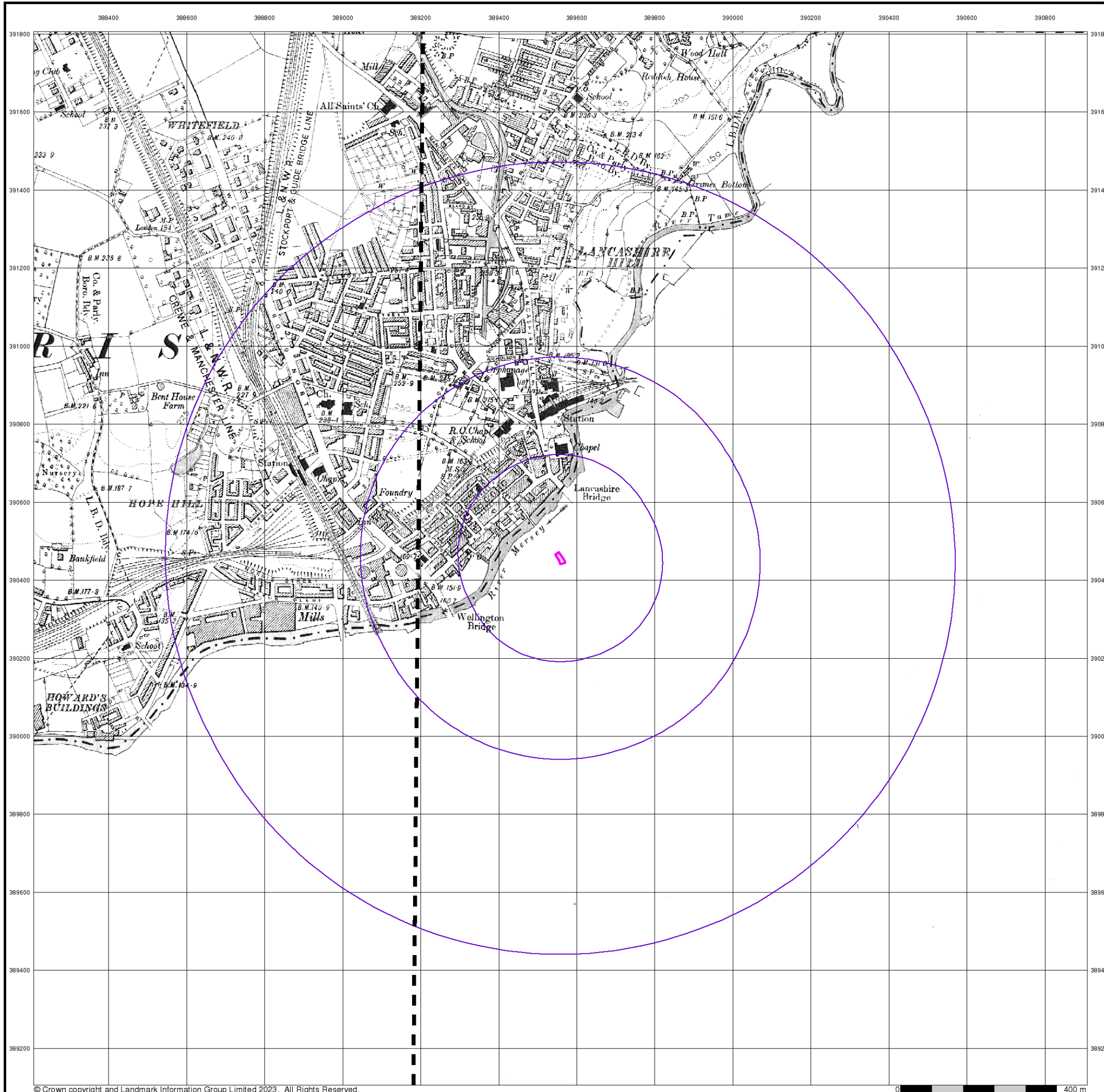

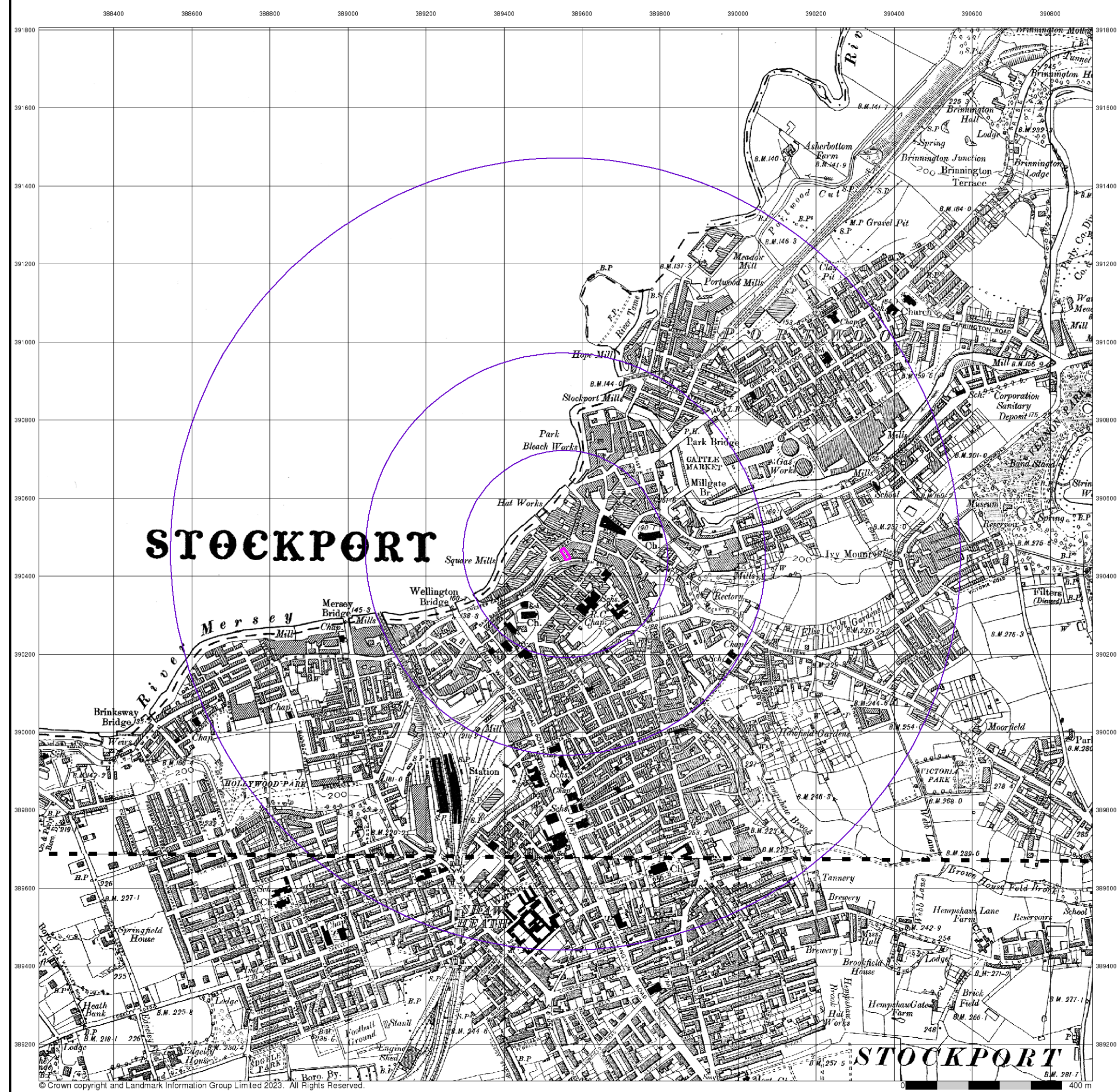

Published 1899
Source map scale - 1:10,560

The historical maps shown were reproduced from maps predominantly held at the scale adopted for England, Wales and Scotland in the 1840's. In 1854 the 1:2,500 scale was adopted for mapping urban areas; these maps were used to update the 1:10,560 maps. The published date given therefore is often some years later than the surveyed date. Before 1938, all OS maps were based on the Cassini Projection, with independent surveys of a single county or group of counties, giving rise to significant inaccuracies in outlying areas. In the late 1940's, a Provisional Edition was produced, which updated the 1:10,560 mapping from a number of sources. The maps appear unfinished - with all military camps and other strategic sites removed. These maps were initially overprinted with the National Grid. In 1970, the first 1:10,000 maps were produced using the Transverse Mercator Projection. The revision process continued until recently, with new editions appearing every 10 years or so for urban areas.

Map Name(s) and Date(s)

010SE	1899	1:10,560
019NE	1899	1:10,560

Historical Map - Slice A

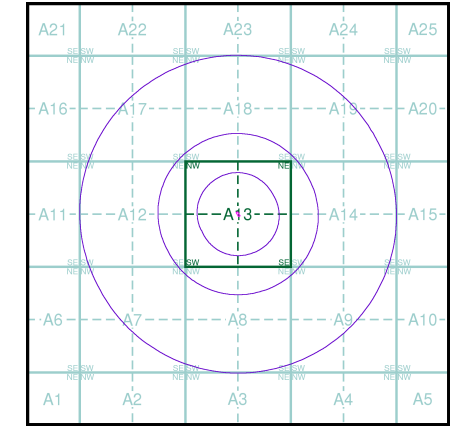

Order Details

Order Number: 321316062_1_1
 Customer Ref: LKC 23 1319
 National Grid Reference: 389560, 390460
 Slice: A
 Site Area (Ha): 0.04
 Search Buffer (m): 1000

Site Details

51a, Great Underbank, Stockport, SK1 1NE

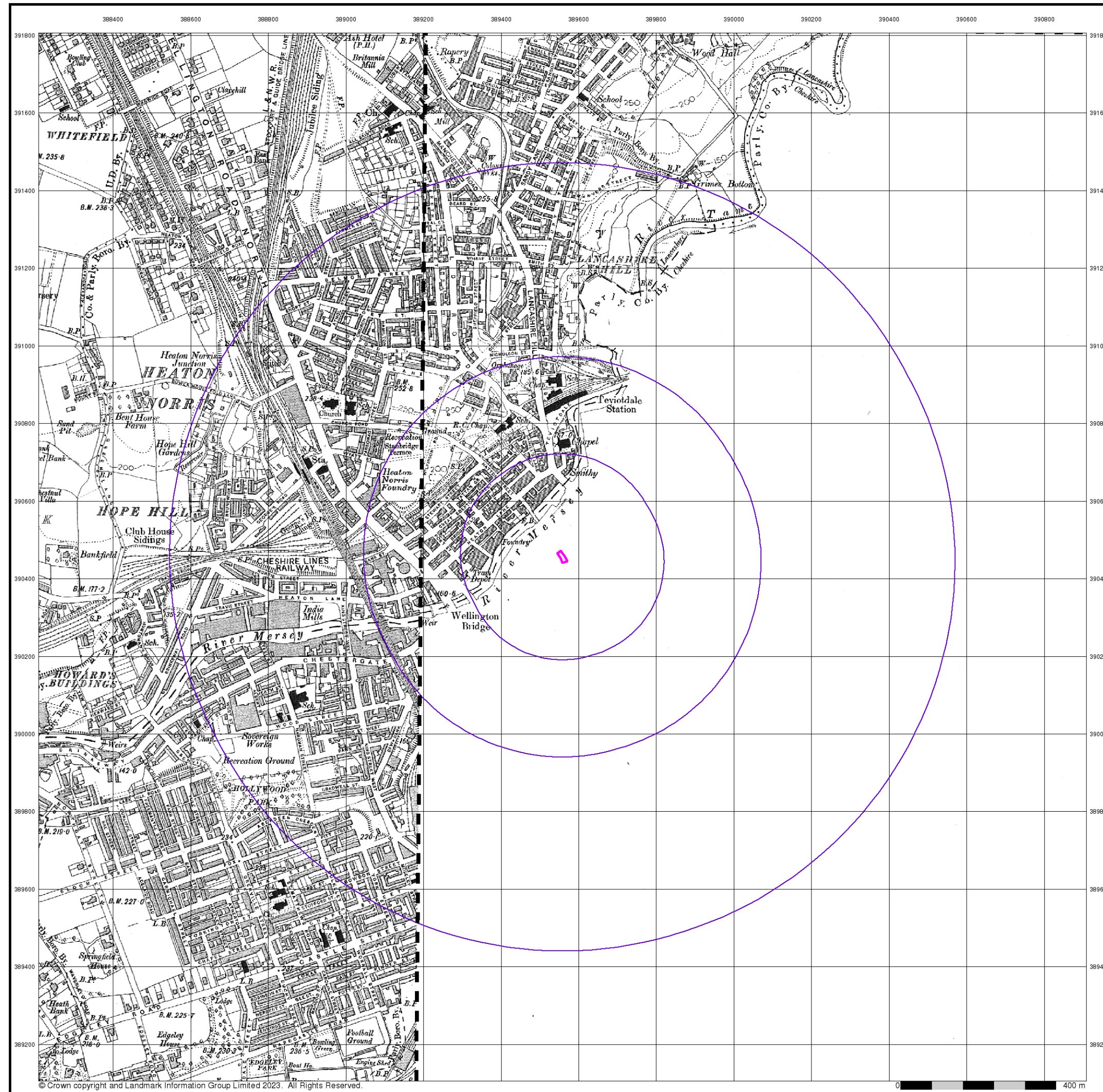

LK GROUP

Lancashire And Furness

Published 1910 - 1911

Source map scale - 1:10,560

The historical maps shown were reproduced from maps predominantly held at the scale adopted for England, Wales and Scotland in the 1840's. In 1854 the 1:2,500 scale was adopted for mapping urban areas; these maps were used to update the 1:10,560 maps. The published date given therefore is often some years later than the surveyed date. Before 1938, all OS maps were based on the Cassini Projection, with independent surveys of a single county or group of counties, giving rise to significant inaccuracies in outlying areas. In the late 1940's, a Provisional Edition was produced, which updated the 1:10,560 mapping from a number of sources. The maps appear unfinished - with all military camps and other strategic sites removed. These maps were initially overprinted with the National Grid. In 1970, the first 1:10,000 maps were produced using the Transverse Mercator Projection. The revision process continued until recently, with new editions appearing every 10 years or so for urban areas.

Map Name(s) and Date(s)

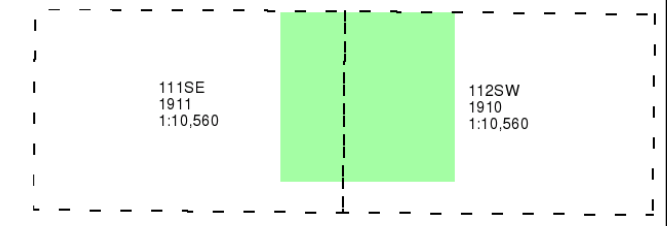

Historical Map - Slice A

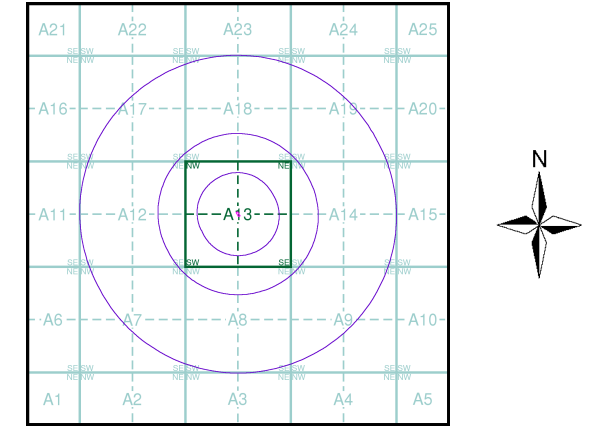

Order Details

Order Number: 321316062_1_1
 Customer Ref: LKC 23 1319
 National Grid Reference: 389560, 390460
 Slice: A
 Site Area (Ha): 0.04
 Search Buffer (m): 1000

Site Details

51a, Great Underbank, Stockport, SK1 1NE



GROUP

Cheshire

Published 1911

Source map scale - 1:10,560

The historical maps shown were reproduced from maps predominantly held at the scale adopted for England, Wales and Scotland in the 1840's. In 1854 the 1:2,500 scale was adopted for mapping urban areas; these maps were used to update the 1:10,560 maps. The published date given therefore is often some years later than the surveyed date. Before 1938, all OS maps were based on the Cassini Projection, with independent surveys of a single county or group of counties, giving rise to significant inaccuracies in outlying areas. In the late 1940's, a Provisional Edition was produced, which updated the 1:10,560 mapping from a number of sources. The maps appear unfinished - with all military camps and other strategic sites removed. These maps were initially overprinted with the National Grid. In 1970, the first 1:10,000 maps were produced using the Transverse Mercator Projection. The revision process continued until recently, with new editions appearing every 10 years or so for urban areas.

Map Name(s) and Date(s)

010SE
1911
1:10,560
019NE
1911
1:10,560

Historical Map - Slice A

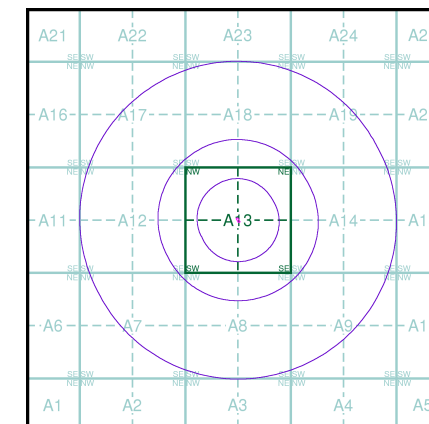

Order Details

Order Number: 321316062_1_1
 Customer Ref: LKC 23 1319
 National Grid Reference: 389560, 390460
 Slice: A
 Site Area (Ha): 0.04
 Search Buffer (m): 1000

Site Details

51a, Great Underbank, Stockport, SK1 1NE



Tel: 0844 844 9952
 Fax: 0844 844 9951
 Web: www.envirocheck.co.uk

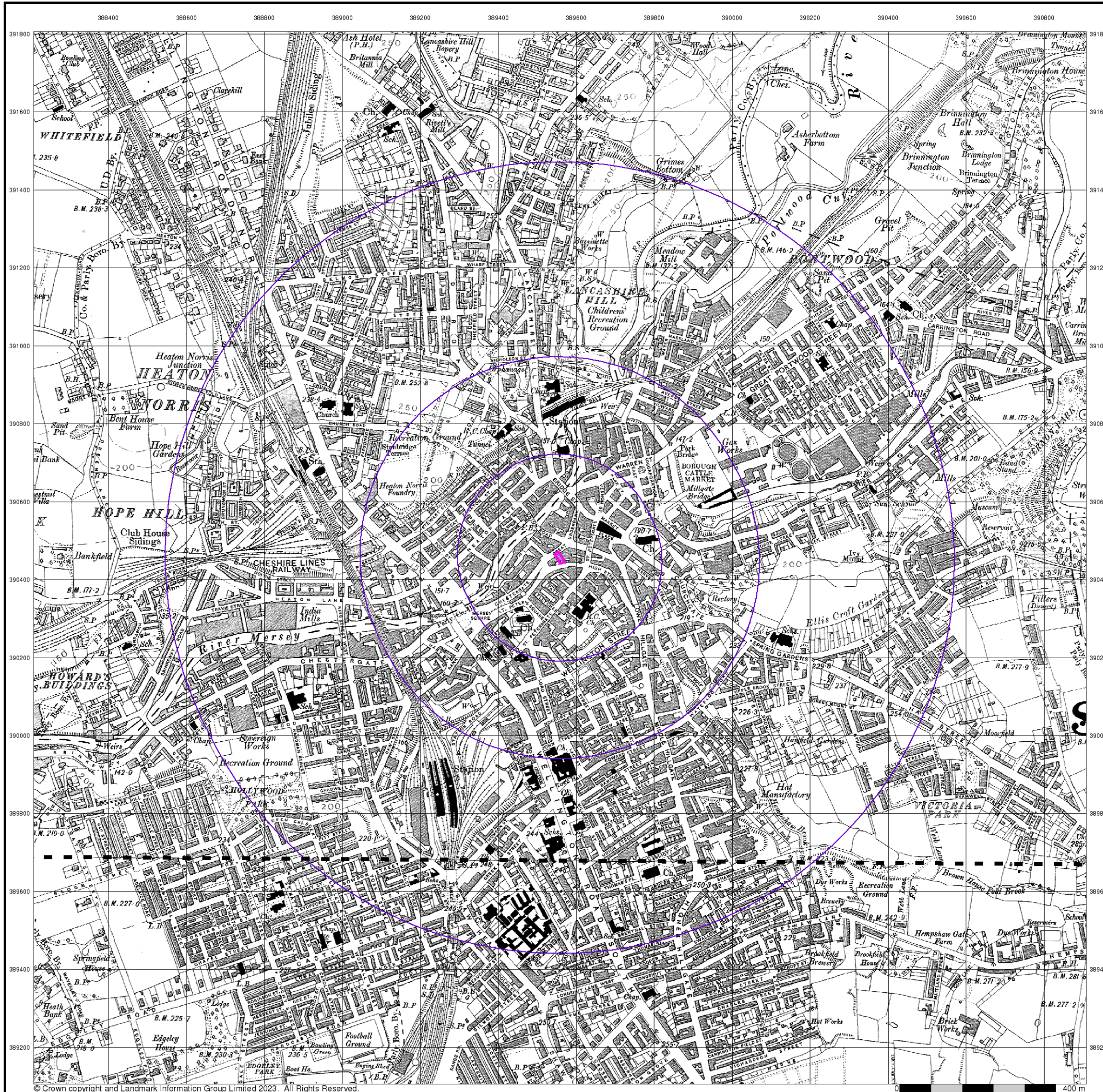

Published 1923

Source map scale - 1:10,560

The historical maps shown were reproduced from maps predominantly held at the scale adopted for England, Wales and Scotland in the 1840's. In 1854 the 1:2,500 scale was adopted for mapping urban areas; these maps were used to update the 1:10,560 maps. The published date given therefore is often some years later than the surveyed date. Before 1938, all OS maps were based on the Cassini Projection, with independent surveys of a single county or group of counties, giving rise to significant inaccuracies in outlying areas. In the late 1940's, a Provisional Edition was produced, which updated the 1:10,560 mapping from a number of sources. The maps appear unfinished - with all military camps and other strategic sites removed. These maps were initially overprinted with the National Grid. In 1970, the first 1:10,000 maps were produced using the Transverse Mercator Projection. The revision process continued until recently, with new editions appearing every 10 years or so for urban areas.

Map Name(s) and Date(s)

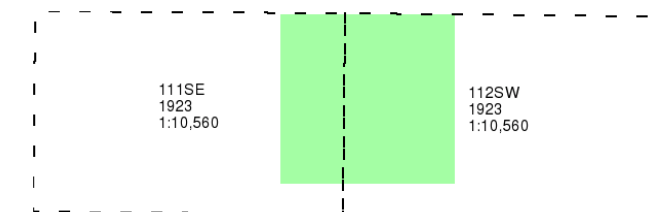

Historical Map - Slice A

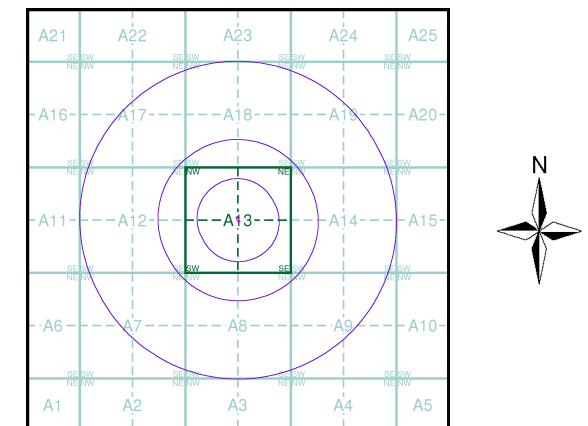

Order Details

Order Number: 321316062_1_1
Customer Ref: LKC 23 1319
National Grid Reference: 389560, 390460
Slice: A
Site Area (Ha): 0.04
Search Buffer (m): 1000

Site Details

51a, Great Underbank, Stockport, SK1 1NE

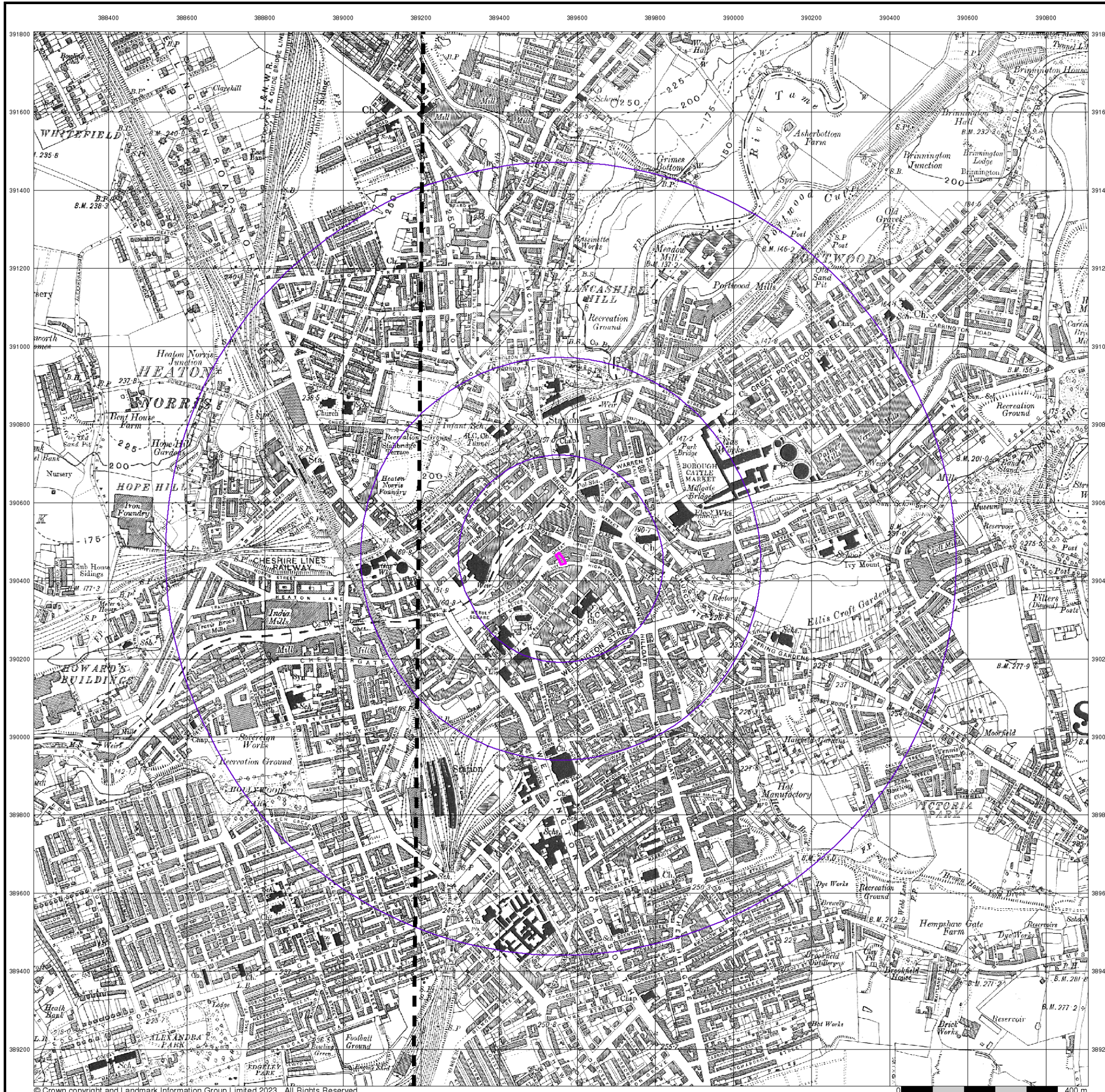

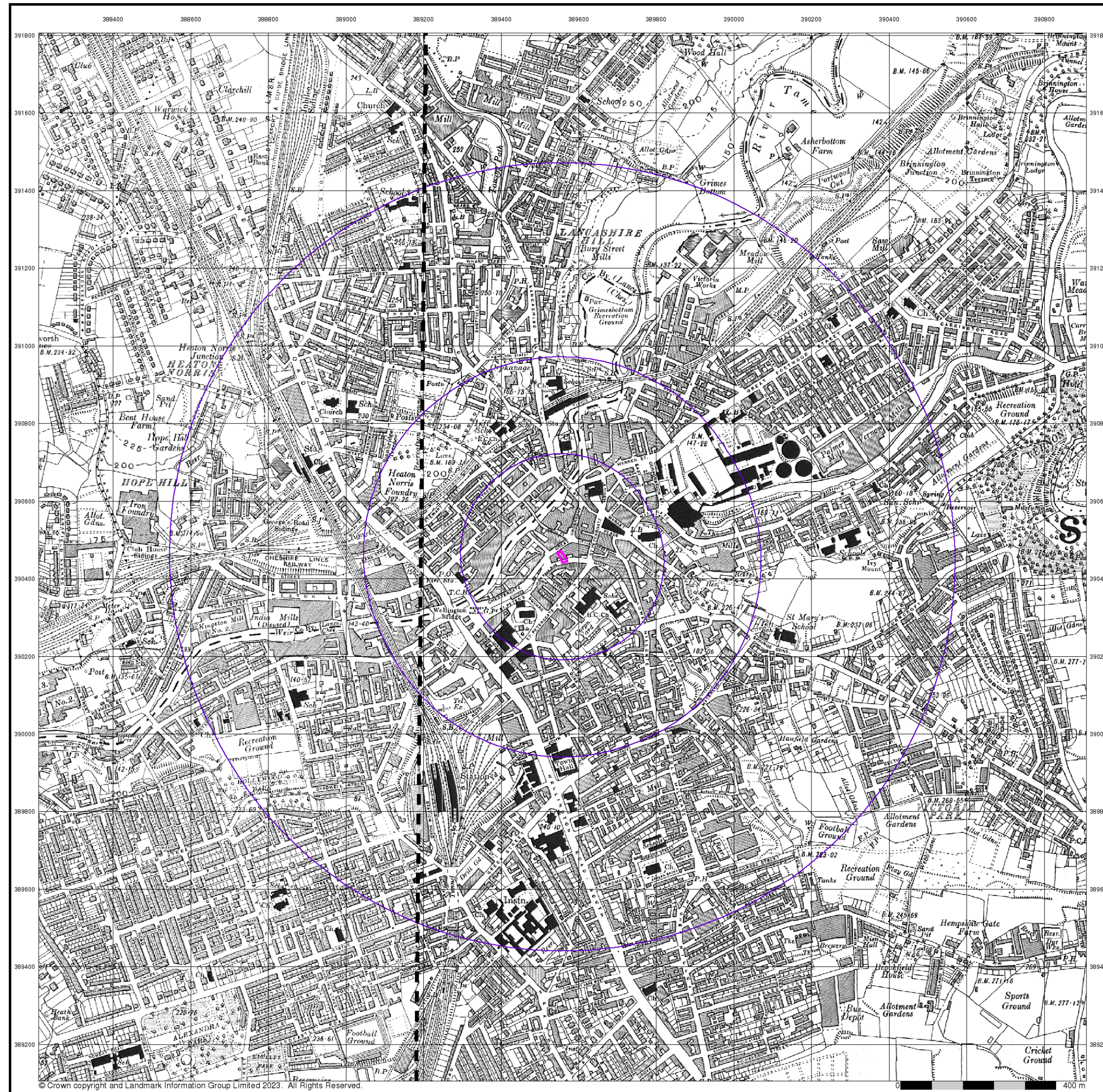

LK
GROUP
Lancashire And Furness
Published 1934
Source map scale - 1:10,560

The historical maps shown were reproduced from maps predominantly held at the scale adopted for England, Wales and Scotland in the 1840's. In 1854 the 1:2,500 scale was adopted for mapping urban areas; these maps were used to update the 1:10,560 maps. The published date given therefore is often some years later than the surveyed date. Before 1938, all OS maps were based on the Cassini Projection, with independent surveys of a single county or group of counties, giving rise to significant inaccuracies in outlying areas. In the late 1940's, a Provisional Edition was produced, which updated the 1:10,560 mapping from a number of sources. The maps appear unfinished - with all military camps and other strategic sites removed. These maps were initially overprinted with the National Grid. In 1970, the first 1:10,000 maps were produced using the Transverse Mercator Projection. The revision process continued until recently, with new editions appearing every 10 years or so for urban areas.

Map Name(s) and Date(s)

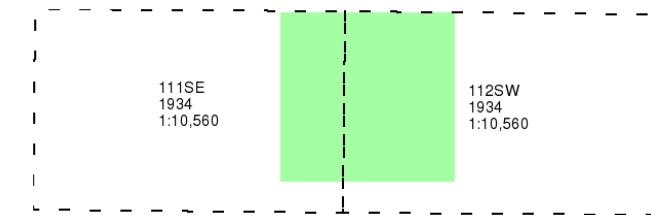

Historical Map - Slice A

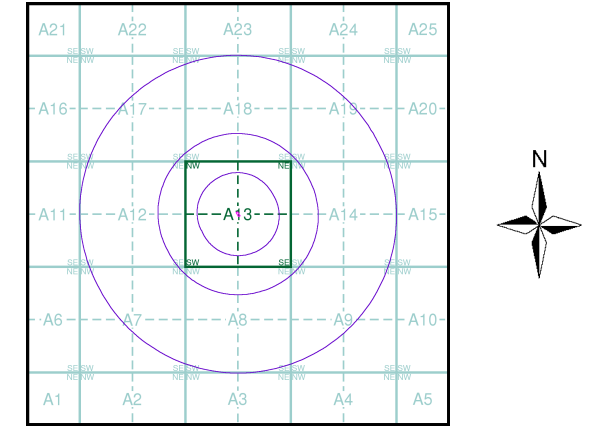

Order Details
 Order Number: 321316062_1_1
 Customer Ref: LKC 23 1319
 National Grid Reference: 389560, 390460
 Slice: A
 Site Area (Ha): 0.04
 Search Buffer (m): 1000

Site Details
 51a, Great Underbank, Stockport, SK1 1NE

Landmark
 INFORMATION GROUP
 Tel: 0844 844 9952
 Fax: 0844 844 9951
 Web: www.envirocheck.co.uk