

**HYDROBRAKE FLOWCONTROL TYPICAL DETAILS  
SEE DRAINAGE LAYOUT AND MANHOLE SCHEDULES  
SCALE 1:20**

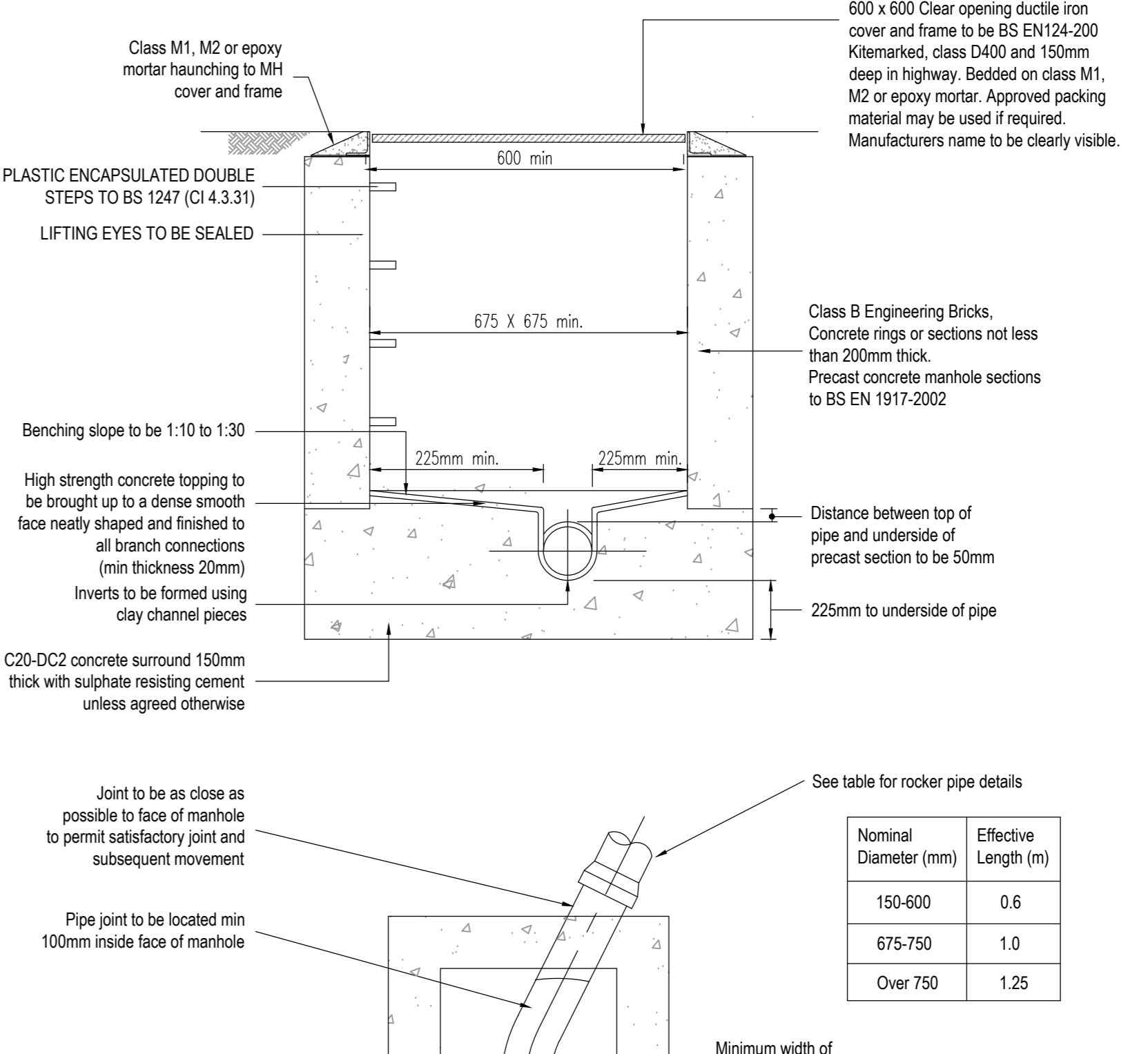
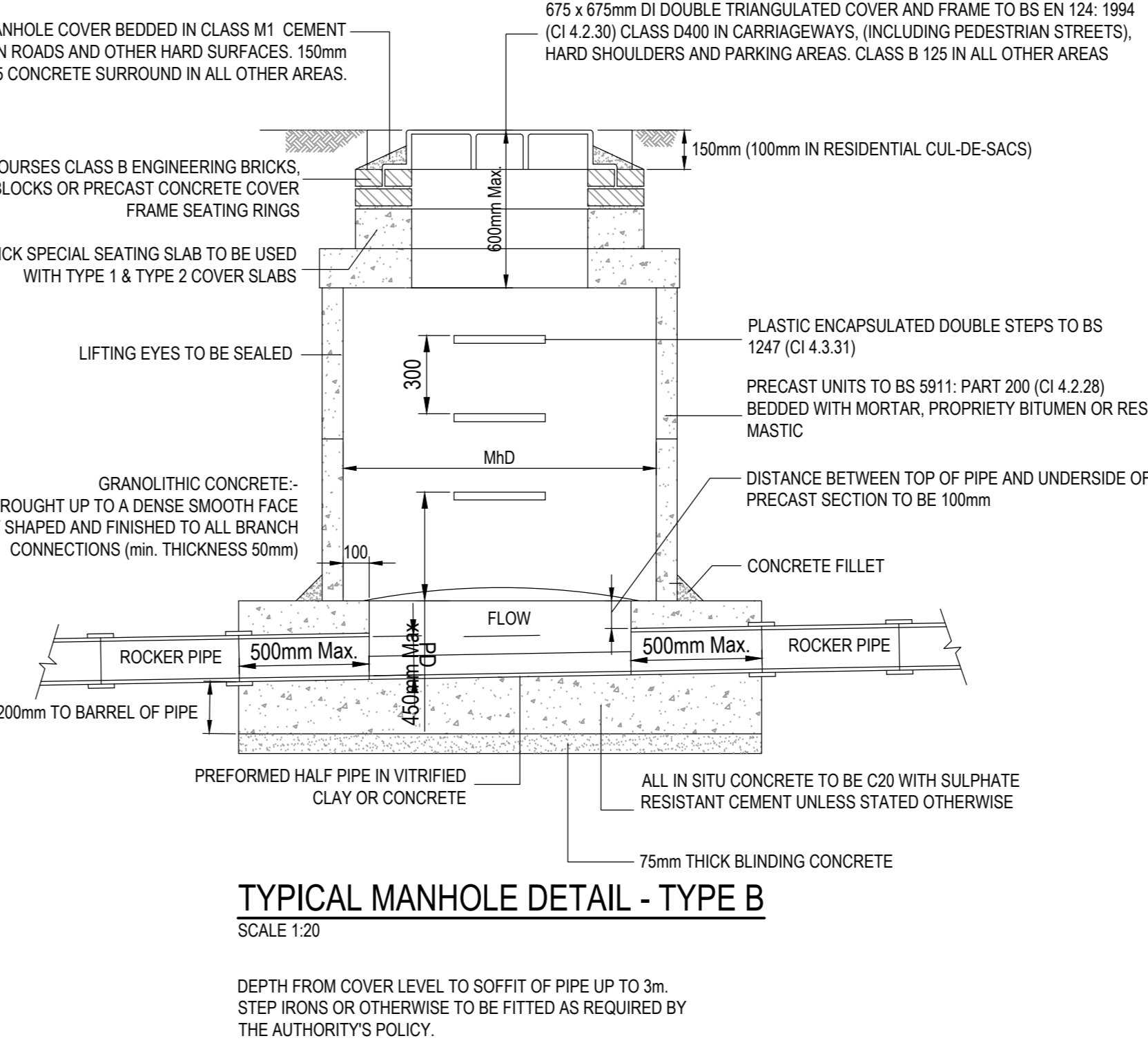
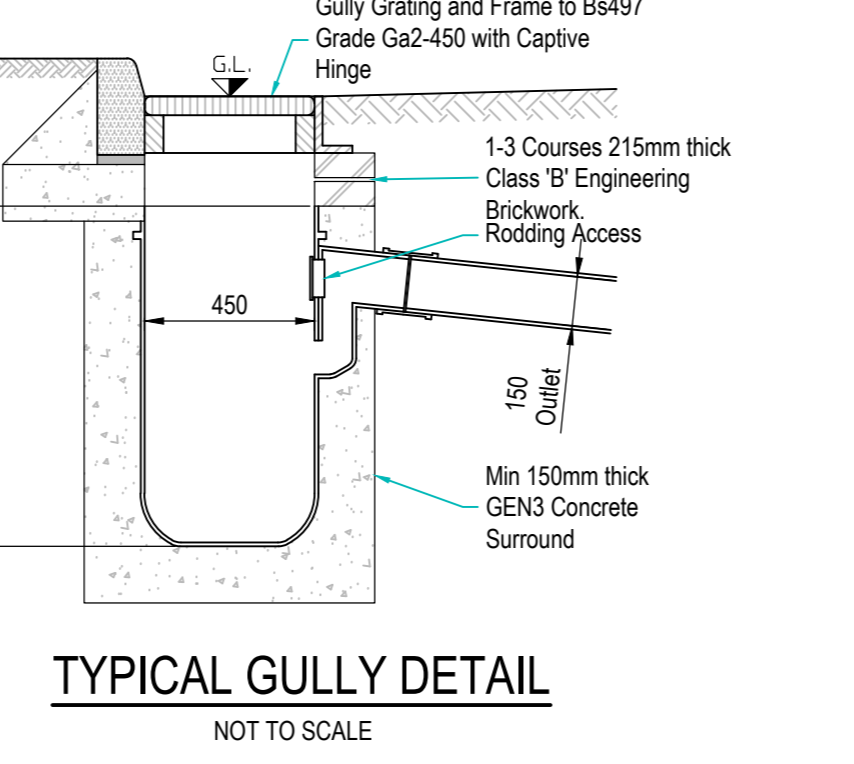
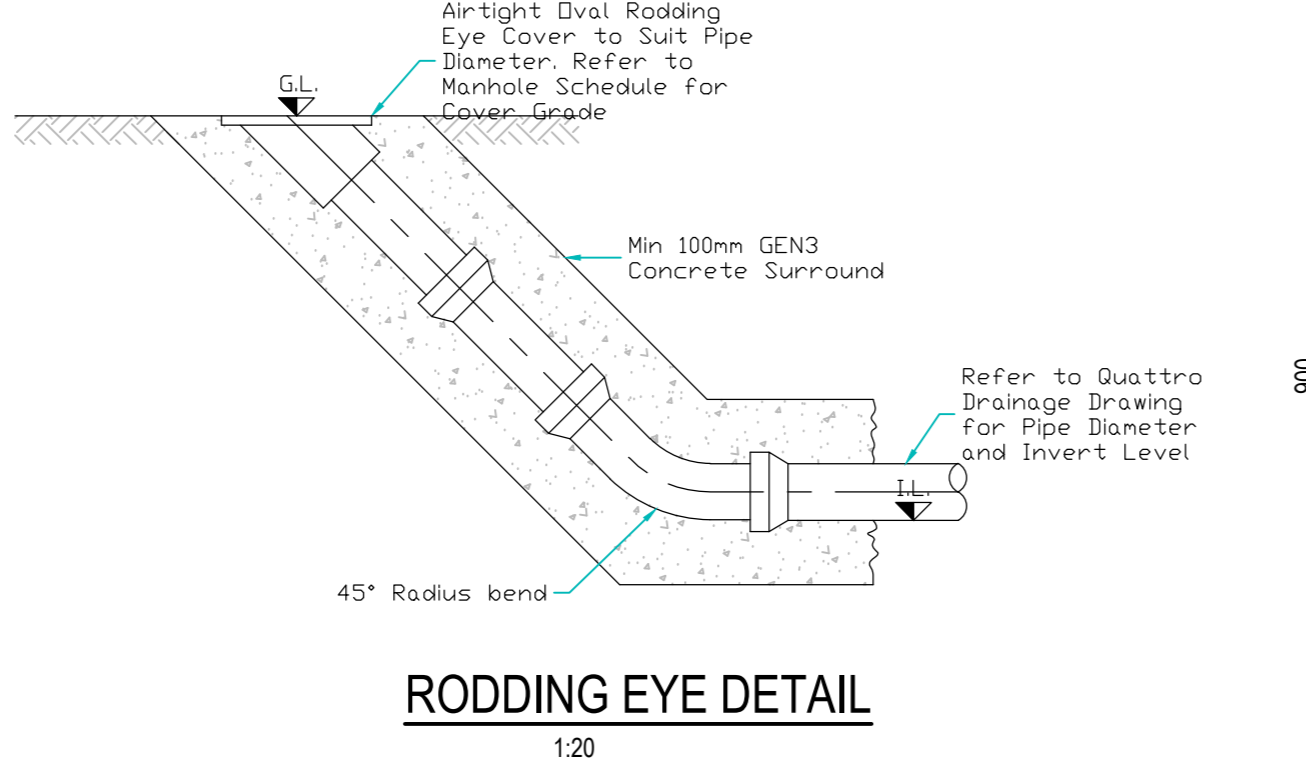
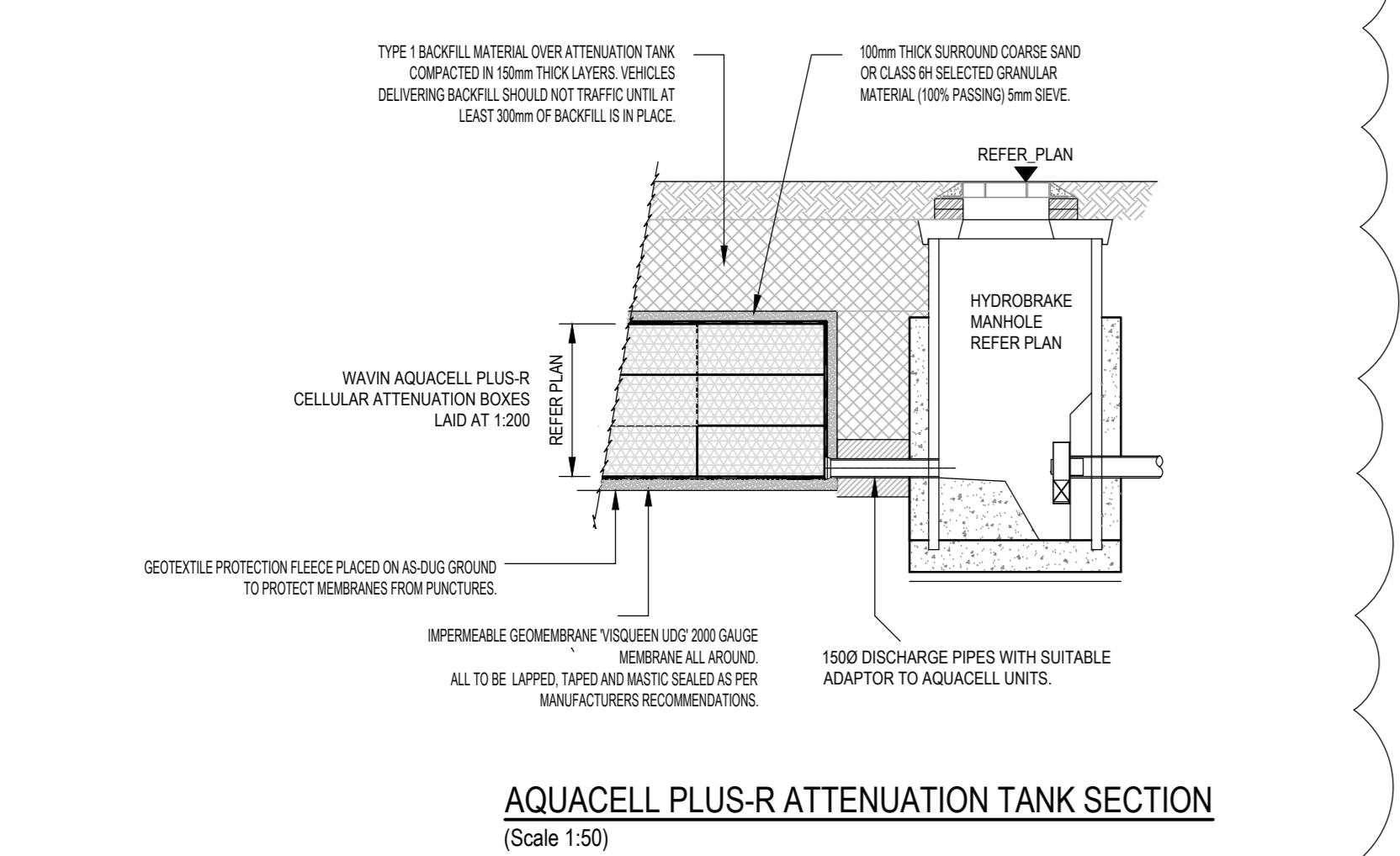

**MANHOLE DIMENSIONS**

DIAMETER OF LARGEST PIPE IN MANHOLE (mm)	INTERNAL DIAMETER OF MANHOLE (mm)
LESS THAN 375	1200
375 - 450	1350
450 - 700	1500

**NOTES:**

- ALL MANHOLES WITH PIPE DIAMETERS EXCEEDING 450mm SHALL BE FITTED WITH SAFETY CHAINS ON THE DOWNSTREAM RUN.
- BURIED MANHOLES - COVERS TO BE SET BELOW GROUND LEVEL (600mm IN FIELDS AND 300mm IN GARDENS) AND COVERED WITH A SHEET OF HEAVY DUTY POLYETHYLENE HELD IN PLACE WITH WATERPROOF PROTECTIVE TAPE.
- SELF CLEANING TOE HOLES TO BE PROVIDED WHERE CHANNELS EXCEED 600mm WIDE.

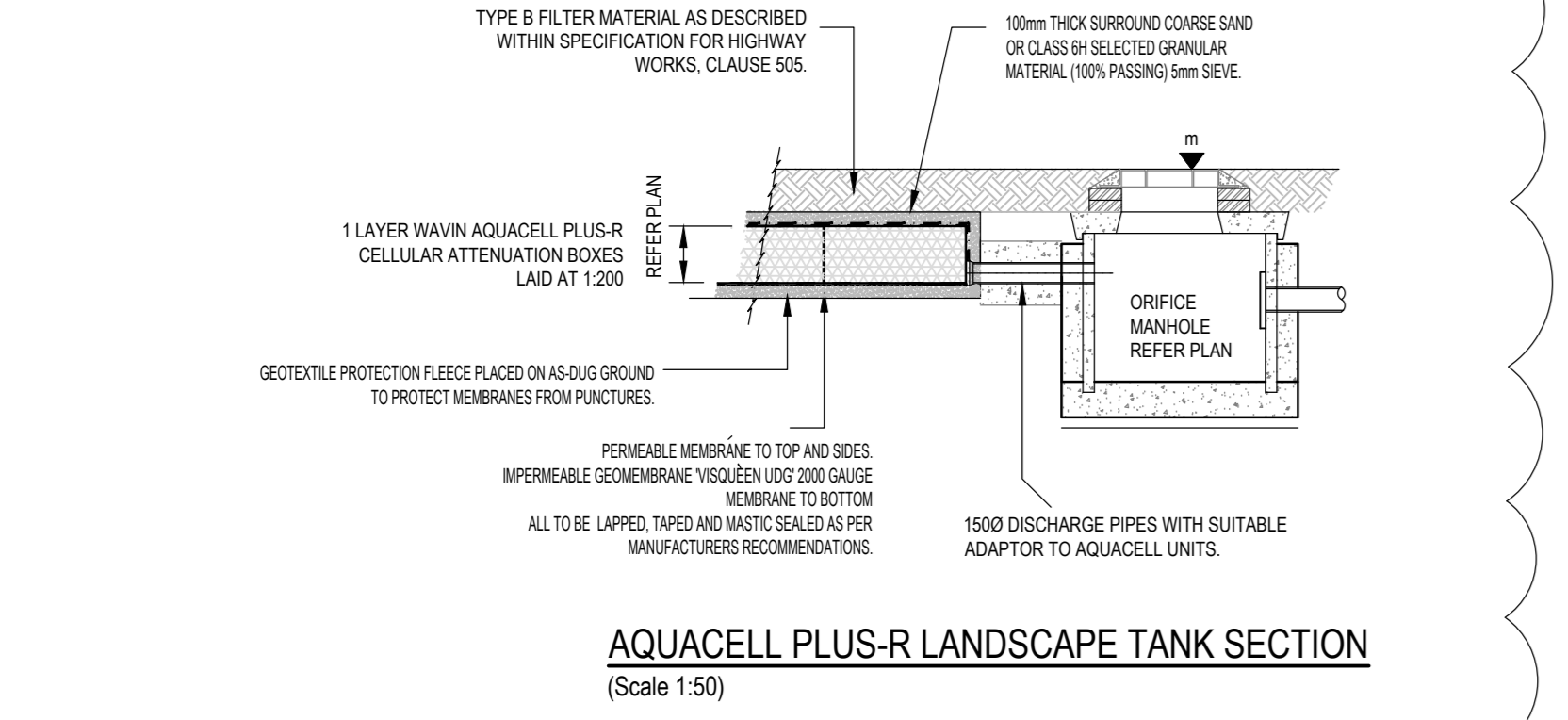

**TYPICAL CLASS B BEDDING DETAIL FOR RIGID PIPEWORK (SCALE 1:20)**

**TYPICAL CLASS B BEDDING DETAIL FOR FLEXIBLE PIPEWORK (NOT TO SCALE)**

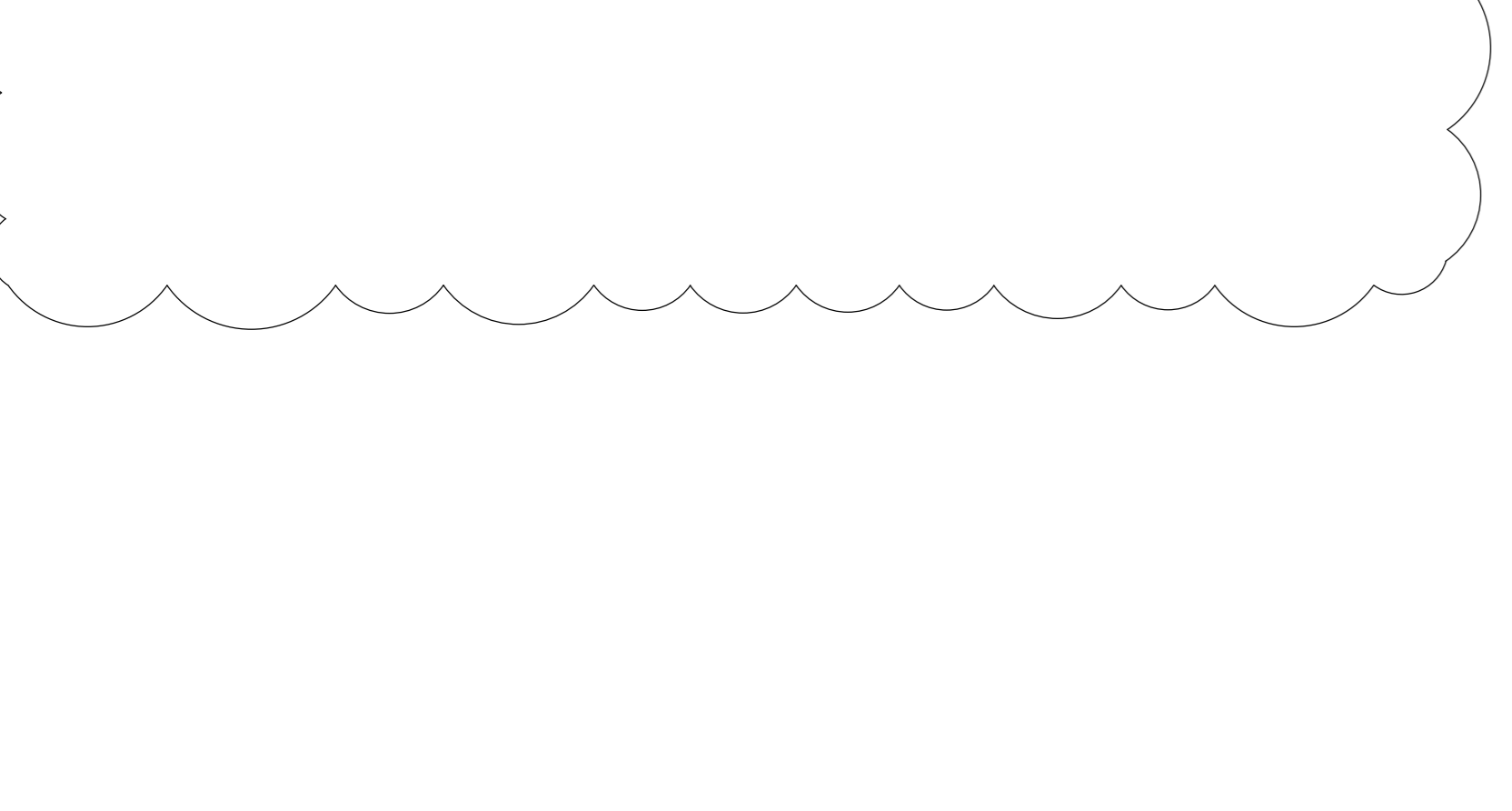
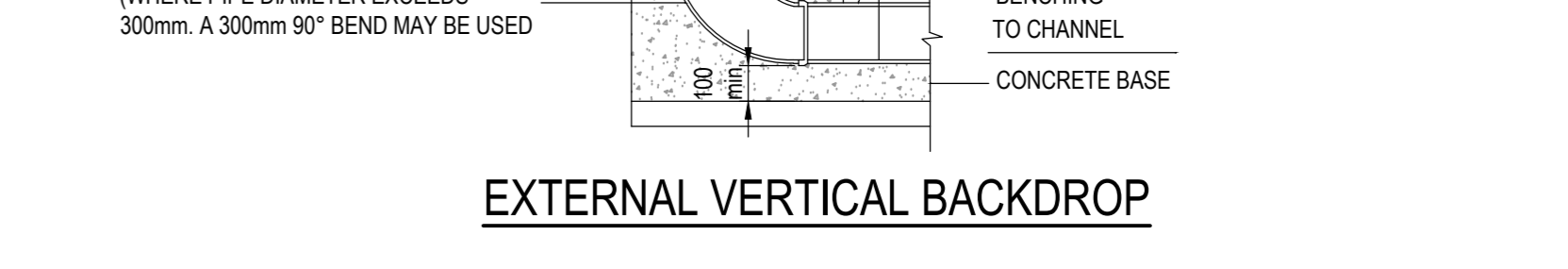
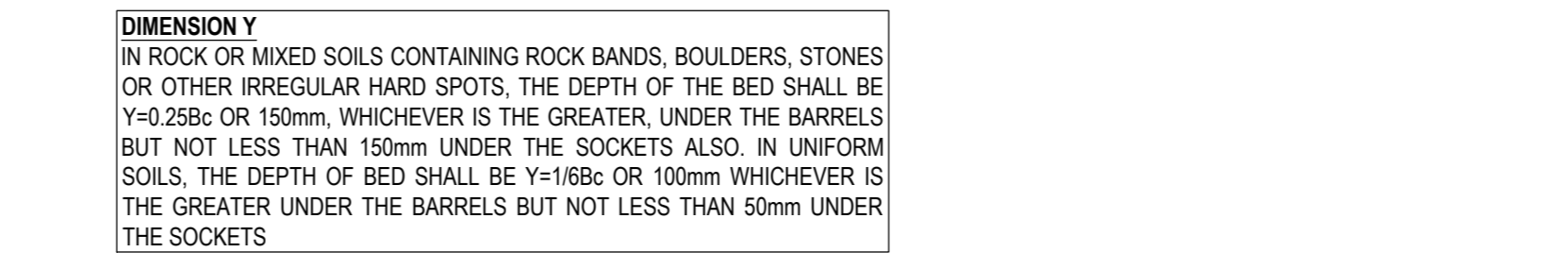
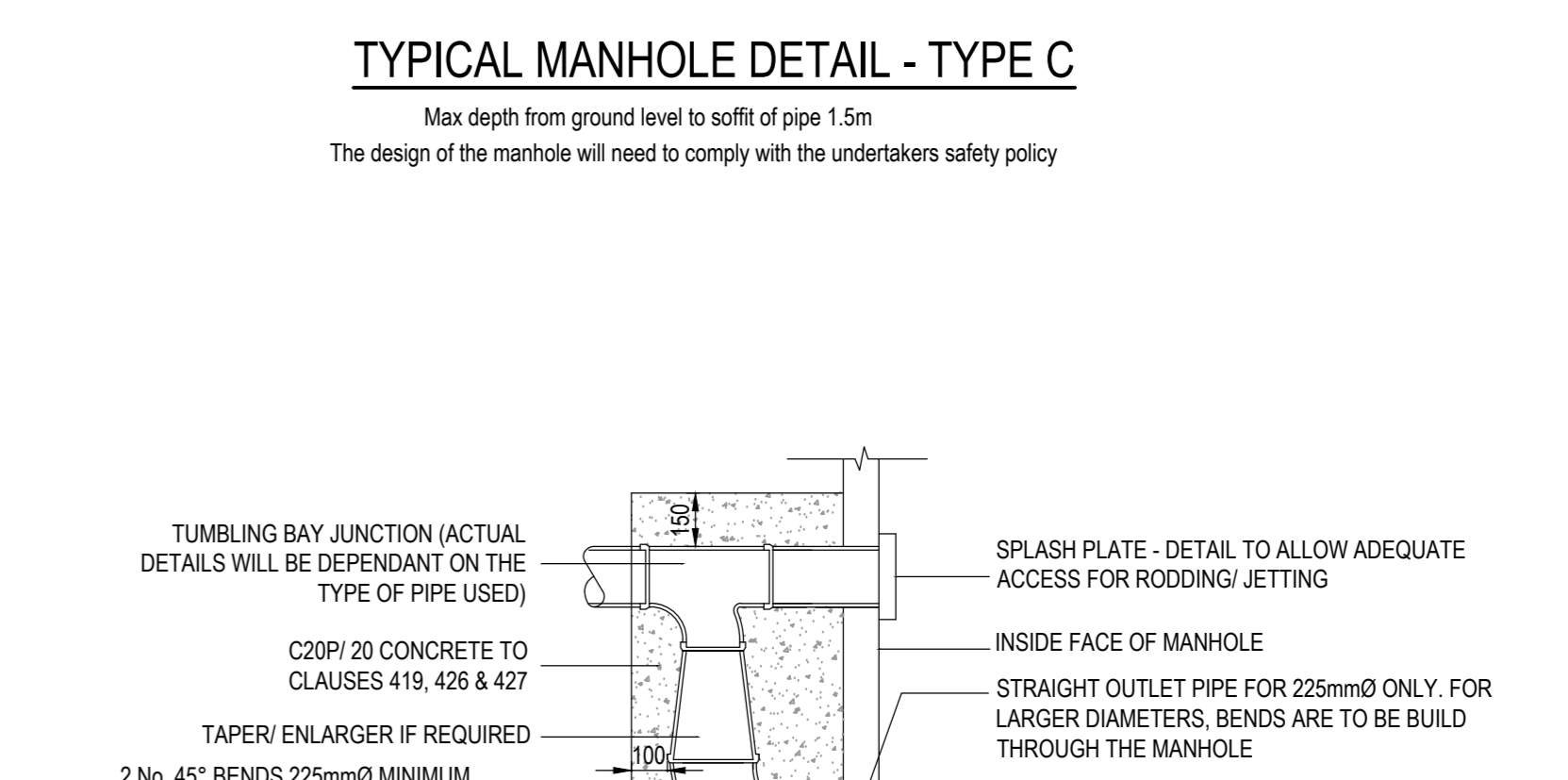
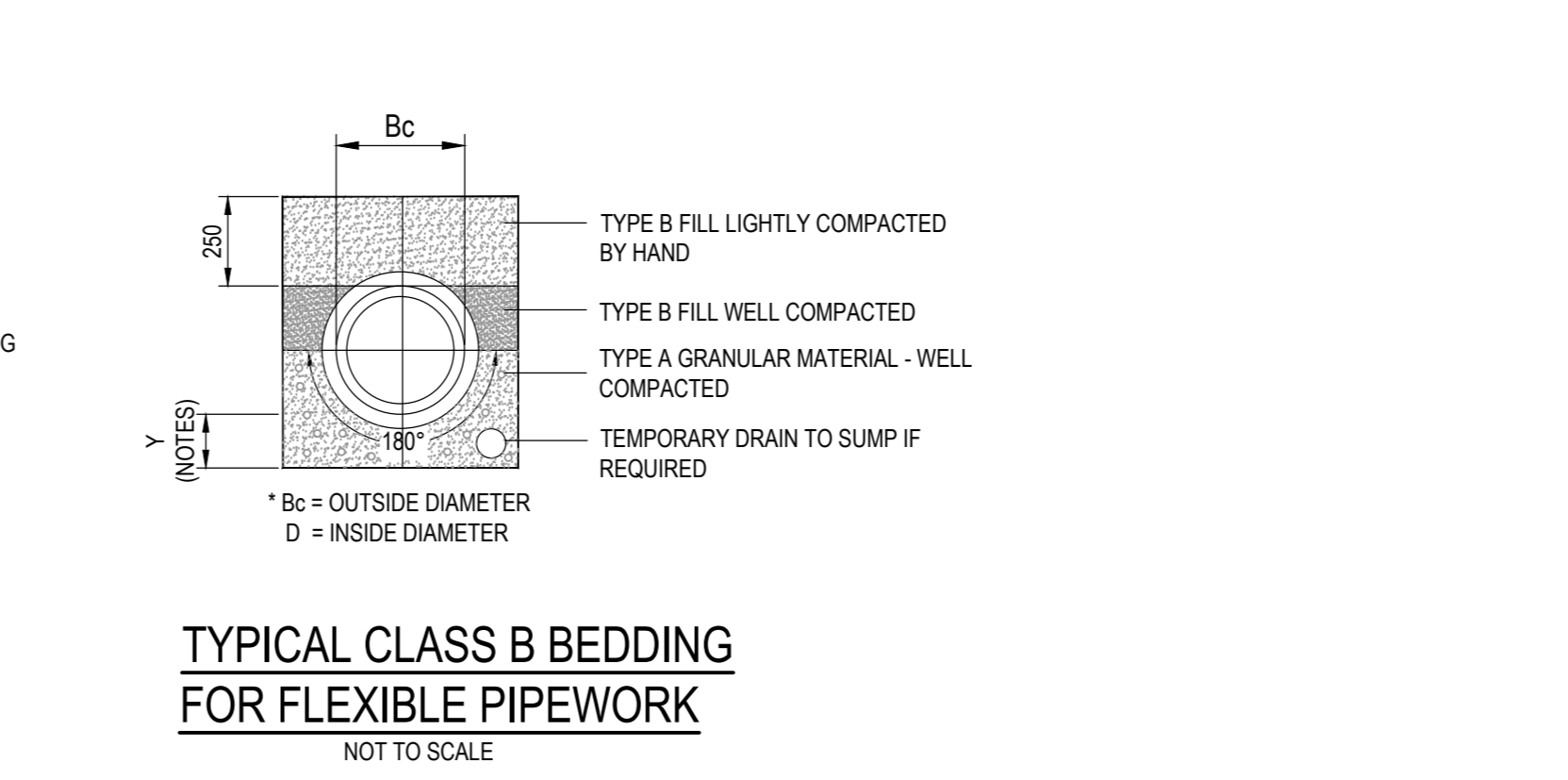

**TYPICAL CLASS B BEDDING DETAIL FOR RIGID PIPEWORK (SCALE 1:20)**

**TYPICAL CLASS B BEDDING DETAIL FOR FLEXIBLE PIPEWORK (NOT TO SCALE)**

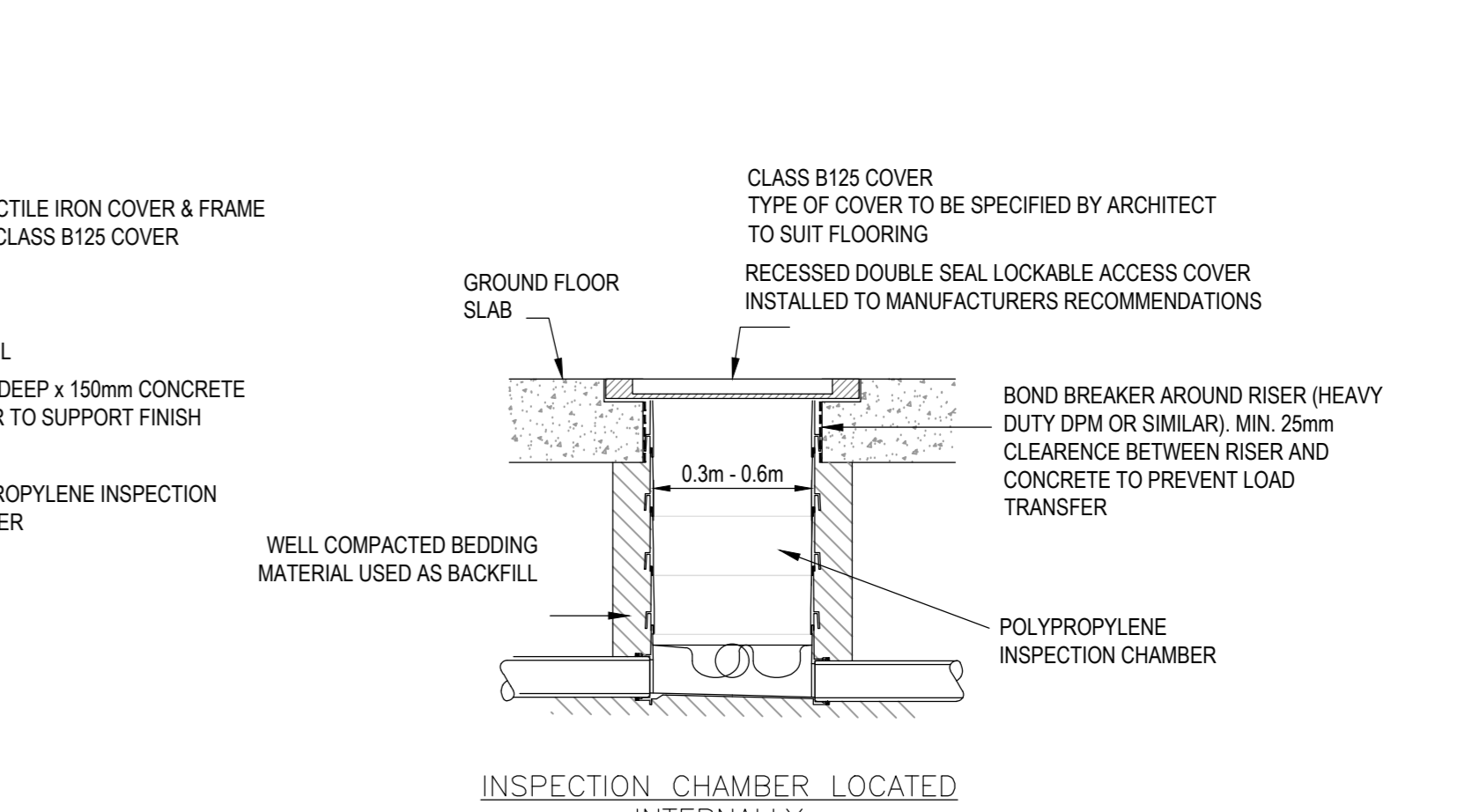
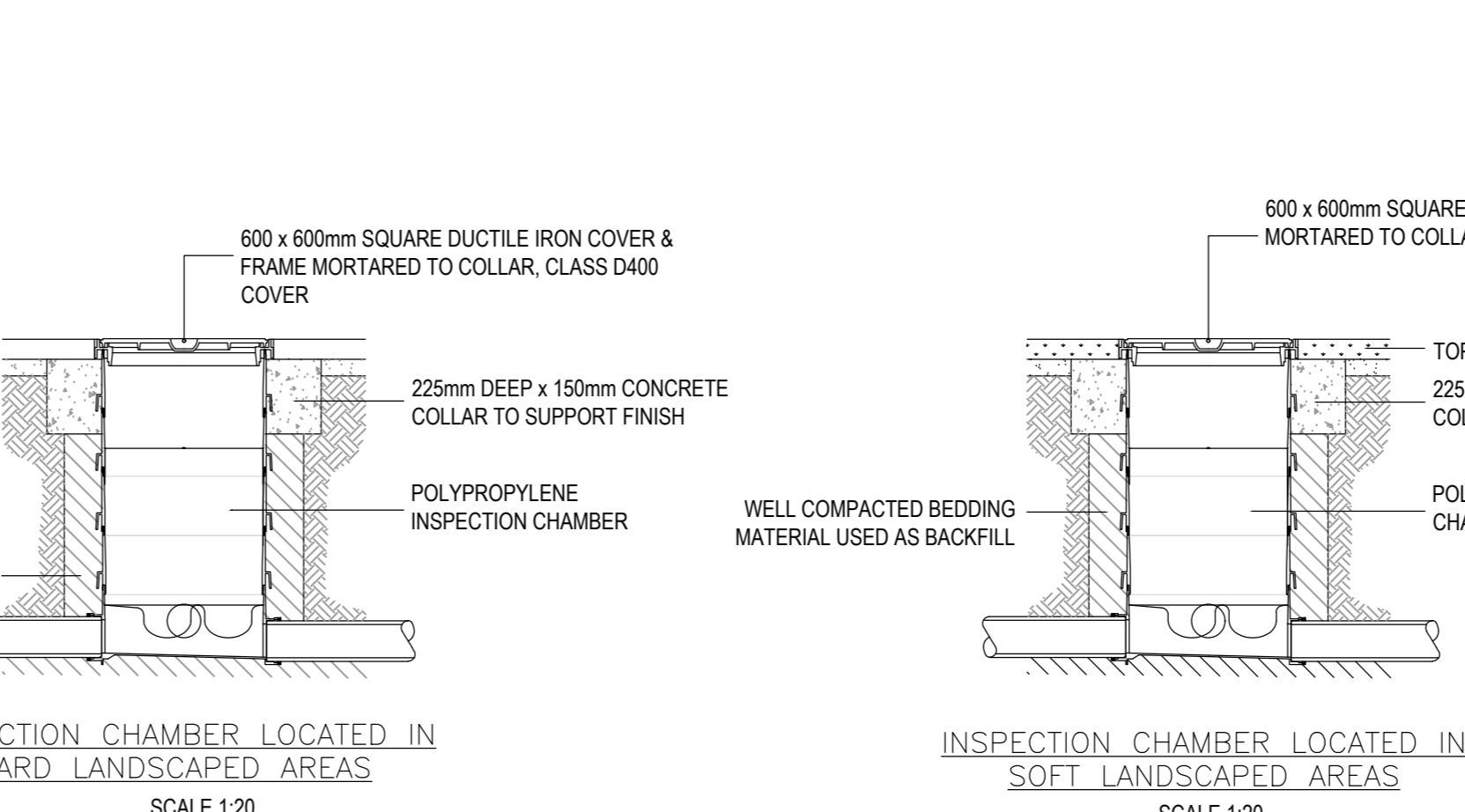

- NOTES**
- WHERE POOR GROUND CONDITIONS ARE ENCOUNTERED, GUIDANCE ON THE DEPTH & TYPE OF BEDDING SHALL BE SOUGHT FROM THE AUTHORITY INSPECTOR.
  - COMMENCING SURFACE SHALL BE:
    - IN EXISTING ROADS - LEVEL AFTER REMOVAL OF SURFACING/ROADBASE
    - IN PROPOSED ROADS - 300mm BELOW PROPOSED FINISHED ROAD LEVEL
    - IN ARABLE AND GRASS LAND - LEVEL AFTER STRIPPING OF TOPSOIL
    - IN WASTE GROUND - ORIGINAL GROUND LEVELS
  - MINIMUM COVER TO PIPE 1.2m WHERE VEHICLE LOADING WILL OCCUR 0.9m IN ALL OTHER LOCATIONS. WHERE MINIMUM COVER CANNOT BE ACHIEVED, CONCRETE PROTECTION MUST BE PROVIDED.

**NOTES**

- DO NOT SCALE FROM THIS DRAWING.
- THIS DRAWING TO BE READ IN CONJUNCTION WITH RELEVANT ARCHITECTS AND ENGINEERS DRAWINGS.
- ANY REFERENCES OR CROSSINGS IN THE CONTRACT DOCUMENTS AND ENGINEERS DRAWINGS TO BE BROUGHT TO THE ATTENTION OF BOTH THE ENGINEER AND ARCHITECT IMMEDIATELY BY THE CONTRACTOR OR BOTH THE ENGINEER AND ARCHITECT IMMEDIATELY IF THE CONTRACTOR DOES NOT UNDERSTAND ANY PART OF THESE DRAWINGS/DRAWINGS. THE CONTRACTOR SHALL BE RESPONSIBLE IMMEDIATELY TO THE CONTRACTOR TO KEEP A RECORD OF ANY VARIATIONS MADE ON SITE SO THAT 'AS BUILT' DRAWINGS CAN BE PREPARED UPON COMPLETION OF THE WORKS. ALL VARIATIONS TO BE AGREED WITH THE ENGINEER AND THE RELEVANT APPROVALS BE IN PLACE.
- ANY WORKS BEING CARRIED OUT PRIOR TO THE RELEVANT APPROVALS BEING IN PLACE SHALL BE AT THE CONTRACTOR'S RISK.
- WORKS TO BE CARRIED OUT IN ACCORDANCE WITH THE SPECIFICATION FOR HIGHWAY WORKS LATEST EDITION AND ALL OTHER RELEVANT GUIDANCE.
- SITE FERMETAL LEVELS TO BE CHECKED AND VERIFIED BY CONTRACTOR WITH EXISTING BOUNDARY AND LEVELS PRIOR TO STARTING ON SITE.
- ALL LEVELS OF EXISTING DRAINAGE TO BE CHECKED BY CONTRACTOR IN ADVANCE OF STARTING ON SITE AND REPORTED TO THE RELEVANT APPROVALS IMMEDIATELY AND ENGINEER IMMEDIATELY.
- ALL DRAINAGE TO BE CONSTRUCTED IN ACCORDANCE WITH THE LATEST EDITION OF THE CODE FOR SEWERS FOR ADOPTION, BS EN 752: DRAIN AND SEWER SYSTEMS OUTSIDE BUILDINGS AND BE IN 150mm GRAVITY DRAINAGE SYSTEMS UNLESS OTHERWISE STATED.
- ALL ATTENUATION CELLS TO BE WITHIN AQUACELL OR EQUAL APPROVED. INSTALLED IN ACCORDANCE WITH MANUFACTURERS RECOMMENDATIONS.
- ALL FLOW CONTROLS TO BE HYDRO INTERNATIONAL HYDRO BRAKE OPTIMUM (AS SPECIFIED) INSTALLED IN ACCORDANCE WITH MANUFACTURERS RECOMMENDATIONS OR EQUAL APPROVED.
- POSSIBLE FLOODING RISKS TO BE TAKEN INTO ACCOUNT TO ALL OUTLET LOCATIONS.
- ALL MANHOLES SUBJECT TO VEHICLE LOADINGS TO HAVE DAY GRADE COVERS. THE DETAILS OF SURFACE FINISH DESIGN WILL REFER TO THE SMP'S ROAD APPROACH AS REQUIRED BY CIRA C231 AND WILL PREVENT ANY UNTREATED RUNOFF FROM ENTERING THE WATERCOURSE. SEWERS FROM MANHOLES HAVE A NEGATIVE IMPACT ON THE RECEIVING WATER QUALITY.
- POSSIBLE FLOODING RISKS TO BE TAKEN INTO ACCOUNT TO ALL OUTLET LOCATIONS.
- ALL PRIVATE DRAINAGE FROM ROOFS/SPILLIERS TO BE DISCONNECTED FROM THE SEWER INLET. DA INSTALLED TO MANUFACTURERS RECOMMENDATIONS.
- ALL PRIVATE DRAINAGE FROM ROOFS/SPILLIERS TO BE DISCONNECTED FROM THE SEWER INLET. DA INSTALLED TO MANUFACTURERS RECOMMENDATIONS.
- FOR SURFACE FINISHES REFER TO LANDSCAPE ARCHITECTS LATEST DRAWINGS SETTING OUT OF ALL DOWNPIPS TO CONCRETE DETAILS.

**CONSTRUCTION STATUS ISSUE**

NOTE: DRAWING SUBJECT TO CONTRACTED DESIGN COORDINATION AND IS SUBJECT TO RECEIPT OF CONTRACT STATUS ARCHITECTURAL AND LANDSCAPE ARCHITECTURAL INFORMATION TO ALLOW CORRELATION OF CURB/TALLESS DESIGN. DRAWING HAS BEEN ISSUED AT CONSTRUCTION STATUS FURTHER TO DIRECT INSTRUCTION/APPROVAL FOR ISSUE AT CONSTRUCTION STATUS BY AXCEL (15/05/2023).

DRAWING REMAINS SUBJECT TO COMMENT APPROVAL BY ALL STATUTORY AUTHORITIES AND MAY BE REQUIRED TO BE AMENDED TO SUIT THIS PROCESS.

**IMPORTANT HEALTH, SAFETY & ENVIRONMENTAL INFORMATION**

IN ADDITION TO THE HAZARDS AND RISKS NORMALLY ASSOCIATED WITH THE TYPE OF WORK DETAILED ON THIS DRAWING, PLEASE NOTE THE FOLLOWING ADDITIONAL RISKS TO HEALTH AND SAFETY:

**CONSTRUCTION PHASE:-**

- DUE CARE AND ATTENTION TO BE GIVEN TO EXISTING PUBLIC & EXISTING UTILITIES IN AND AROUND THE SITE.
- CONTRACTOR IS RESPONSIBLE FOR CONFIRMING THE LOCATION AND DEPTH OF ALL EXISTING UTILITIES PRIOR TO THE COMMENCEMENT OF WORK.
- CONTRACTOR IS RESPONSIBLE FOR PROTECTING/DIVERTING ALL EXISTING UTILITIES IN ACCORDANCE WITH THE RELEVANT UTILITY PROVIDER'S GUIDELINES.

**MAINTENANCE/DEMOLITION:-**

IT IS ASSUMED THAT ALL WORKS WILL BE CARRIED OUT BY A COMPETENT CONTRACTOR WORKING, WHERE APPROPRIATE, TO AN APPROVED METHOD STATEMENT.

REV	DETAILS ADDED	AT	GD	GD	20/11/23
001	FIRST ISSUE	AT	GD	GD	12/05/23



38 Thistle Street • Edinburgh • EH2 1EN  
Tel: 0115 220 6666  
Email: quattro@quattroconsult.co.uk

**AXCEL HOSPITALITY (YORK) Ltd.**

**BANANA WAREHOUSE, YORK**

**DRAINAGE DETAILS**

**CONSTRUCTION**

DRAWN	AT	CHECKED	GD	APPROVED	GD
DATE	12.05.23	DATE	12.05.23	DATE	12.05.23
DRAWING SCALE	1:100	ORIGINAL DRAWING SCALE	1189 x 841 - A0		
DRAWING No.	4488-QCL-XX-XX-DR-C-5205	REV.	C02		