

PROPOSED NEW WALL & FENCING

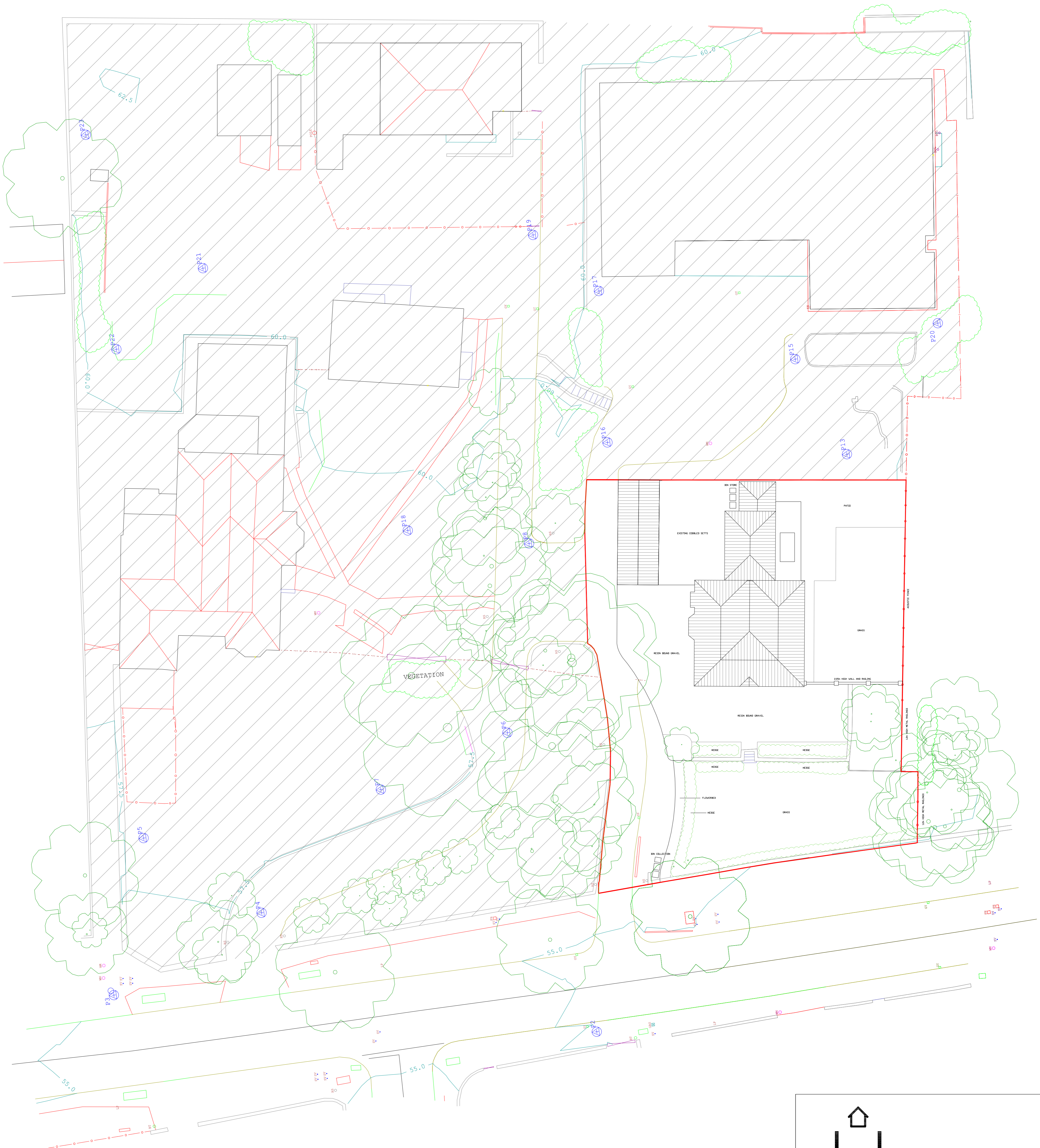

PROPOSED SITE PLAN

**drb**  
Architecture & Design

Unit 14 Jupiter Business Park  
353 Bentley Road, Bentley  
Doncaster DN5 9TJ  
Telephone 07889376885  
email dan@drb-architecture.co.uk

Project  
PART RETROSPECTIVE FULL PLANNING APPLICATION FOR CHANGE OF USE AND ALTERATIONS TO:  
THE MOUNT, CARLTON RD, WORKSOP S81 7HP  
PROPOSED SITE PLAN

Drawing No DRB 1B	Date 13.03.23	Revised 22.03.23
Scale 1=200 @ A1 1=400 @ A3	Drawn DRB	Client ROSE & CO

Copyright. This drawing is the copyright of DRB and may not be copied or reproduced for use by a third party without the written consent of the Director, Mr D Birkinshaw.

It is the responsibility of the builder to confirm all dimensions and roof angles prior to commencement on site. If in doubt, ask.

Revision  
01.11.22 - AMENDED BOUNDARY LINE  
22.03.23 - ADDED BIN STORE