

EXISTING

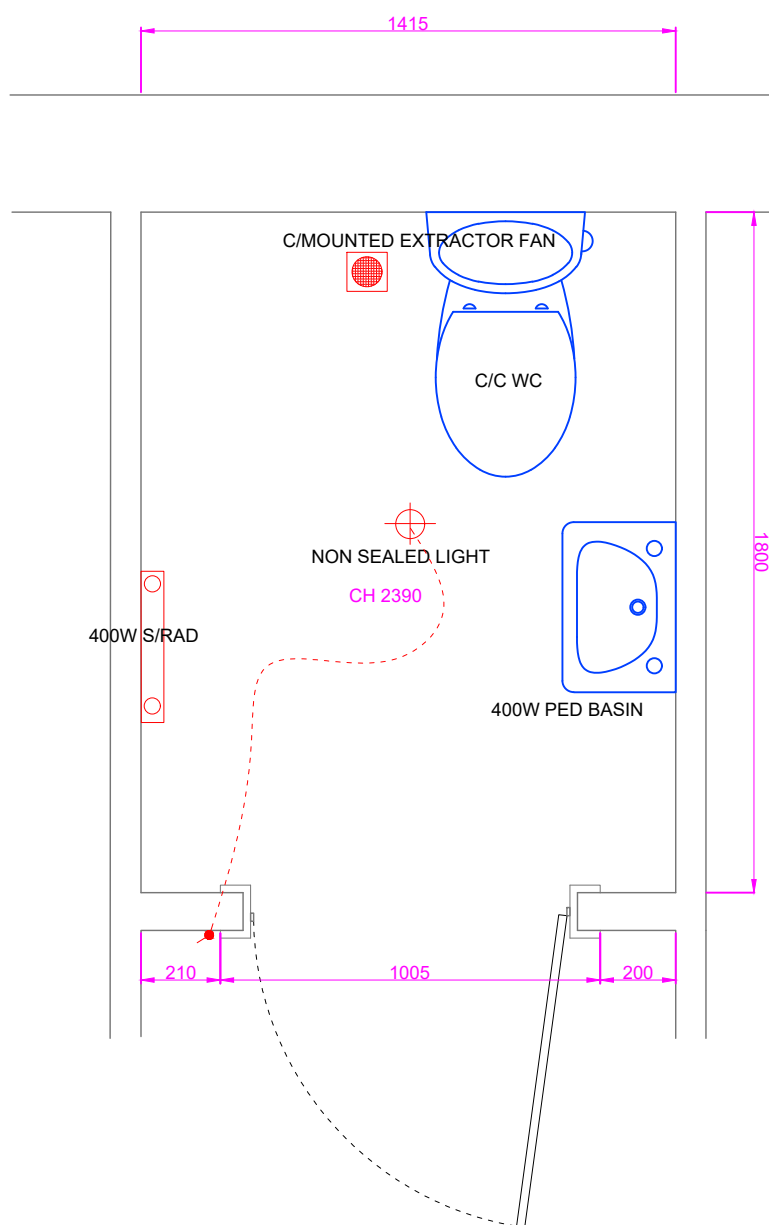

- NB.
- THE CLOAKROOM HAS CONCRETE FLOOR AND TIMBER AND SOLID WALLS.
 - THE PROPERTY HAS PARKING AT THE REAR OF THE PROPERTY.

SUPPLY AND INSTALL A NEW 'IMPEY', 1200 X 1200MM LEVEL DEC EASY-FIT FORMER WITH GRAVITY CHROME WASTE AND CONNECT TO WASTE RUN. THE FORMER NEEDS TO BE TRIMMED DOWN TO BE 900MM ON WIDTH x 1100MM LONG.

SUPPLY AND FIT A NEW 'IMPEY', U-SHAPED CURTAIN TRACK WITH AND 2NO. FULL LENGTH WHITE WEIGHTED HEMMED SHOWER CURTAINS ABOVE.

PROPOSED

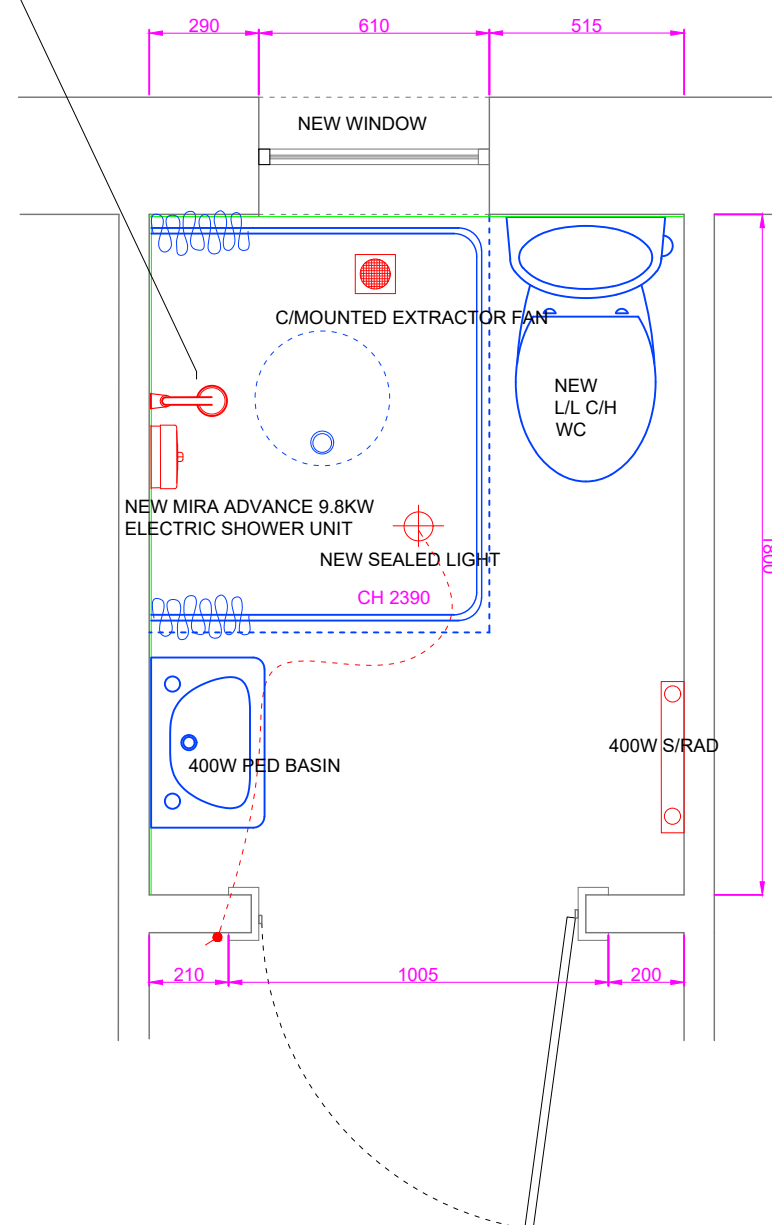

- NB.
- THE WET ROOM HAS CONCRETE FLOOR, TIMBER AND SOLID WALLS.
 - THE WET ROOM WALLS ARE TO BE COMPLETELY TILED ON 2NO. WALLS ONLY, AS INDICATED IN GREEN.
 - THE WET ROOM TO HAVE A WINDOW INSTALLED IN THE EXTERIOR WALL.
 - THE PROPERTY HAS PARKING AT THE REAR OF THE PROPERTY.

REVISION /DATE/ DESCRIPTION:

CLIENT DETAILS:

Miss Jade Vardy,
10 Greenfield Drive,
Bishops Cleeve,
Cheltenham,
Glos.

DWG TITLE:

Existing & Proposed Wet Room
Layouts

DRAWN BY:

MAP

DWG NO.:

1428JV-01

DATE OF DWG:

JAN '24

REVISION:

SCALE:

1:20

DWG STATUS:

Issued

MAAS

Design Services

5 Chestnut Grove, Walton Cardiff, Tewkesbury,
Gloucestershire, GL20 7TX
07789 685752
info@maasdesignservices.co.uk

All visual designs, technical drawings and design stamps are owned by Maas Design Services under the intellectual property copyright protection law. All particulars and dimensions must be checked on site prior to commencement and not scaled from the drawings.