

- NOTES
1. This drawing is copyright and the work of a professional engineer.
 2. Due to unavoidable inaccuracies during the reproduction process this drawing may not be used to verify dimensions and critical information. Accuracy of dimensions and critical information on any other drawing shall govern at the time of this drawing.
 3. All dimensions and portions to be checked on site.
 4. No responsibility will be accepted for any work of construction undertaken prior to the receipt of satisfactory approval or agreement from the client or other stakeholders.

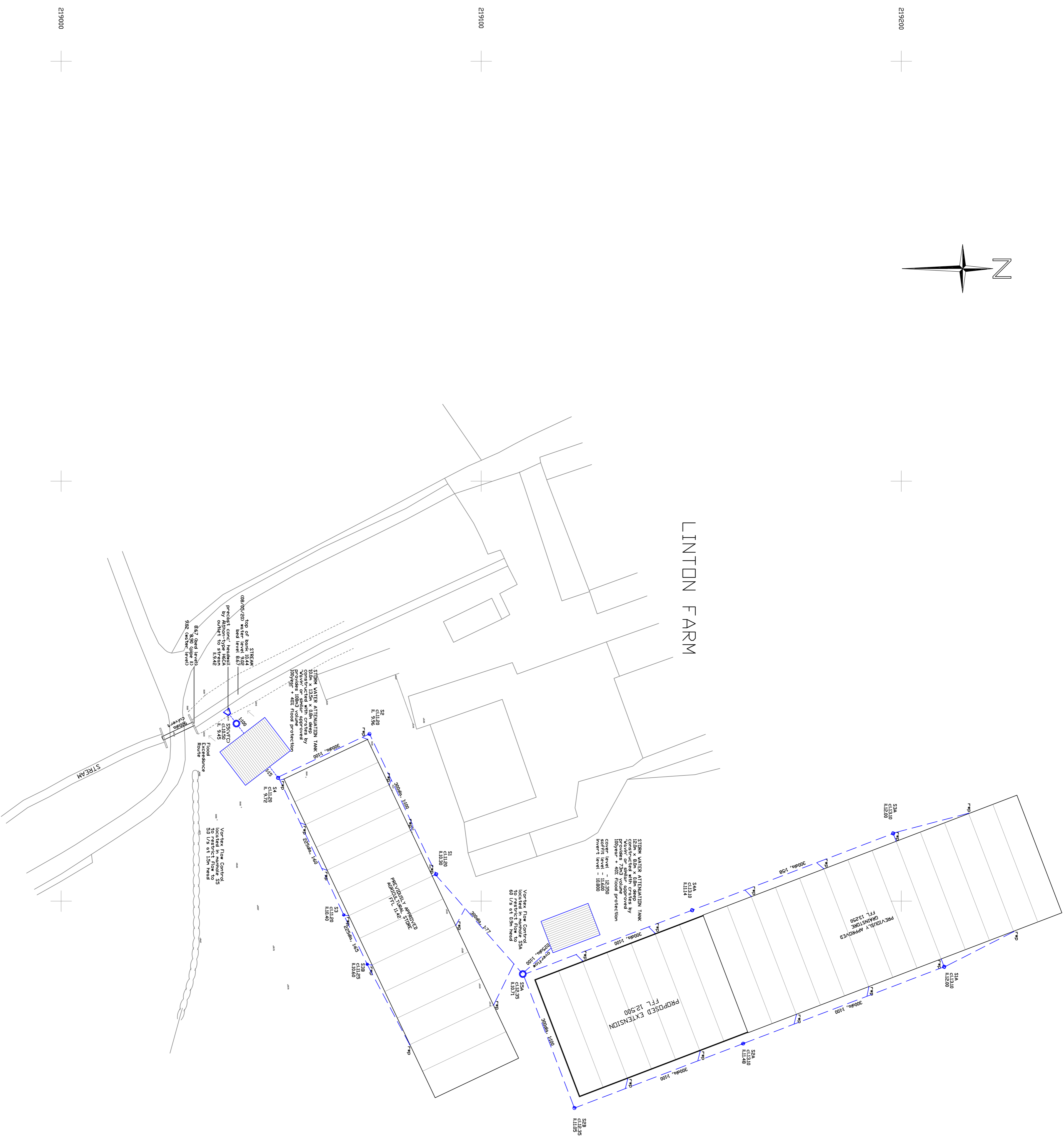
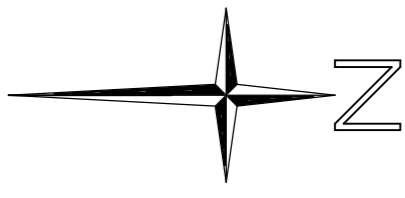

NO.	REVISION	DATE
C	Extension to gutterline along existing flow control device extension (50/100 at 12m to 20/100 at 12m)	12/01/24
B	New extension (50/100 flow control) added device extension (50/100 at 12m to 20/100 at 12m)	20/06/22
A	Extension to agricultural store (50/100 flow control) device extension (50/100 at 12m to 20/100 at 12m)	09/02/22

PHIL WARREN
 LAND & BUILDING SURVEYS
 INFRASTRUCTURE DESIGN & SETTING OUT
 Digital Lane
 Gloucestershire
 GL62 7JQ
 Email: phil@philwarren.co.uk
 Email: phil@philwarren.co.uk

DRAWING TITLE
PROPOSED SCHEMATIC DRAINAGE DESIGN

SITE ADDRESS
**PROPOSED EXTENSION TO AGRICULTURAL STORE
 LINTON FARM, CHURCHAM, GLOS**

CLIENT
SMART FARMS

SCALE	SHEET NO.	DATE
1:500 c't A1	PV	16/09/21

PROJECT NO.	REV.	REV.
21-09-01	02	C



CONSTRUCTIONLINE