

Attenuation Basin Section X-X 1:50

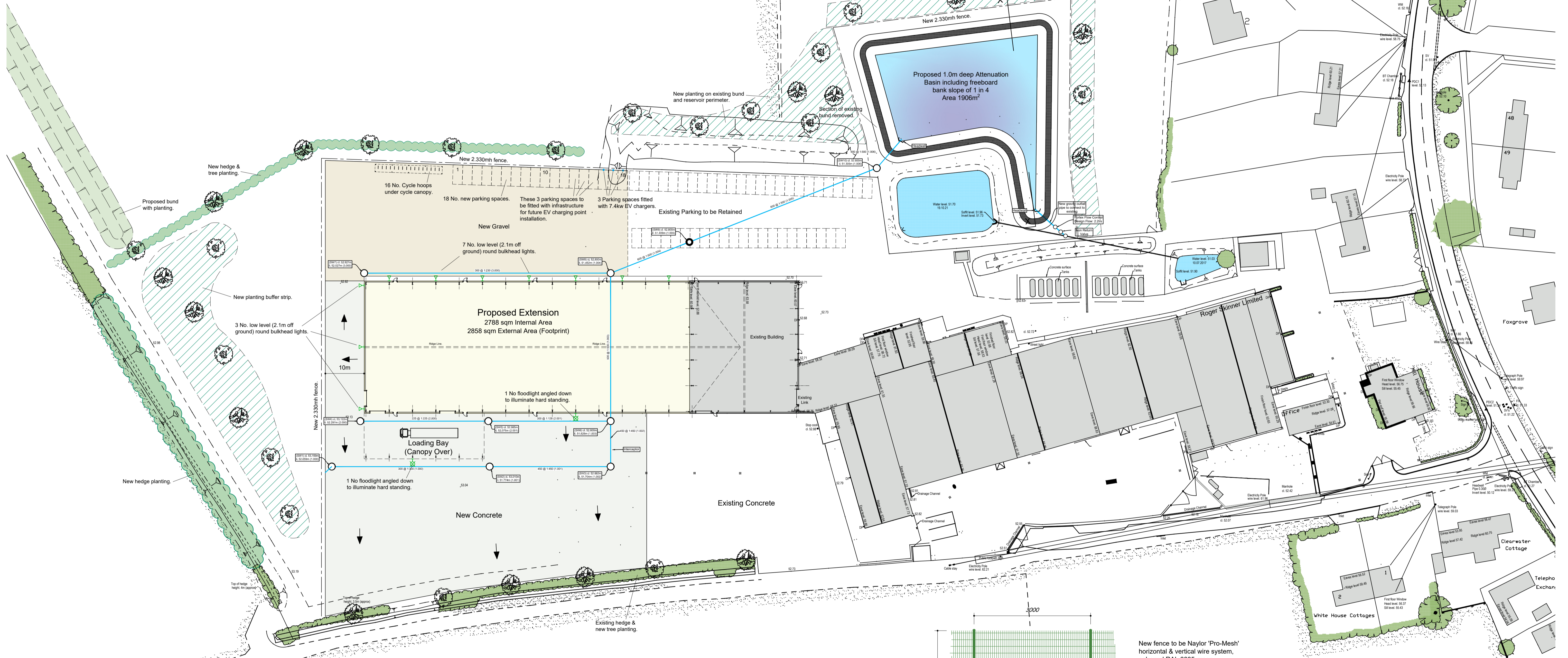

Proposed Site Plan 1:500

Proposed Planting Attenuation Pond
 On completion of excavation ground to be prepared for planting.
 Apply pre-seed fertiliser at 35g/m², lightly cultivate area.
 Applied grass seed being a mixture of:

- Chewings Fescue
- Slender Creeping Red Fescue
- Strong Creeping Red Fescue
- Hard Fescue
- Browntop Bent

Sowing rate 20-30g/m²
 In addition sow wild flower seed mix 5-10g/m².
 During the establishment period any bare areas to be reseeded.
 Once established areas to be mown twice a year mowing height 25-50mm.

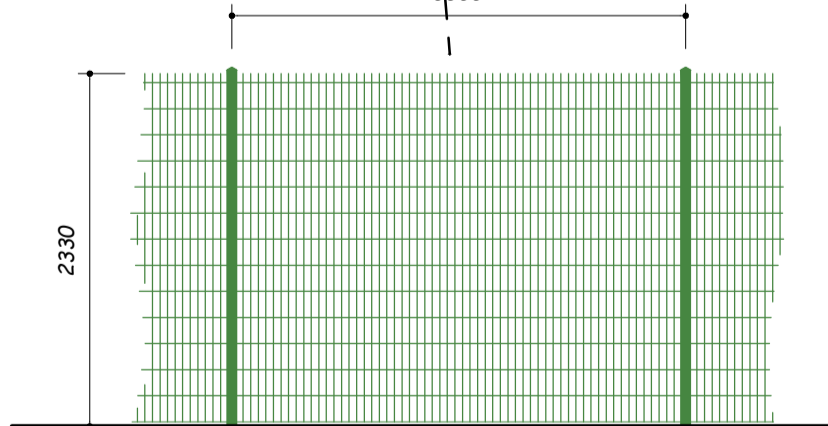

New Fence Detail 1:50

Revisions			Project		Site	
No.	Date	Description	NEW EXTENSION TO REAR OF FACTORY		THE MILL STRADBROKE	
A	Apr 22	Concrete, new lagoon, bund & planting strip revised. New fence added.	Client		Details	
B	May 22	Existing parking added.	ROGER SKINNER LTD		PROPOSED SITE PLAN	
C	Jun 22	Attenuation Pond notes added.				
D	Jul 22	Attenuation pond updated and surface water drains added. Bund removed.				
E	Sep 22	Attenuation basin section added.				
F	Dec 22	Planting revised as Landscape Architect proposals. External lighting added. Fence detail added.				
G	Nov 23	New car parking (with EV spaces) & cycle storage added.				

HOLLINS
 Architects, Surveyors & Planning Consultants

The Guildhall
 Market Hill
 Framlingham
 Suffolk
 IP13 9BD

Telephone 01728 723959
 E mail info@hollins.co.uk
 Website www.hollins.co.uk

This drawing is copyright. This drawing must not be scaled. Before commencing any work the contractor must set out and check all dimensions on site. This drawing to be read in conjunction with any consultants details. Any discrepancies must be reported to Hollins Architects & Surveyors.

Scale 1:500 1:50 @ A1
 Date MARCH 2022
 Drawn PJT
 Drawing No. 2163 314 G
 THIS DRAWING IS COPYRIGHT