



## Chartwell Tree Consultants Ltd

2 Greencroft Cottage, Farley Lane, Westerham, Kent, TN16 1UB  
[sam@chartwelltreeconsultants.co.uk](mailto:sam@chartwelltreeconsultants.co.uk)  
07789907861

Paul Thomas  
14 Diamond Terrace,  
London,  
SE10 8QN

31<sup>st</sup> January 2024

Ref: CTC/14D/AL1

Dear Mr Thomas

### **RE: Proposed rear extension to the above property.**

#### **Instructions Received**

To comment on the potential impact of the proposed rear extension on the Magnolia tree in the garden.

The tree is protected by a Greenwich Council Conservation Area.

#### **Proposal**

To construct a single-storey rear extension

#### **Tree details**

Tree No.	Species	Age Range	Height (m)	Average Spread (m)	Physiological Condition	Structural Condition
T1	Magnolia .sp	M	6	2.5	Good	Good

**Comments:** Multi-stemmed at base. Raised surface roots. Previously crown reduced. No works required. No site visit has been undertaken. Measurements have been provided by the client.

## Conclusions

I can confirm that the proposed development will not require an incursion into the Root Protection Area of the Magnolia T1 and therefore conventional construction methods can be used. Shade arcs are already known factor and do not affect the proposal.

## Recommendations

The Magnolia (T1) can be protected by HERRAS fencing with a construction exclusion zone to the South – please see attached Tree Survey and Protection Plan – as long as this plan is adhered to there will be no affect to the tree by the proposed extension.

I hope that you find this information of use to you. Should you have any further questions then please do not hesitate to contact me.

Yours sincerely,

A handwritten signature in black ink, appearing to read 'S. Bateson', with a long horizontal flourish underneath.

Sam Bateson

## Letter Range & Limitations:

- The tree data provided is for the purposes of a development site in accordance with BS5837: 2012 and is not a detailed tree safety inspection.
- The information contained in this report is provided without prejudice and is based upon the authors knowledge, experience, qualifications and public research. The author cannot be held responsible for the consequences of a difference of opinion for example, from the Local Planning Authority or the Planning Inspectorate.
- The Local Planning Authority (Greenwich Council) must be consulted prior to any pruning works being carried out due to the Conservation Area.

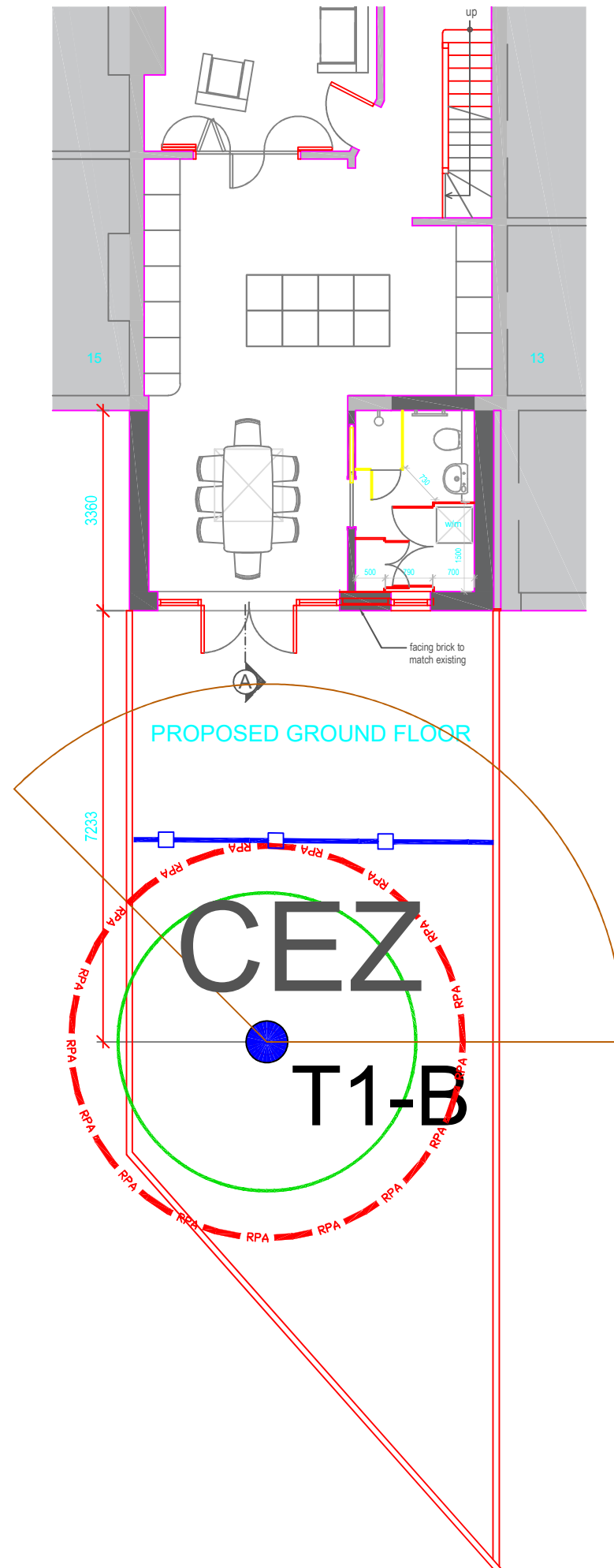

No construction works including storage or fire safety within the CEZ.

Tree protection fencing can be HERRAS panels firmly affixed to the ground.

Notes:  
Do not scale from this drawing  
All dimensions to be checked on site

**TREE SURVEY & PROTECTION PLAN**

T1 Tree Number

- A Category
- B Category
- C Category
- U Category

- Root protection area
- Branch spread
- ⤴ Shade arc
- Tree protection fencing
- CEZ** Construction Exclusion Zone

Title Tree Survey & Constraints Plan  
 Job 14 Diamond Terrace  
 Scale 1:100 @ A3  
 Date 31.01.2024  
 Drn SB  
 Dwg No 001

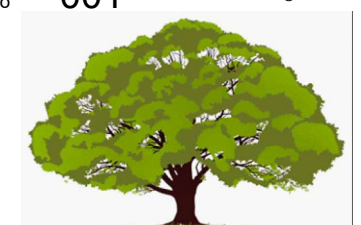

Chartwell Tree Consultants Ltd  
 2 Greencroft Cottage  
 Farley Lane  
 Westerham  
 Kent  
 TN16 1UB

Tel: 07789 907861  
[sam@chartwelltreeconsultants.co.uk](mailto:sam@chartwelltreeconsultants.co.uk)