

H
PAPER SIZE
A7

C
B
A

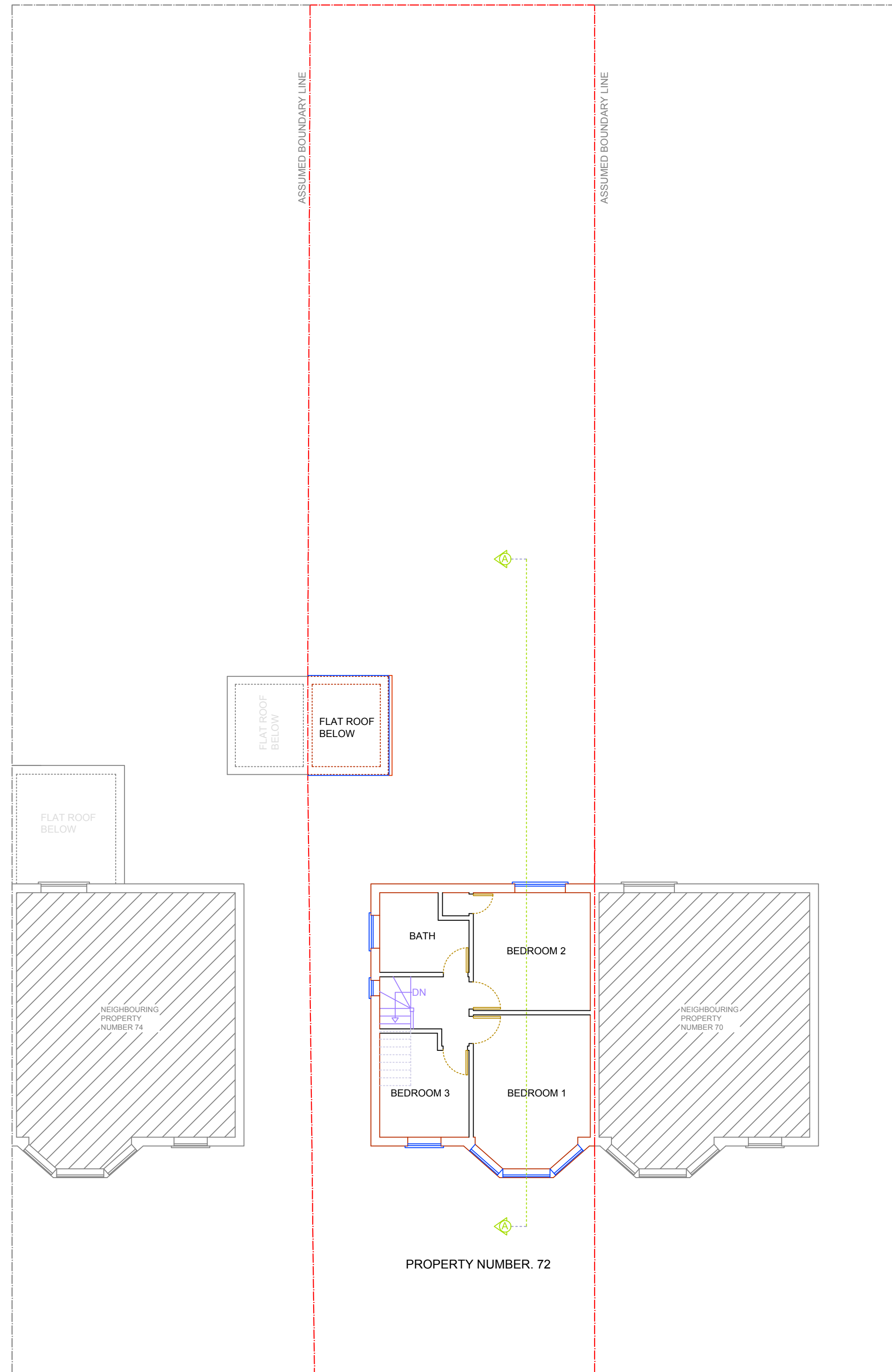

3 FIRST FLOOR - EXISTING
1:100

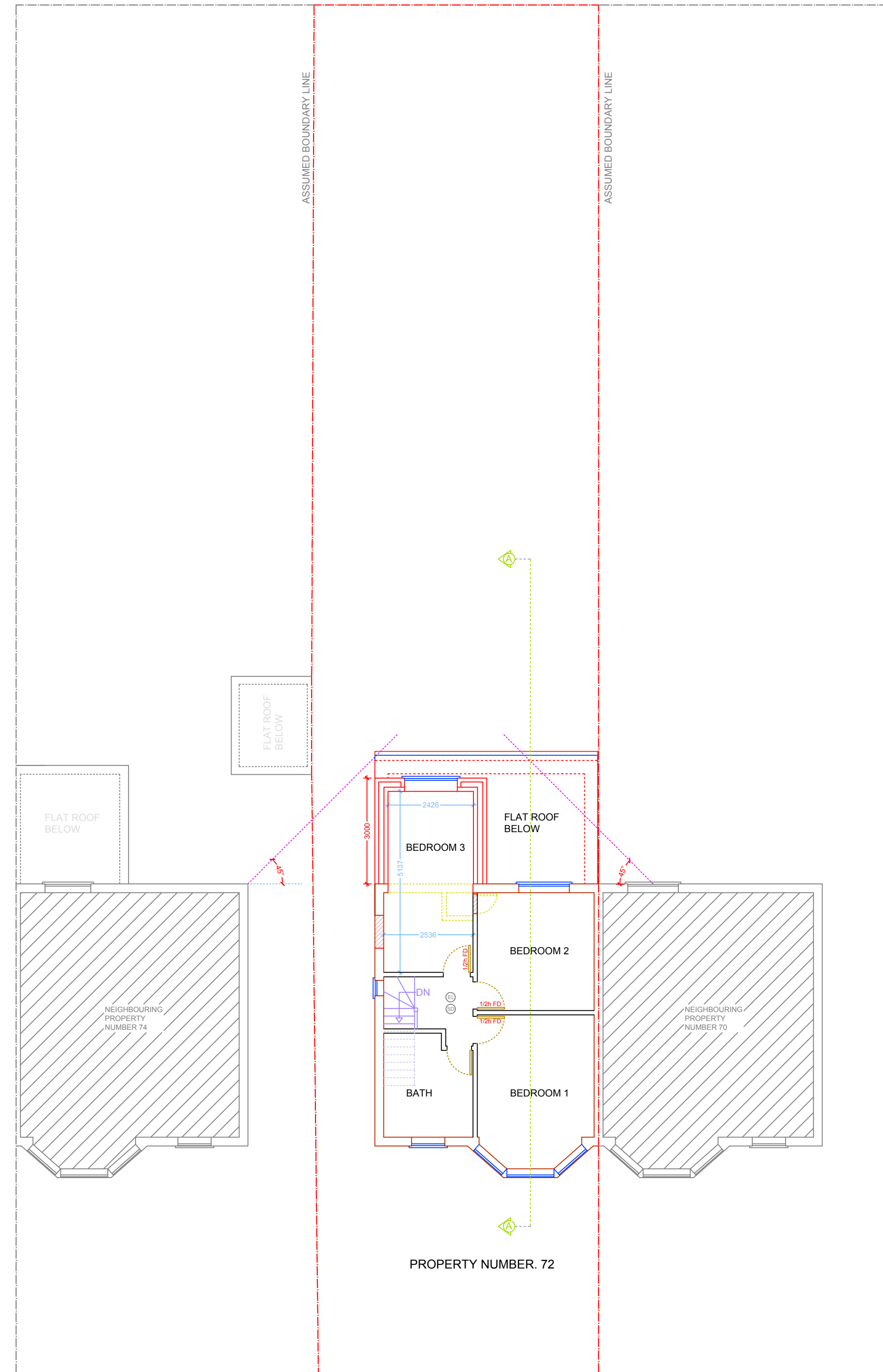

4 FIRST FLOOR - PROPOSED
1:100



ALL WORK TO COMPLY WITH CURRENT BUILDING REGULATIONS AND CODES OF PRACTICE.
ALL DIMENSIONS IN MM UNLESS NOTED OTHERWISE.
MEASURED SURVEY DOES NOT INCLUDE FOR INTRUSIVE SURVEY TO DETERMINE EXACT LOCATION OF STEELWORK/SUPPORTING STRUCTURE.
THIS DRAWING IS PREPARED SOLELY FOR DESIGN AND PLANNING SUBMISSION PURPOSES. IT IS NOT INTENDED OR SUITABLE FOR EITHER BUILDING REGULATIONS OR CONSTRUCTION PURPOSES AND SHOULD NOT BE USED FOR SUCH.
THIS DRAWING IS COPYRIGHT AND MUST NOT BE TRACED OR COPIED IN ANY WAY OR FORM.
PLEASE NOTE: PROPERTY OWNER TO ENSURE THAT ALL ASPECTS OF THE PARTY WALL ETC. ACT 1999 ARE COMPLIED WITH PRIOR TO ANY WORK COMMENCING ON SITE.
VARIATIONS IN SQUARENESS, DEPTH OF PLASTER ETC. MUST BE CHECKED FOR. WHERE NEW WALLS ARE SHOWN AS ALIGNED WITH EXISTING WALLS, PHYSICAL REMOVAL OF BRICKWORK AND / OR PLASTER TO ESTABLISH THE ACTUAL POSITION OF THE WALL BEING ATTACHED TO MUST BE CHECKED.
DOCUMENTS SHOULD BE USED AS THE DRAWING STATUS DESCRIBED, ANY OTHER USE IS DONE SO AT THE RESPONSIBILITY OF THE USER.
MATERIALS SHOULD MATCH THOSE OF THE EXISTING DWELLING
NO WORK TO BE CARRIED OUT PRIOR TO THE APPROVAL OF THE DRAWINGS UNDER THE TOWN PLANNING AND COUNTRY PLANNING ACTS AND THE BUILDING REGULATIONS.
CONTRACTOR TO BE RESPONSIBLE FOR NOTIFYING THE LOCAL AUTHORITY FOR THE START OF THE WORK.
DO NOT SCALE THE DRAWINGS EXCEPT FOR THE PLANNING APPLICATION PURPOSE.

PLANNING ISSUE
DO NOT USE FOR ANY CONSTRUCTION WORK.
ANY DEVELOPMENT WITHOUT A CERTIFICATE OF LAWFULNESS OR PLANNING PERMISSION IS SOLELY AT OWNERS RISK.

Revision	Description	Date

GET RAPID PLANS
Architectural Services
02084786567 / 07538938251 / 07507665812
169 Southpark Drive Ifford IG3 9AD
Email: getrapidplans@gmail.com
Website: getrapidplans.co.uk
ADDRESS 72 LINTHORPE ROAD
LONDON BARNET
EN4 9PL

PROJECT
DOUBLE STOREY REAR EXTENSION

TITLE
FIRST FLOOR PLANS

DRAWN AT	SCALE	DRAWN BY
HEAD OFFICE	1:100 @A1	
DRAWING NO	REVISION	DATE
S09-2		10-01-2024

