

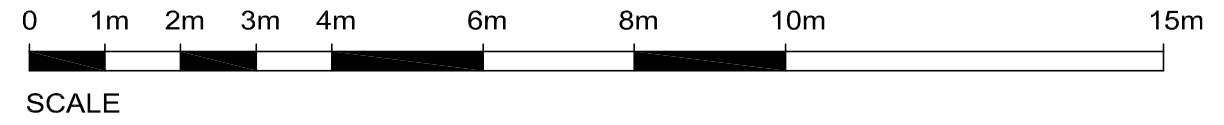

Proposed Front Elevation - 244 & 246 Iffley Road

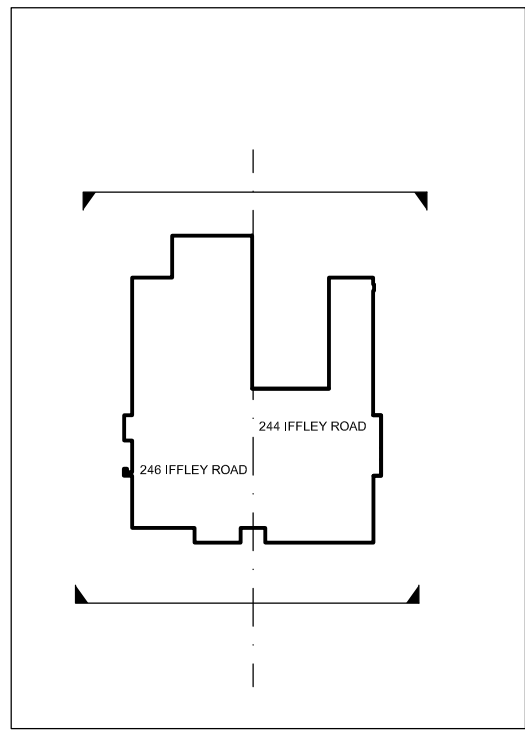

Proposed Rear Elevation - 244 & 246 Iffley Road

This drawing and design is for use solely in connection with the project described below. The drawing and design is the copyright of MEB Design and must not be reissued, loaned or copied without written consent.

All dimensions and setting out to be checked on site before construction. Do not scale from the drawing.

The drawing is to be read in conjunction with all other information relevant to the project. Any apparent discrepancy is to be brought to the attention of MEB Design.

If drawings are extracts from a co-ordinated Building Information Model (Autodesk Revit or similar) then for full details, layouts, keys and any items outside the Architectural Package please refer to the separate Structural and Services Packages. If in any doubt ask.

Linked and imported elements and files produced by other parties remain the copyright and responsibility of those parties and not of MEB Design Ltd

3D and rendered images are intended for information and illustrative purposes only. 3D and rendered drawings should not be relied upon and do not form part of any contractual arrangements.

© MEB Design Ltd

GENERAL NOTES

REV	DATE	DESCRIPTION

CLIENT
CHURCH MISSION SOCIETY

PROJECT TITLE
244-246 IFFLEY ROAD

DRAWING TITLE
Proposed Front & Rear Elevations

SCALE	DRAWN/CHKD	DATE
1:100 @A3	PC/PC	Jan 24

MEB Design Ltd
Chartered Architects

London Office Unit 2, Florence House
29 Grove Street, Oxford OX2 7JT
T: 01865 316 944
oxford@mebdesign.co.uk www.mebdesign.co.uk

DRAWING No. Rev.
2327-XX-XX-DR-A-3-203 A