

Post 4
 $H = 183\text{cm}$
 $w = 10\text{cm}$

$H = 183\text{cm}$
 $P3 = w = 10\text{cm}$

$H = 183\text{cm}$
 $P2 = w = 10\text{cm}$

Post 1 = $H = 183\text{cm}$

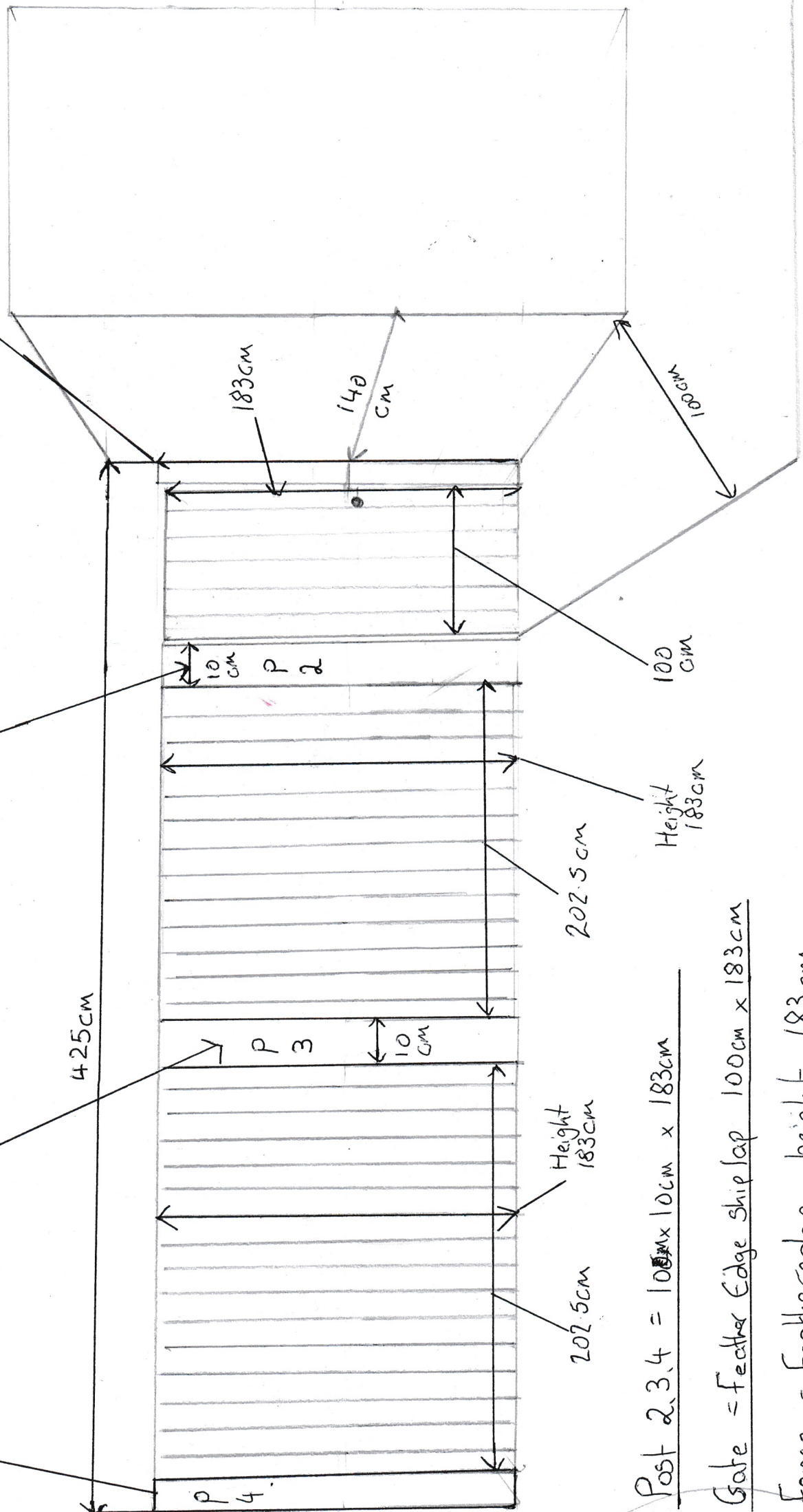

Post 2,3,4 = $100\text{mm} \times 10\text{cm} \times 183\text{cm}$

Gate = Feather Edge ship lap $100\text{cm} \times 183\text{cm}$

Fence = Featheredge height 183cm

11 Brisbane Place
 Proposed plan to show alterations front fence