

general notes:
do not scale the drawing.
all dimensions to be checked on site prior to commencement of work and any discrepancy shall be immediately reported and resolved prior to work commencing.
this drawing is to be read in conjunction with all relevant drawings and specifications relating to the job whether or not indicated on the drawing.
copyright reserved to clover architectural design limited and this drawing may not be used or reproduced without prior written consent.

VEHICULAR CROSSING CONSTRUCTION

FOOTWAY CONSTRUCTION

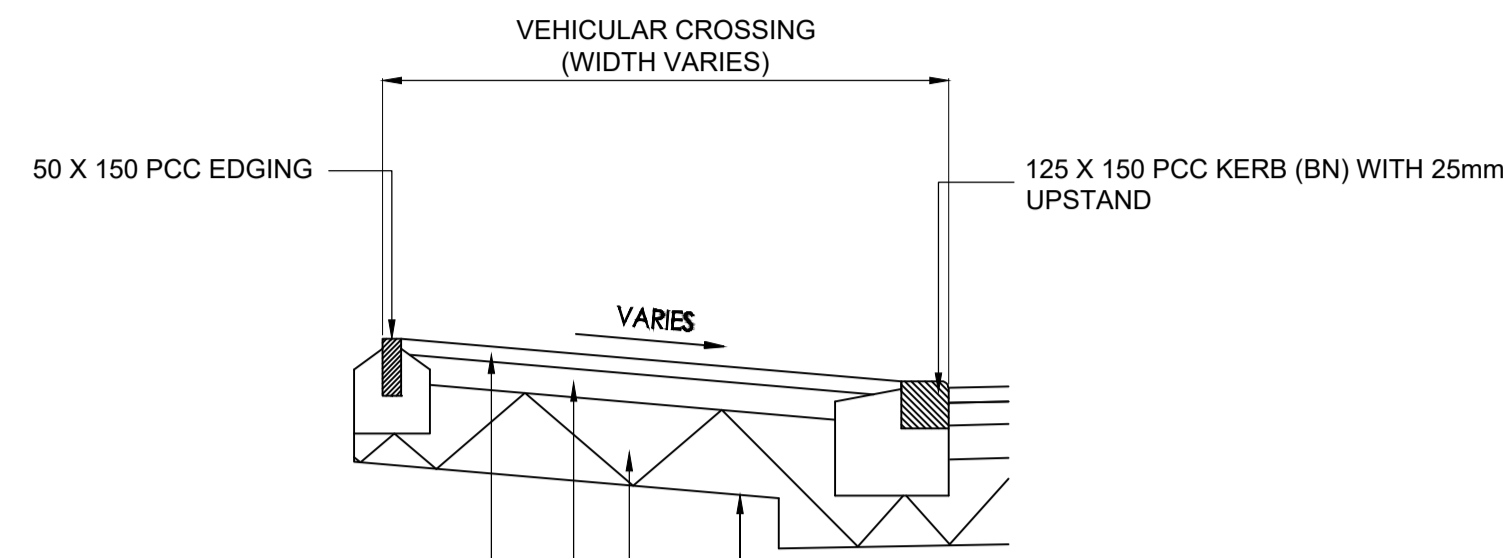

SURFACE COURSE:
40mm THICK AC 6 DENSE SURF 100/150 TO BS EN 13108 LAID AND COMPACTED TO BS 594987:2007

BINDER COURSE:
75mm THICK AC 20 DENSE BIN 100/150 TO BS EN 13108 LAID AND COMPACTED TO BS 594987:2007

SUB BASE:
225mm THICK TYPE 1 UNBOUND MIXTURE SUB-BASE TO CURRENT DTP SPECIFICATION FOR HIGHWAY WORKS CL 802 CL 803, TABLE 8/2

SUB GRADE BELOW FOOTWAYS TO BE TREATED WITH GRANULAR WEED KILLER PRIOR TO LAYING OF SUB BASE TO LANCASHIRE COUNTY COUNCIL REQUIREMENTS

FORMATION LEVEL TO BE PROOF ROLLED TO CLAUSE 609, SOFT SPOTS TO BE EXCAVATED BACK TO GOOD GROUND AND FILLED WITH FULLY COMPACTED TYPE 1 SUB-BASE MATERIAL TO THE SPECIFICATION FOR HIGHWAY WORKS CLAUSE 616 OR ALTERNATIVE AS AGREED WITH HIGHWAYS INSPECTOR

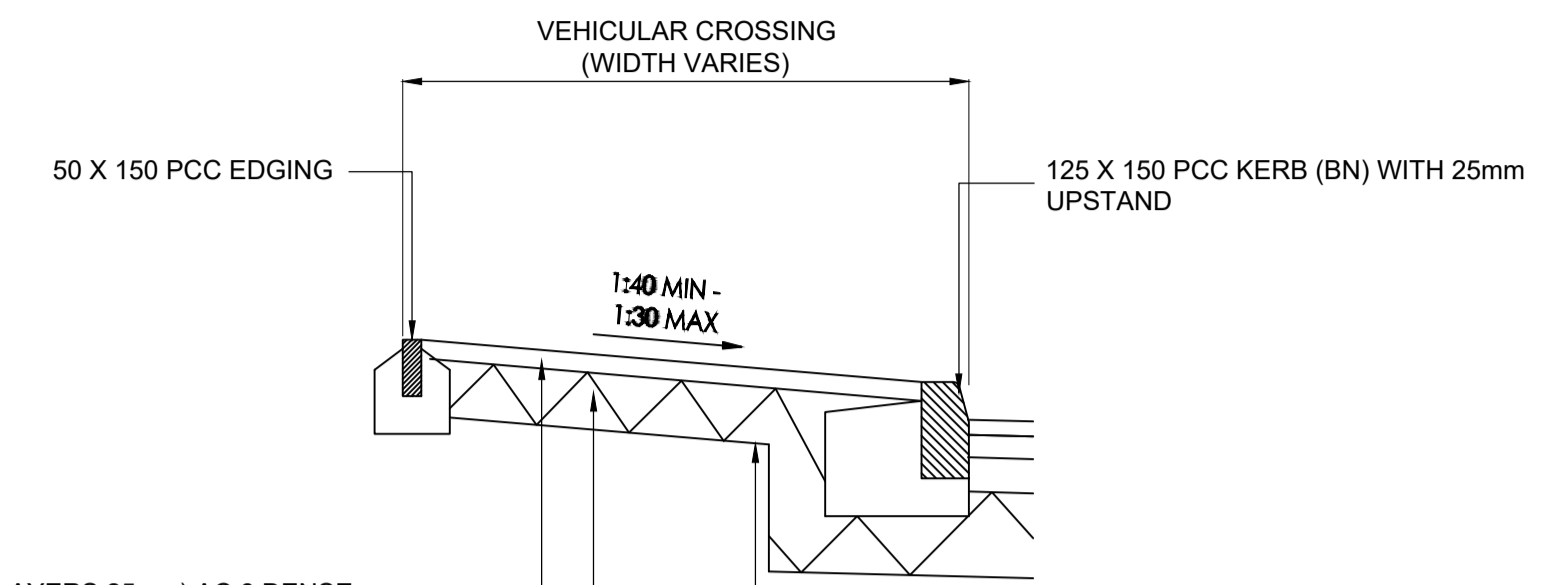

SURFACE COURSE:
50mm THICK (COMPRISING 2 LAYERS 25mm) AC 6 DENSE SURF 100/150 TO BS EN 13108 LAID AND COMPACTED TO BS 594987:2007

SUB BASE:
150mm THICK TYPE 1 UNBOUND MIXTURE SUB-BASE TO CURRENT DTP SPECIFICATION FOR HIGHWAY WORKS CL 802 CL 803, TABLE 8/2

SUB GRADE BELOW FOOTWAYS TO BE TREATED WITH GRANULAR WEED KILLER PRIOR TO LAYING OF SUB BASE TO LANCASHIRE COUNTY COUNCIL REQUIREMENTS

FORMATION LEVEL TO BE PROOF ROLLED TO CLAUSE 609, SOFT SPOTS TO BE EXCAVATED BACK TO GOOD GROUND AND FILLED WITH FULLY COMPACTED TYPE 1 SUB-BASE MATERIAL TO THE SPECIFICATION FOR HIGHWAY WORKS CLAUSE 616 OR ALTERNATIVE AS AGREED WITH HIGHWAYS INSPECTOR

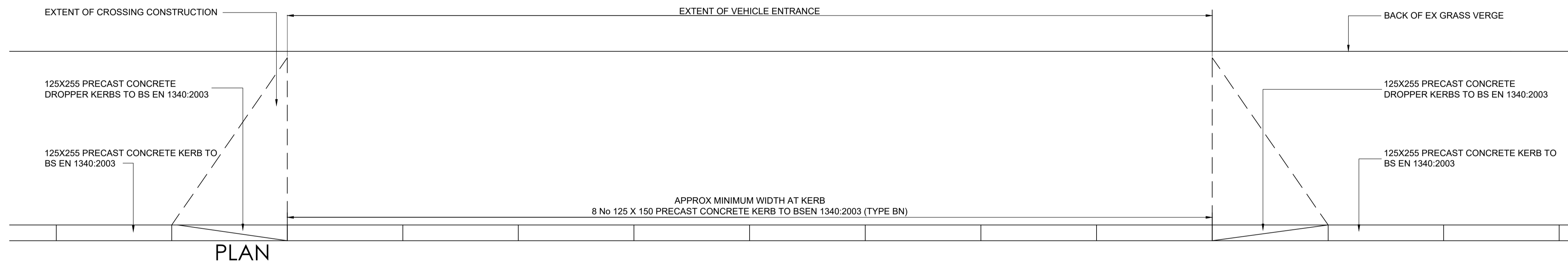

PLAN

ELEVATION

TYPICAL KERB ARRANGEMENT OF VEHICULAR CROSSING

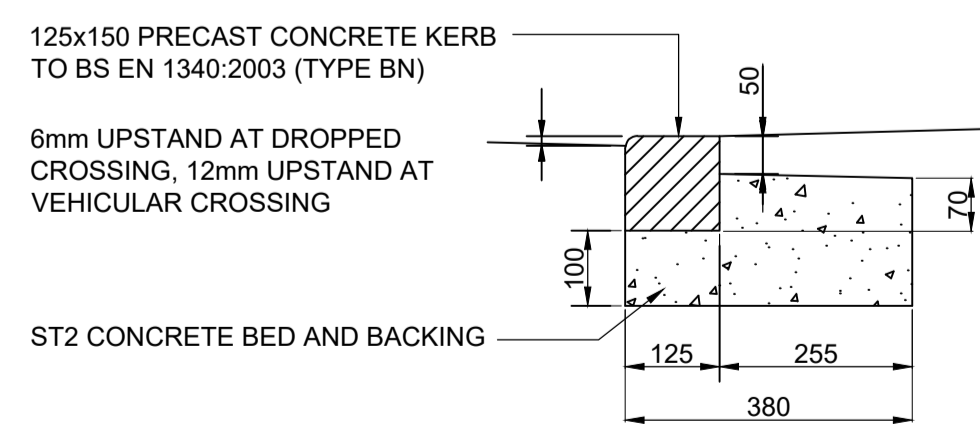

DROPPED KERB DETAIL

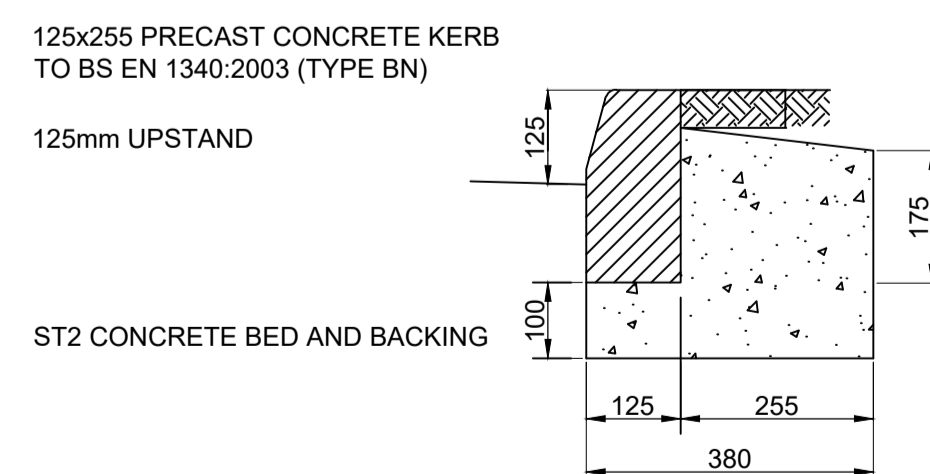

FULL HEIGHT KERB DETAIL

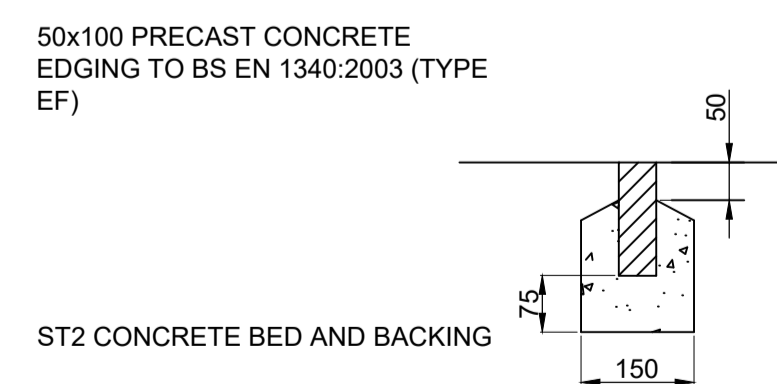

EDGING DETAIL

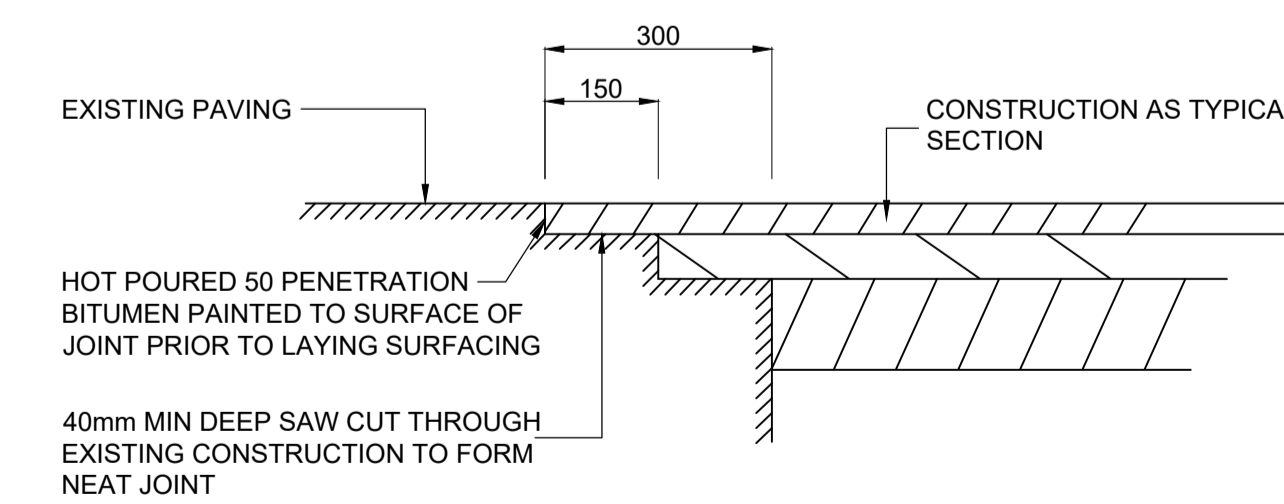

TYPICAL DETAIL TIE-IN BETWEEN NEW AND EXISTING BITUMINOUS CONSTRUCTION

Rev. Date By Description

clover
architectural design

9 clover drive, freckleton, preston, lancashire pr4 1tg
tel: 07773 014899 email info@clover-design.co.uk

Client:
MENCAP (Blackpool)

Project:
**Proposed Developemtn
86 Whitegate Drive
Blackpool**

Drawing Title:
Proposed Vehicle Crossing

Drawn: AMS	Checked:	Scale: 1:50	Page: 24
Job No: 23-052	Drawing No: 1103	Rev:	

PROPOSED VEHICULAR CROSSING DETAILS