

SITE LAYOUT 1:250

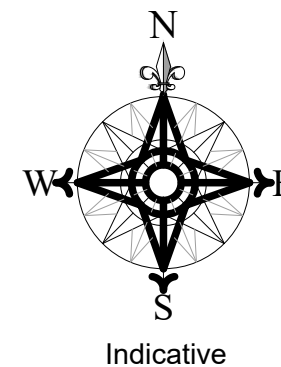

LEGEND

- Existing trees
- Existing trees to be removed
- Existing hedges/planting
- Existing hedges/planting to be removed
- Proposed planting (subject to detailed landscape design)
- Existing Levels
- Proposed levels – dpc/finished floor & finished ground levels (subject to engineers design)
- Indicative SW drainage
- Existing foul drainage
- Indicative foul drainage

Foul & sw drains where shown are for guidance purposes only & may vary due to site conditions, local water authority & building control approval, etc.
Local water authority approval will be required when building over or close to a sewer. Previously shared private drains are now likely to be considered public sewers.

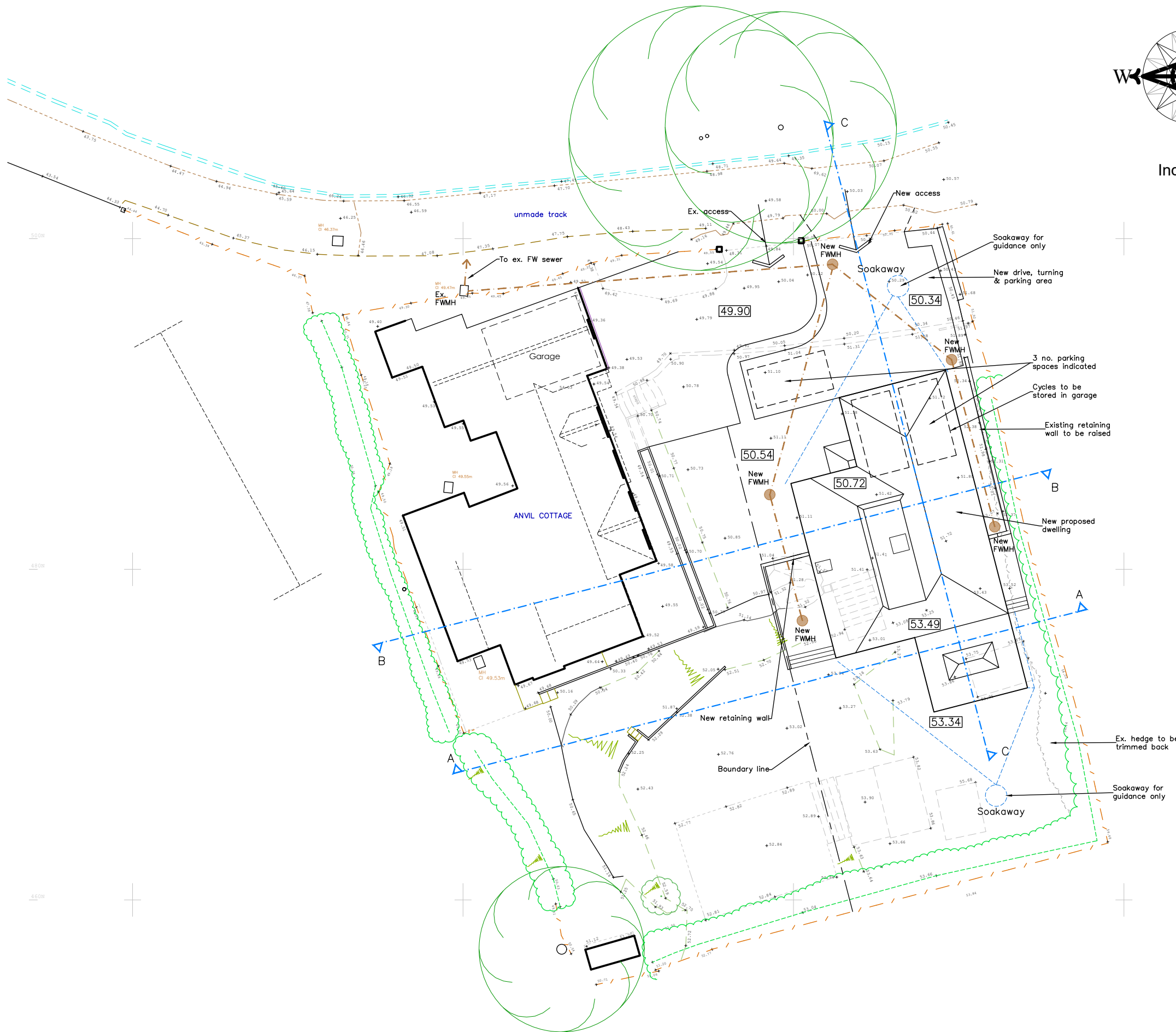

A	21.02.24	Planning issue
rev:	date:	note:

adp architects ltd
architects & urban designers

Tel: 01489 584503
Email: mail@adp-ltd.co.uk
www.adparchitectsLtd.co.uk

Richmond Court, 94 Bolley Road, Park Gate, Southampton, SO31 1BA

project name/address:
**Proposed Dwelling
Anvil Cottage
Arford Common
Headley
GU35 8AD**

client:
Oakesfield

drawing title:
Site Layout

job number: 2042	drawing number: 01	revision: A
drawing scale/size: 1:250 (A3)	date: Nov 23	drawn: