



Around The World

TREE & LANDSCAPING

36A Ellesmere Court, Sunderland, SR2 9UA

Tree Preservation/Conservation Order Application

Date 15/02/2024

St Aidan's Catholic Academy

Willow Bank Road

Sunderland

SR2 7HJ

Description of works –

These works have been identified on the Tree Survey carried out by Amenity Tree with the works and TPO application carried out by ATW Tree and Landscaping Specialists LTD.

T4 - Large cavity at base of tree up to approximately 1m in height, tree has lean towards school premises, recommend for removal.

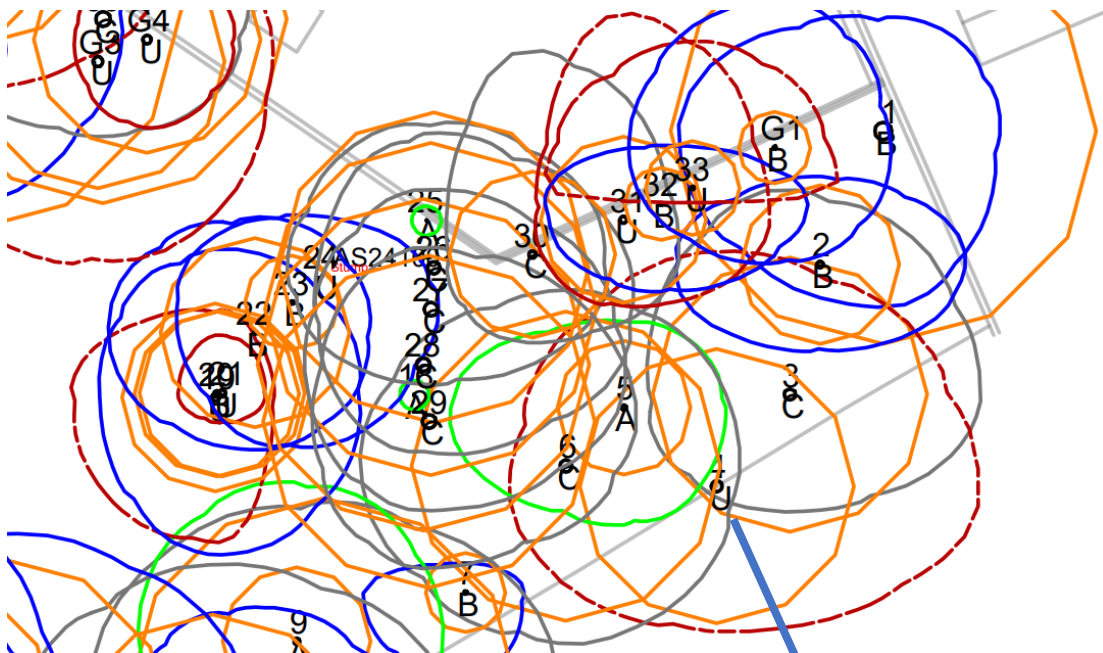

CONSERVATION AREA.

T4



CONTACT DETAILS

07506914738 / ATW25@YAHOO.COM



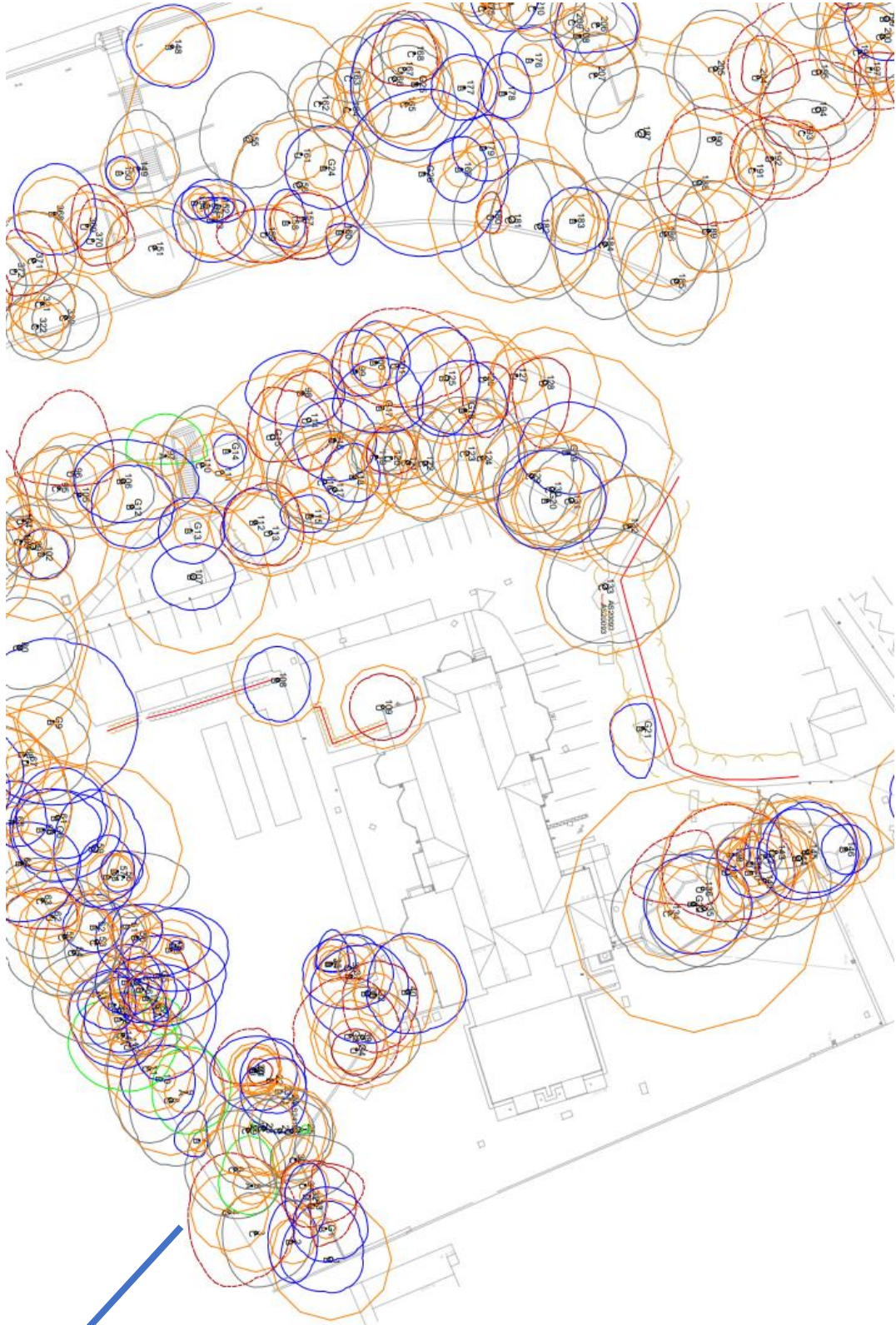

T4

T12 – Common Lime - Dead standing Lime, remove to ground level.

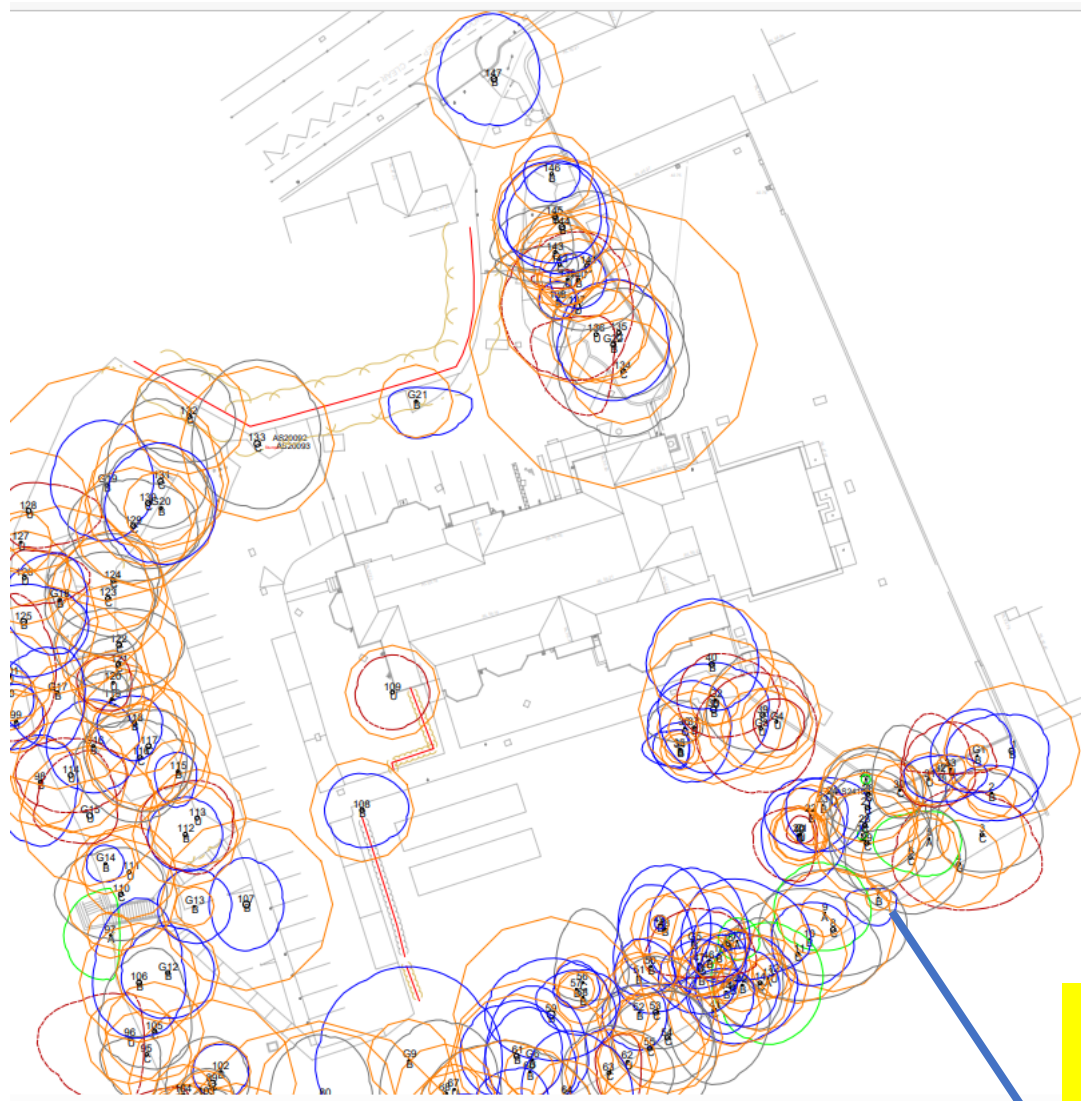
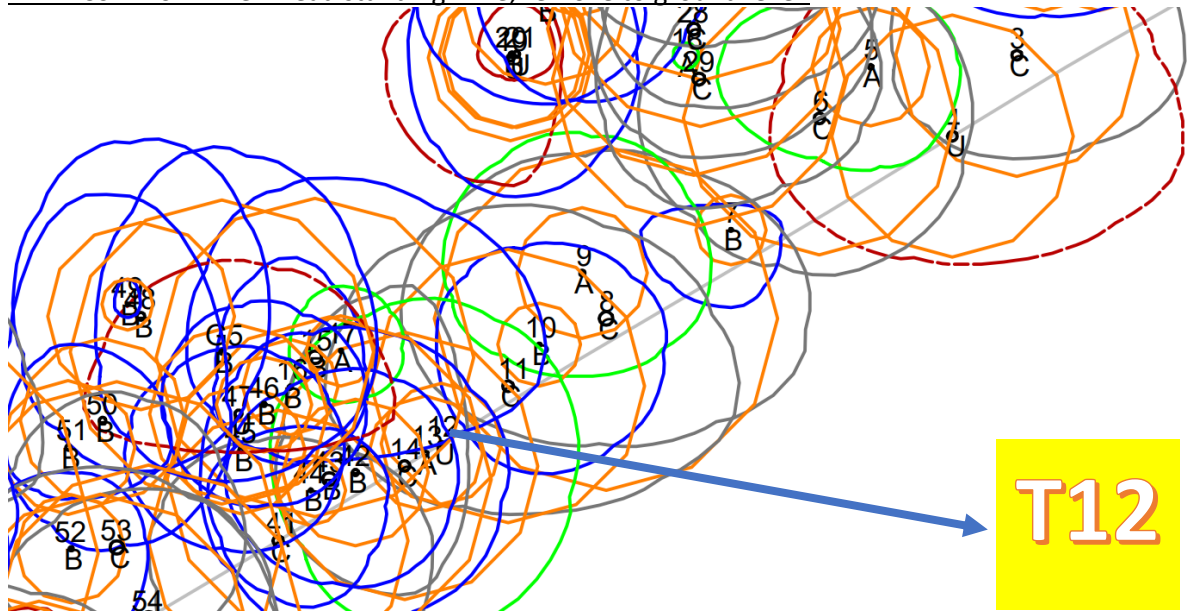

CONSERVATION AREA



CONTACT DETAILS

07506914738 / ATW25@YAHOO.COM



T19 – Common Black Elder - Elder in decline, signs of dead throughout tree, cavity at 1m up stem, saprophytic fungi (Jews Ear) common on Elder but large amount of dead evident throughout crown, bad specimen close to playing field, remove to eliminate risk.

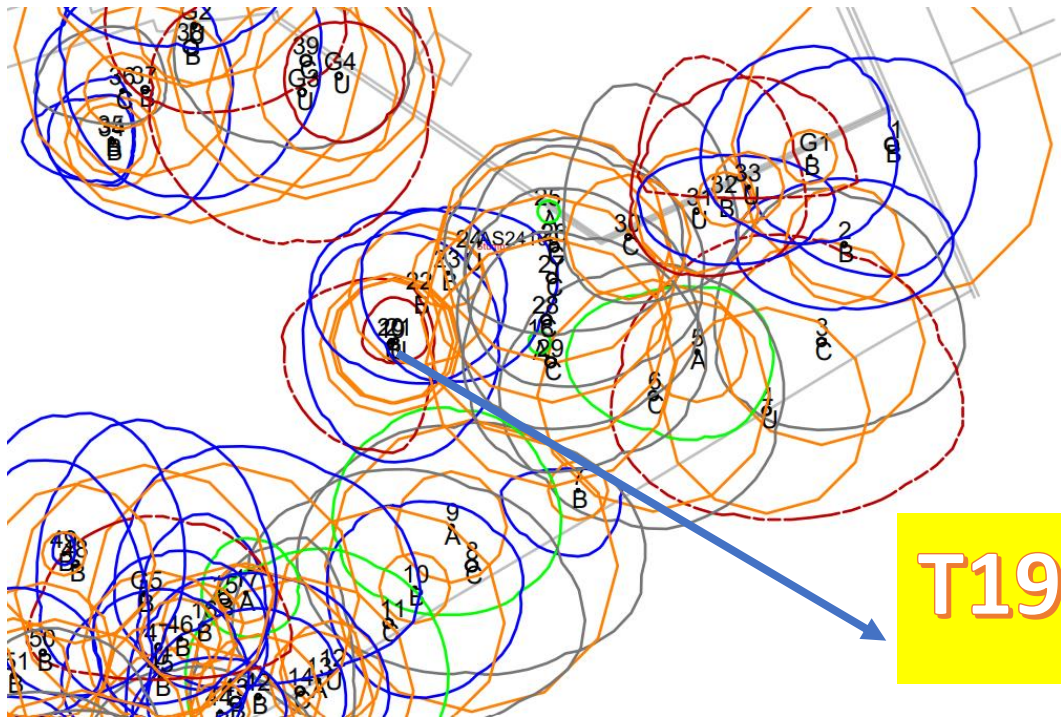

T24 – Common horse chestnut - Horse Chestnut stump at 0.5M, cut down to ground level to remove trip hazard.

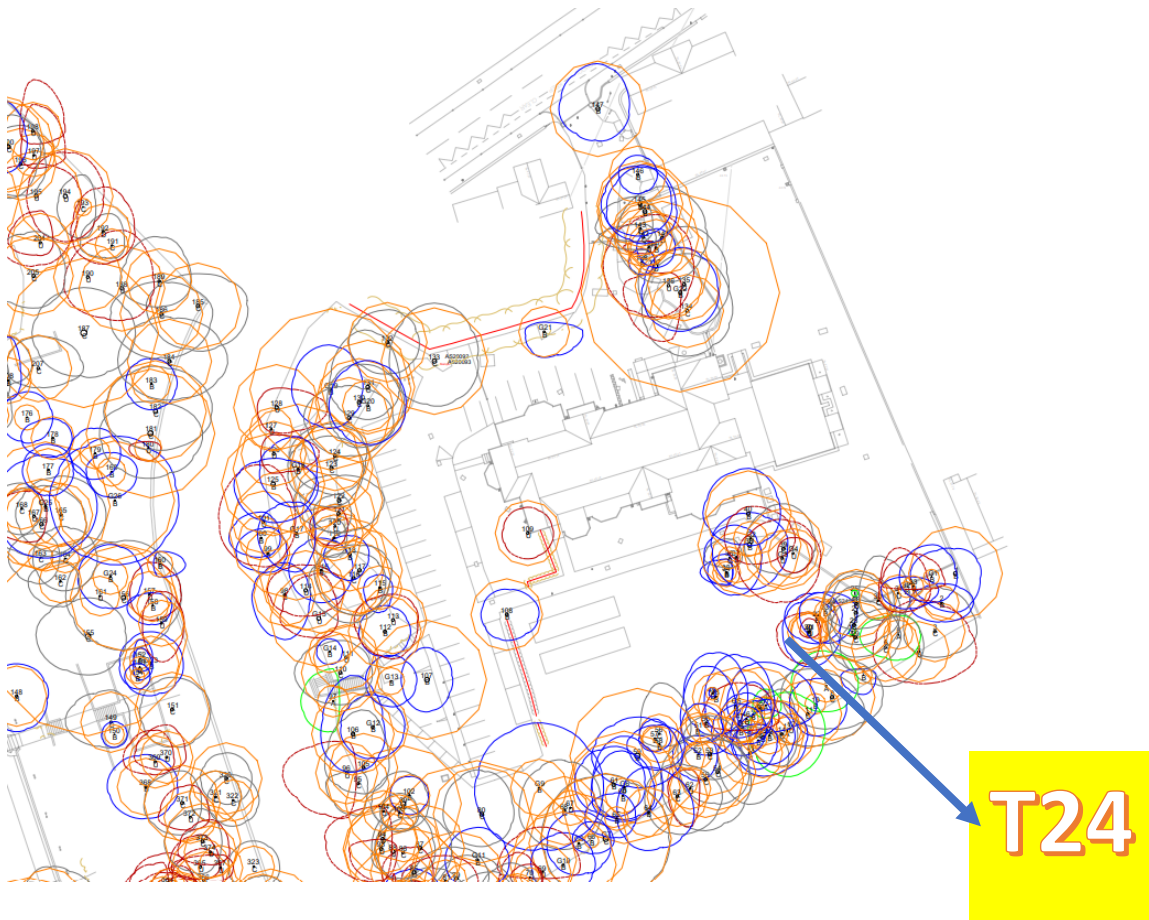
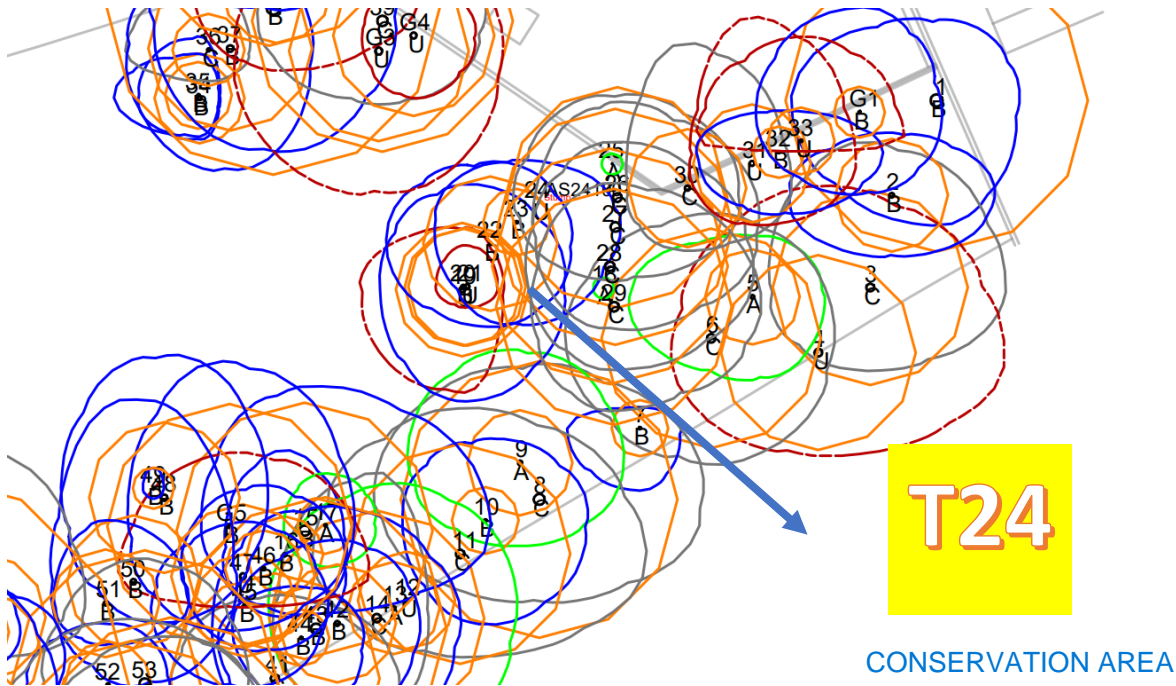

T33 – Common Ash - Inonutus hispidus evident on stem @ approximately 1.5m, unclear if Ash has developed die back at this stage due to time of year. Ash is leaning over playground remove to eliminate risk.

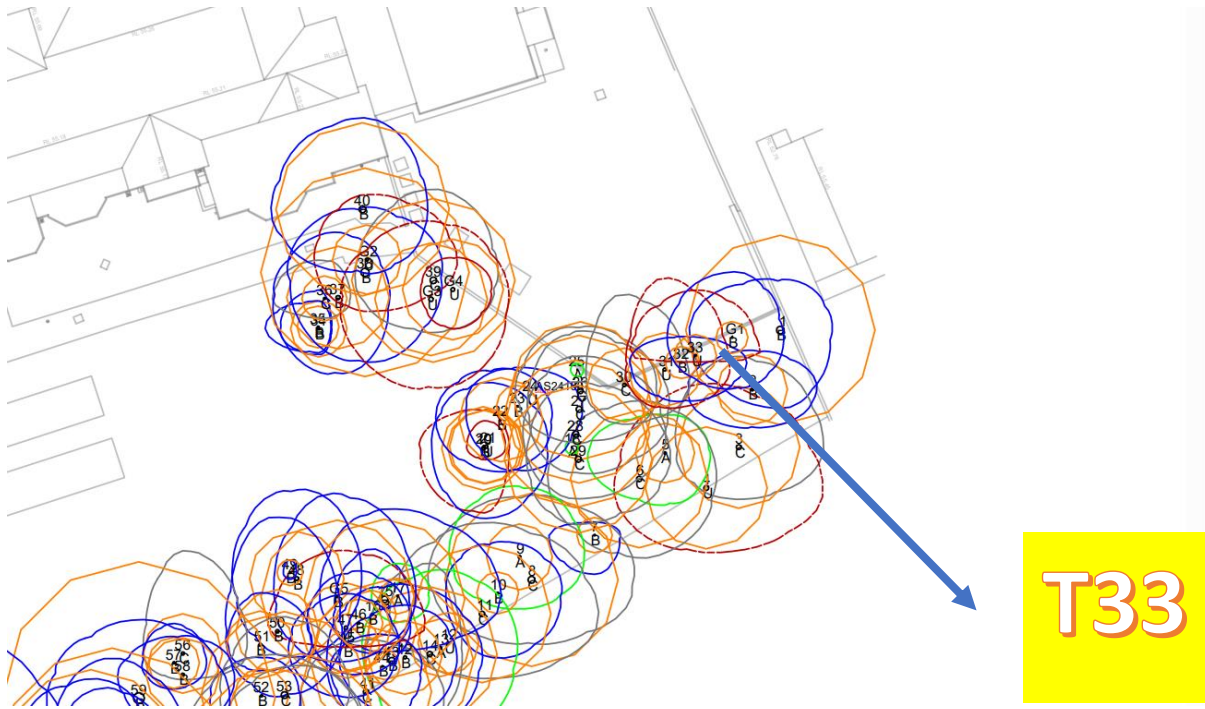

CONSERVATION AREA

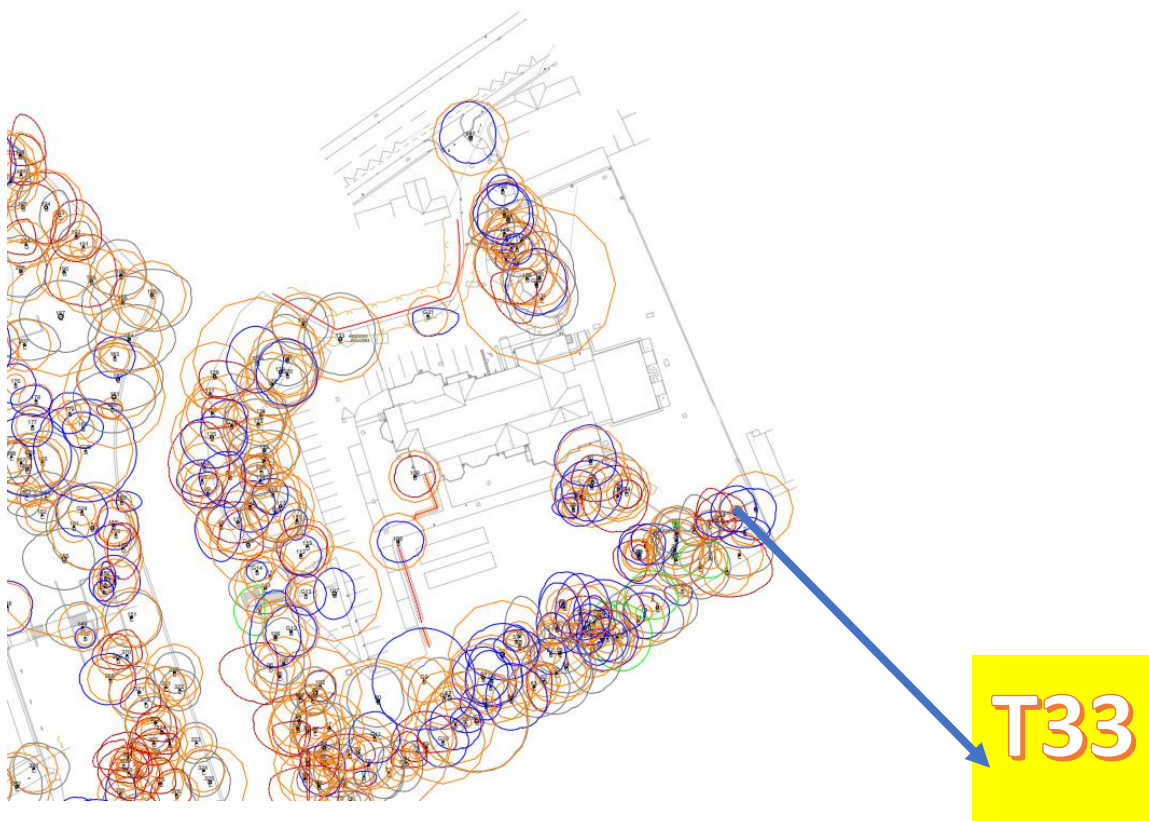

T67 – Common Ash - Windblown Ash already processed prior to survey, leave in length for habitat, saprophytic Jews Ear evident, no works required.



CONSERVATION AREA

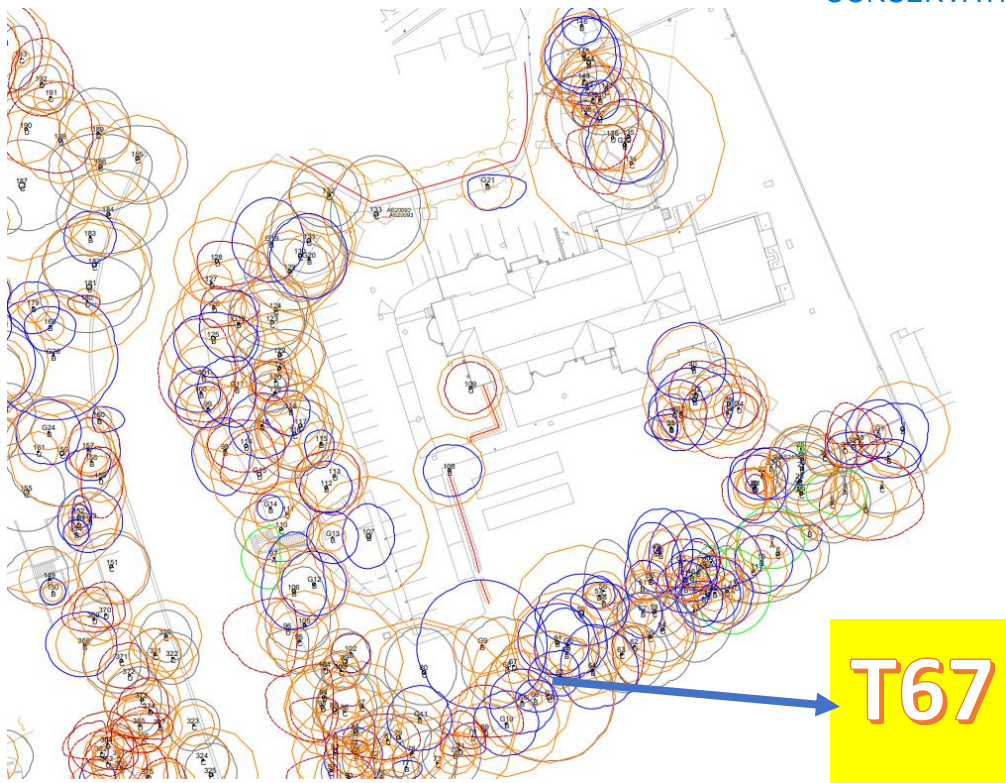

T93 – Sycamore - Difficult to determine trees health due to Ivy engulfing stem and crown, remove Ivy to reinspect.

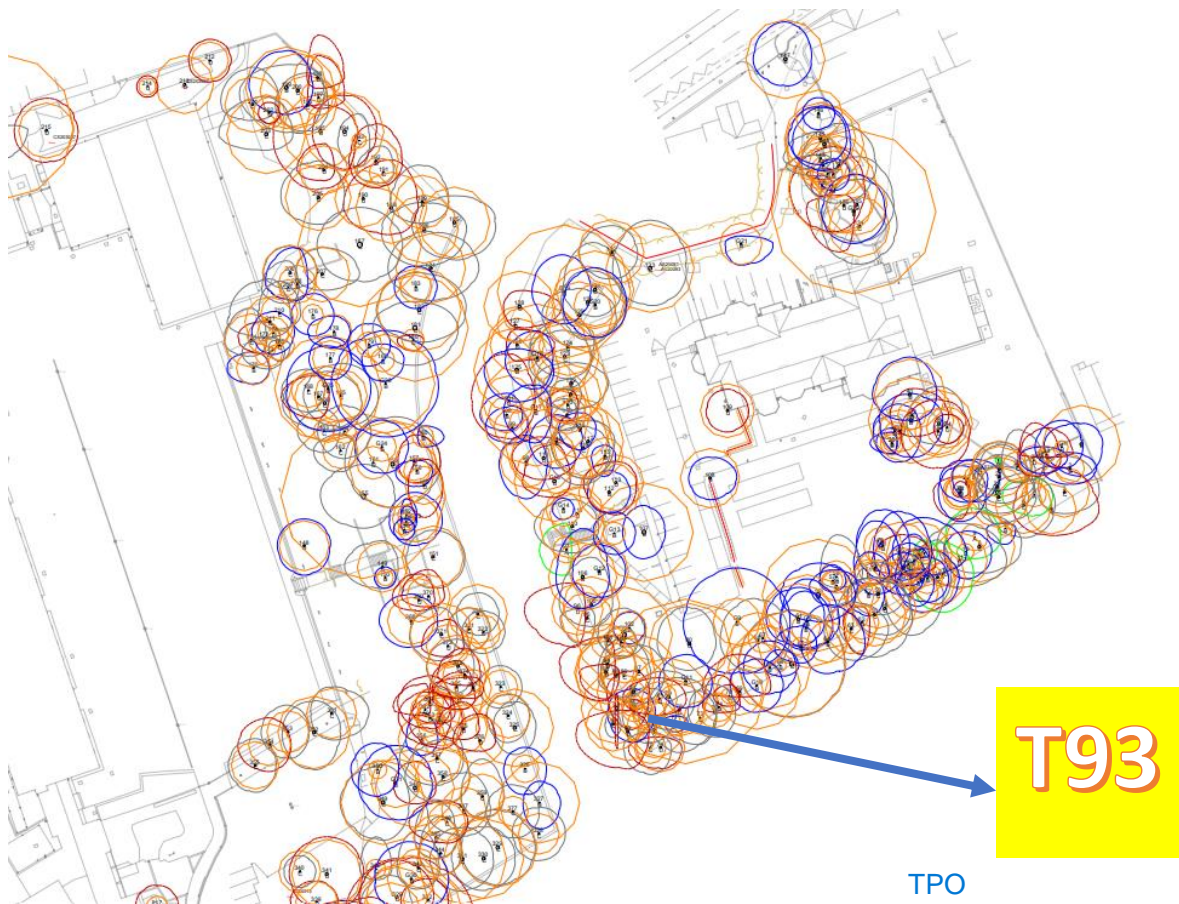
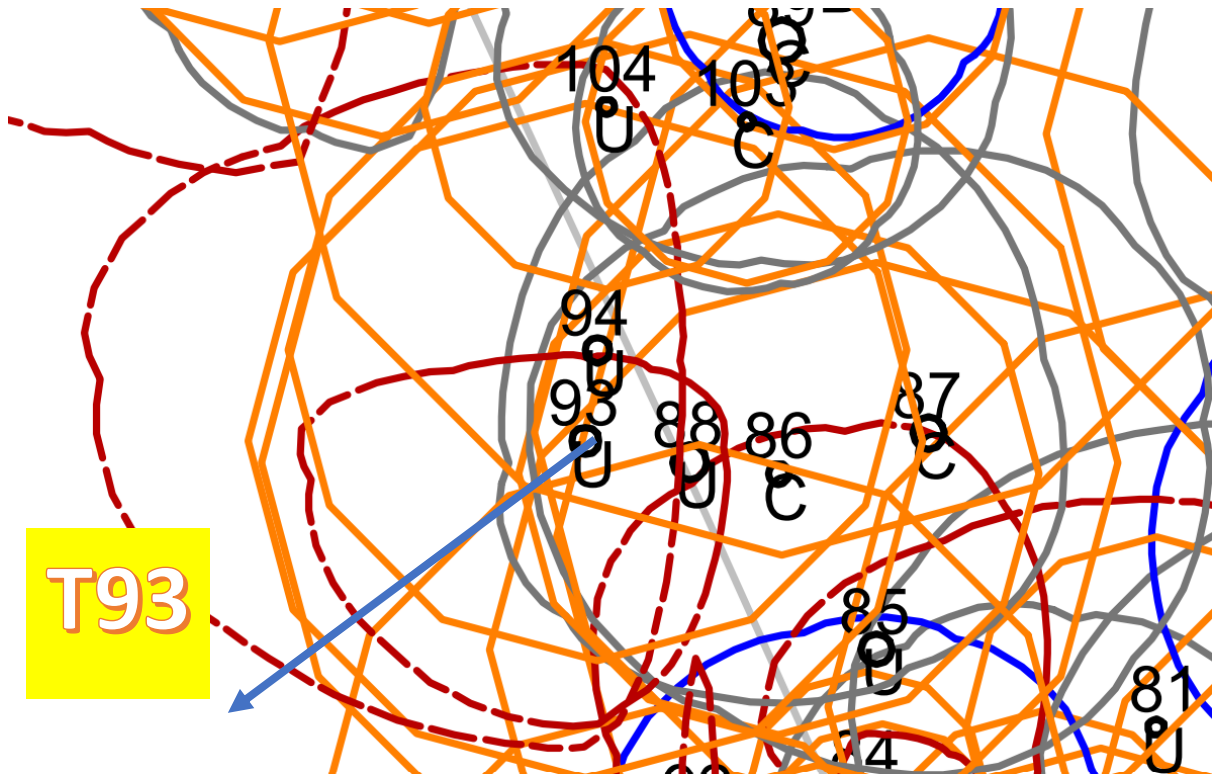

T104 – Swedish Whitebeam - Windblown tree, process and stack for habitat piles.

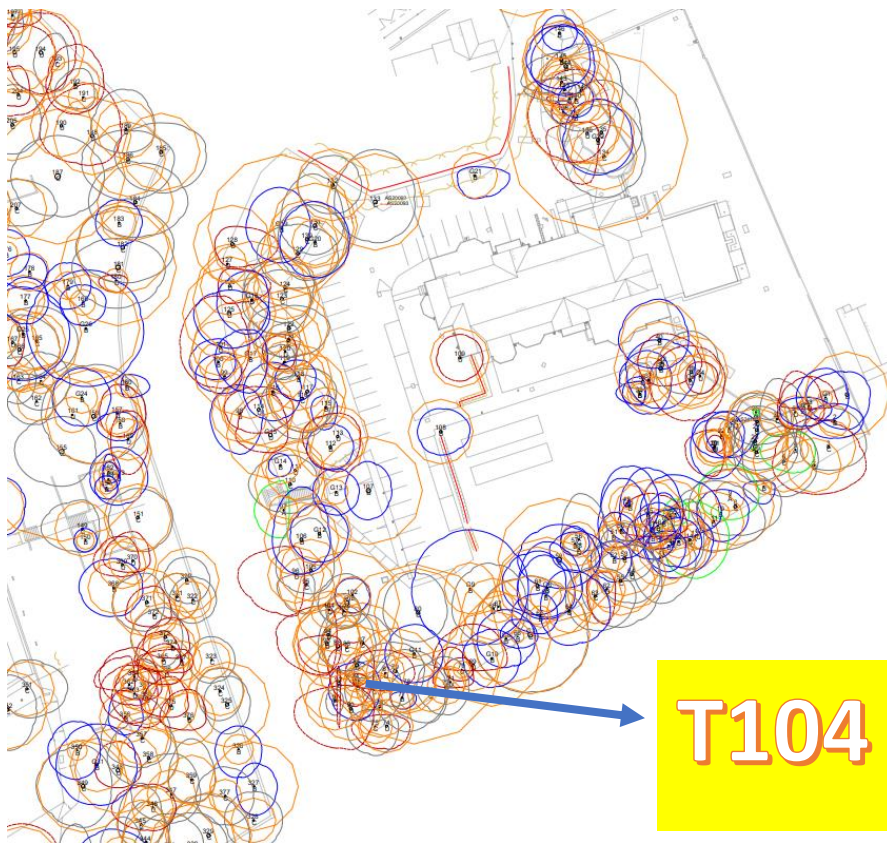
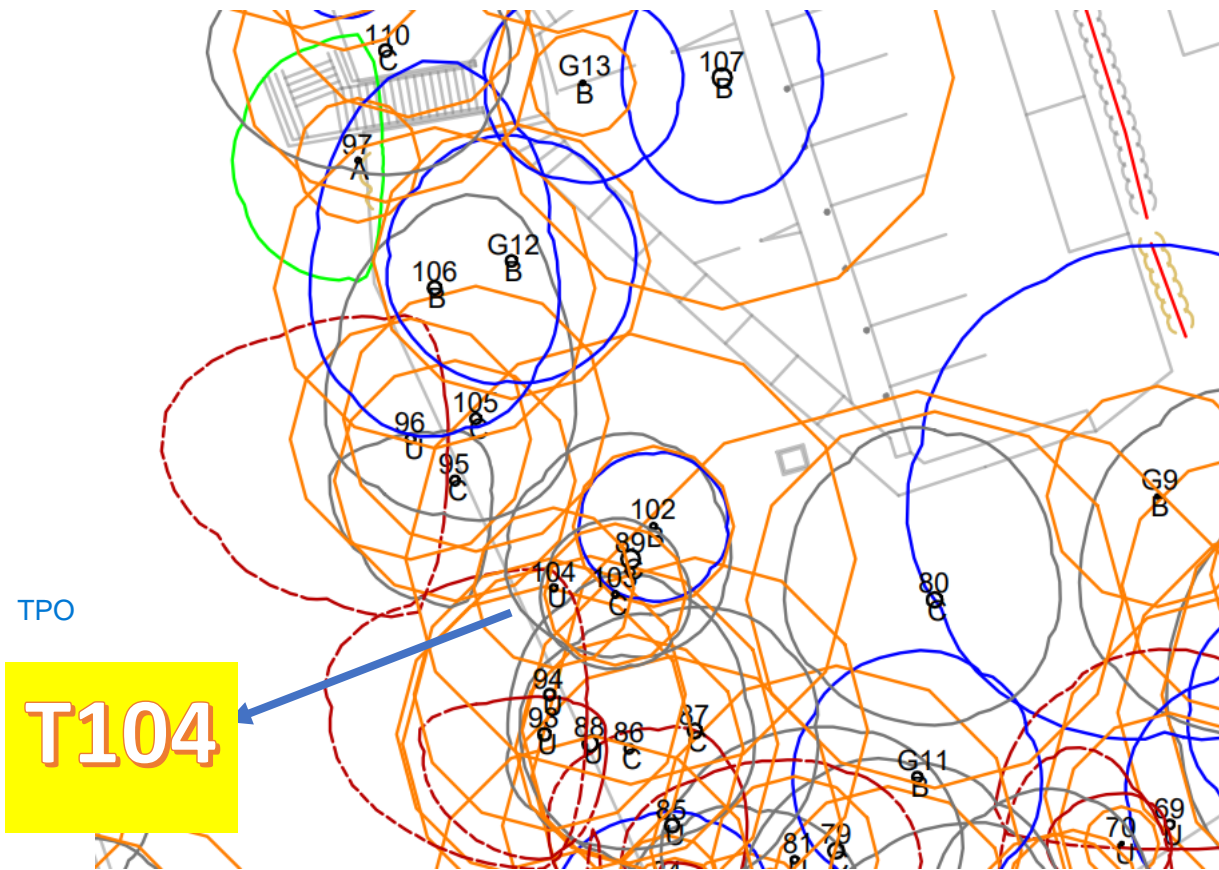

T111 -Swedish Sycamore - Crown has been removed and left as standing stem, no work required.

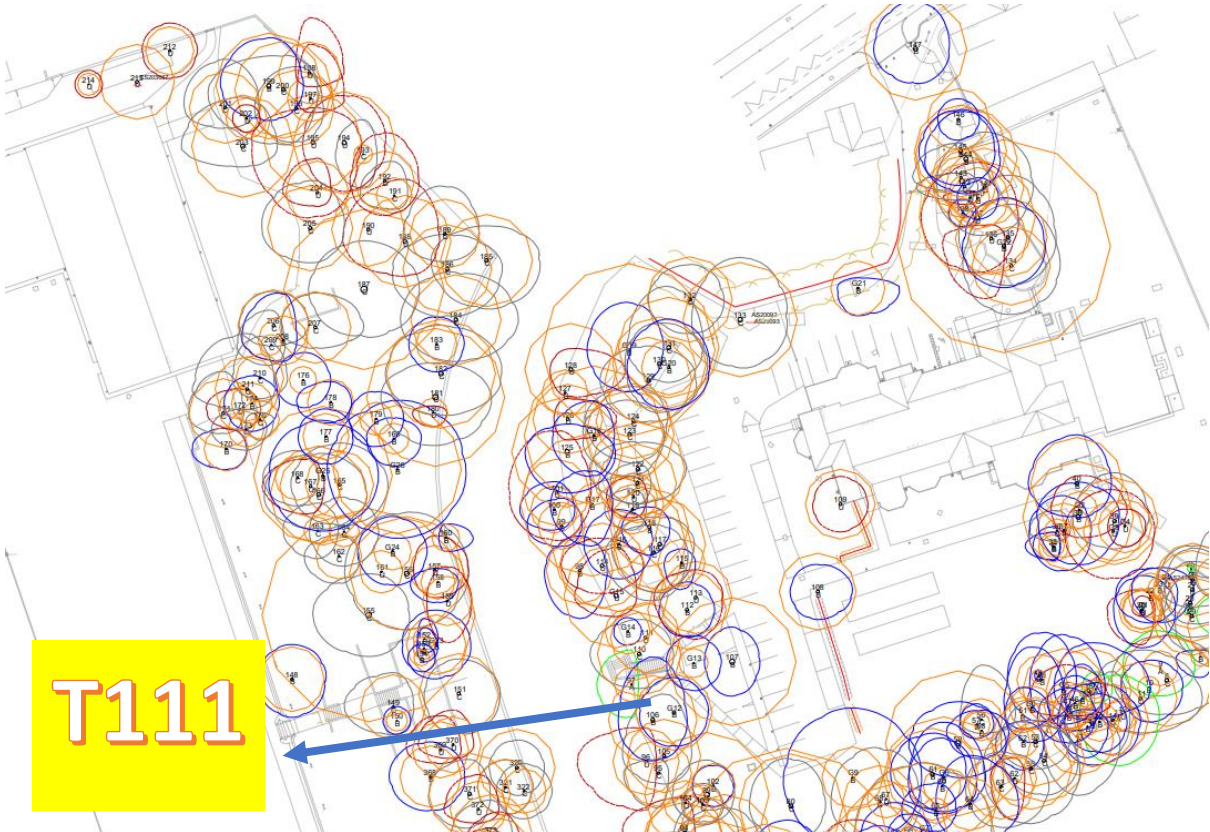
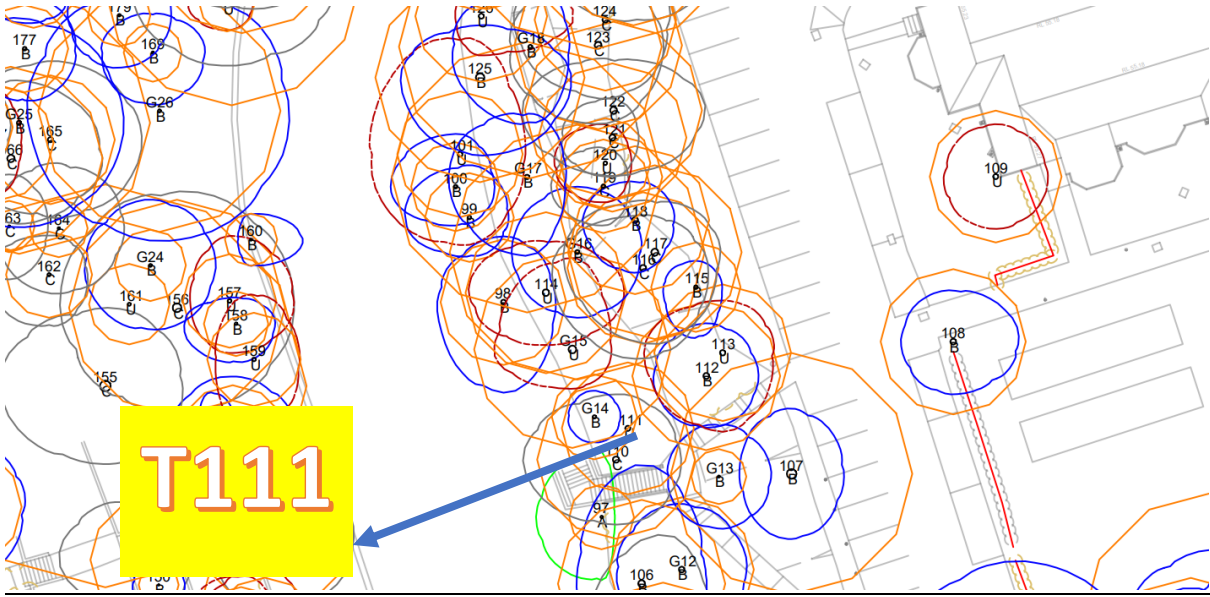

TPO

T136 – Common Lime - Massive lean southward to school building, poor specimen, suggest removal.



CONSERVATION

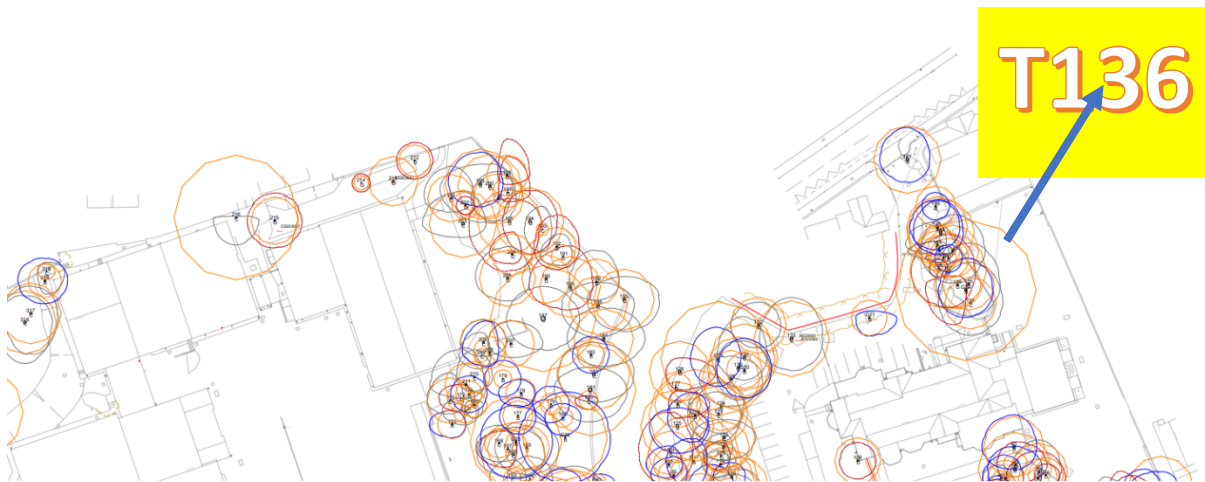

T137 - Common Ash - Major deadwood in the majority of crown, overhang on entrance road to Sixth Form, has all the characteristics of dieback, recommend removal or pollard at the very least.

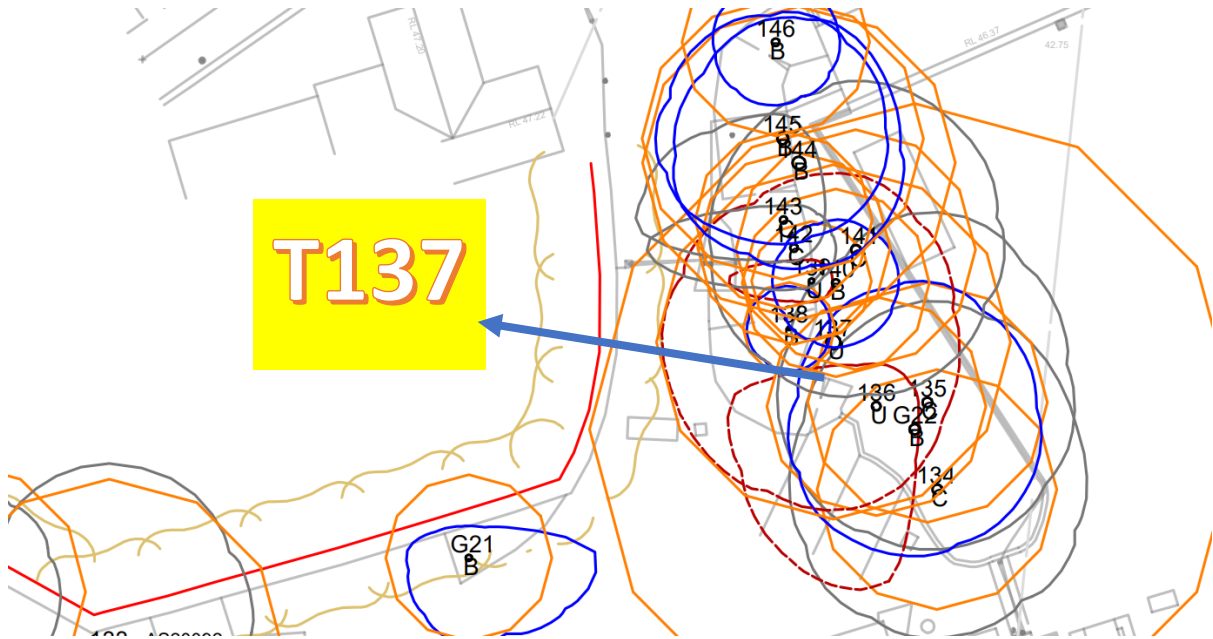

CONSERVATION

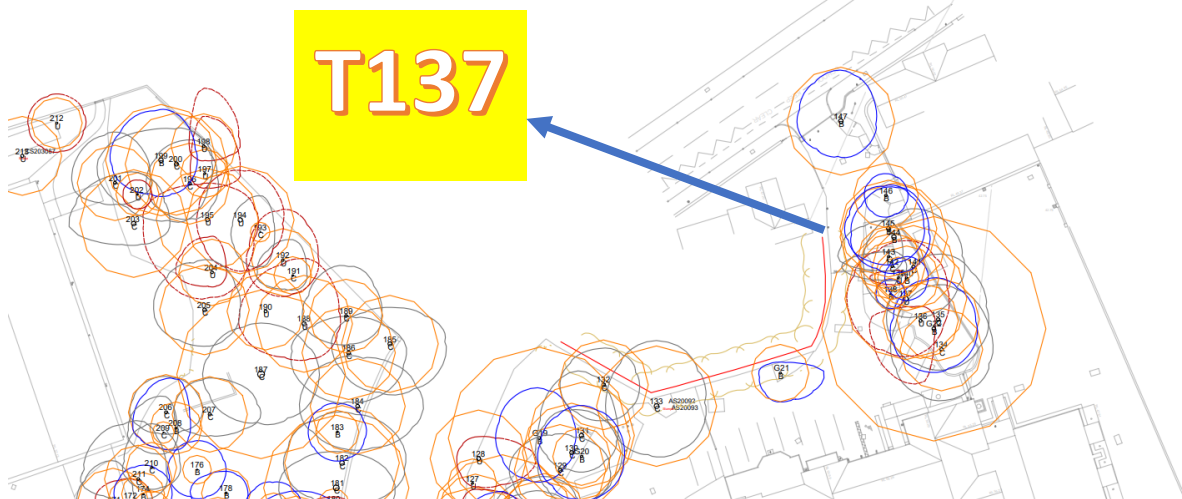

T139 – Common Lime - Large tear/cavity @ 4m on main stem, heartwood visible. Affecting crown of adjacent Yew, Lime is a poor specimen, removal recommended.

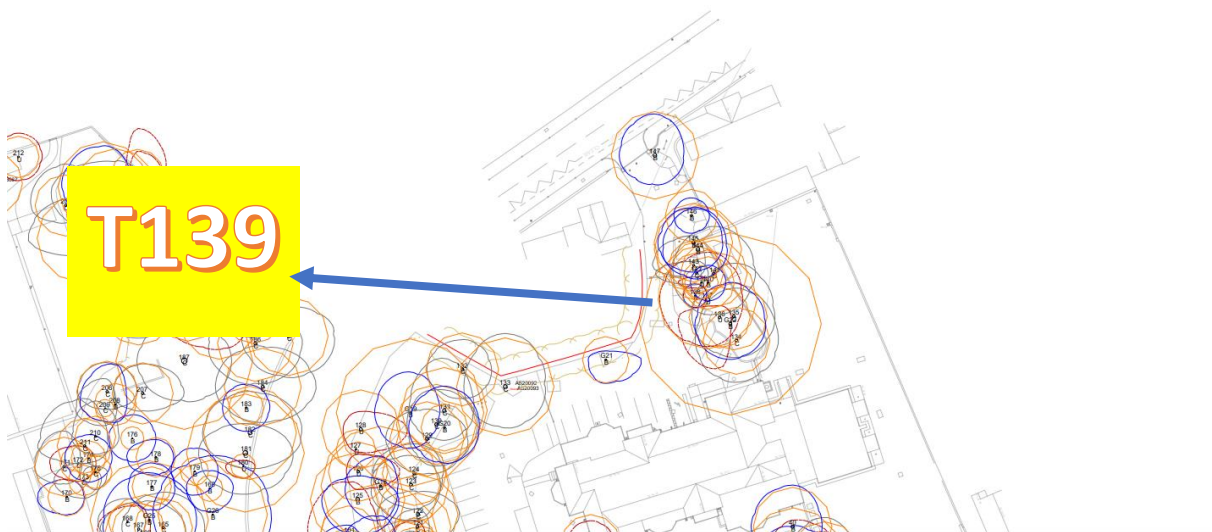

T161 – Common Ash - Windblown Ash, tips of crown touching wall, process and leave in piles for habitat.

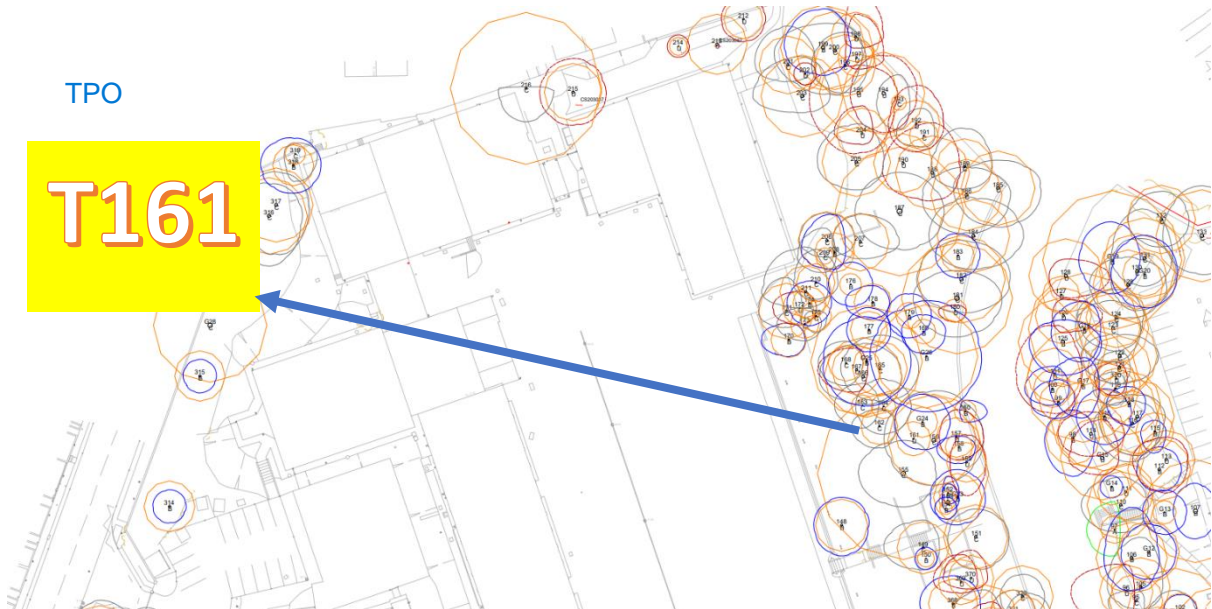
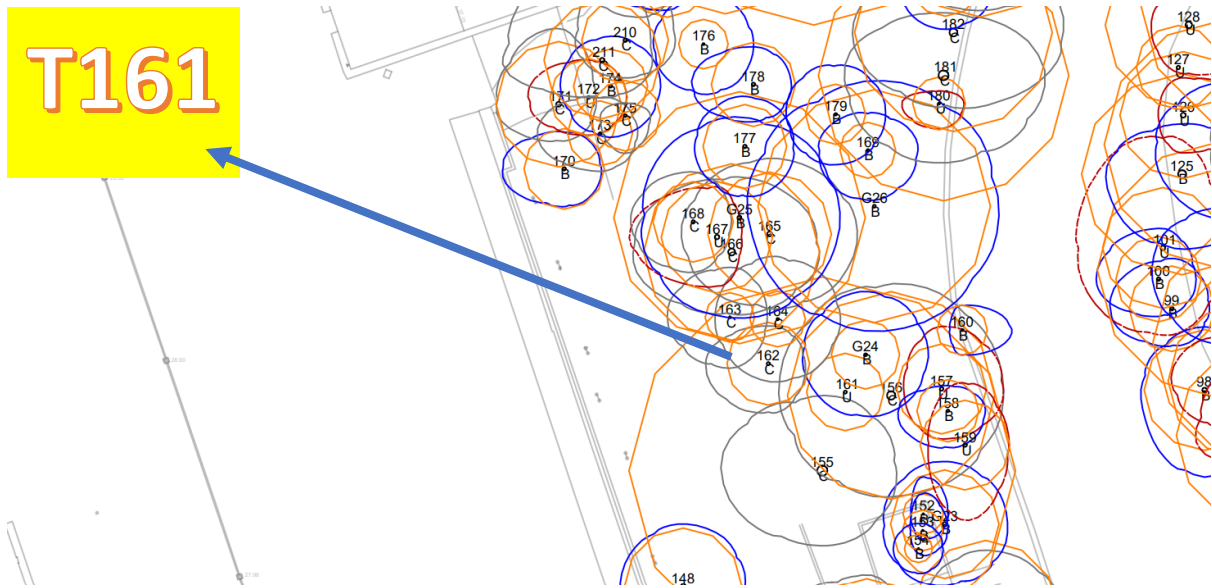

T167 – Sycamore - Severe westerly lean within falling distance of playground, Sycamore is a poor specimen which may have had scaffold branch failure @ 6m easterly side, hard to determine due to Ivy, recommend fell to eliminate risk.

T167
TPO

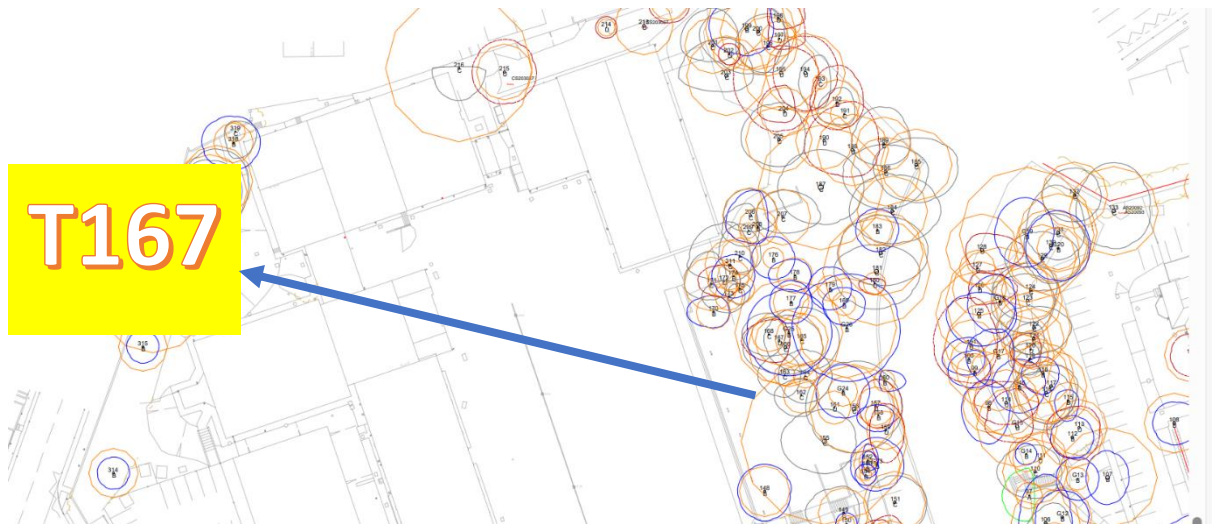

T213 – Black elder - Remove Elder stump to ground level.

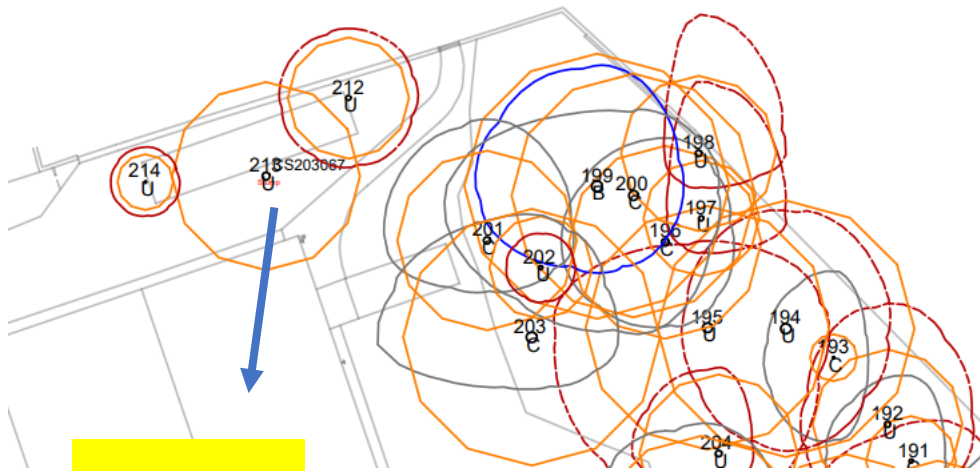

T213

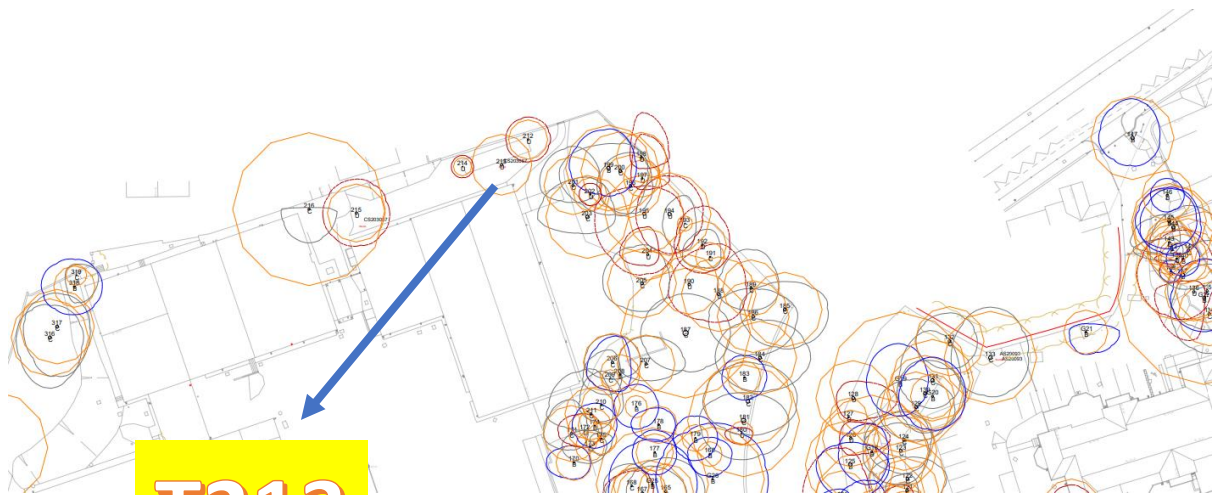

T213

CONSERVATION