

Notes  
 This document and its design content is copyright ©. It shall be read in conjunction with all other associated project information including models, specifications, schedules and related consultants documents. Do not scale from documents. All dimensions to be checked on site. Immediately report any discrepancies, errors or omissions on this document to the Originator. If in doubt ASK.

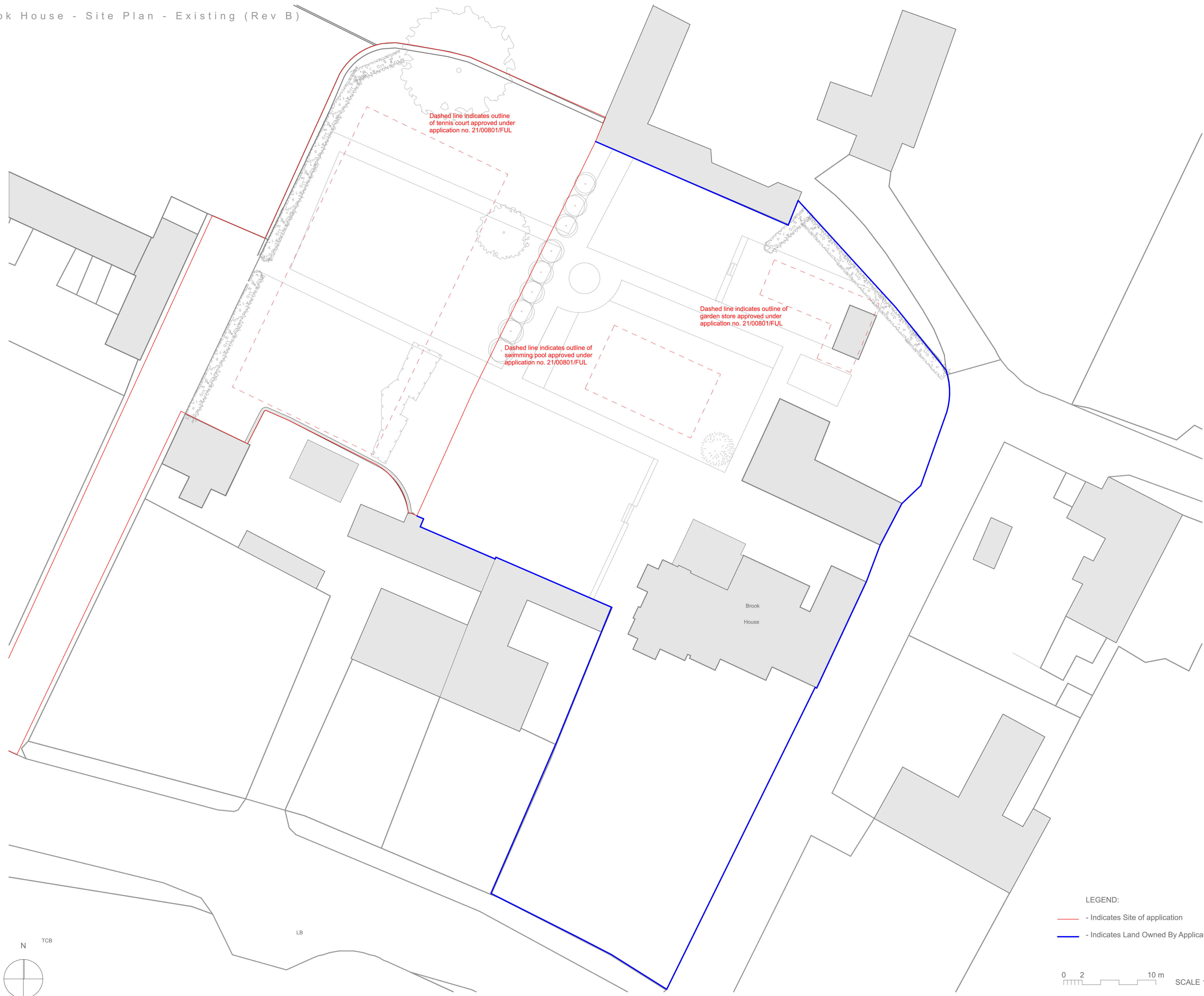

Dashed line indicates outline of tennis court approved under application no. 21/00801/FUL

Dashed line indicates outline of garden store approved under application no. 21/00801/FUL

Dashed line indicates outline of swimming pool approved under application no. 21/00801/FUL

Brook House

LEGEND:  
 - Indicates Site of application  
 - Indicates Land Owned By Applicant

0 2 10 m SCALE 1:200

-1. Site plan Existing

Rev ID	Date	
A	19/01/2024	
B	26/02/2024	Site outline and drawing status amended

Issued by:  
 Shen Carter Studio Ltd.  
 61 Marle Hill Parade, Cheltenham,  
 Gloucestershire, GL50 4LH  
 phone: 07968 404 387  
 email: j.carter@shencarterstudio

Project: Brook House	Project Number: 231
Status: <b>Planning</b>	Date: 26 February 2024
Client: Will Hine	Drawn By / Checked By: JC/YS

Project Address:  
 Brook House  
 Cheltenham  
 Glos.  
 GL54 3DR

Layout Title  
**Site Plan - Existing (Rev B)**

**shen carter studio**

Scales @	Drawing Number (project-status-layout ID)	Revision
1:200	231-PL-02	Rev B