

General Arrangement



General Arrangement showing key dimensions and Features



Notes
Based on topographical survey provided by applicant.

- Key
- Topographical survey base
 - Proposed access layout
 - Proposed access visibility lines
 - Proposed access levels
 - Asphalt surface
 - Free draining hoggin or similar
 - Rainwater run-off infiltration trench

Vehicle Details

DB32 Private Car
 Overall Length 4.223m
 Overall Width 1.715m
 Overall Body Height 1.392m
 Min Body Ground Clearance 0.233m
 Max Track Width 1.629m
 Lock to lock time 4.00s
 Kerb to Kerb Turning Radius 5.780m

Rev	By	Chkd	Apprv	Date	Description
B	JH	JH	JH	28.02.24	Fence added
A	JH	JH	JH	09.01.24	Details added

Client
Stephen Lewis

Project
No. 5 The Green Uley

Drawing
Plan Showing Indicative Access Improvements, Key Dimensions Features and Vehicle Manoeuvres

Drawn by: JH Date: 07/11/2023
 Checked by: JH Date: 07/11/2023
 Approved by: JH Date: 07/11/2023

Drawing No. **2330DWG01** Revision **B**

Drawing Scale: 1:200@A1

Vehicle Manoeuvres at the Junction with The Street

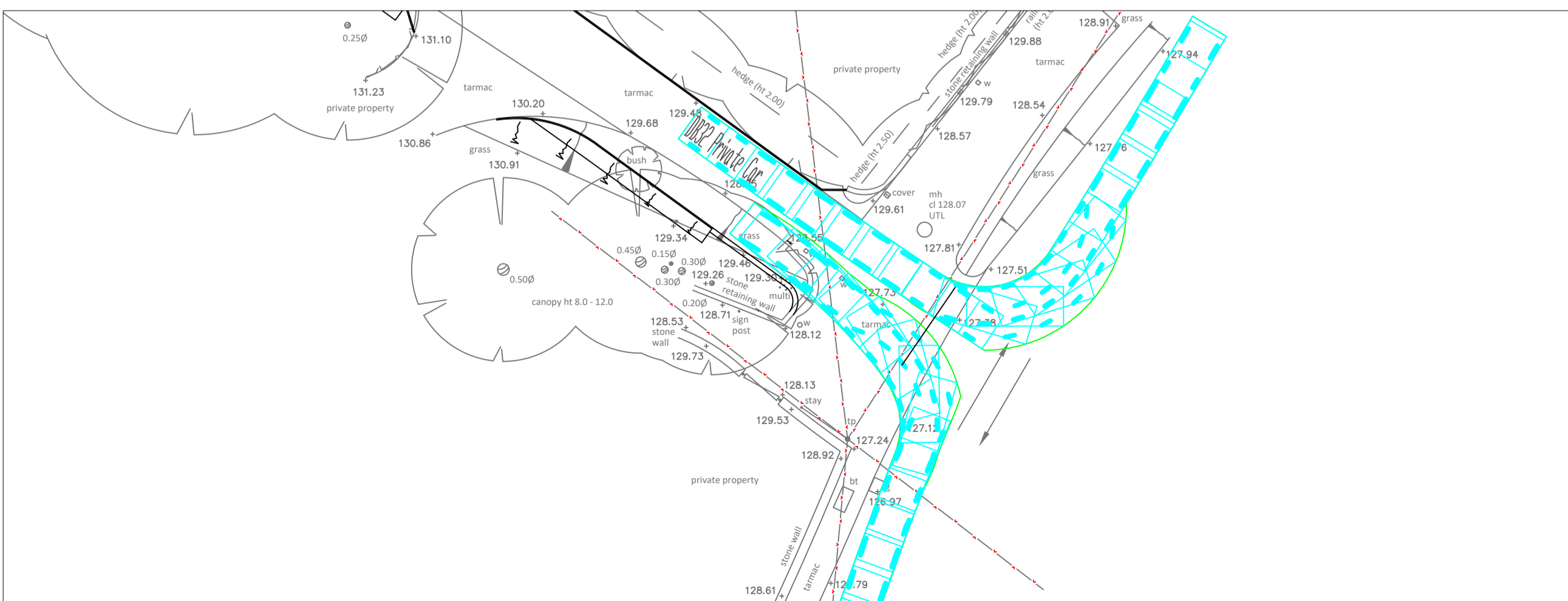

Vehicle Manoeuvres at the Site Entrance

