

Rev	Description	Date	By

FIRST FLOOR PLAN

"A"

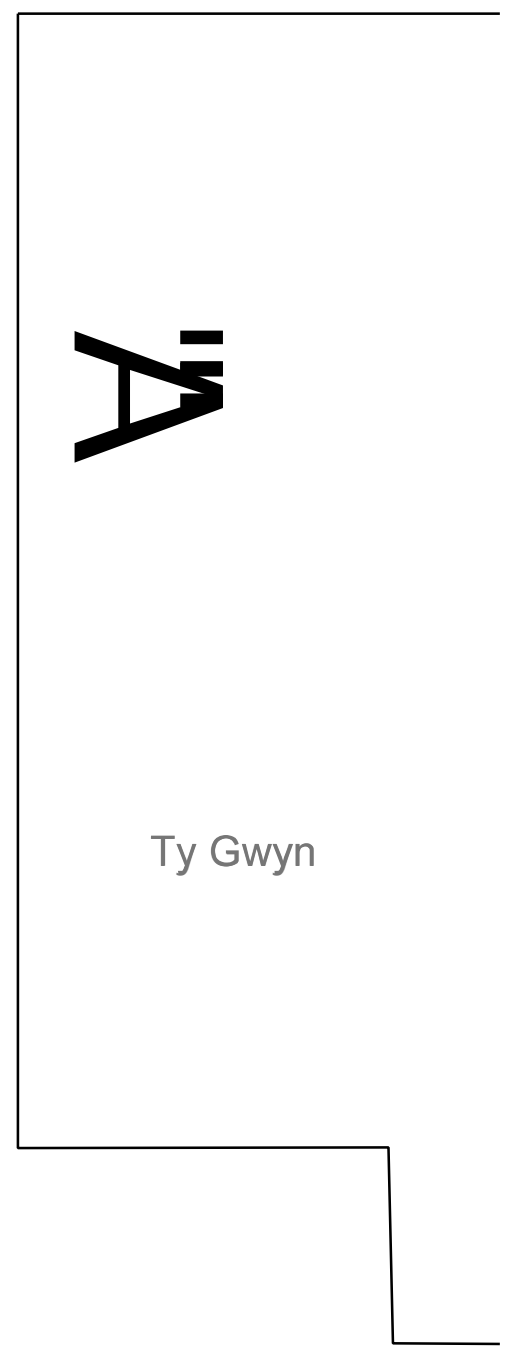
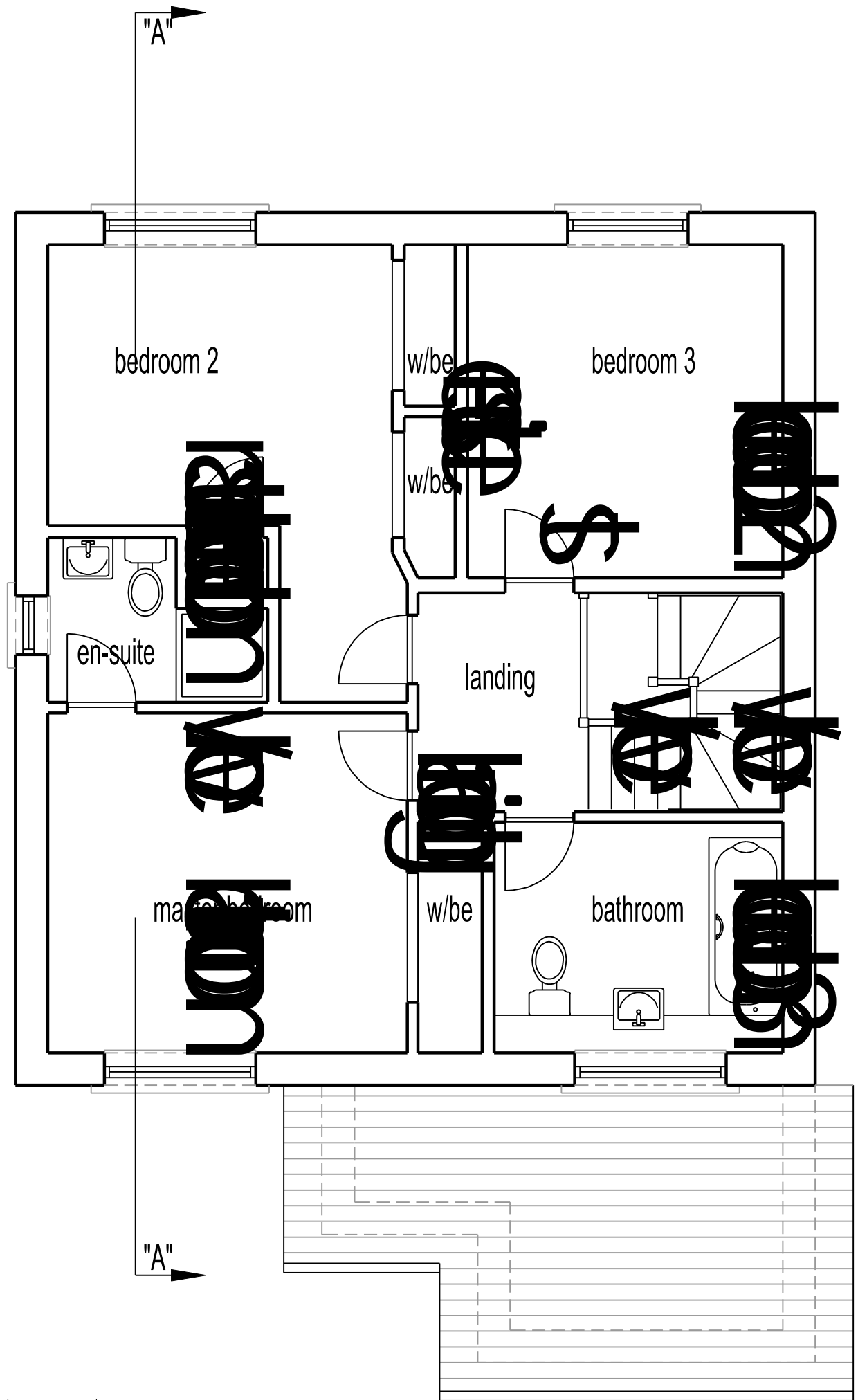

FIRST FLOOR PLAN

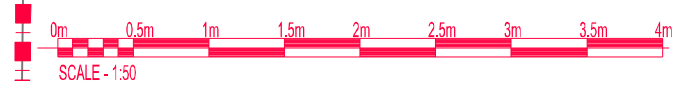

2 CHANDLERS'S RISE, ELGIN. IV30 4JE
Proposed Alterations and Extension to House
First Floor Plan - As Existing

James Roberts		770-004	REV
DATE 26/02/2024	SCALE 1:50	DRAWN K. Duncan	SHEET A3
STATUS Planning			

KEN DUNCAN MCIAT
BUILDING DESIGN | ARCHITECTURAL TECHNOLOGY | INTERIOR DESIGN

2 Glen Royal, Glenburn Road, Rothesay, ISLE of BUTE PA20 9JP
Mobile: 07311 266105 e-mail: kenduncan1td@gmail.com