

Rev	Description	Date	By

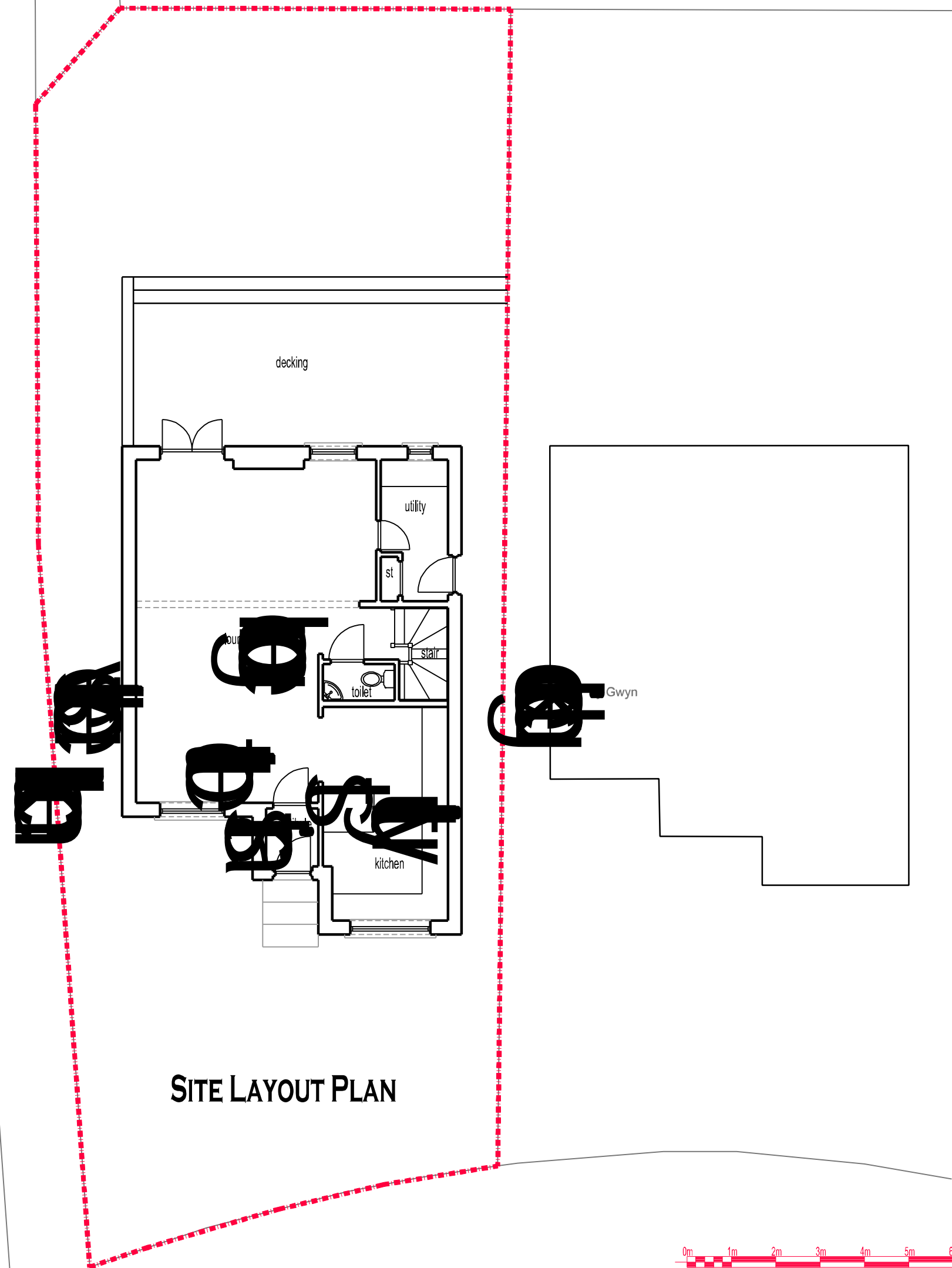

Roberts
 CHANDLERS RISE

SITE LAYOUT PLAN

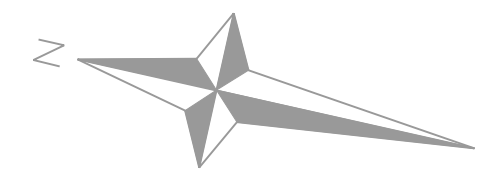
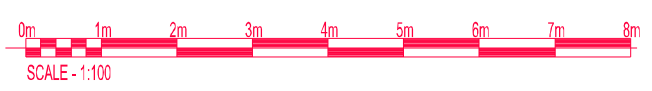

2 CHANDLERS'S RISE, ELGIN. IV30 4JE				
Proposed Alterations and Extension to House				
Site Layout Plan - As Existing				
James Roberts			770-002	
DATE	SCALE	DRAWN	SHEET	STATUS
26/02/2024	1:100	K. Duncan	A3	Planning



2 Glen Royal, Glenburn Road, Rothesay, ISLE of BUTE PA20 9JP
 Mobile: 07311 266105 e-mail: kenduncan1td@gmail.com

