

Rev	Description	Date	By

Rothesay

"A"

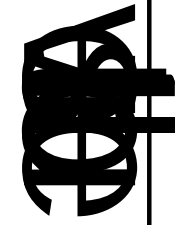

Rothesay

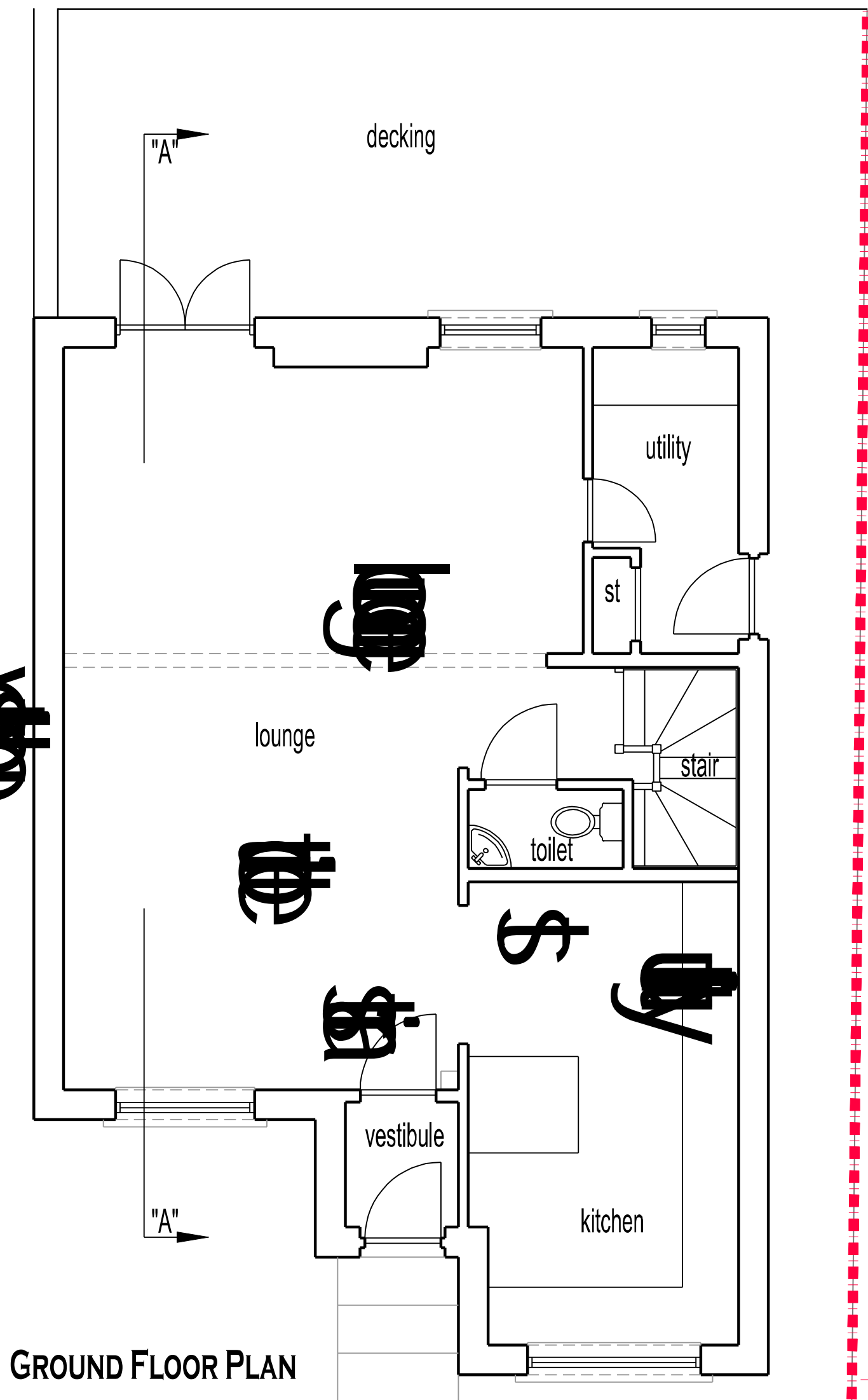

GROUND FLOOR PLAN

"A"

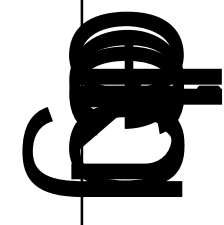

Ty Gwyn

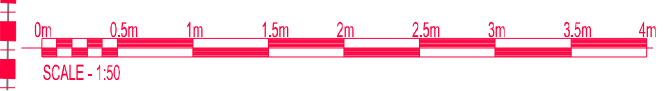

2 CHANDLERS'S RISE, ELGIN. IV30 4JE  
Proposed Alterations and Extension to House  
Ground Floor Plan - As Existing

James Roberts		770-003	REV
DATE 26/02/2024	SCALE 1:50	DRAWN K. Duncan	SHEET A3
STATUS Planning			

**KEN DUNCAN** MCIAT  
BUILDING DESIGN ARCHITECTURAL TECHNOLOGY INTERIOR DESIGN

2 Glen Royal, Glenburn Road, Rothesay, ISLE of BUTE PA20 9JP  
Mobile: 07311 266105 e-mail: kenduncan1td@gmail.com