

134 Kirkby Road Barwell LE9 8FN UK  
 T: +44 (0)1455 446521 F: +44 (0)1455 446521  
 E: admin@thedesignsocial.com

GENERAL DRAWING NOTES

© This drawing is not to be shown to any Third Party unless agreed by The Design Social.

This drawing shows 'design intent' only.  
 It is the responsibility of the appointed contractor to finalise development, using specialists approved by The Design Social, & produce detailed working drawings.  
 ALL working drawings to be approved by The Design Social prior to manufacture.

		Alteration to application 22/0153/HH. Proposed boundary wall to extend across frontage.	B.R.
A	30/01/2024		
REV.	DATE	NOTES	REV. BY

Edward Wilkes			
Easton House, Hinckley Road, Aston Flamville, LE10 3AG			
Site Plan			
AUTHOR	DATE	APPROVED	
B.R.	19/01/2022	E.W.	
SCALE	READ WITH		
1:200 @ A3	0216 (A) GA 001		
DRAWING No.			
<b>0216</b>	<b>(A)</b>	<b>GA 003</b>	<b>A</b>
Project No.	Type	Area	Number Rev
DRAWING STATUS			
For Approval			

Site Plan Notes

1. Property perimeter outlined in red.
2. Proposed gated entrance to property.
3. Existing close boarded fencing to be replaced with brick perimeter walls.
4. Existing brickwork perimeter wall to be removed & rebuilt further back from the highway.
5. Alteration to approved planning application 22/0153/HH. Proposed boundary wall to extend across former parking space.

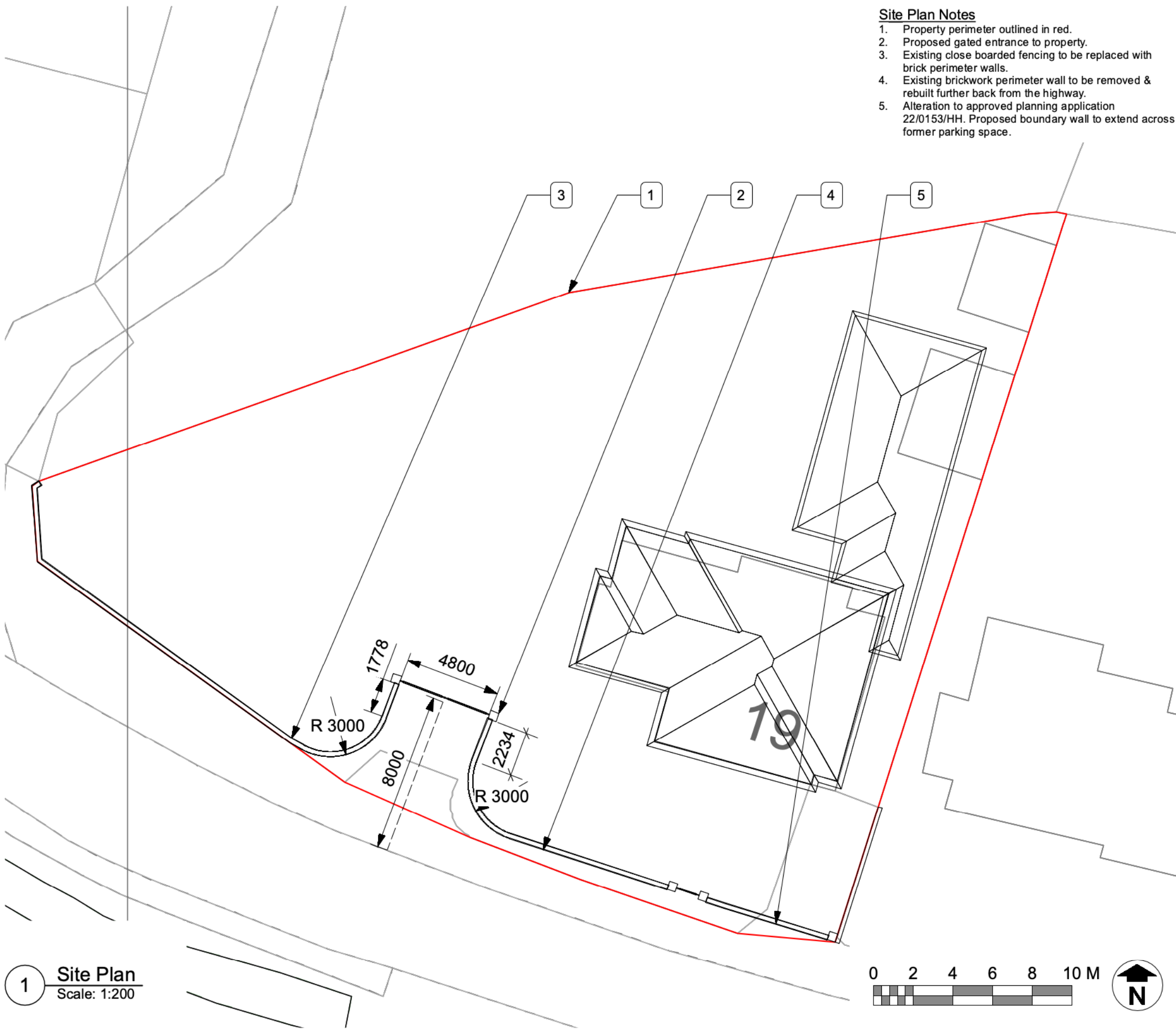

1 Site Plan  
 Scale: 1:200