

Important
The contractor will be held to have examined the site and checked all dimensions and levels before commencing construction work. No assumption should be made without reference to the architect. No dimensions should be scaled from this drawing.

Revision _____ Date _____



Block Plan - 1:500

Produced on 20 February 2024 from the Ordnance Survey National Geographic Database and incorporating surveyed revision available at this date.

This map shows the area bounded by 293721 641866,293863 641866,293863 642008,293721 642008,293721 641866

Crown copyright and database rights 2024 OS 100054135. Supplied by copla ltd trading as UKPlanningMaps.com a licensed Ordnance Survey partner (OS 100054135).

Data licence expires 20 February 2025. Unique plan reference: v2e//1061802/1430217

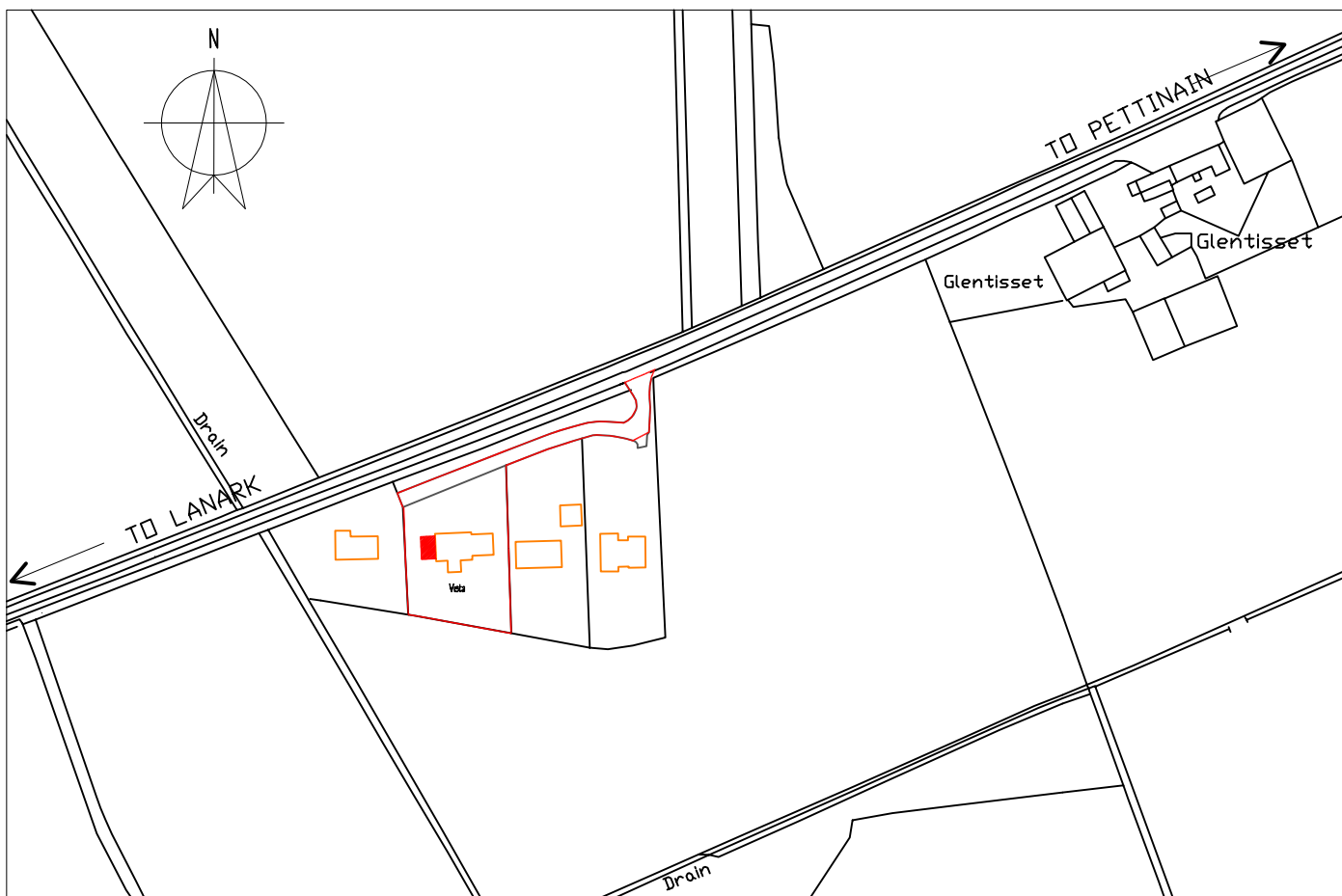

Location Plan - 1:1250

Calum Smith Architect

Woodlands
134 New Trows Road T 01555 893122
Lasmahagow M 0773 0067409
Lanarkshire F 01555 893122
ML11 0ER E info@calumsmitharchitect.co.uk



PLANNING

Client
MR & MRS BRYAN GRAY

Project Title
PROPOSED GABLE EXTENSION TO VISTA, GLENTISSET ROAD, PETTINAIN, ML11 8SL

Drawing Title
PROPOSED BLOCK PLAN & LOCATION PLAN

Scale
1:500 & 1:1250 & A3

Date
FEBRUARY 2024

Job No.
390

Drawing No.
01

Rev.