

01

WHIN

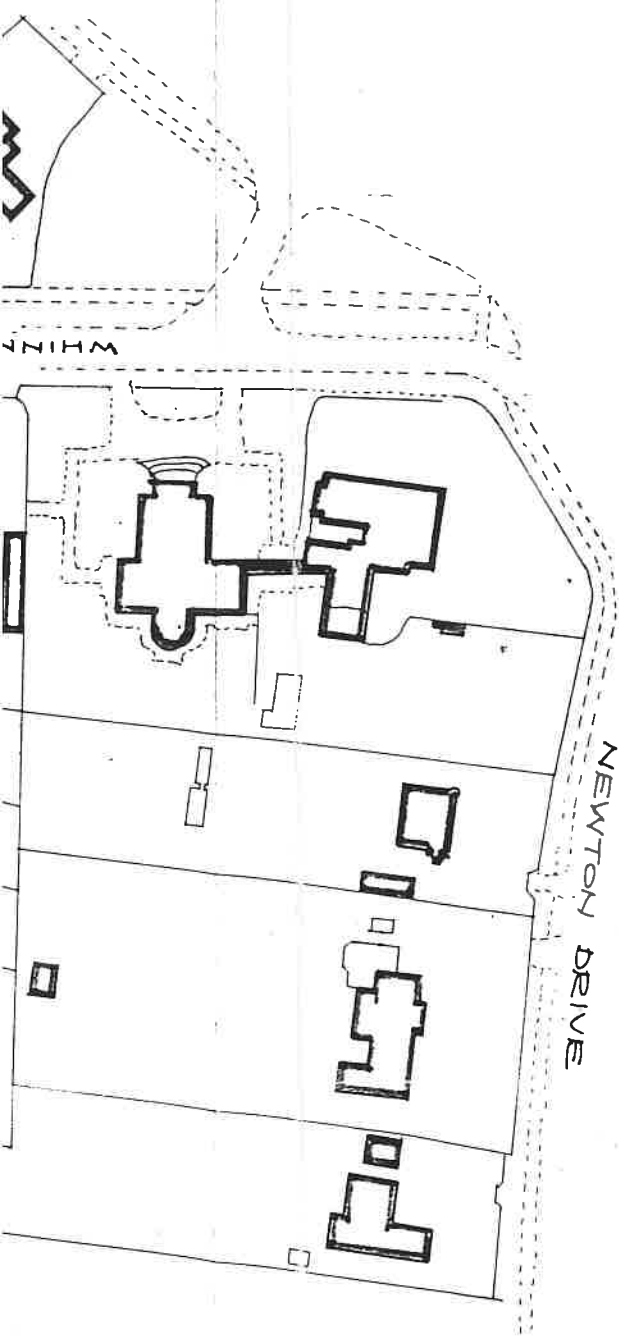

BURWOOD DRIVE



proposed dwelling
 11.5m
 NEW DRIVEWAY

A diagram showing a proposed dwelling with a dimension of 11.5m. A new driveway is indicated with an arrow pointing towards the dwelling. The dwelling is a rectangular structure with a small square feature on its side.

COTTESMORE PL.

