

- ▭ design freeze survey area
  - ▭ previous corridor survey area
  - ▭ CCS Scheme Geophysical Survey (ASWYAS 2012)
  - ▭ AP and LiDAR assessment (Deegan 2021)
  - ▭ HER data
- | TYPE OF ANOMALY  | INTERPRETATION        |
|--|-----------------------|
| <span style="color: black;">●</span> dipolar isolated      | ferrous material      |
| <span style="color: grey;">■</span> magnetic disturbance   | ferrous material      |
| <span style="color: grey;">■</span> magnetic enhancement   | uncertain             |
| <span style="color: brown;">—</span> linear trend          | ridge and furrow      |
| <span style="color: green;">—</span> linear trend          | agricultural          |
| <span style="color: green;">—</span> linear                | former field boundary |
| <span style="color: blue;">—</span> linear trend           | geological variation  |
| <span style="color: blue;">■</span> magnetic enhancement   | geology               |
| <span style="color: orange;">■</span> magnetic enhancement | archaeology?          |

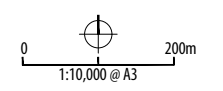

PROJECT SEGL21  
Scotland England Green Link 2  
North Yorkshire and  
East Yorkshire

CLIENT AECOM

**HEADLAND  
ARCHAEOLOGY**

Headland Archaeology Yorkshire & North  
Units 23-25 | Acorn Business Centre | Balme Road  
Cleckheaton | BD19 4EZ  
t 0127 493 8019  
w www.headlandarchaeology.com

ILLUS 13 Interpretation of magnetometer data; Overview 6

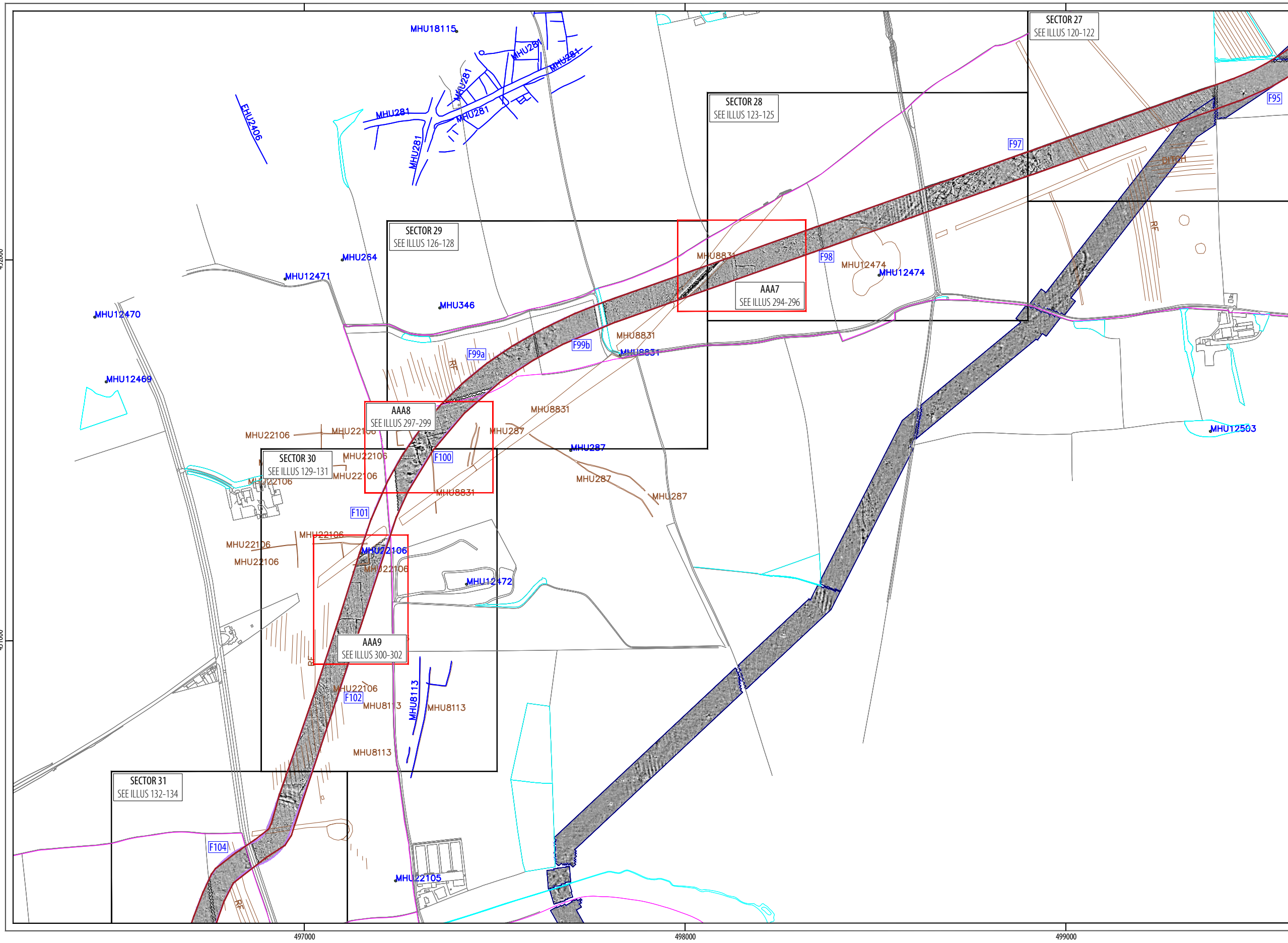

- design freeze survey area
- previous corridor survey area
- CCS Scheme Geophysical Survey (ASWYAS 2012)
- AP and LiDAR assessment (Deegan 2021)
- HER data

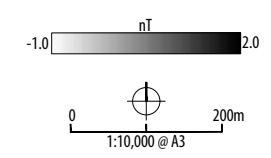

PROJECT SEGL21  
 Scotland England Green Link 2  
 North Yorkshire and  
 East Yorkshire

CLIENT AECOM



Headland Archaeology Yorkshire & North  
 Units 23-25 | Acorn Business Centre | Balme Road  
 Cleckheaton | BD19 4EZ  
 t 0127 493 8019  
 w www.headlandarchaeology.com

ILLUS 14 Processed greyscale magnetometer data; Overview 7

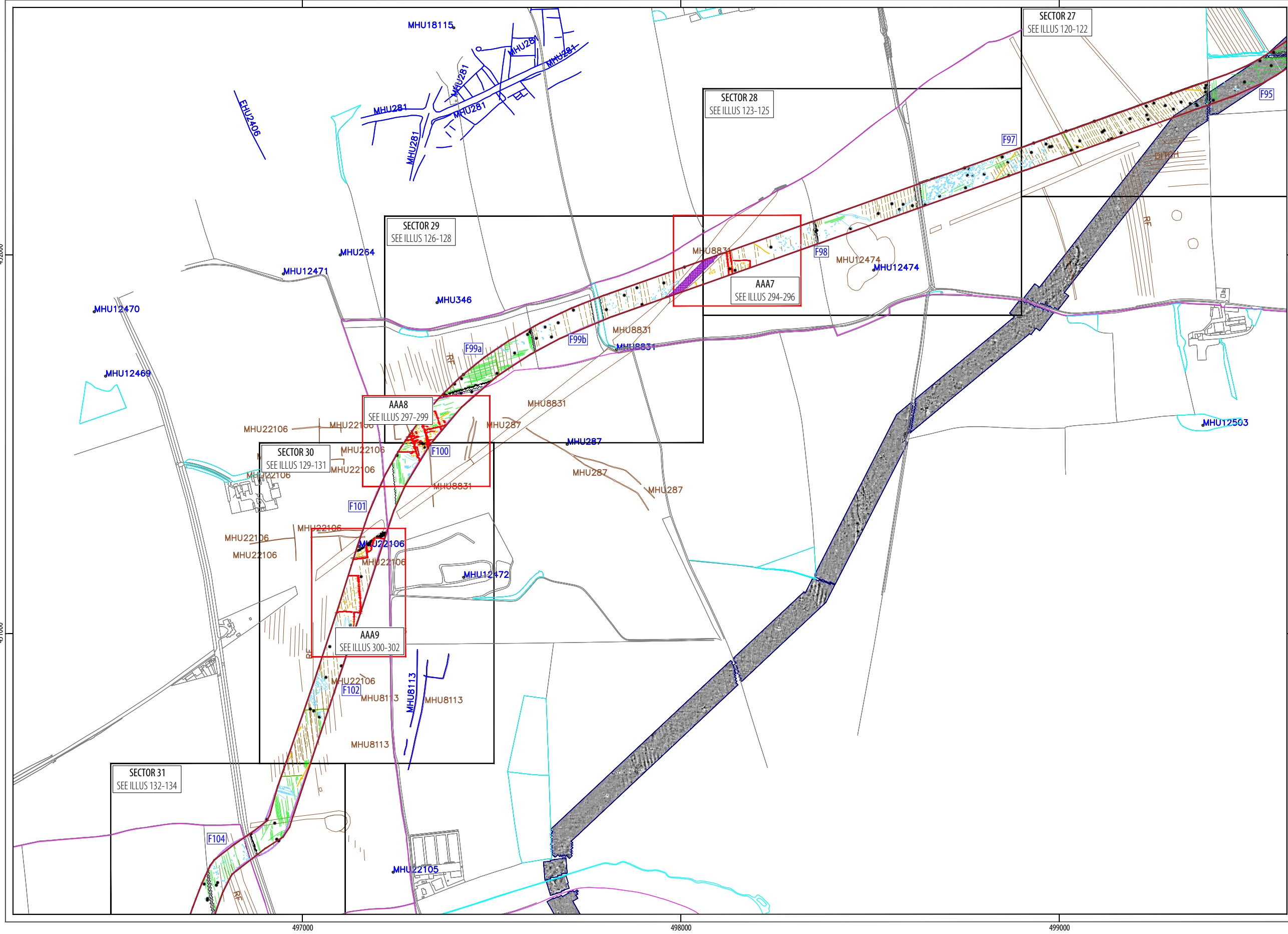

■ design freeze survey area  
■ previous corridor survey area  
■ CCS Scheme Geophysical Survey (ASWYAS 2012)  
■ AP and LiDAR assessment (Deegan 2021)  
■ HER data

| TYPE OF ANOMALY        | INTERPRETATION        |
|------------------------|-----------------------|
| ● dipolar isolated     | ferrous material      |
| ● magnetic disturbance | ferrous material      |
| ■ magnetic disturbance | former building       |
| — linear trend         | ridge and furrow      |
| — linear trend         | agricultural          |
| — linear               | former field boundary |
| — linear trend         | geological variation  |
| ● magnetic enhancement | geology               |
| ● magnetic enhancement | archaeology?          |
| ● magnetic enhancement | archaeology           |

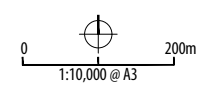

PROJECT SEGL21  
 Scotland England Green Link 2  
 North Yorkshire and  
 East Yorkshire  
  
 CLIENT AECOM  
  
**HEADLAND  
 ARCHAEOLOGY**  
 Headland Archaeology Yorkshire & North  
 Units 23-25 | Acorn Business Centre | Balme Road  
 Cleckheaton | BD19 4EZ  
 t 0127 493 8019  
 w www.headlandarchaeology.com

ILLUS 15 Interpretation of magnetometer data; Overview 7

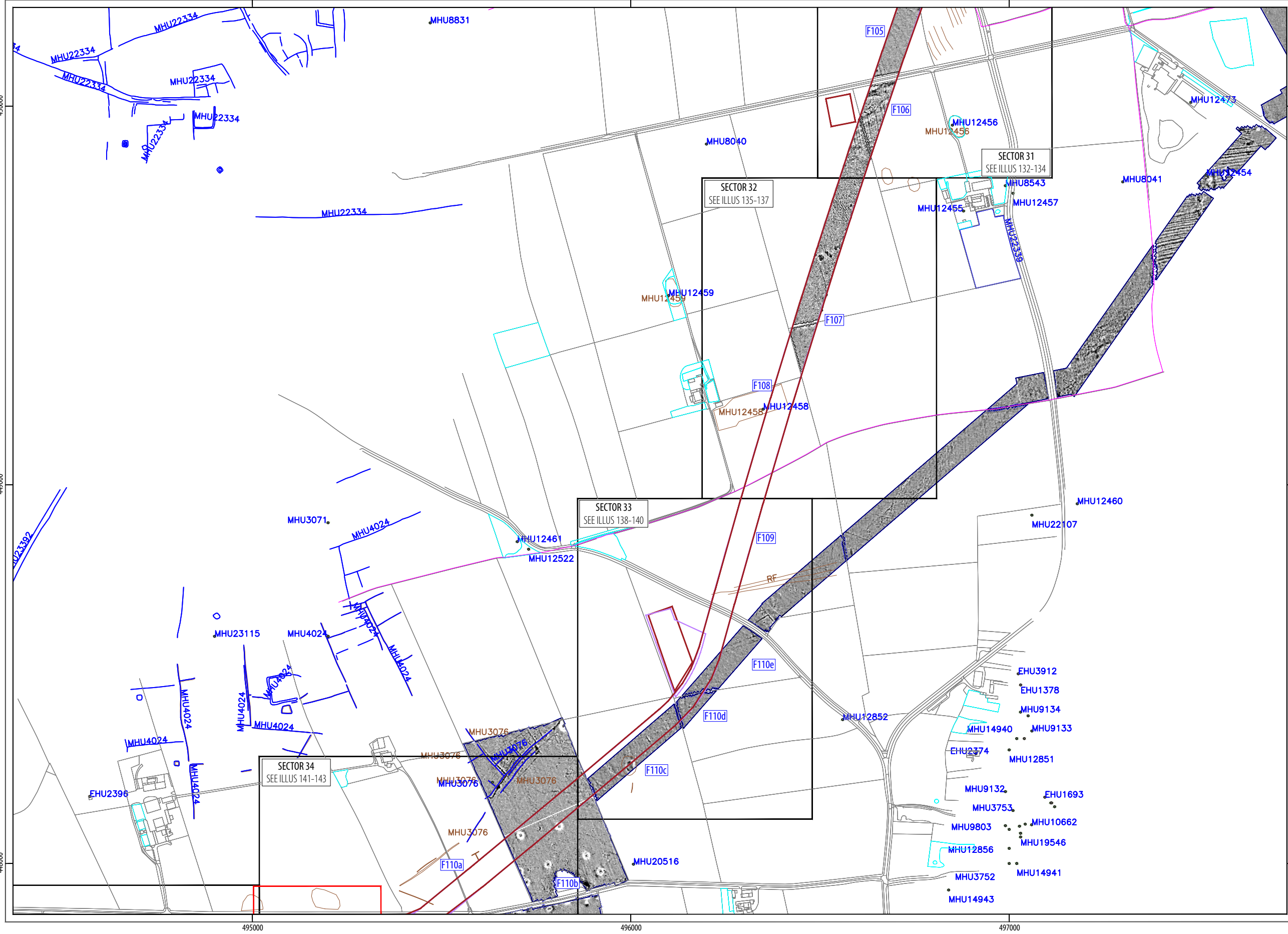

- ▭ design freeze survey area
- ▭ previous corridor survey area
- ▭ CCS Scheme Geophysical Survey (ASWYAS 2012)
- ▭ AP and LiDAR assessment (Deegan 2021)
- HER data

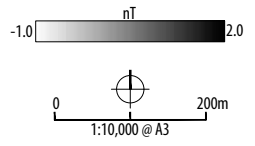

PROJECT SEGL21  
 Scotland England Green Link 2  
 North Yorkshire and  
 East Yorkshire

CLIENT AECOM



Headland Archaeology Yorkshire & North  
 Units 23-25 | Acorn Business Centre | Balme Road  
 Cleckheaton | BD19 4EZ  
 t 0127 493 8019  
 w www.headlandarchaeology.com

ILLUS 16 Processed greyscale magnetometer data; Overview 8

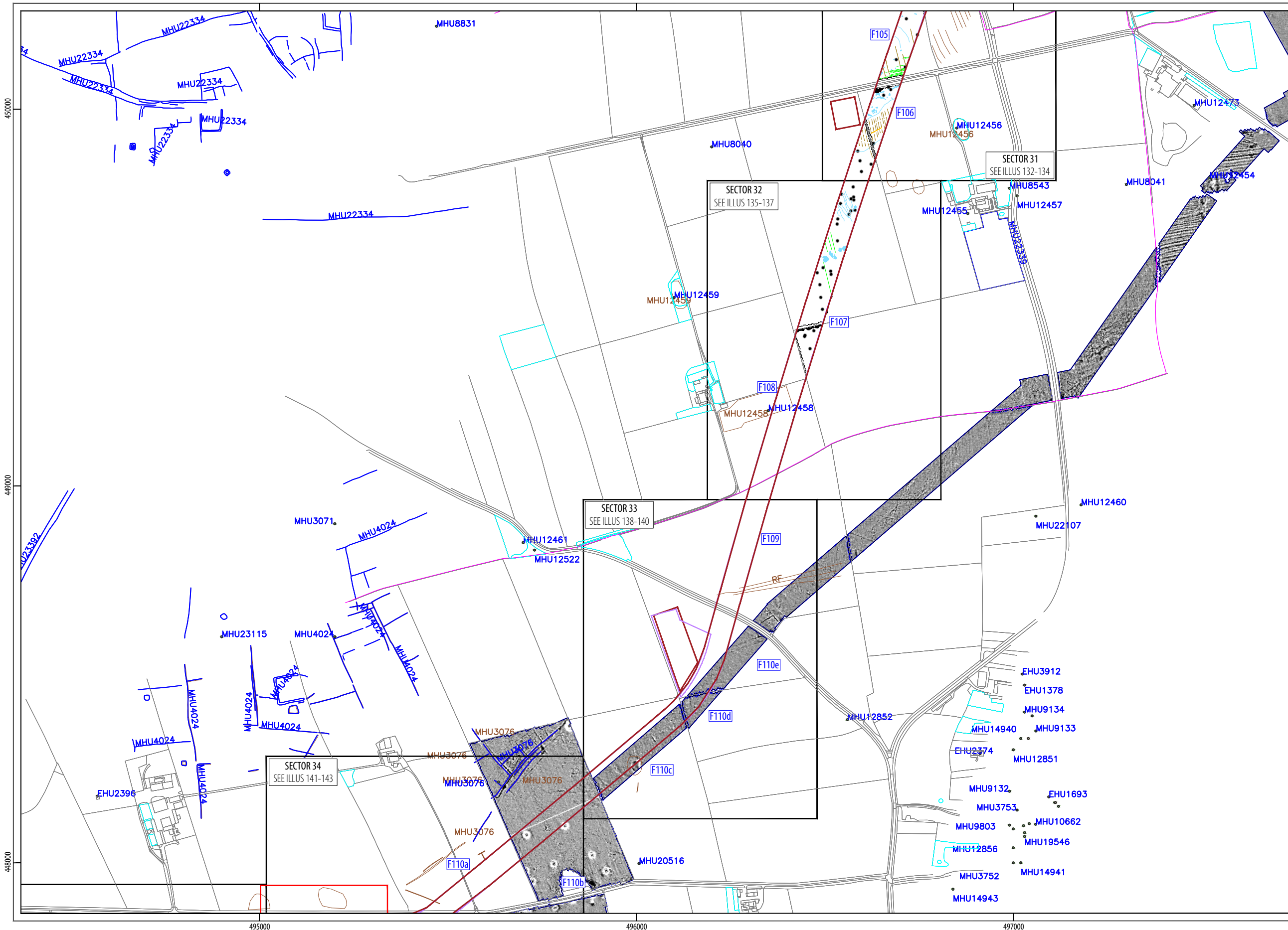

- design freeze survey area
  - previous corridor survey area
  - CCS Scheme Geophysical Survey (ASWYAS 2012)
  - AP and LiDAR assessment (Deegan 2021)
  - HER data
- | TYPE OF ANOMALY        | INTERPRETATION       |
|------------------------|----------------------|
| ● dipolar isolated     | ferrous material     |
| ● magnetic disturbance | ferrous material     |
| — linear trend         | ridge and furrow     |
| — linear trend         | agricultural         |
| — linear trend         | geological variation |
| ● magnetic enhancement | geology              |
| ● magnetic enhancement | archaeology?         |

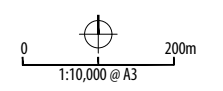

PROJECT SEGL21  
Scotland England Green Link 2  
North Yorkshire and  
East Yorkshire

CLIENT AECOM

**HEADLAND  
ARCHAEOLOGY**

Headland Archaeology Yorkshire & North  
Units 23-25 | Acorn Business Centre | Balme Road  
Cleckheaton | BD19 4EZ  
t 0127 493 8019  
w www.headlandarchaeology.com

ILLUS 17 Interpretation of magnetometer data; Overview 8

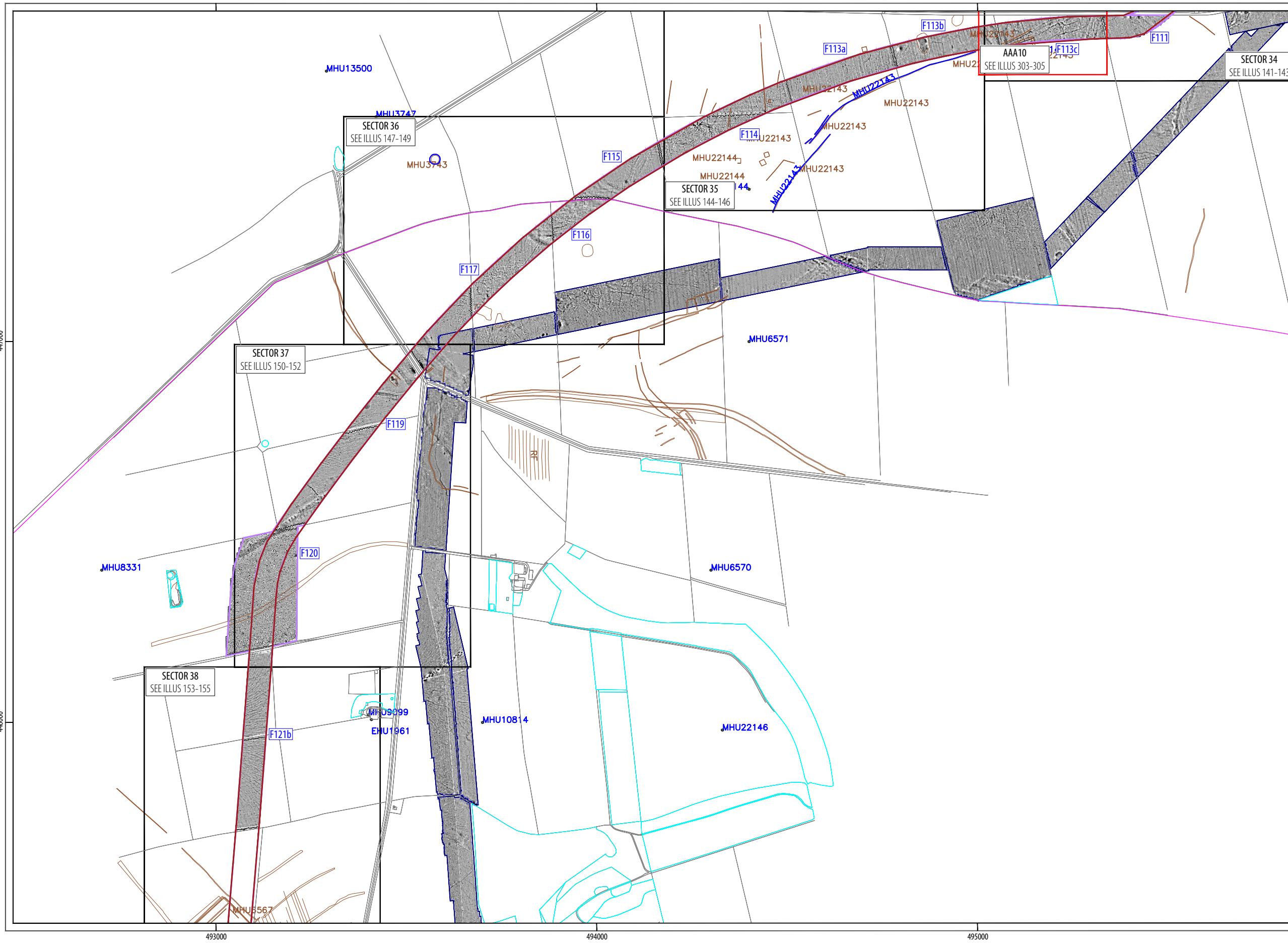

- ▭ design freeze survey area
- ▭ previous corridor survey area
- ▭ CCS Scheme Geophysical Survey (ASWYAS 2012)
- ▭ AP and LiDAR assessment (Deegan 2021)
- ▭ HER data

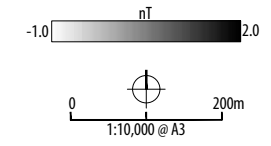

PROJECT SEGL21  
Scotland England Green Link 2  
North Yorkshire and  
East Yorkshire

CLIENT AECOM

**HEADLAND  
ARCHAEOLOGY**

Headland Archaeology Yorkshire & North  
Units 23-25 | Acorn Business Centre | Balme Road  
Cleckheaton | BD19 4EZ  
t 0127 493 8019  
www.headlandarchaeology.com

ILLUS 18 Processed greyscale magnetometer data; Overview 9

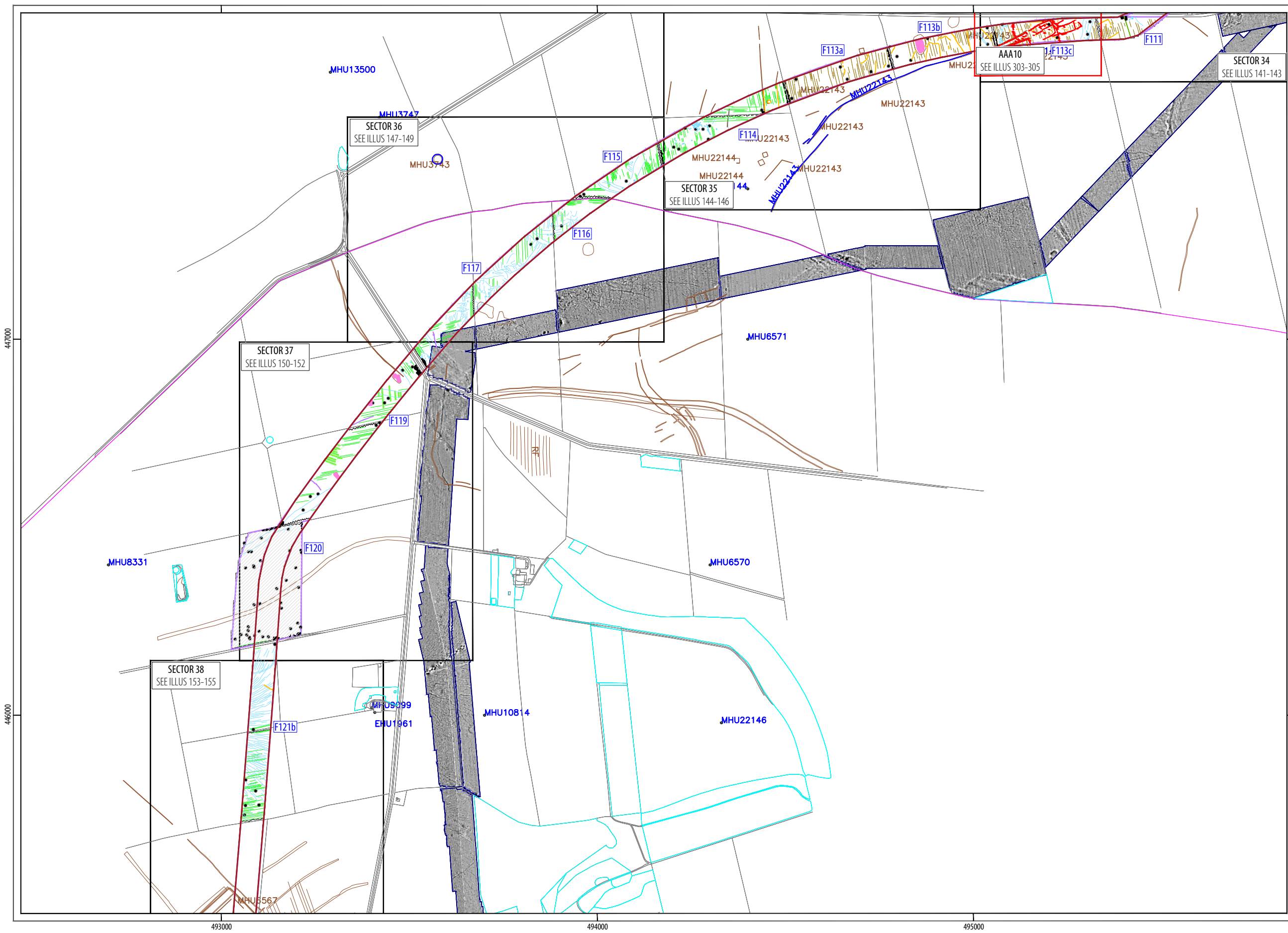

- design freeze survey area
  - previous corridor survey area
  - CCS Scheme Geophysical Survey (ASWYAS 2012)
  - ~ AP and LiDAR assessment (Deegan 2021)
  - ~ HER data
- | TYPE OF ANOMALY   | INTERPRETATION        |
|---|-----------------------|
| <span style="color: black; font-size: 10px;">•</span> dipolar isolated  | ferrous material      |
| <span style="background-color: black; border-radius: 50%; width: 10px; height: 10px; display: inline-block; margin-right: 5px;"></span> magnetic disturbance  | ferrous material      |
| <span style="background-color: grey; border-radius: 50%; width: 10px; height: 10px; display: inline-block; margin-right: 5px;"></span> magnetic disturbance   | greenwaste            |
| <span style="background-color: pink; border-radius: 50%; width: 10px; height: 10px; display: inline-block; margin-right: 5px;"></span> magnetic disturbance   | quarrying             |
| <span style="background-color: purple; border-radius: 50%; width: 10px; height: 10px; display: inline-block; margin-right: 5px;"></span> magnetic enhancement | uncertain             |
| <span style="color: yellow; font-size: 10px;">—</span> linear trend   | ridge and furrow      |
| <span style="color: green; font-size: 10px;">—</span> linear trend  | agricultural          |
| <span style="color: green; font-size: 10px;">- - -</span> linear trend  | field drain           |
| <span style="color: green; font-size: 10px;">—</span> linear  | former field boundary |
| <span style="color: cyan; font-size: 10px;">—</span> linear trend   | geological variation  |
| <span style="background-color: cyan; border-radius: 50%; width: 10px; height: 10px; display: inline-block; margin-right: 5px;"></span> magnetic enhancement   | geology               |
| <span style="background-color: yellow; border-radius: 50%; width: 10px; height: 10px; display: inline-block; margin-right: 5px;"></span> magnetic enhancement | archaeology?          |
| <span style="background-color: red; border-radius: 50%; width: 10px; height: 10px; display: inline-block; margin-right: 5px;"></span> magnetic enhancement    | archaeology           |

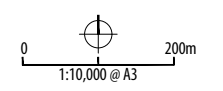

PROJECT SEGL21  
Scotland England Green Link 2  
North Yorkshire and  
East Yorkshire

CLIENT AECOM

**HEADLAND  
ARCHAEOLOGY**

Headland Archaeology Yorkshire & North  
Units 23-25 | Acorn Business Centre | Balme Road  
Cleckheaton | BD19 4EZ  
t 0127 493 8019  
w www.headlandarchaeology.com

ILLUS 19 Interpretation of magnetometer data; Overview 9

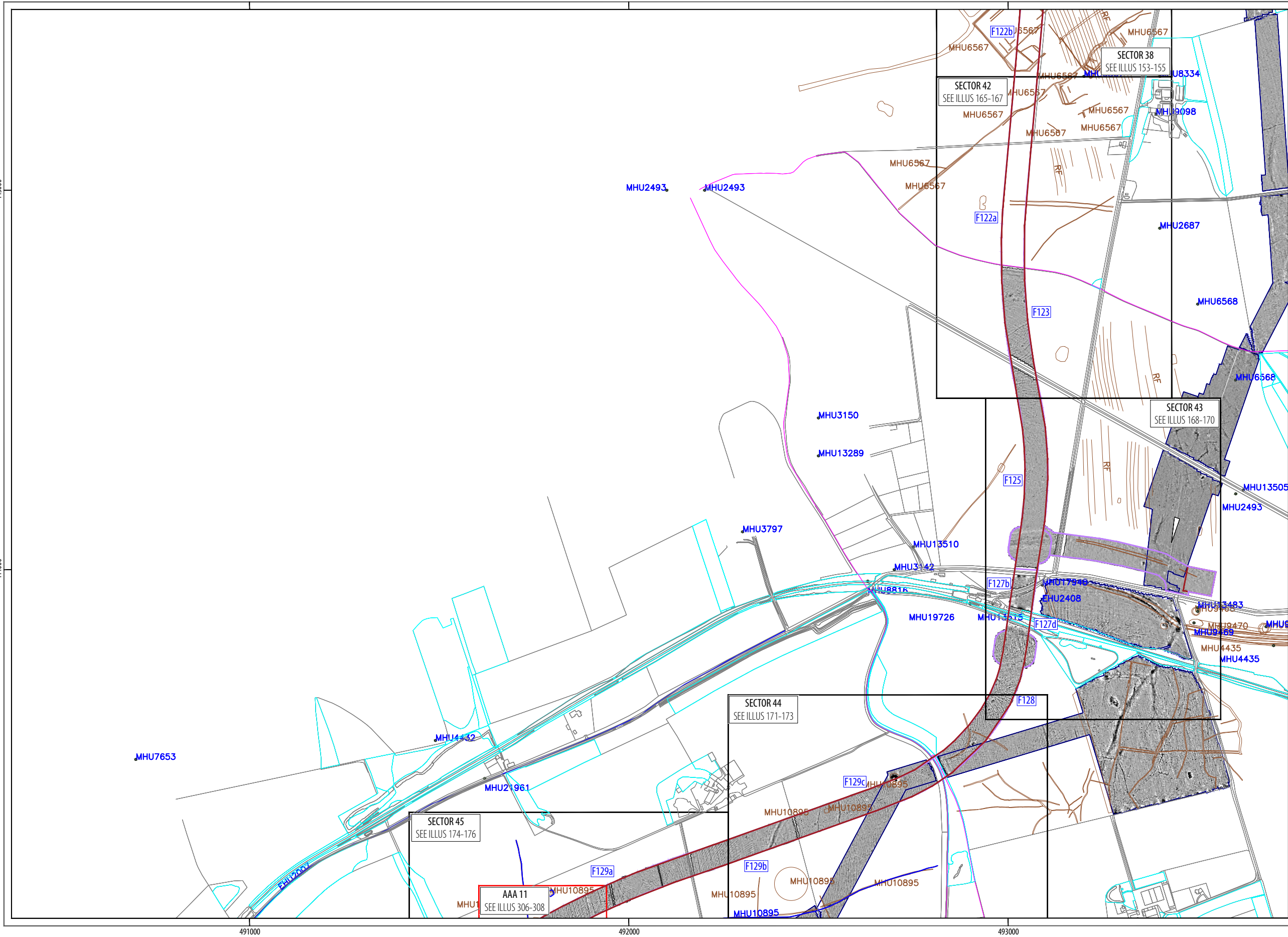

- design freeze survey area
- previous corridor survey area
- CCS Scheme Geophysical Survey (ASWYAS 2012)
- AP and LiDAR assessment (Deegan 2021)
- HER data

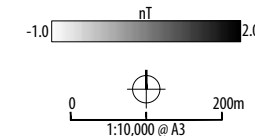

PROJECT SEGL21  
 Scotland England Green Link 2  
 North Yorkshire and  
 East Yorkshire

CLIENT AECOM



Headland Archaeology Yorkshire & North  
 Units 23-25 | Acorn Business Centre | Balme Road  
 Cleckheaton | BD19 4EZ  
 t 0127 493 8019  
 www.headlandarchaeology.com



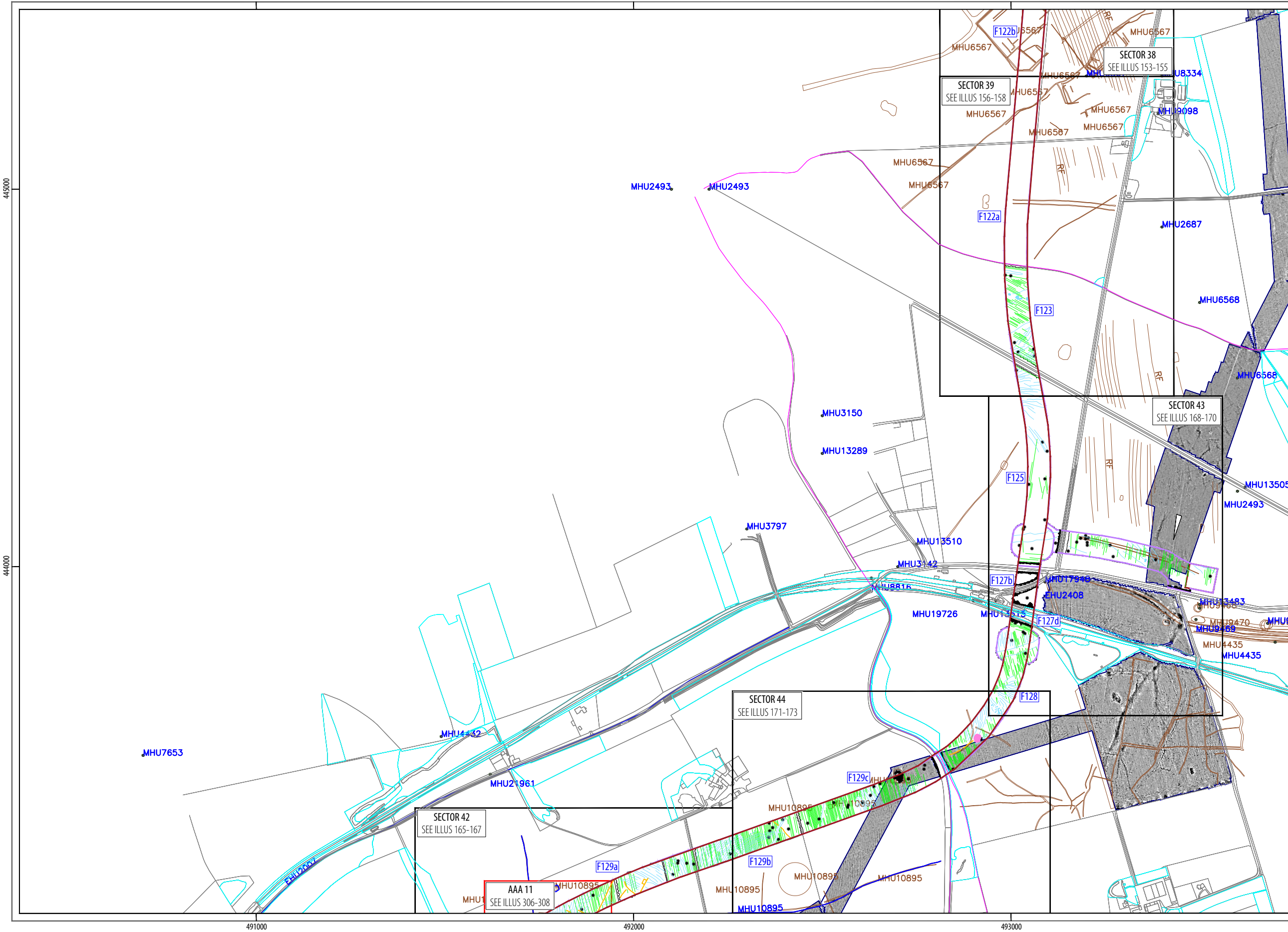

design freeze survey area  
 previous corridor survey area  
 CCS Scheme Geophysical Survey (ASWYAS 2012)  
 AP and LiDAR assessment (Deegan 2021)  
 HER data

| TYPE OF ANOMALY      | INTERPRETATION       |
|----------------------|----------------------|
| dipolar isolated     | ferrous material     |
| magnetic disturbance | ferrous material     |
| magnetic disturbance | quarrying            |
| linear trend         | agricultural         |
| linear trend         | geological variation |
| magnetic enhancement | geology              |
| magnetic enhancement | archaeology?         |

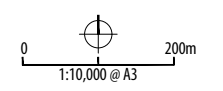

PROJECT SEGL21  
 Scotland England Green Link 2  
 North Yorkshire and  
 East Yorkshire

CLIENT AECOM

**HEADLAND  
 ARCHAEOLOGY**

Headland Archaeology Yorkshire & North  
 Units 23-25 | Acorn Business Centre | Balme Road  
 Cleckheaton | BD19 4EZ  
 t 0127 493 8019  
 w www.headlandarchaeology.com

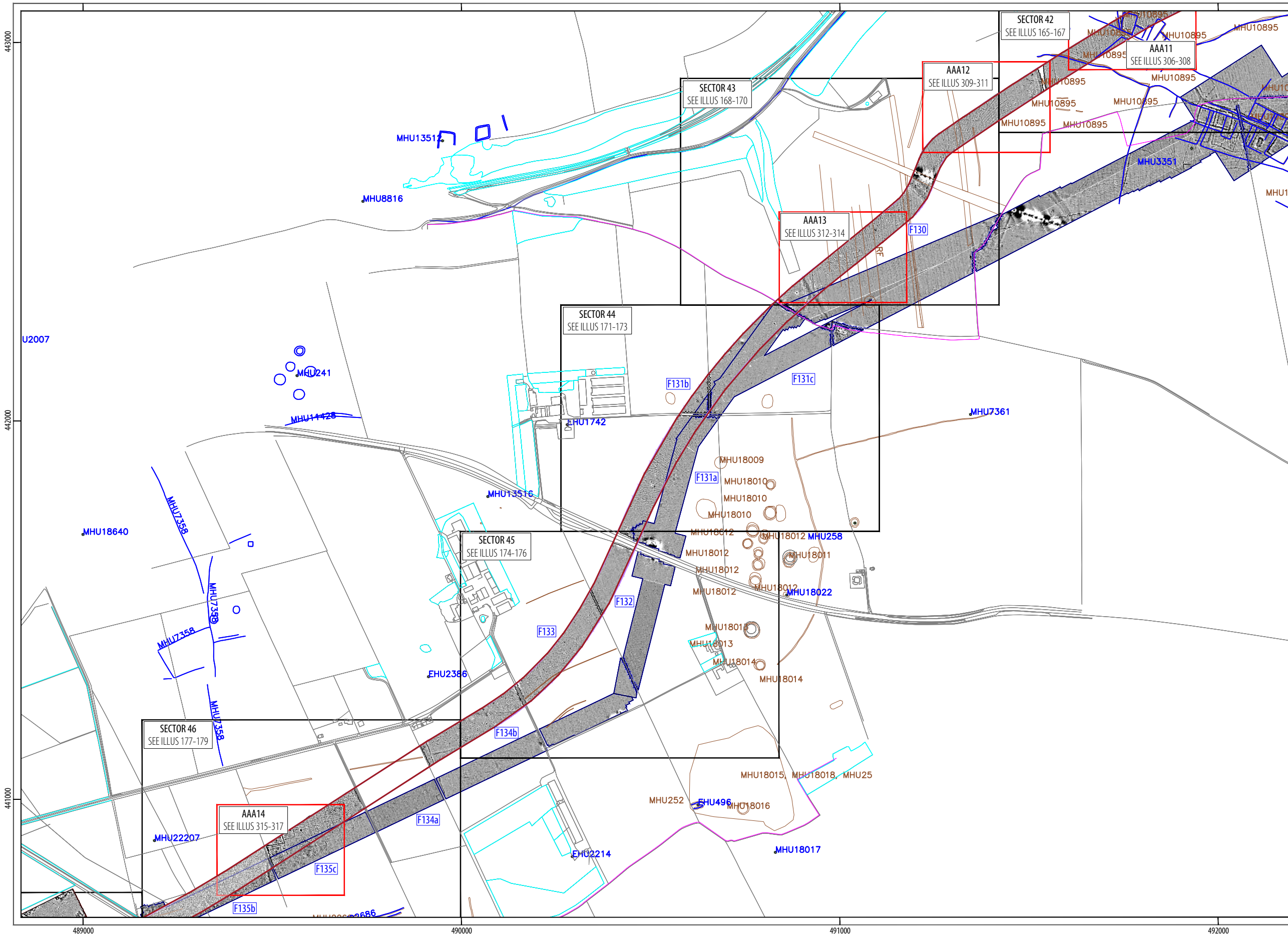

- ▭ design freeze survey area
- ▭ previous corridor survey area
- ▭ CCS Scheme Geophysical Survey (ASWYAS 2012)
- ▭ AP and LiDAR assessment (Deegan 2021)
- ▭ HER data

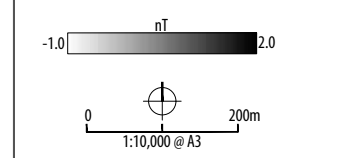

PROJECT SEGL21  
Scotland England Green Link 2  
North Yorkshire and  
East Yorkshire

CLIENT AECOM

**HEADLAND  
ARCHAEOLOGY**

Headland Archaeology Yorkshire & North  
Units 23-25 | Acorn Business Centre | Balme Road  
Cleckheaton | BD19 4EZ  
t 0127 493 8019  
www.headlandarchaeology.com

ILLUS 22 Processed greyscale magnetometer data; Overview 11

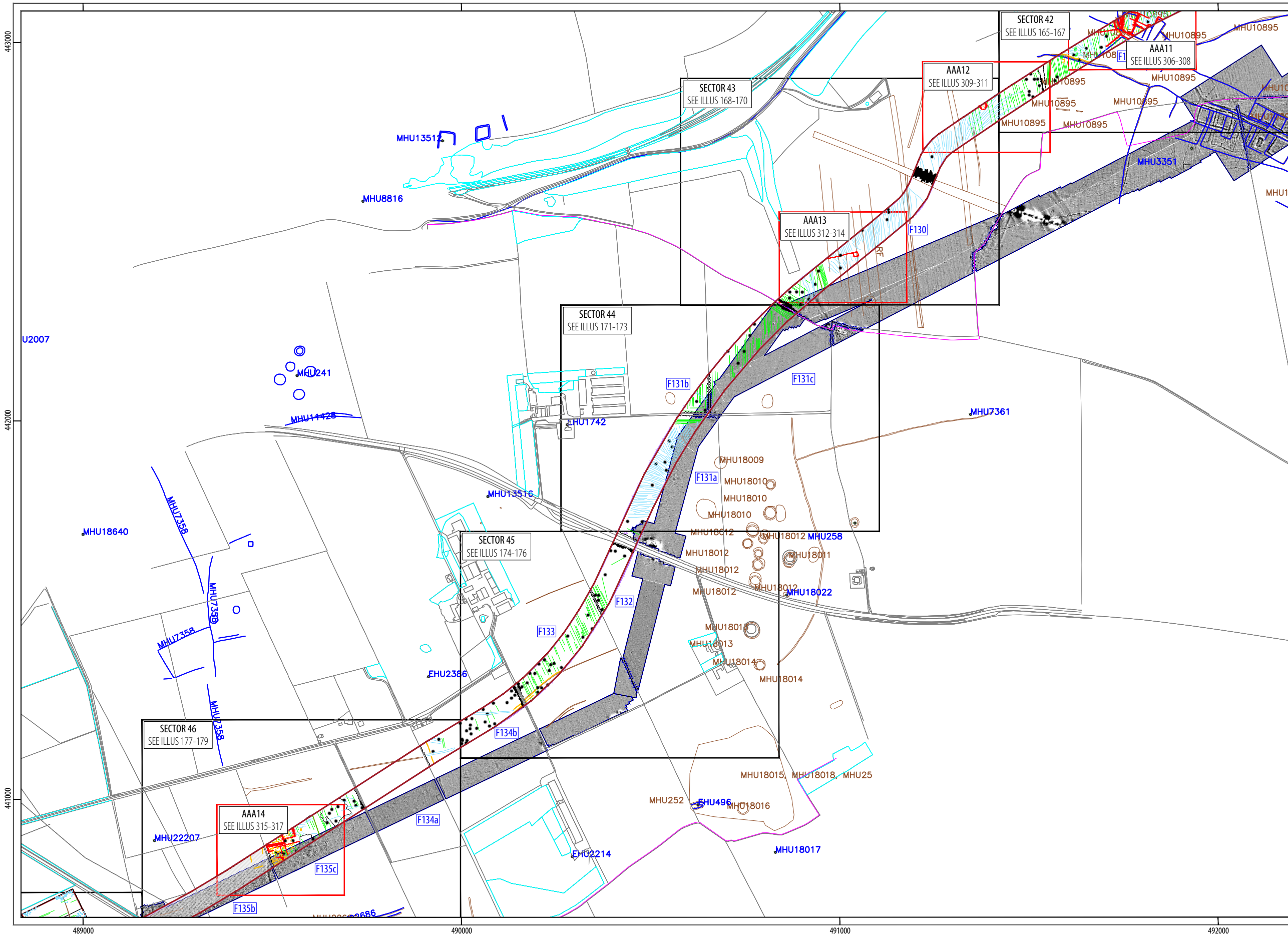

- design freeze survey area
  - previous corridor survey area
  - CCS Scheme Geophysical Survey (ASWYAS 2012)
  - AP and LiDAR assessment (Deegan 2021)
  - HER data
- | TYPE OF ANOMALY  | INTERPRETATION        |
|--|-----------------------|
| <span style="color: black;">●</span> dipolar isolated      | ferrous material      |
| <span style="color: black;">■</span> magnetic disturbance  | ferrous material      |
| <span style="color: black;">—</span> dipolar linear        | service pipe          |
| <span style="color: grey;">■</span> magnetic disturbance   | greenwaste            |
| <span style="color: green;">—</span> linear trend          | agricultural          |
| <span style="color: green;">—</span> linear                | former field boundary |
| <span style="color: blue;">—</span> linear trend           | geological variation  |
| <span style="color: blue;">■</span> magnetic enhancement   | geology               |
| <span style="color: orange;">■</span> magnetic enhancement | archaeology?          |
| <span style="color: red;">■</span> magnetic enhancement    | archaeology           |

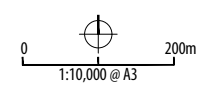

PROJECT SEGL21  
Scotland England Green Link 2  
North Yorkshire and  
East Yorkshire

CLIENT AECOM

**HEADLAND  
ARCHAEOLOGY**

Headland Archaeology Yorkshire & North  
Units 23-25 | Acorn Business Centre | Balme Road  
Cleckheaton | BD19 4EZ  
t 0127 493 8019  
w www.headlandarchaeology.com

ILLUS 23 Interpretation of magnetometer data; Overview 11

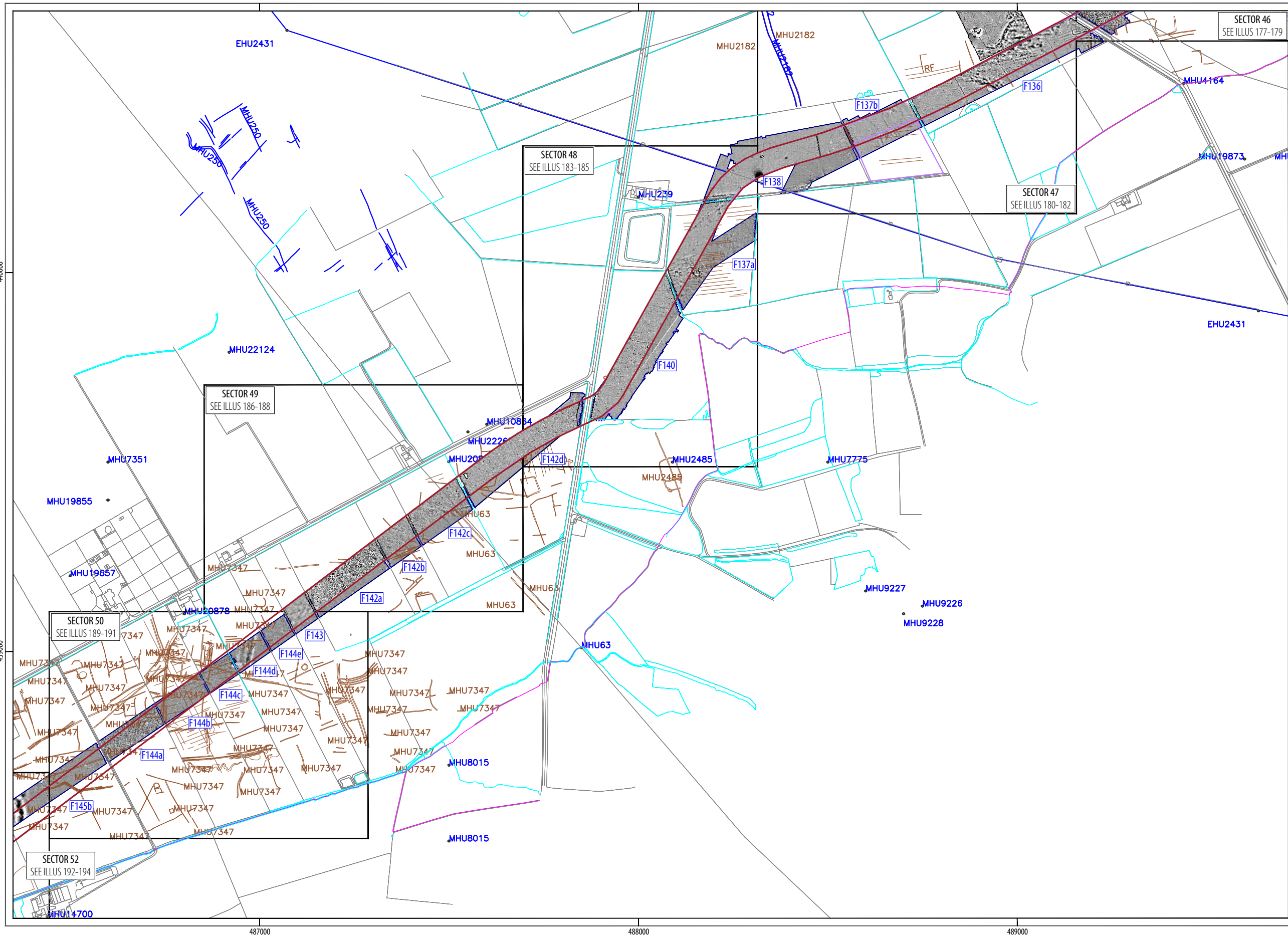

- design freeze survey area
- previous corridor survey area
- CCS Scheme Geophysical Survey (ASWYAS 2012)
- AP and LiDAR assessment (Deegan 2021)
- HER data

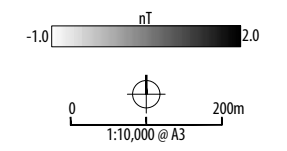

PROJECT SEGL21  
Scotland England Green Link 2  
North Yorkshire and  
East Yorkshire

CLIENT AECOM



Headland Archaeology Yorkshire & North  
Units 23-25 | Acorn Business Centre | Balme Road  
Cleckheaton | BD19 4EZ  
t 0127 493 8019  
www.headlandarchaeology.com

ILLUS 24 Processed greyscale magnetometer data; Overview 12

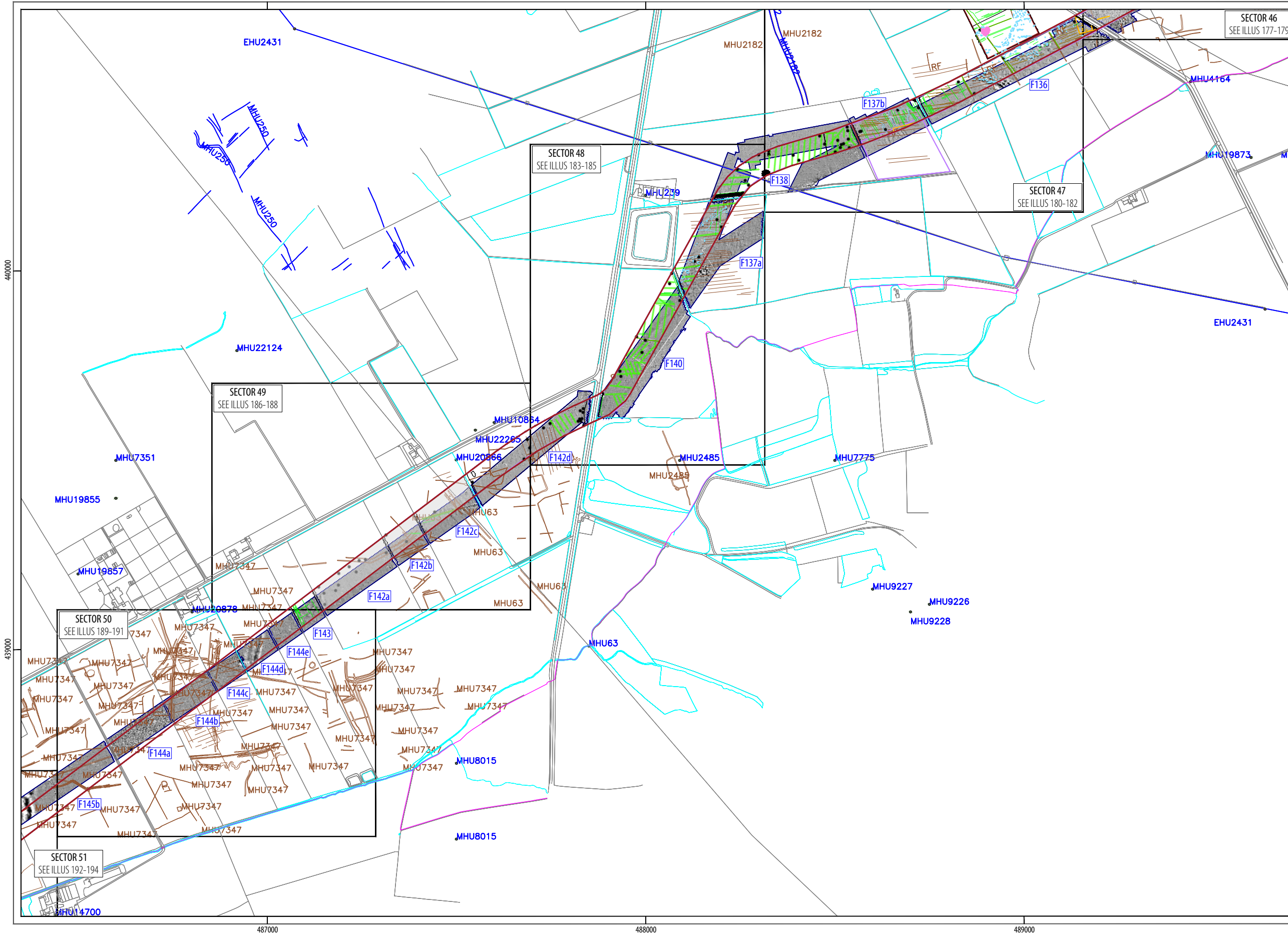

|  |   |
|--|---|
|  | design freeze survey area                   |
|  | previous corridor survey area               |
|  | CCS Scheme Geophysical Survey (ASWYAS 2012) |
|  | AP and LiDAR assessment (Deegan 2021)       |
|  | HER data                                    |

| TYPE OF ANOMALY | INTERPRETATION                        |
|-----------------|---------------------------------------|
|                 | dipolar isolated ferrous material     |
|                 | magnetic disturbance ferrous material |
|                 | magnetic disturbance greenwaste       |
|                 | magnetic disturbance quarrying        |
|                 | linear trend ridge and furrow         |
|                 | linear trend agricultural             |
|                 | linear trend field drain              |
|                 | linear trend former field boundary    |
|                 | linear trend geological variation     |
|                 | magnetic enhancement geology          |
|                 | magnetic enhancement archaeology?     |

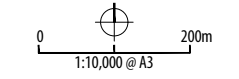

**PROJECT** SEGL21  
Scotland England Green Link 2  
North Yorkshire and  
East Yorkshire

**CLIENT** AECOM

**HEADLAND  
ARCHAEOLOGY**

Headland Archaeology Yorkshire & North  
Units 23-25 | Acorn Business Centre | Balme Road  
Cleckheaton | BD19 4EZ  
t 0127 493 8019  
www.headlandarchaeology.com

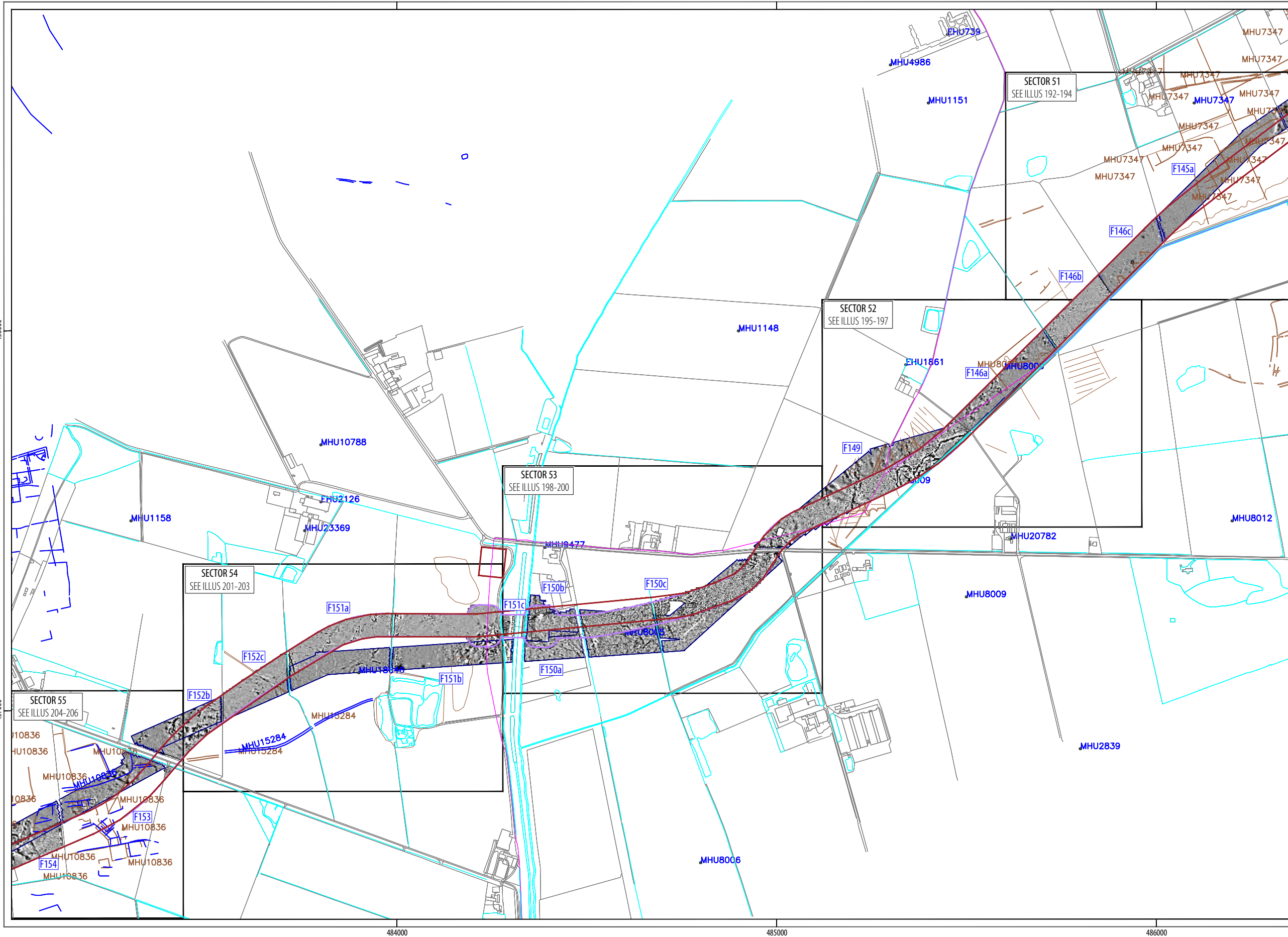

- ▭ design freeze survey area
- ▭ previous corridor survey area
- ▭ CCS Scheme Geophysical Survey (ASWYAS 2012)
- ▭ AP and LiDAR assessment (Deegan 2021)
- ▭ HER data

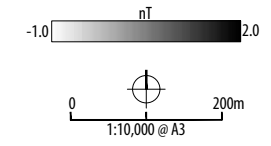

PROJECT SEGL21  
Scotland England Green Link 2  
North Yorkshire and  
East Yorkshire

CLIENT AECOM

**HEADLAND  
ARCHAEOLOGY**

Headland Archaeology Yorkshire & North  
Units 23-25 | Acorn Business Centre | Balme Road  
Cleckheaton | BD19 4EZ  
t 0127 493 8019  
www.headlandarchaeology.com

ILLUS 26 Processed greyscale magnetometer data; Overview 13

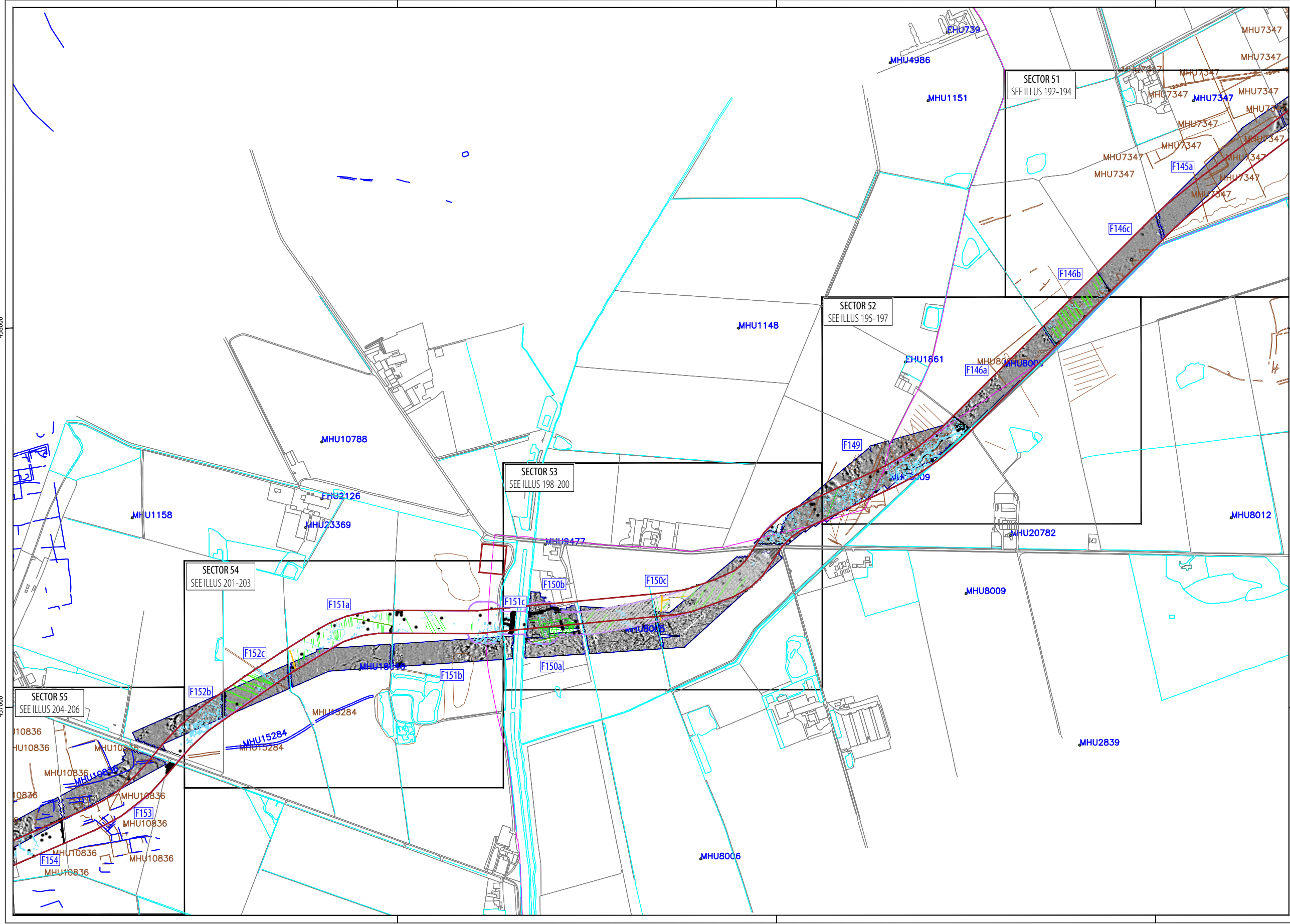

- design freeze survey area
  - previous corridor survey area
  - CCS Scheme Geophysical Survey (ASWYAS 2012)
  - AP and LiDAR assessment (Deegan 2021)
  - HER data
- | TYPE OF ANOMALY  | INTERPRETATION        |
|--|-----------------------|
| <span style="color: black;">●</span> dipolar isolated      | ferrous material      |
| <span style="color: black;">■</span> magnetic disturbance  | ferrous material      |
| <span style="color: black;">—</span> dipolar linear        | service pipe          |
| <span style="color: grey;">■</span> magnetic disturbance   | greenwaste            |
| <span style="color: green;">—</span> linear trend          | agricultural          |
| <span style="color: green;">- - -</span> linear trend      | field drain           |
| <span style="color: green;">—</span> linear                | former field boundary |
| <span style="color: blue;">—</span> linear trend           | geological variation  |
| <span style="color: blue;">■</span> magnetic enhancement   | geology               |
| <span style="color: orange;">■</span> magnetic enhancement | archaeology?          |

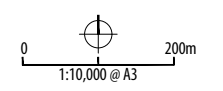

PROJECT SEGL21  
Scotland England Green Link 2  
North Yorkshire and  
East Yorkshire

CLIENT AECOM

**HEADLAND  
ARCHAEOLOGY**

Headland Archaeology Yorkshire & North  
Units 23-25 | Acorn Business Centre | Balme Road  
Cleckheaton | BD19 4EZ  
t 0127 493 8019  
w www.headlandarchaeology.com