



Notes:

1. Copyright: The contents of this drawing may not be reproduced in whole or in part without the written consent of Robinson Kenning & Gallagher.
2. All dimensions to be checked on site by Contractor.
3. Where discrepancy occurs between specification and drawings then Robinson Kenning & Gallagher must be notified immediately.

Note:

-  Extent of Greater Anglia TOC Lease
-  Site Area
-  Extent of Public Rights of Access

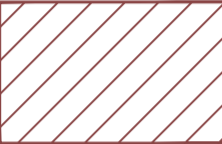
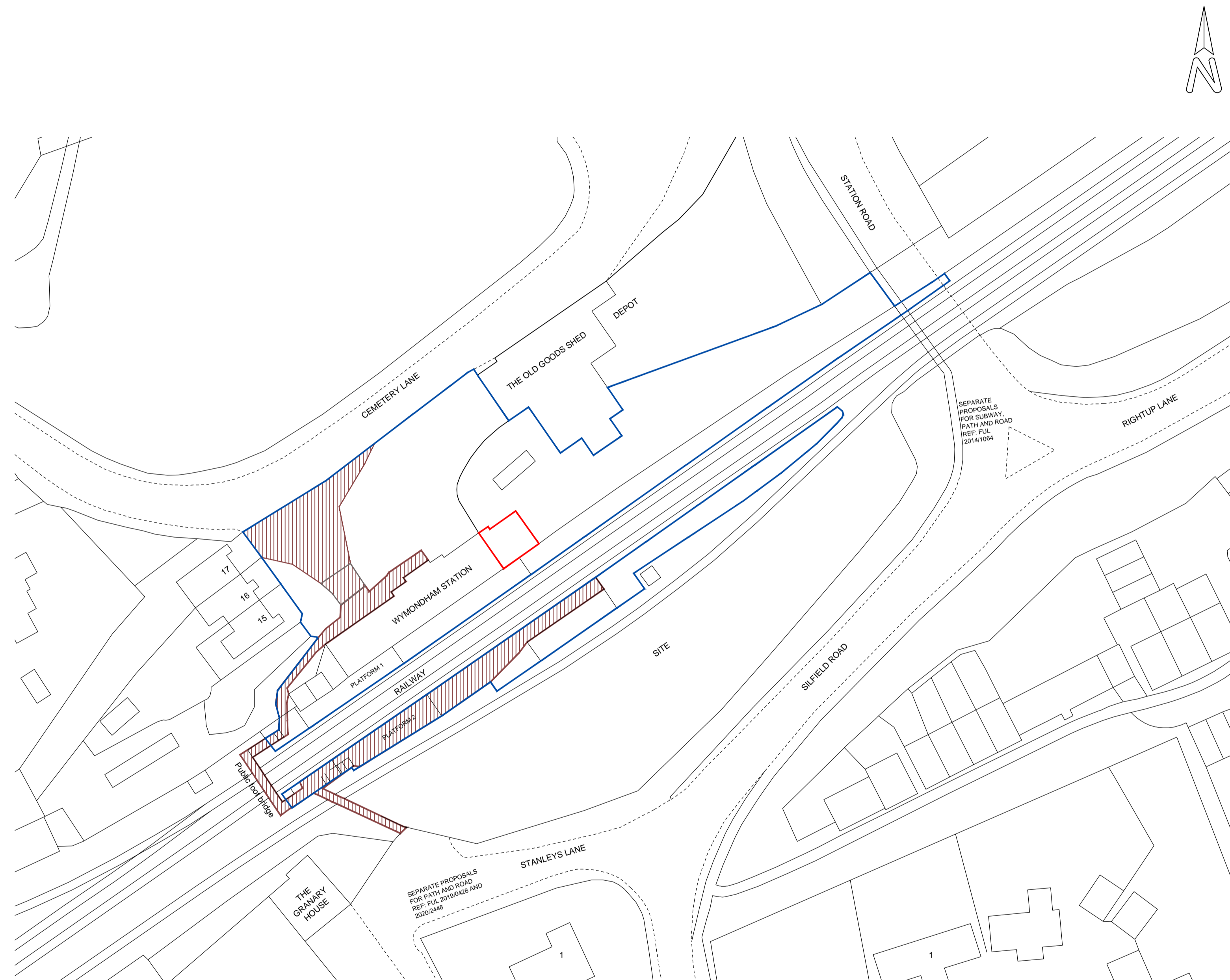

01 Site Location Plan
1:500 @ A1

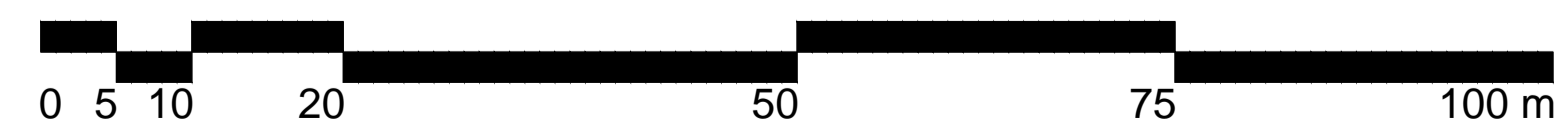

P01	06/02/2024	LC	Listed Building Application	MP	MP
REV	DATE	BY		CHK	ATHD

DRAWING STATUS: **PLANNING**

architecture
building surveying
project management
Principal Designers



Robinson Kenning & Gallagher

Airport House
Purley Way Croydon Surrey CR0 0XZ.
T: 020 8684 8125
E: info@rkpartnership.co.uk
W: www.rkpartnership.co.uk

CLIENT:

greater anglia

PROJECT:

Wymondham Station
Station Approach, Wymondham, Norfolk, NR18 0JZ

TITLE:

Site Location Plan

SCALE @ A1:	1:500	CHECKED:	-	APPROVED:	-
CAD FILE:	DESIGN DRAWN:	DATE:			
	LC	12/02/2024			
PROJECT No:	DRAWING No:	REV:			
24-4773	24-4773-A-001	P01			