

NB: SITE PLAN BASED ON REPRODUCTION BY MILLAR & BRYCE BY PERMISSION OF ORDINANCE SURVEY ON BEHALF OF HMSO. CROWN COPYRIGHT AND DATABASE RIGHT 2020.

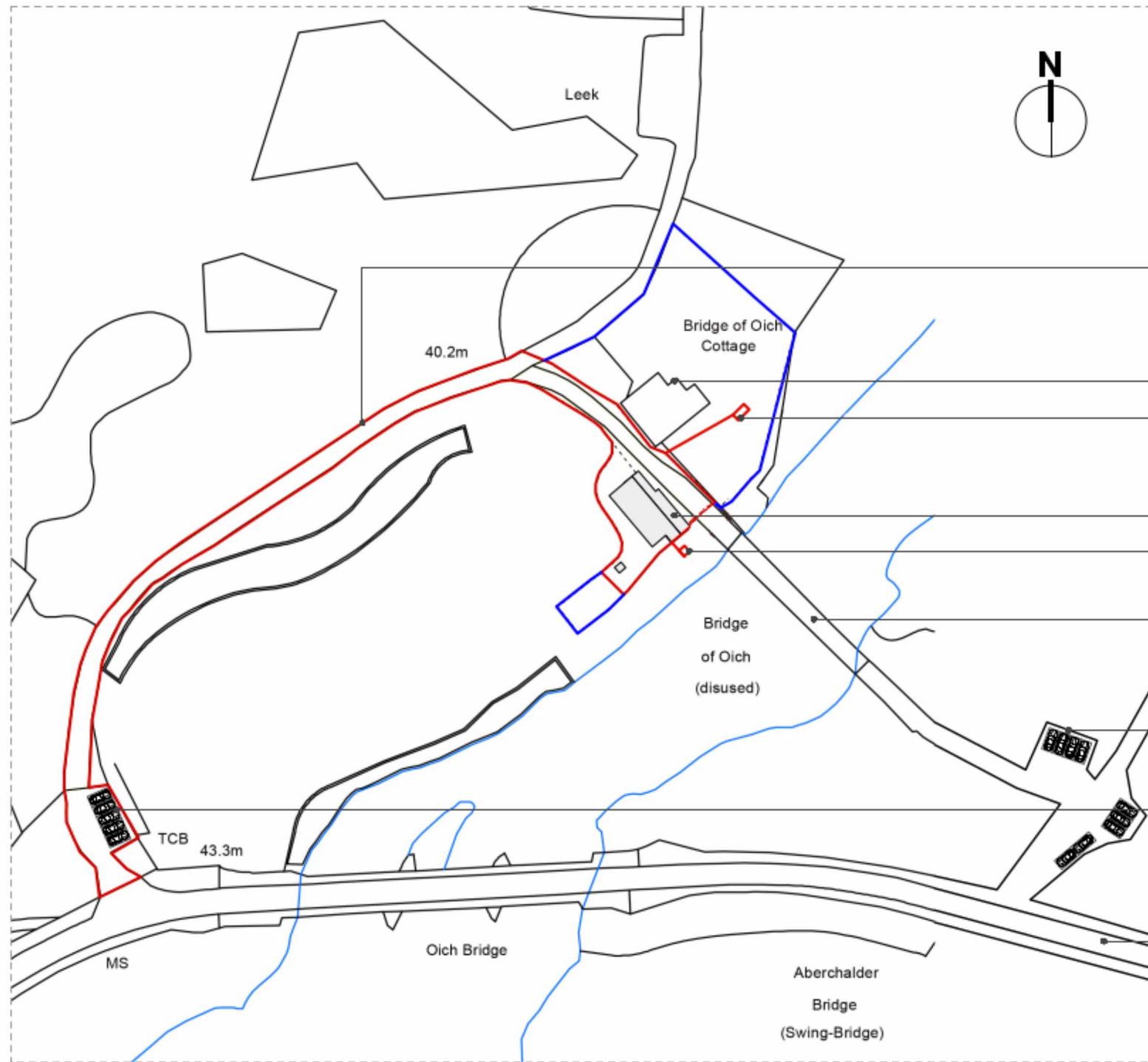

NB: DRAWING TO BE READ IN CONJUNCTION WITH 1002_100 & 1002_102

ADJOINING LAND OWNED BY APPLICANT

SITE BOUNDARY FOR PURPOSES OF PLANNING

ROAD ACCESS
EXISTING ACCESS FROM A82

BRIDGE OF OICH COTTAGE

SEPTIC TANK
APPROX. LOCATION EXISTING

BARN FOR DEVELOPMENT

PUMP HOUSE
APPROX. LOCATION EXISTING

PEDESTRIAN ACCESS
ACROSS EXISTING BRIDGE

EXISTING PARKING
X9 BAYS APPROX. HARDSTANDING
IMAGE SHOWN FOR REFERENCE

EXISTING PARKING
X5 BAYS APPROX. HARDSTANDING
IMAGES OF ACCESS SPLAY SHOWN ON RIGHT

A82 ROAD



1 Location Plan B
Scale: 1:1250



This drawing is the property of Ford McPhee Design. It may not be duplicated or disclosed to any third party for any purpose except as authorised in writing by Ford McPhee Design. Do not scale this drawing. Figured dimensions only are to be used in preference to small scale drawings. All dimensions are to be verified on site before any work commences. Any errors or omissions are to be reported to the designer. If in doubt, ask. The contractor is to provide full sized setting-out drawings based on the information contained within this drawing for the designers approval before commencing any manufacture. This drawing/documents and any discrepancies or variations are to be notified to the designer before the affected work commences.

© Ford McPhee Design

Revisions		
NO.	Date	Note
A	26/02	red line update

PROJECT:
Little Oich Barn

DRAWING NUMBER:
1002_101 A

CLIENT: MCPHEE

SUBJECT: LOCATION PLAN B

LOCATION: INVERGARRY

SCALE: AS SHOWN @A3

DATE: 04/12/23

DRAWN BY: SM

Ford McPhee Design
Bridge of Oich Cottage, Invergarry,
PH35 4HN

© Copyright Ford McPhee Design