

**EXISTING CELLAR**  
1:100

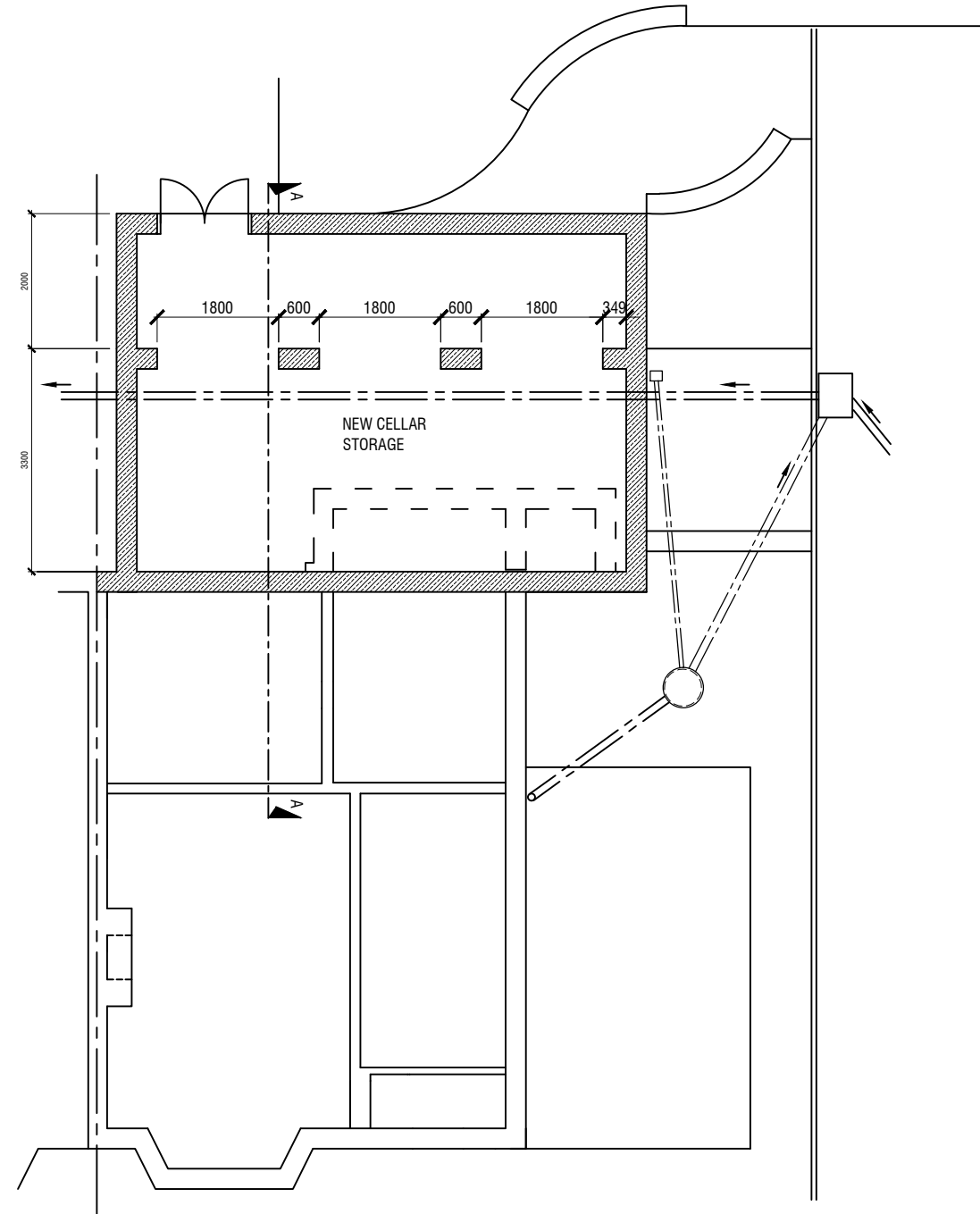

**PROPOSED CELLAR STORAGE**

PROJECT TITLE			
<b>PROPOSED KITCHEN EXTENSION</b>			
<b>MR &amp; MRS R GRAY</b>			
<b>48 COXWOLD VIEW, WETHERBY. LS22 7PU</b>			
DRAWING TITLE		<b>EXISTING AND PROPOSED CELLAR STORAGE</b>	
SCALE:	1:100	@ A3	DRAWN: CAROL PETTIFAR
DATE:	01/03/24	DRAWING NO: <b>G0224/2</b>	