

# PREPARED FOR PLANNING

**GENERAL NOTES:**  
 All dimensions to be checked on site  
 Do not scale from this drawing except for planning application purposes. Structural Design and Building Control Approval is required before construction commences. Drawings to be read in conjunction with Structural Engineers drawings. Client to secure 'Party wall' agreement prior to works commencing. Client to secure agreement for 'Building Over or Near' Public sewers from the local water authority prior to works commencing. This drawing is subject to copyright do not reproduce this drawing without prior permission.

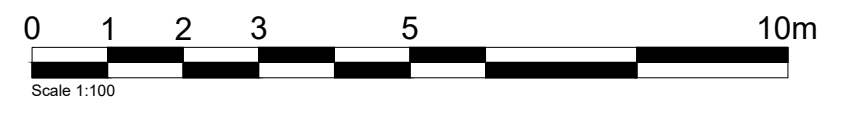

Materials to match existing where possible  
 Materials to be in keeping with the area

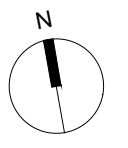

rev	description	date	dr by	ap by
-	PLANNING	20.02.2024	sm	sm

**ALTMORE ARCHITECTURE**  
 Architects & Designers.

**Address:** 125 Altmore Avenue, London, E6 2BU  
**Telephone:** 07927 61 76 91  
**Email:** info@aitmorearchitecture.com

Client <b>WASIM AKHTAR</b>	
Project <b>142 Stokes Road, LONDON, E6 3SE</b>	
Drawing <b>EXISTING GROUND AND ROOF PLANS</b>	
Drawing Number <b>103</b>	Scale <b>1:100 @ A3</b>
Project number <b>P0167</b>	Issue status <b>Planning</b>
<small>This drawing is to be read in conjunction with all related drawings. Do not scale from this drawing. All dimensions must be checked and verified on site before commencing any work or producing shop drawings. The originator should be notified immediately of any discrepancy. This drawing is copyright and remains the property of Altmore Architecture.</small>	

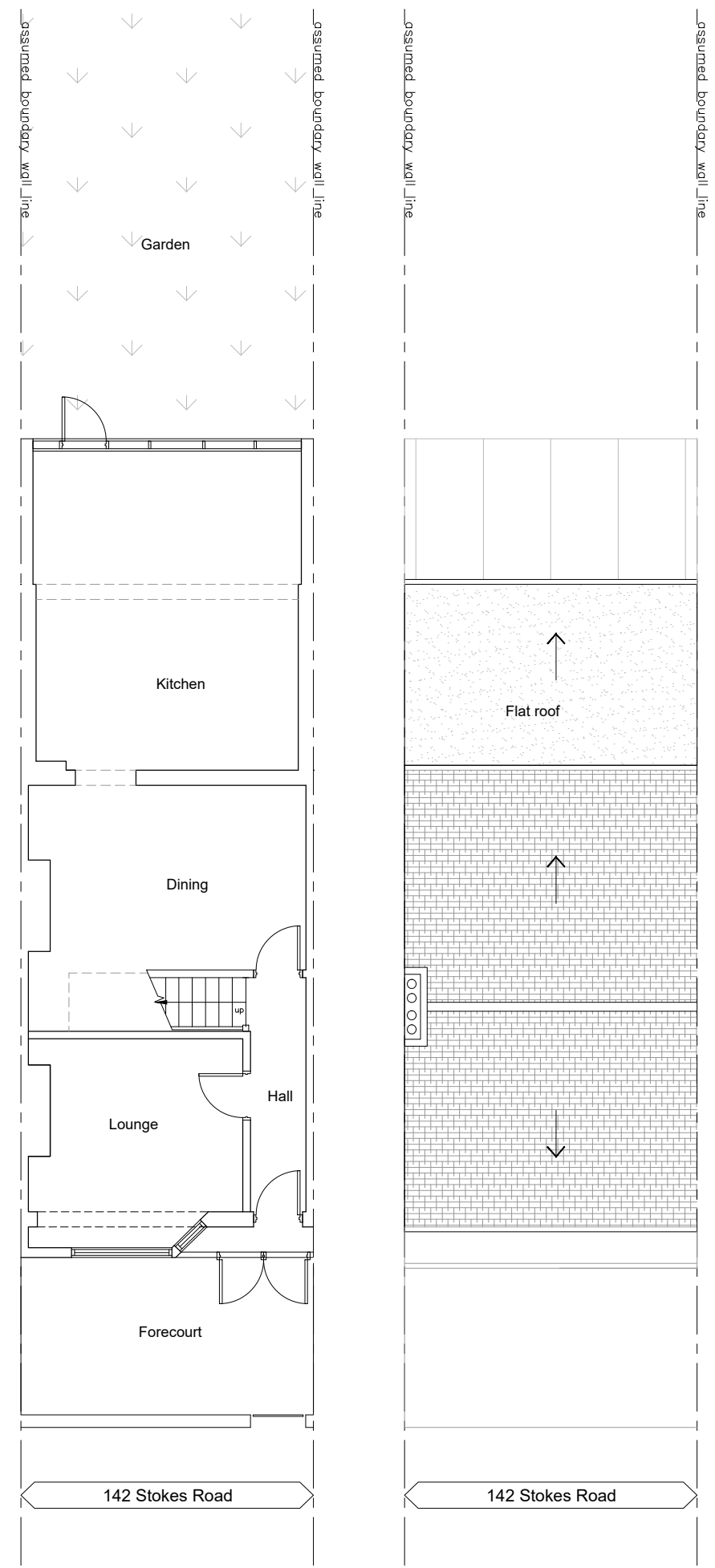

**EXISTING**