

1,470mm Check On Site !

Ex 100 x 75 softwood timber door frame jamb rebated and grooved plus weather proofing and draught strip

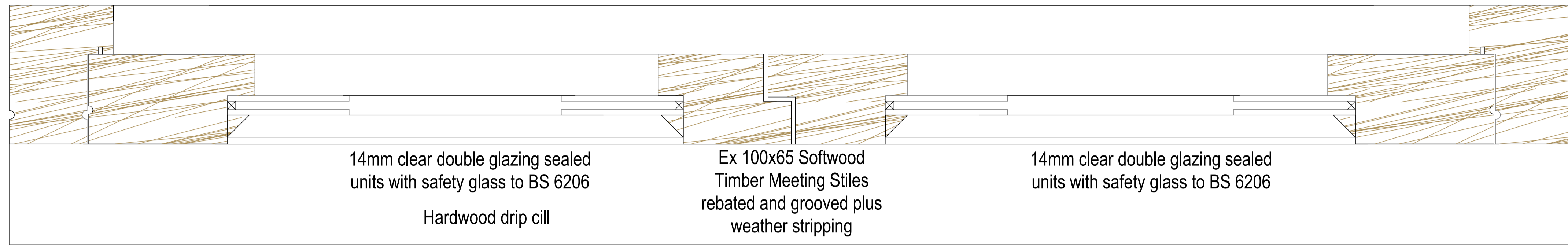

Ex 100 x 75 softwood timber door frame jamb rebated and grooved plus weather proofing and draught strip

**Proposed Section 'A'-'A'**  
Scale: 1:2 @ A1 Print

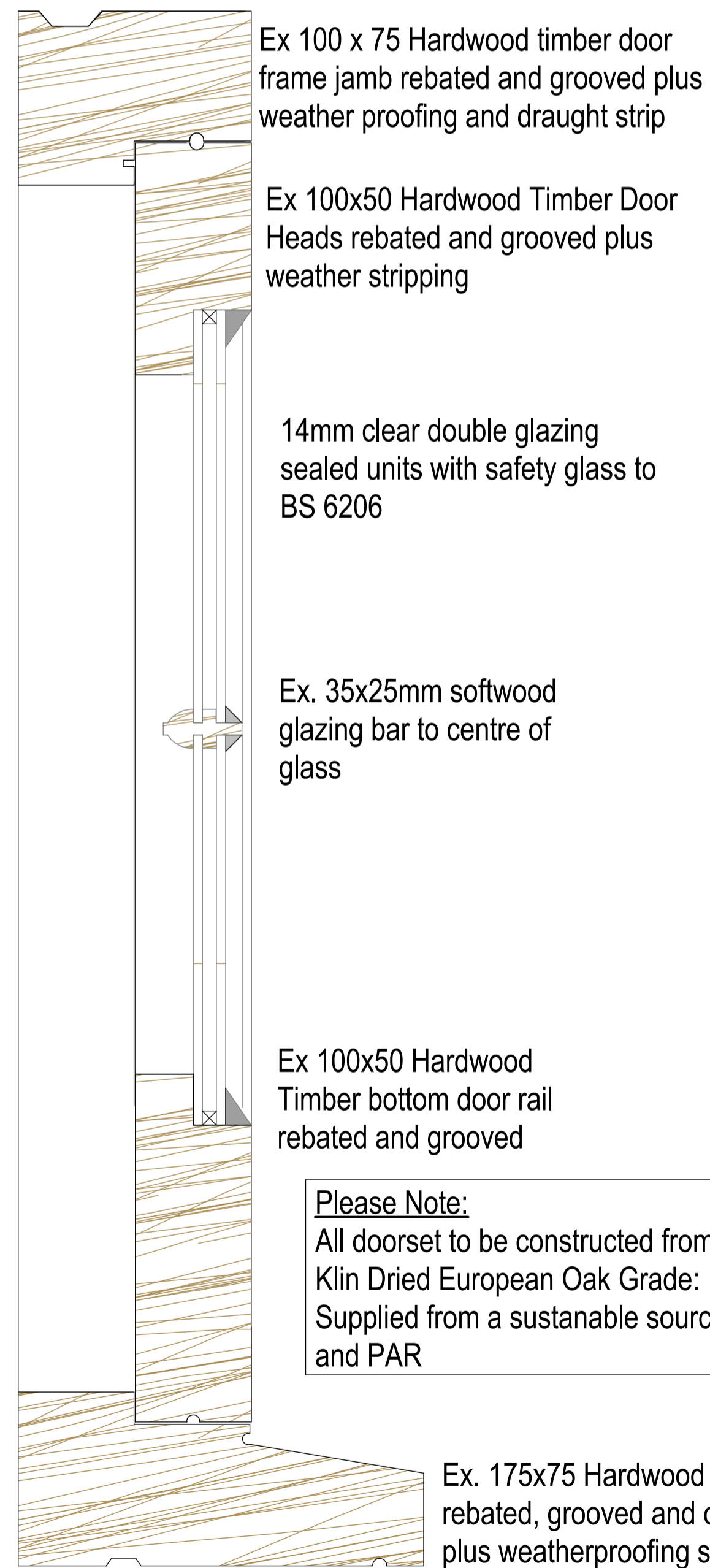

**Please Note:**  
All doorset to be constructed from Klin Dried European Oak Grade: Supplied from a sustainable source and PAR

**Proposed Section 'B'-'B'**  
Scale: 1:2 @ A1 Print

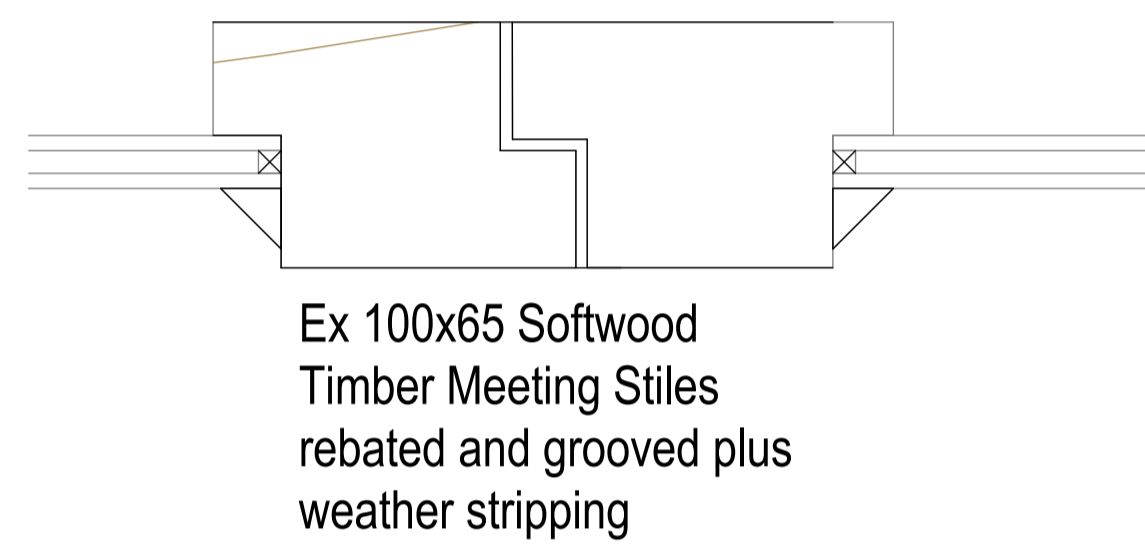

Ex 100x65 Softwood Timber Meeting Stiles rebated and grooved plus weather stripping

**Windows and Doors - Important Notes on Drawing:**  
All timber work to be hardwood joinery kiln dried oak including the door and window cills  
Overall sizes - All measurements to be checked on site before manufacturer - Any discrepancies to be reported to MNL Designs Ltd before any joinery manufacturing  
All door and window casements are to be finished white gloss to match existing casements  
Weatherproofing and draught strips are to be incorporated in all openable sections of the casement  
----- Dash indicates method of casement opening side  
Provide 14mm thick fully sealed slimlight double glazed units to each casement (4/6/4 profile)  
Use Saint Gobain Glass Argon Filled with Low emissivity (Low-E) coating - all to achieve a minimum "U" value of 1.4 w/m<sup>2</sup>k to satisfy building regulations  
Do not allow for any roughted slots for trickle vents within the frame - this is to be achieved (to satisfy building regulations) via using a suitable low profile air brick within the masonry frame wall construction below the cill line  
All glazed lights to windows and doors to be double glazed.  
utilise toughened glass to BS 6206:1981 to all 'critical' locations. units to consist low emission glass with 'slimlight' frames 12mm air gap to achieve 1.4 w/m<sup>2</sup>k  
All windows within 800mm of floor level to be glazed with toughened glass  
Fix slimlight glazing panels within the rebated frames using linseed oil putty and small glazing spriggs  
This drawing must not be scaled. All dimensions are to be approximate only and to be checked prior to the construction stage

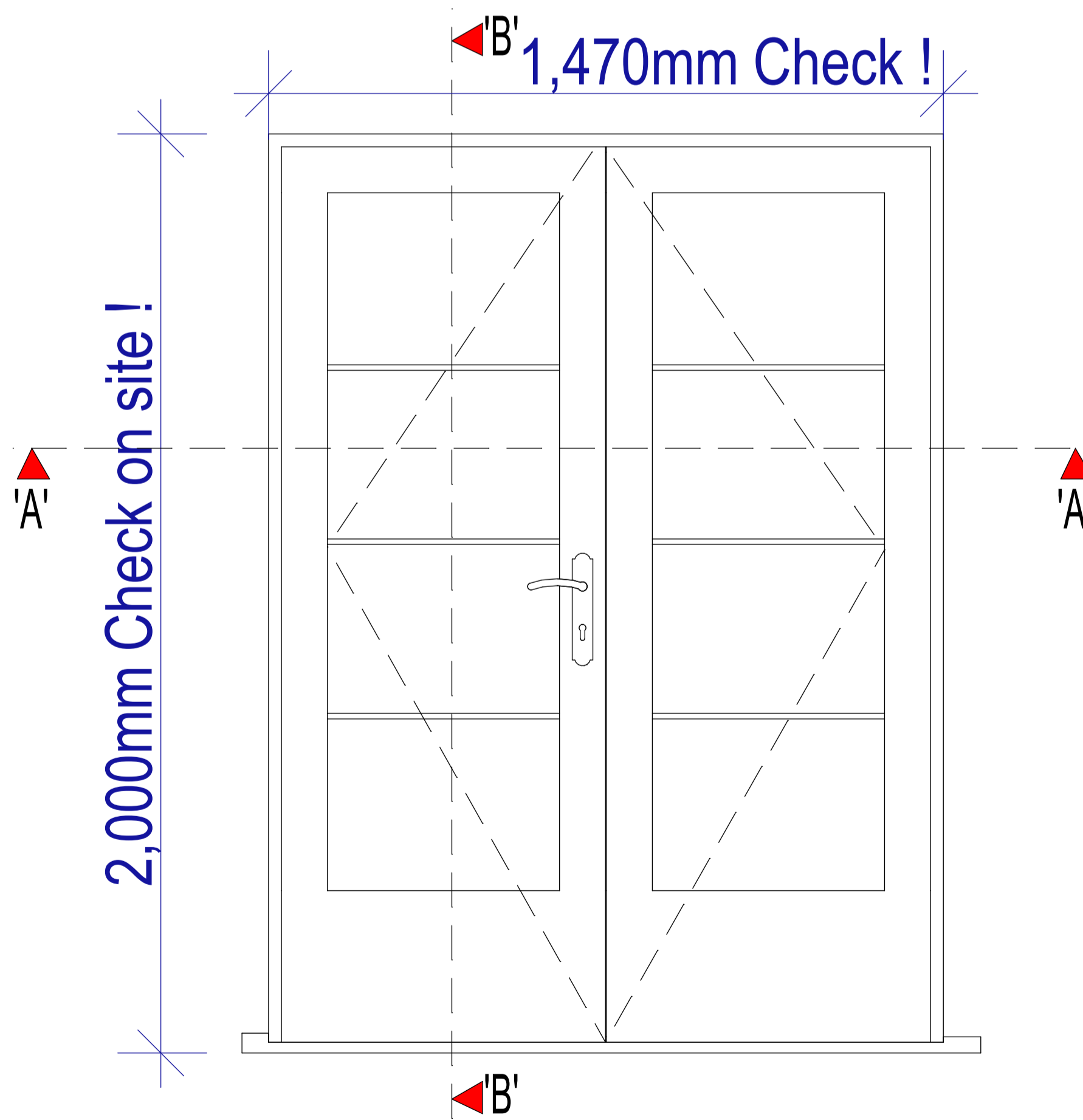

**Rear Elevation**  
**Proposed Study Window - 1 off**  
Scale: 1:10 @A1 Drawing

PL0 31.01.24 : Issued to client for approval : mnl

**MNL DESIGNS LTD**

5 Heather Close Thurston Bury St. Edmunds Suffolk IP31 3PX tele: 01359 232507 Mo: 07827 683 702 e: lewisnm521@gmail.com

client : Mr. William Pate	job : 43 Whiting Street Bury St. Edmunds Suffolk IP33 1NP	drawing : Proposed Joinery Details of Double French Doors
------------------------------	---	--

scale: as shown	date: 31/01/24	dm.: mnl	job no.: MNL448	drg. no.: 06	rev.: PL0
--------------------	-------------------	-------------	--------------------	-----------------	--------------