

Existing Rear Elevation
Scale: 1:50 @ A1 Print

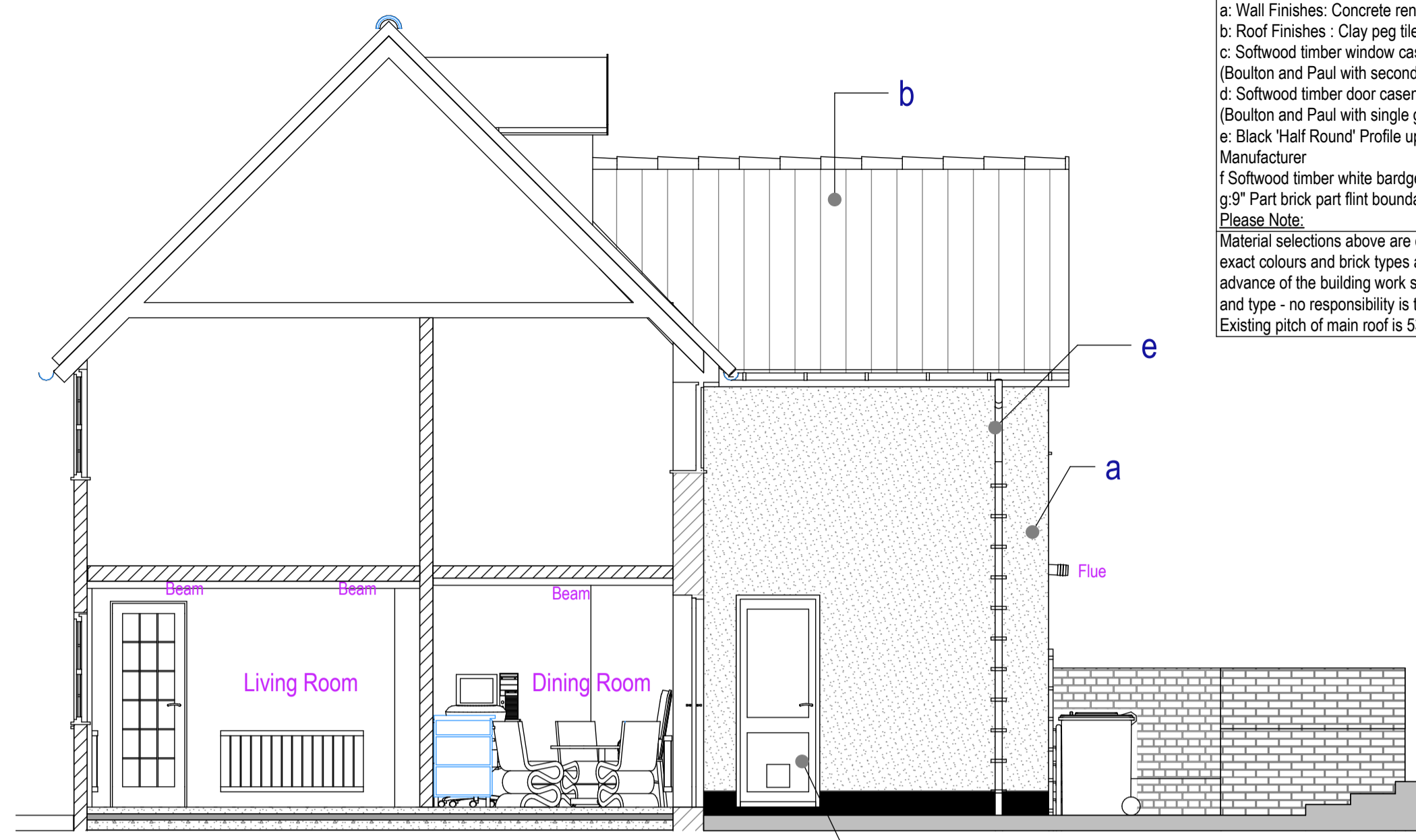

Existing Side Elevation (Section 'D'-D')
Scale: 1:50 @ A1 Print

Schedule of finishes 43 WHITING STREET BURY ST EDMUNDS IP33 1NP:
 a: Wall Finishes: Concrete render in a smooth finish painted white
 b: Roof Finishes: Clay peg tiles granular finish in Brown Colour
 c: Softwood timber window casement to sizes and style as shown: Finished: White (Boulton and Paul with secondary glazing panel)
 d: Softwood timber door casement to sizes and style as shown: Finished: White (Boulton and Paul with single glazing panel)
 e: Black 'Half Round' Profile upvc guttering and downpipes by osma or similar Manufacturer
 f: Softwood timber white barge boarding and soffit boards
 g: 9" Part brick part flint boundary wall
 Please Note:
 Material selections above are carried out from observations and photographs only, exact colours and brick types and tiles should be carried out via trial samples in advance of the building work stage and before ordering to establish exact colour and type - no responsibility is taken by MNL designs Ltd
 Existing pitch of main roof is 53 degrees and 46.1 degree for flank elevation roof

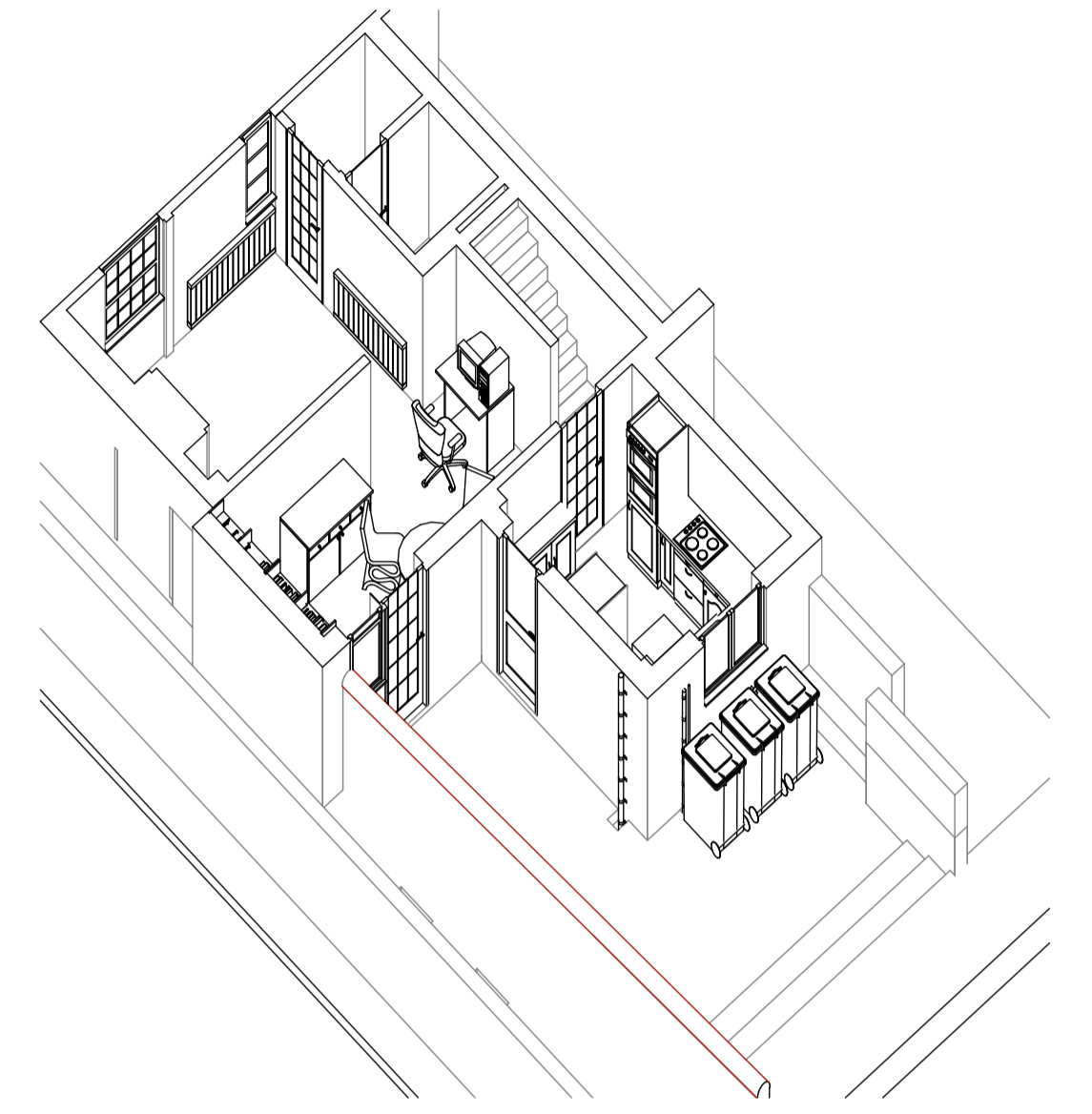

3D Cutaway - Existing
Scale: 1:100

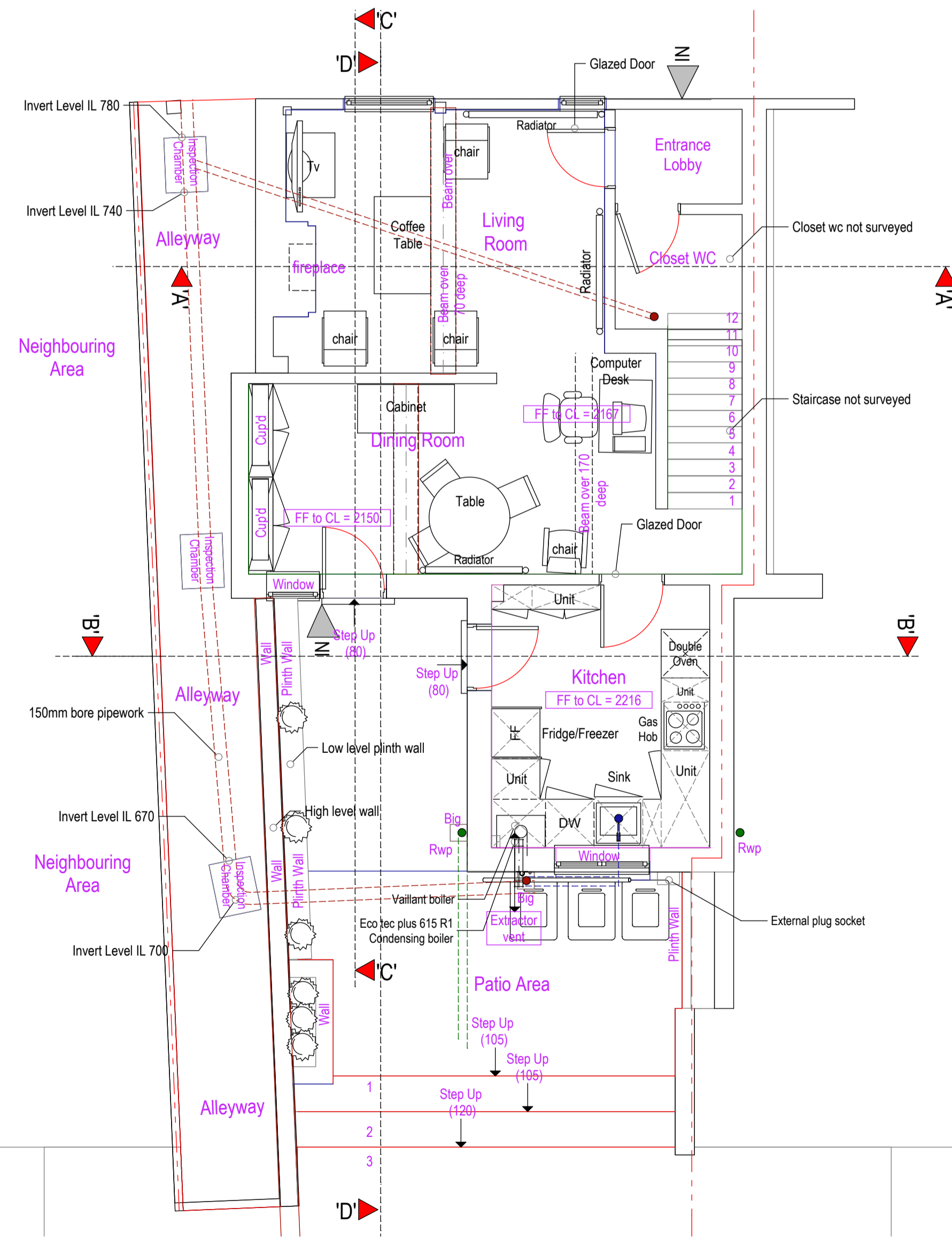

Existing Ground Floor Plan
Scale: 1:50 @ A1 Print

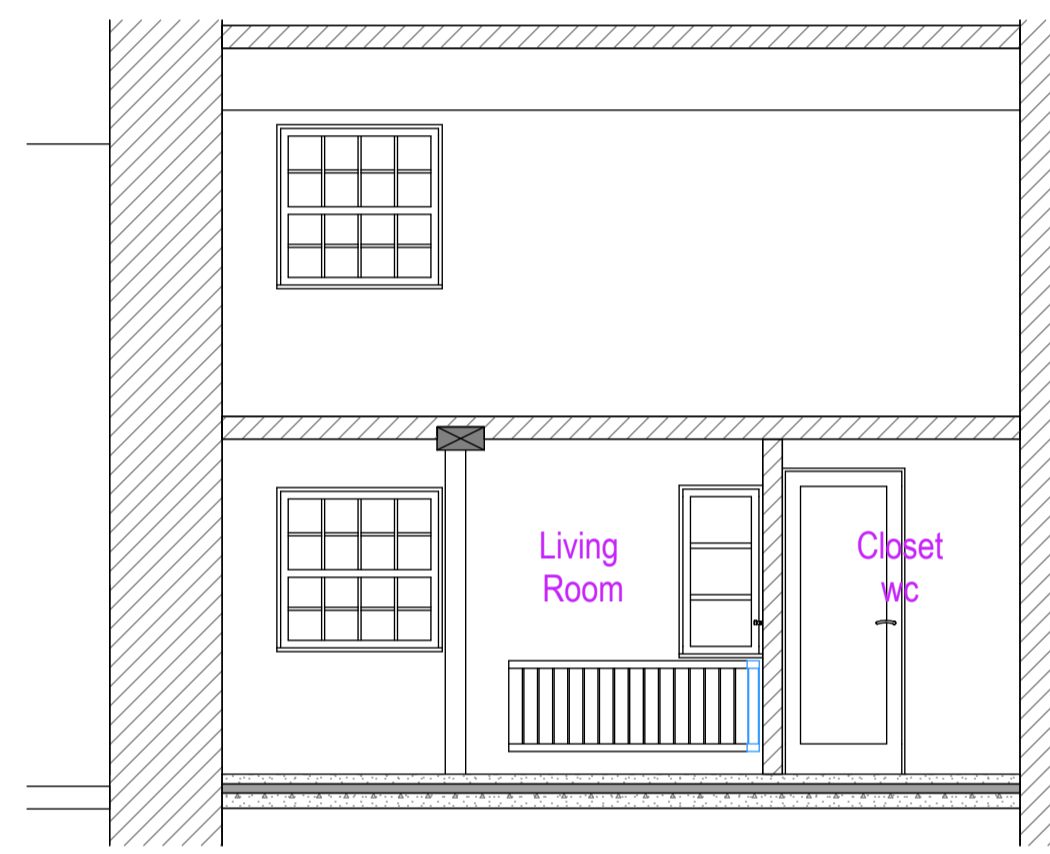

Existing Section Thro' '-A'-A'
Scale: 1:50 @ A1 Print



3D Rear/Side View - Existing
Scale: 1:100

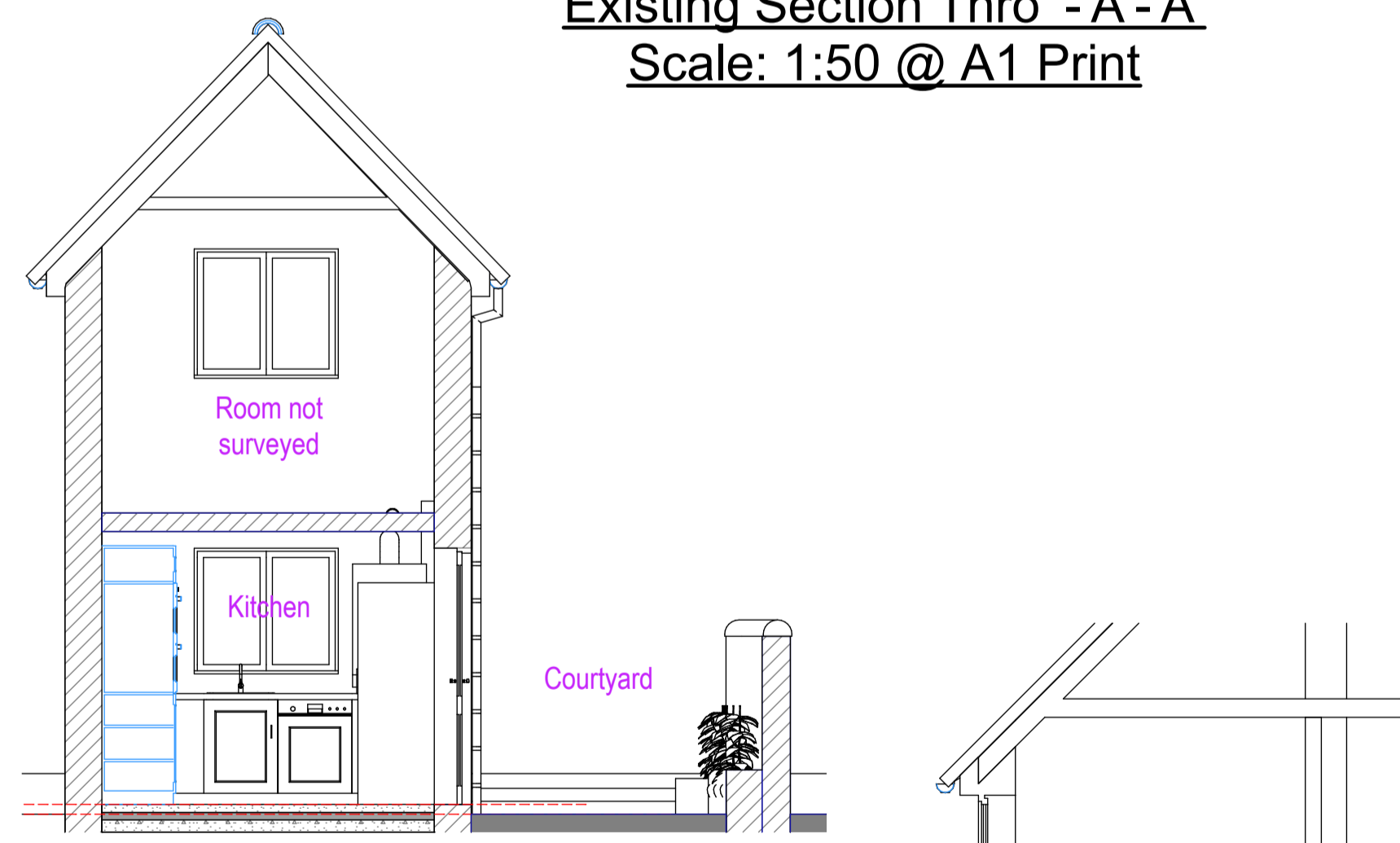

Existing Section Thro' '-B'-B'
Scale: 1:50 @ A1 Print

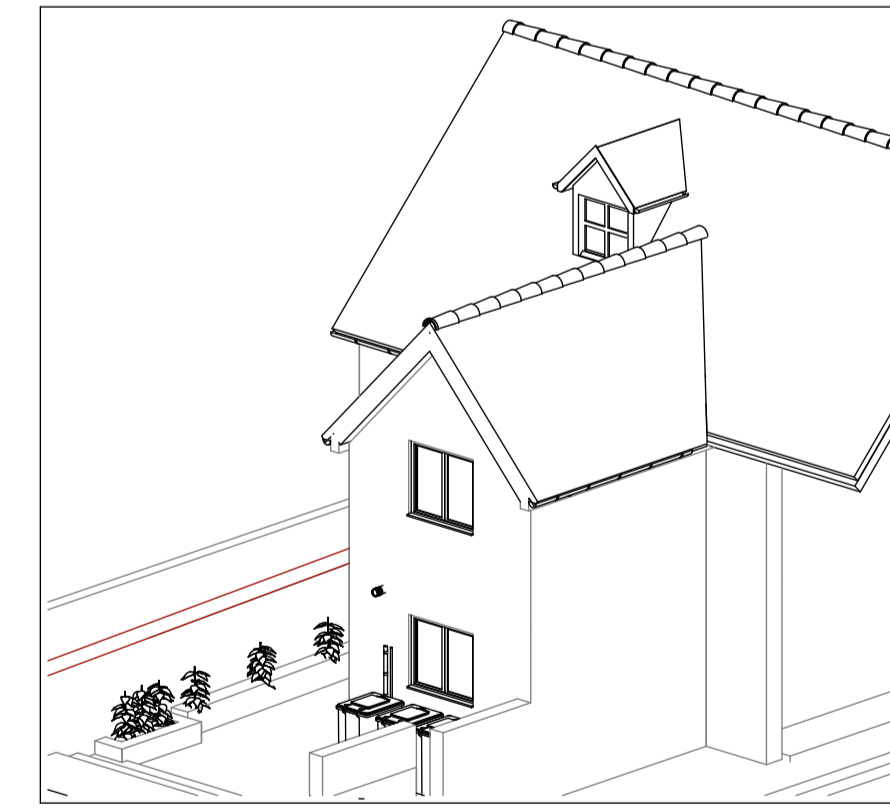

3D Rear/Side View - Existing
Scale: 1:100

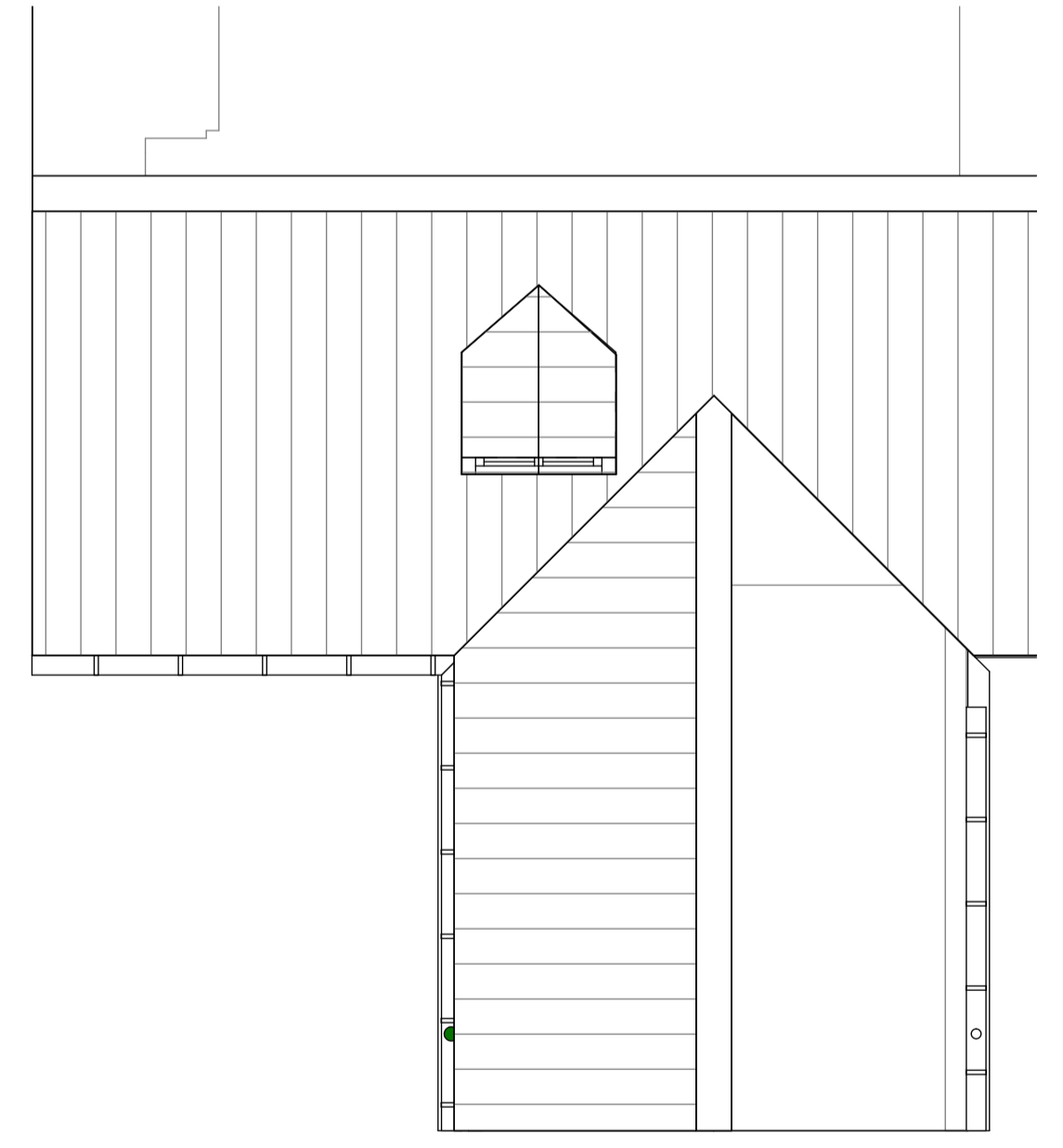

Existing Roof Plan
Scale: 1:50 @ A1 Print

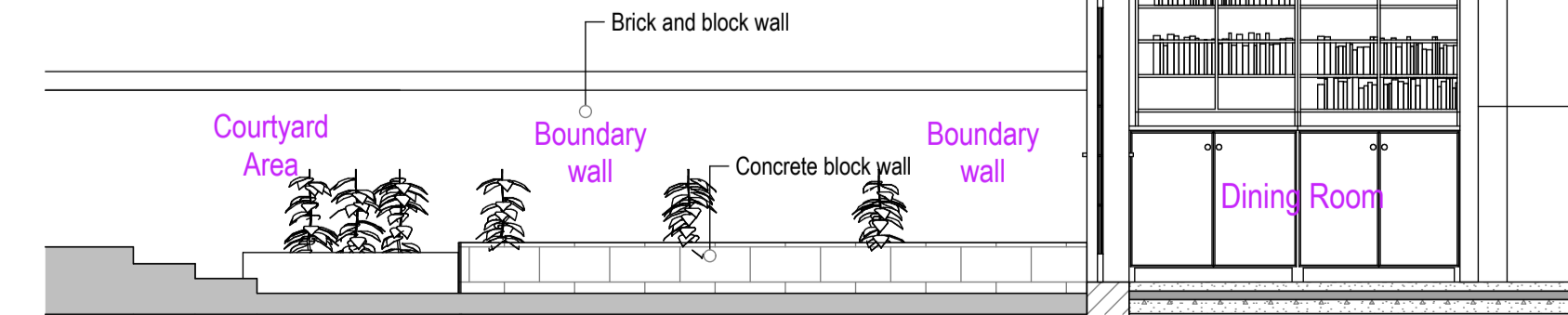

Existing Section Thro' '-C'-C'
Scale: 1:50 @ A1 Print