

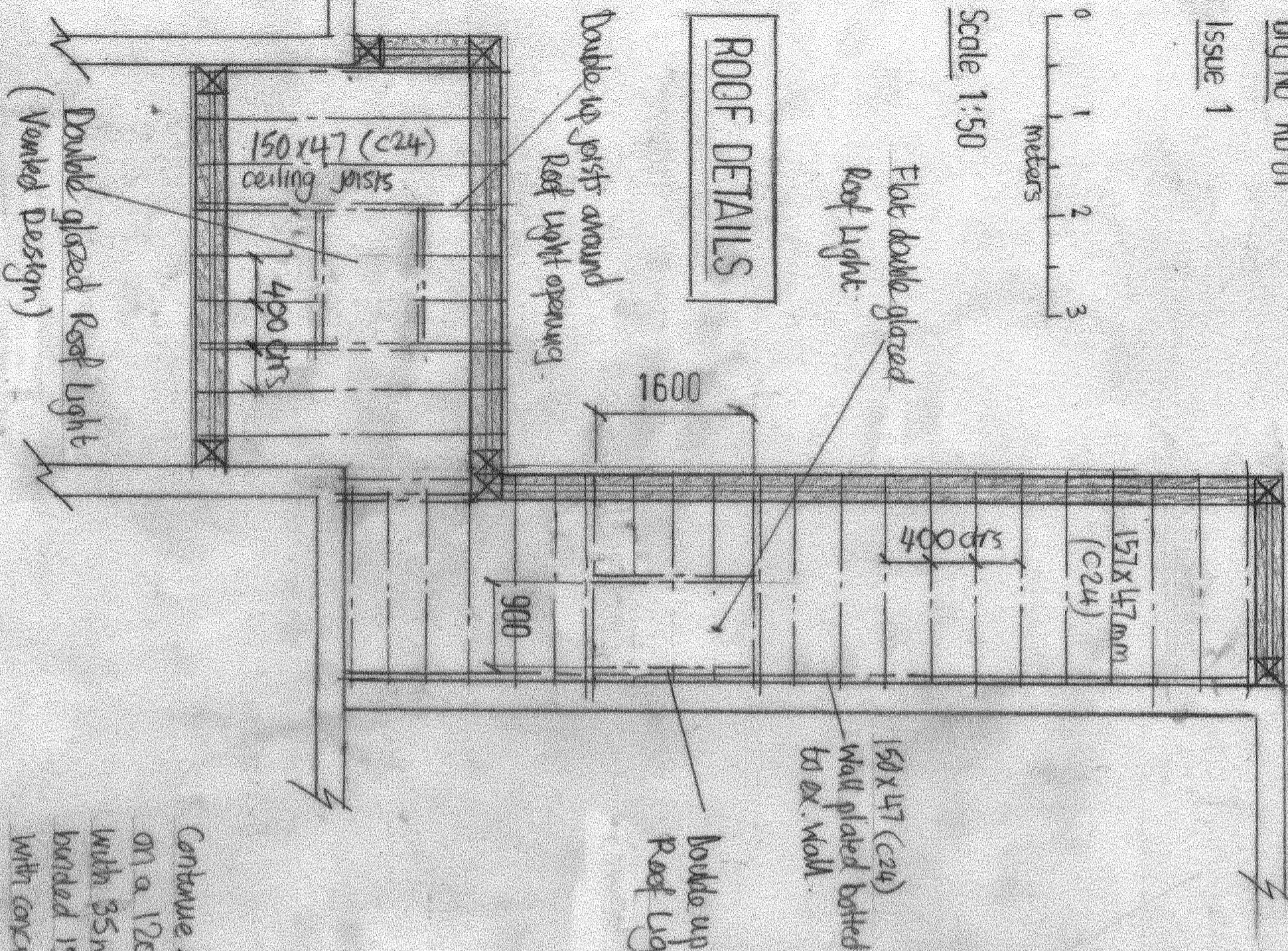

Scale 1:50

ROOF DETAILS



Flat double glazed Roof Light.

150x47 (C24) Wall plated bolted to ex. wall.

Double up joists around Roof Light opening

Roof Construction - Fix a EPDM rubber membrane on 19mm staggered Siding boards on 150mm Gilder or similar rigid insulation board on 150x47(C24) joists set at 400trs and fixed to 100x75 wall plates on row blockwork and wall plate bolted to ex wall. Add vapour barrier to inner side of joists with 12.5mm plasterboard with skim finish. Wall plates fixed to inner leaf with 30x5x1200 galvanised Bar Straps at 1200trs and each side of every joist with 30x5x900 galvanised Bar Straps every 3 joists.

Use Cable lead flashing to junction of Flat roof and ex blockwork - Min 150mm overlap. Fix in accordance with BS5500 guidelines.

Use 20mm thick UPVC Faced and gaskets with 10mm air gap for ventilation. ϕ 100 UPVC guttering into ϕ 75 RWIP.

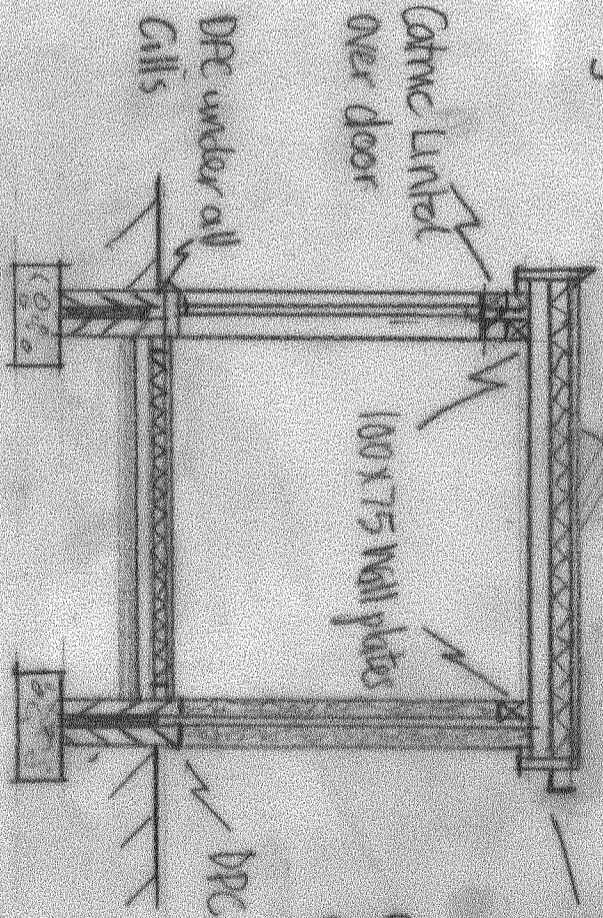

Continue existing concrete floor. 75mm lightly reinforced sand/concrete screed on a 1200g vapour barrier on Kingspan or similar rigid insulation board with 35mm perimeter upstand on 100mm thick concrete slab on 50mm sand bedded 150mm consolidated hardcore. Fit Radon slates to all service entries with concrete lintels over all pipework - 0.18 w/m² U value.