

Title Number : BM343059

This title is dealt with by HM Land Registry, Leicester Office.

The following extract contains information taken from the register of the above title number. A full copy of the register accompanies this document and you should read that in order to be sure that these brief details are complete.

Neither this extract nor the full copy is an 'Official Copy' of the register. An official copy of the register is admissible in evidence in a court to the same extent as the original. A person is entitled to be indemnified by the registrar if he or she suffers loss by reason of a mistake in an official copy.

This extract shows information current on 22 NOV 2021 at 09:40:36 and so does not take account of any application made after that time even if pending in HM Land Registry when this extract was issued.

REGISTER EXTRACT

Title Number	: BM343059
Address of Property	: The Rectory, Stone, Aylesbury (HP17 8RZ)
Price Stated	: Not Available
Registered Owner(s)	: THE INCUMBENT OF THE BENEFICE OF STONE WITH DINTON AND HARTWELL IN THE COUNTY OF BUCKINGHAM IN THE DIOCESE OF OXFORD AND HIS SUCCESSORS care of Diocesan Church House, North Hinksey Lane, Botley, Oxford OX2 0NB.
Lender(s)	: None

Title number BM343059

This is a copy of the register of the title number set out immediately below, showing the entries in the register on 22 NOV 2021 at 09:40:36. This copy does not take account of any application made after that time even if still pending in HM Land Registry when this copy was issued.

This copy is not an 'Official Copy' of the register. An official copy of the register is admissible in evidence in a court to the same extent as the original. A person is entitled to be indemnified by the registrar if he or she suffers loss by reason of a mistake in an official copy. If you want to obtain an official copy, the HM Land Registry web site explains how to do this.

A: Property Register

This register describes the land and estate comprised in the title.

BUCKINGHAMSHIRE

- 1 (25.02.2009) The Freehold land shown edged with red on the plan of the above title filed at the Registry and being The Rectory, Stone, Aylesbury (HP17 8RZ).

B: Proprietorship Register

This register specifies the class of title and identifies the owner. It contains any entries that affect the right of disposal.

Title absolute

- 1 (25.02.2009) PROPRIETOR: THE INCUMBENT OF THE BENEFICE OF STONE WITH DINTON AND HARTWELL IN THE COUNTY OF BUCKINGHAM IN THE DIOCESE OF OXFORD AND HIS SUCCESSORS care of Diocesan Church House, North Hinksey Lane, Botley, Oxford OX2 0NB.
- 2 (25.02.2009) RESTRICTION: No disposition of the registered estate is to be registered unless made in accordance with the Parsonages Measure 1938 or some other Measure or authority.

End of register

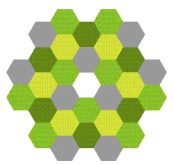

©Crown Copyright. Produced by HM Land Registry. Reproduction in whole or in part is prohibited without the prior written permission of Ordnance Survey. Licence Number 100026316

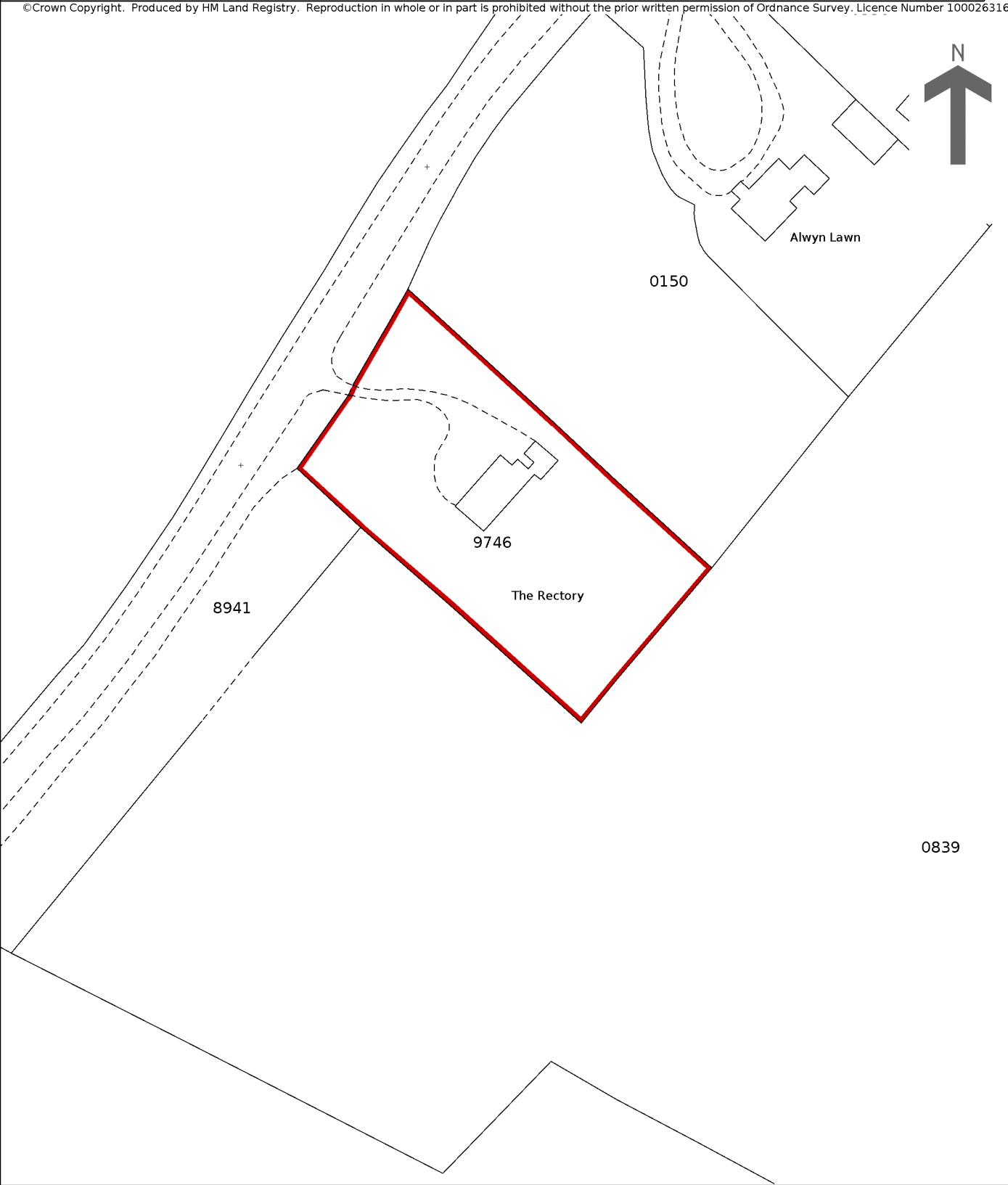

This is a copy of the title plan on 22 NOV 2021 at 09:40:37. This copy does not take account of any application made after that time even if still pending in HM Land Registry when this copy was issued.

This copy is not an 'Official Copy' of the title plan. An official copy of the title plan is admissible in evidence in a court to the same extent as the original. A person is entitled to be indemnified by the registrar if he or she suffers loss by reason of a mistake in an official copy. If you want to obtain an official copy, the HM Land Registry web site explains how to do this.

HM Land Registry endeavours to maintain high quality and scale accuracy of title plan images. The quality and accuracy of any print will depend on your printer, your computer and its print settings. This title plan shows the general position, not the exact line, of the boundaries. It may be subject to distortions in scale. Measurements scaled from this plan may not match measurements between the same points on the ground.

This title is dealt with by HM Land Registry, Leicester Office.