

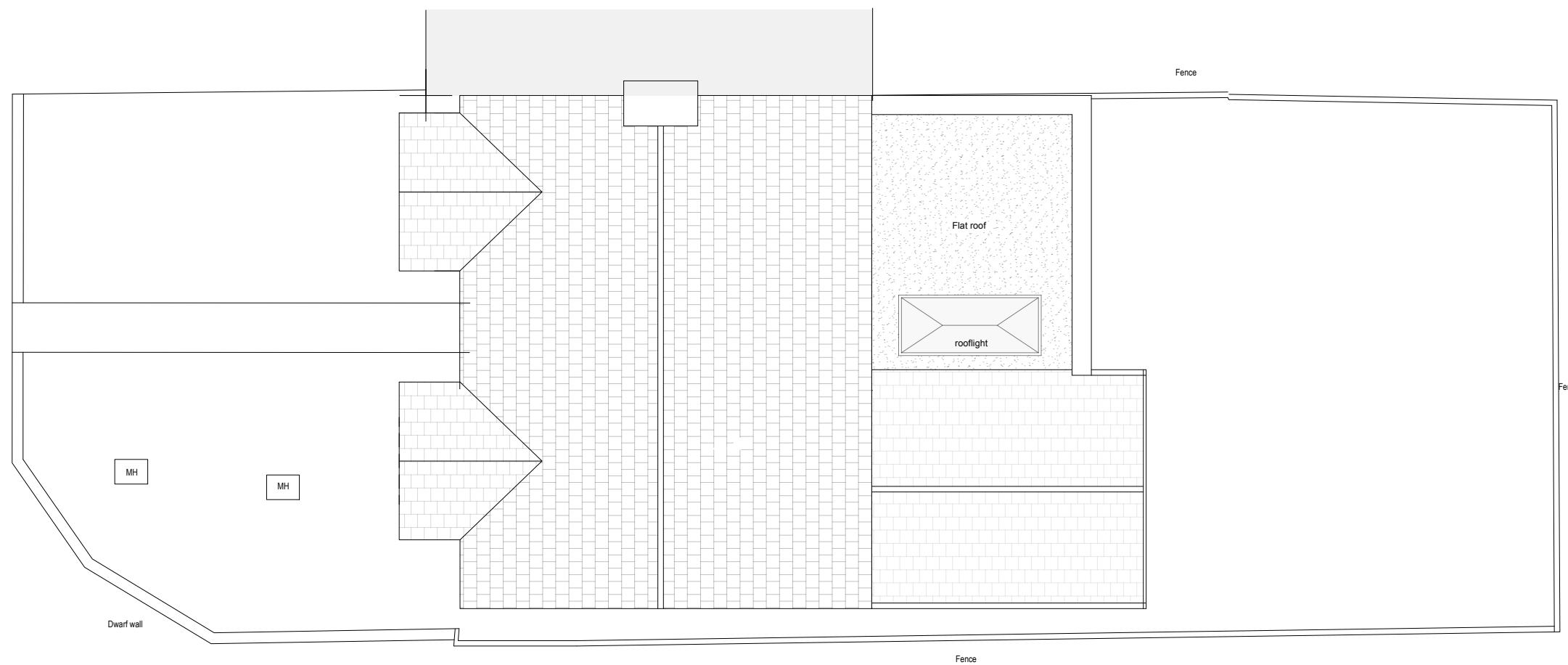

This drawing is protected under Copyright and at no time should any portion of this drawing be reproduced or copied without the permission of the Architect. (Design Copyright Act 1968)

This drawings must not be used for purposes other than that for which it is provided. It is supplied without liability for any errors or omissions. Drawings only to be scaled for planning application purposes, all dimensions to be checked on site.

All drawings subject to Statutory Authority Approval.



**Proposed Roof plan**  
**1:100**

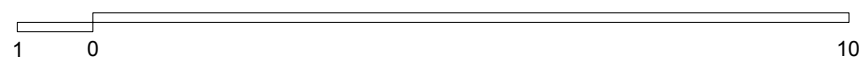
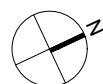

Rev A - Issued to client  
Revisions

04.09.23  
Date

PROJECT TITLE: **145 Pembury Avenue, Old Malden, Worcester Park, KT4 8BX**

DRWG TITLE: **Proposed Roof plan**

DRWG No: **2313\_P112**

REV: **A**

SCALE: **1:100@A3** DATE: **04.09.23**

DRWG STATUS: **Information**

a: 103/105 Brighton Rd Coulsdon, Surrey, CR5 2NG  
t: 0208 6432716

e: enquiry@jorgessalman.com

w: www.jorgessalman.com

Jorges Salman Architects Limited - Company Registration Number: 5081435

