

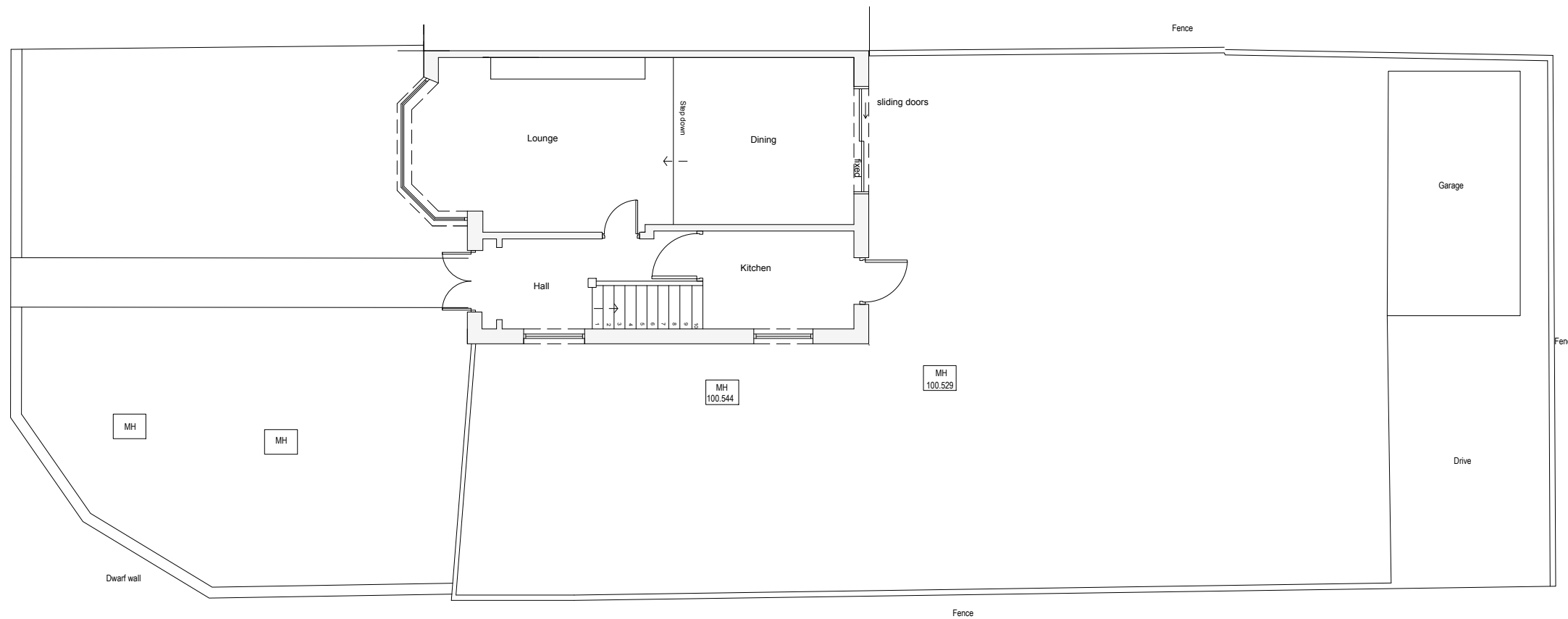

This drawing is protected under Copyright and at no time should any portion of this drawing be reproduced or copied without the permission of the Architect. (Design Copyright Act 1968)

This drawings must not be used for purposes other than that for which it is provided. It is supplied without liability for any errors or omissions. Drawings only to be scaled for planning application purposes, all dimensions to be checked on site.

All drawings subject to Statutory Authority Approval.



Existing Ground floor plan
1:100

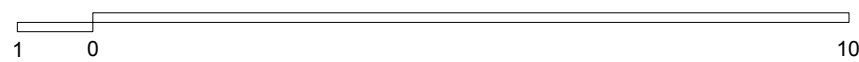
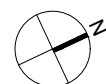

Existing Walls

Rev A - Issued to client
Revisions

04.09.23
Date

PROJECT TITLE: 145 Pembury Avenue, Old Malden, Worcester Park, KT4 8BX

DRWG TITLE: Existing Ground floor

DRWG No: 2313_P010

REV: A

SCALE: 1:100@A3 DATE: 04.09.23

DRWG STATUS: Information

a: 103/105 Brighton Rd Coulsdon, Surrey, CR5 2NG
t: 0208 6432716

e: enquiry@jorgessalman.com

w: www.jorgessalman.com
Jorges Salman Architects Limited - Company Registration Number: 9081435

