

EXISTING SITE PLAN 1:200

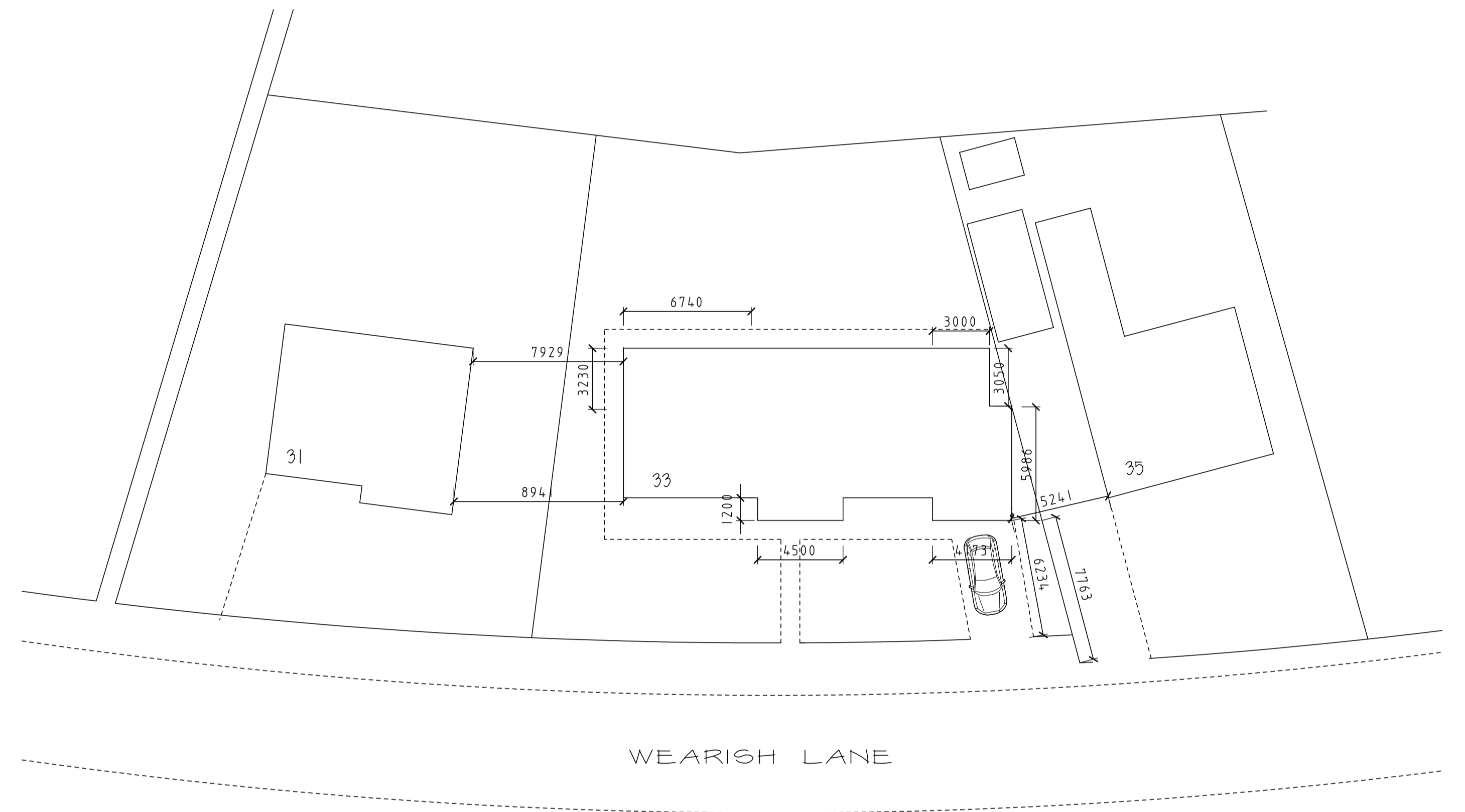
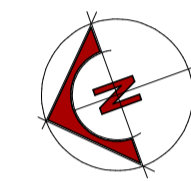

PROPOSED SITE PLAN 1:200

CLIENT: MR S RANCAR,	PROPOSED: SITE PLAN
LOCATION: 33 Wearish Lane Weethoughton Bolton	SCALE: 1:200
BL5 2AX	DATE: MARCH 2024.
	DRG.NO: 24/110/SP
	AMENDMENTS:

**L . P . P Consultants Ltd**  
 BOUNDARY HOUSE  
 578 NEWTON ROAD  
 LOWTON, WARRINGTON  
 WA3 1PQ  
 Tel/Fax: 01925 221883 Email: lawsonpreston@aol.com