

1:50 PROPOSED "FRONT" ELEVATION

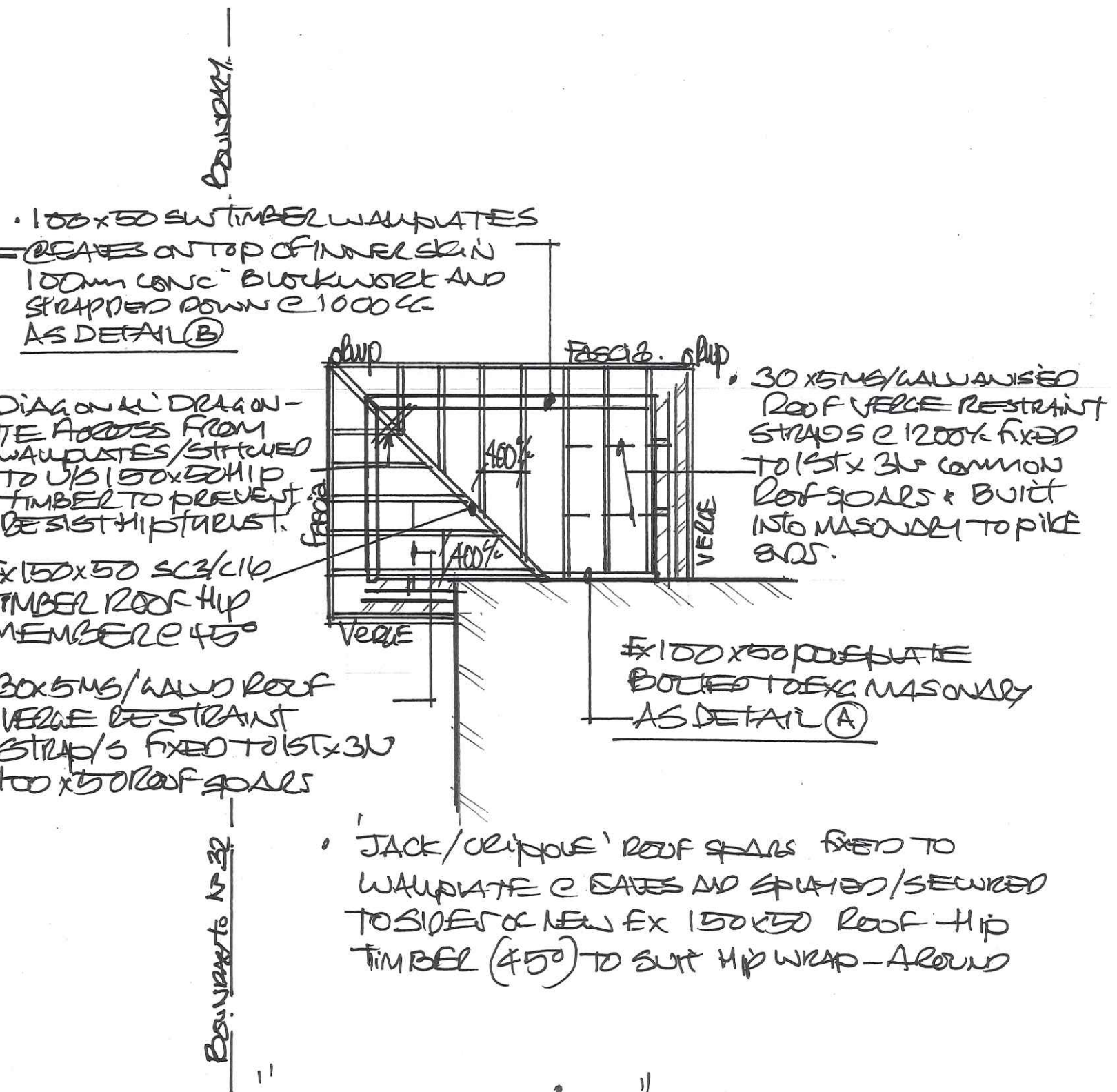

1:50 ROOF-CARASSING - PLAN

- 100x50 SW TIMBER WAUPLATES @ EAVES ON TOP OF INNER SKIN 100mm CONC. BLOCKWORK AND STRAPPED DOWN @ 1000 CC AS DETAIL (B)
- DIAGONAL DRAGON-TIE ACROSS FROM WAUPLATES/STITCHED TO U/S 150x50 HIP TIMBER TO PREVENT BEST HIP TURST.
- EX 150x50 SC3/C14 TIMBER ROOF HIP MEMBER @ 45°
- 30x5MS/WALV ROOF VERGE RESTRAINT STRAP/S FIXED TO 150x300 ROOF SOALS
- JACK/CRIPPLE ROOF RAFTS FIXED TO WAUPLATE @ EAVES AND STRAPPED/SECURED TO SIDES OF NEW EX 150x50 ROOF HIP TIMBER (45°) TO SUIT HIP WRAP-AROUND
- 30x5MS/WALVANISED ROOF VERGE RESTRAINT STRAP/S @ 1200 CC FIXED TO 150x300 COMMON ROOF SOALS & BUILT INTO MASONRY TO PIKE END.
- EX 100x50 POSIPLATE BOLTED TO EXC MASONRY AS DETAIL (A)

05 MAR 2024

17701/24

DRG N°: **5A**