

31, NORTH ROAD AVENUE, HERTFORD, SG14 2BT

Supplied by: www.ukmapcentre.com

Serial No: 267443

Centre Coordinates: 531425,213013

Production Date: 11/07/2023 09:33:08

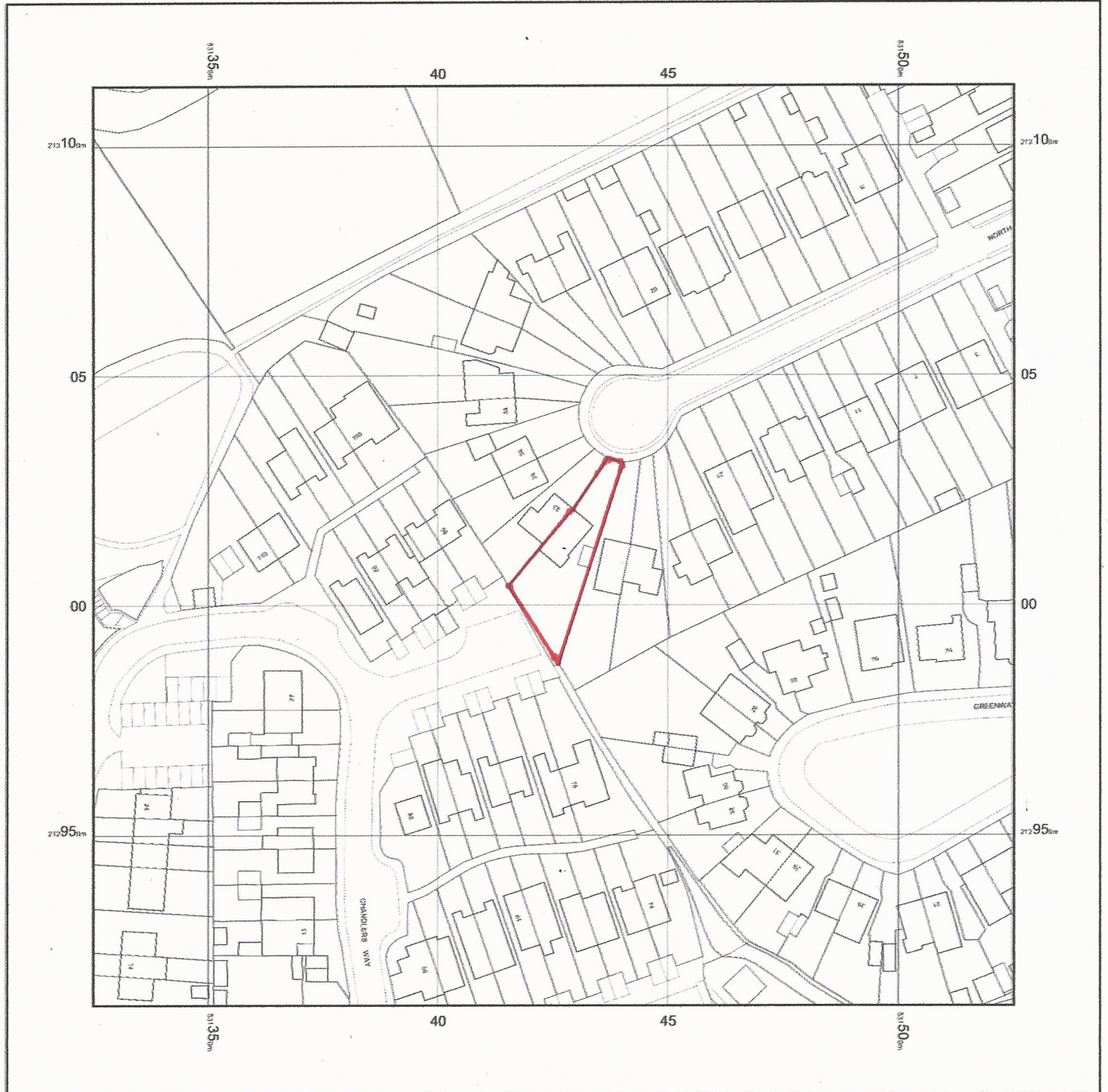

© Crown copyright and database rights 2023 Ordnance Survey 100048957. The representation of road, track or path is no evidence of a boundary or right of way. The representation of features as lines is no evidence of a property boundary.

0m 1cm = 12.5m 62.5m
Scale 1:1250