

VERTICAL SECTION DOOR

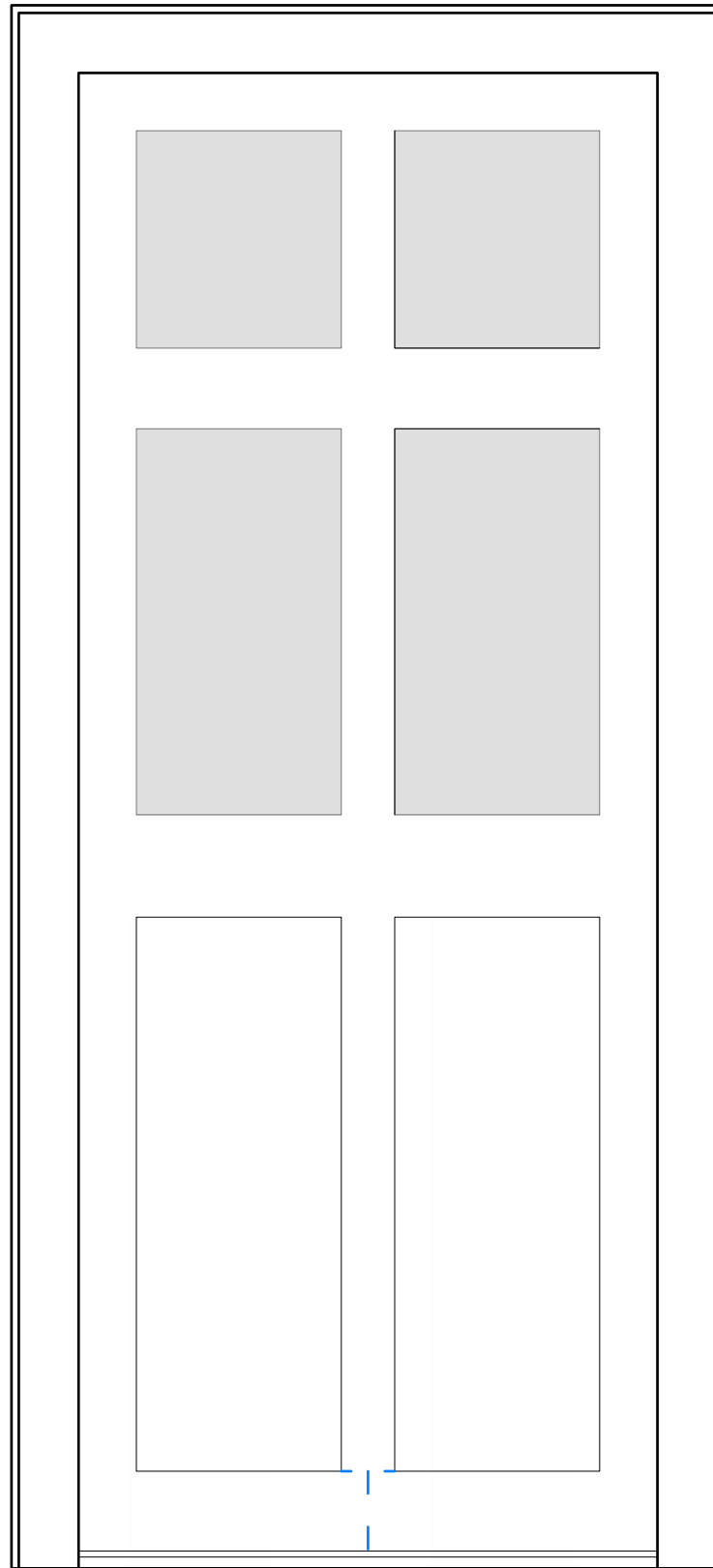

PLAN DOOR

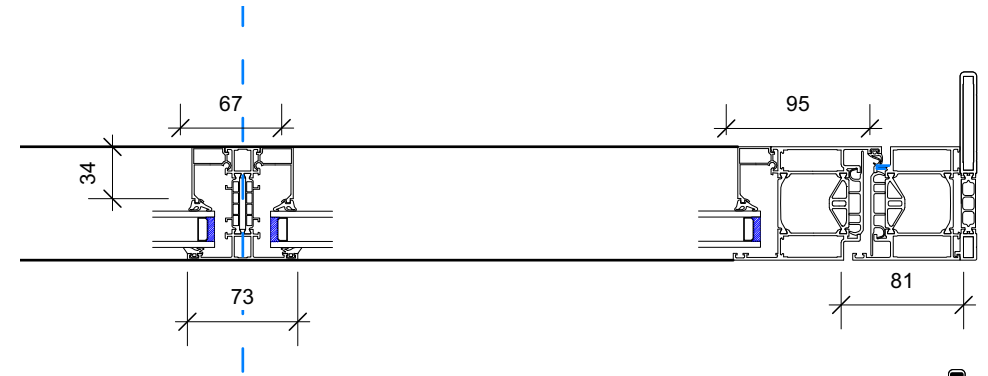
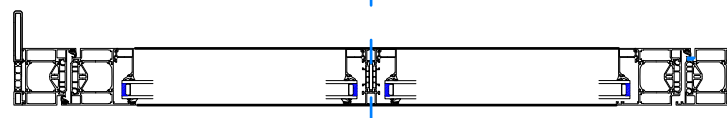

TRANSVERSE SECTION

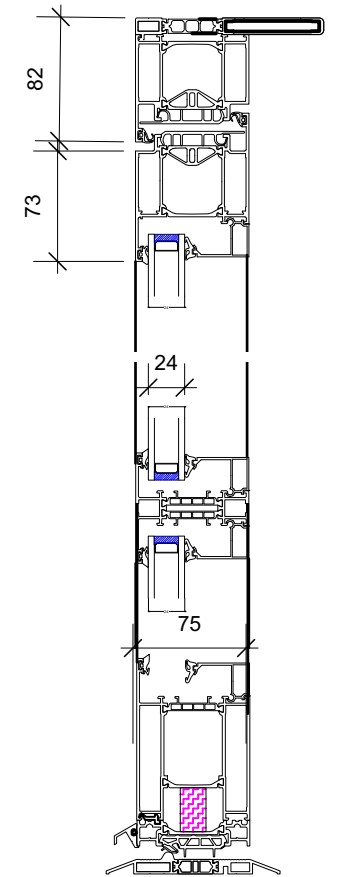
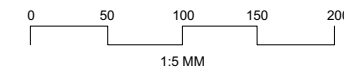

VERTICAL SECTION

IN KEEPING WITH THE CONTEMPORARY BUILD OF THE LINK THE REAR DOOR IS A ROBUST ALUMINIUM POWDER COATE FRAME AND INWARD OPENING DOOR WELL INSULATED AND DOUBLE GLAZED DOUBLE-GLAZING TO BE ARGON FILLED, SOFT-COAT, LOW-E GLASS.

PLAN DOOR JAMB DETAIL

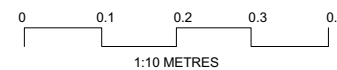

AMENDMENT:
A:

DATE
00.00.00

Status	DISCHARGE CONDITIONS	
Job no / drawing no	Job title	
858 A 11	1 GAINSBOROUGH	
Drawing title		
Summer Room Elevations		
Date	Sheet	Scale
JAN 2024	A3	var
Drawn by	Checked by	
ST	ST	



Do not scale