

Site Details:

Land behind 22 to 34, GOLDNEY AVENUE, WARMLEY, BS30 5JG

Client Ref: OE-1702-1058-LS-272
Report Ref: GS-LAU-T4D-TR3-2M1
Grid Ref: 367298, 173277

Map Name: County Series

Map date: 1883

Scale: 1:10,560

Printed at: 1:10,560

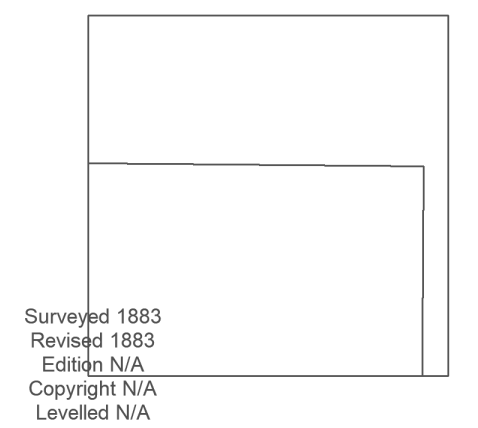
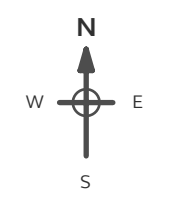

Surveyed 1883
 Revised 1883
 Edition N/A
 Copyright N/A
 Levelled N/A



Produced by
 Groundsure Insights
 T: 08444 159000
 E: info@groundsure.com
 W: www.groundsure.com

© Crown copyright and database rights 2018 Ordnance Survey 100035207

Production date: 27 November 2023

Map legend available at:
www.groundsure.com/sites/default/files/groundsure_legend.pdf

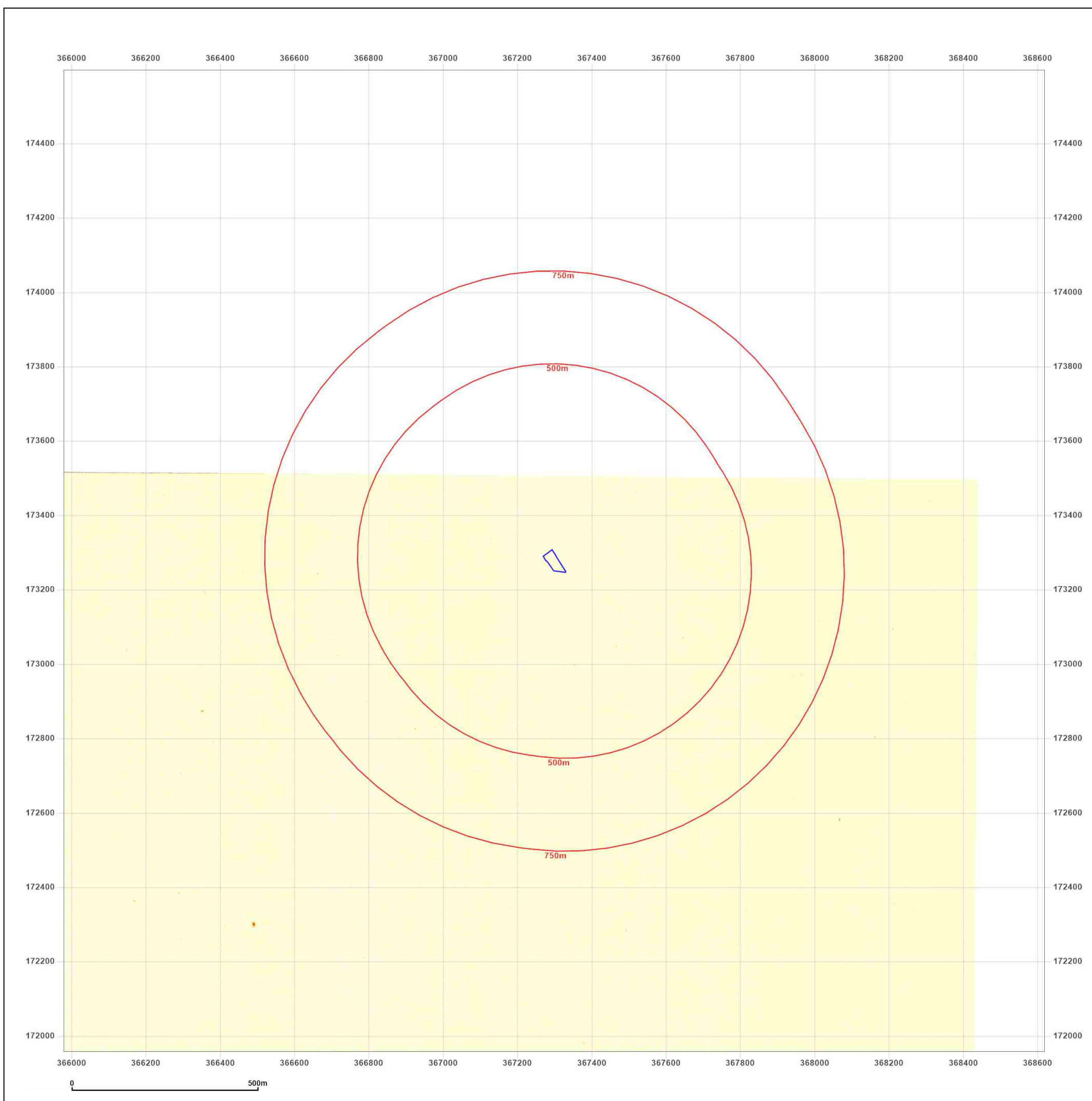

Site Details:

Land behind 22 to 34, GOLDNEY AVENUE, WARMLEY, BS30 5JG

Client Ref: OE-1702-1058-LS-272
Report Ref: GS-LAU-T4D-TR3-2M1
Grid Ref: 367298, 173277

Map Name: County Series

Map date: 1881-1886

Scale: 1:10,560

Printed at: 1:10,560



Surveyed 1881
 Revised 1881
 Edition N/A
 Copyright N/A
 Levelled N/A

Surveyed 1883
 Revised N/A
 Edition N/A
 Copyright N/A
 Levelled N/A



Produced by
 Groundsure Insights
 T: 08444 159000
 E: info@groundsure.com
 W: www.groundsure.com

© Crown copyright and database rights 2018 Ordnance Survey 100035207

Production date: 27 November 2023

Map legend available at:
www.groundsure.com/sites/default/files/groundsure_legend.pdf

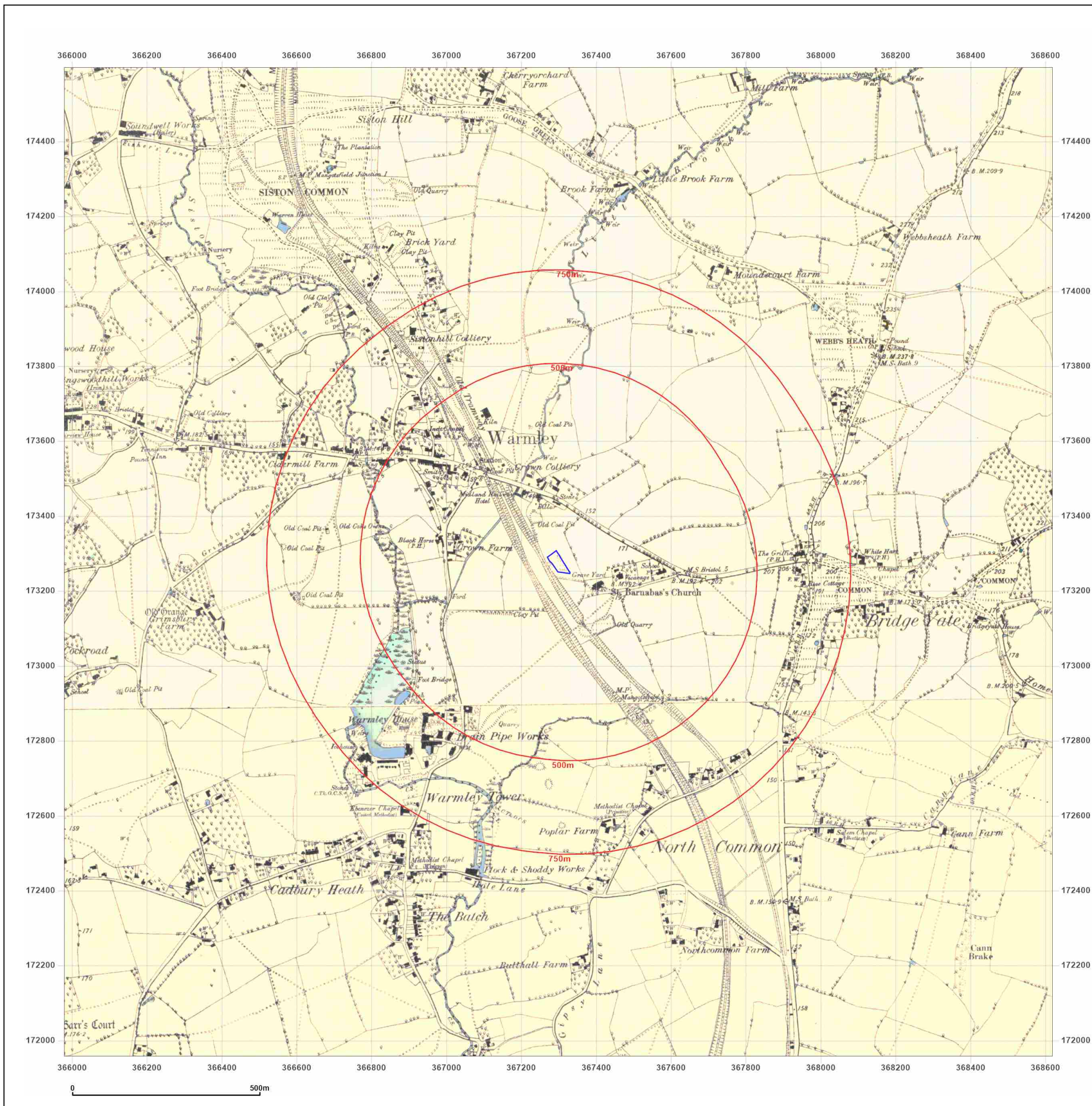

Site Details:

Land behind 22 to 34, GOLDNEY AVENUE, WARMLEY, BS30 5JG

Client Ref: OE-1702-1058-LS-272
Report Ref: GS-LAU-T4D-TR3-2M1
Grid Ref: 367298, 173277

Map Name: County Series

Map date: 1883-1887

Scale: 1:10,560

Printed at: 1:10,560



Surveyed 1881
 Revised N/A
 Edition 1887
 Copyright N/A
 Levelled N/A

Surveyed 1883
 Revised 1883
 Edition N/A
 Copyright N/A
 Levelled N/A



Produced by
 Groundsure Insights
 T: 08444 159000
 E: info@groundsure.com
 W: www.groundsure.com

© Crown copyright and database rights 2018 Ordnance Survey 100035207

Production date: 27 November 2023

Map legend available at:
www.groundsure.com/sites/default/files/groundsure_legend.pdf



Site Details:

Land behind 22 to 34, GOLDNEY AVENUE, WARMLEY, BS30 5JG

Client Ref: OE-1702-1058-LS-272
Report Ref: GS-LAU-T4D-TR3-2M1
Grid Ref: 367298, 173277

Map Name: County Series

Map date: 1902

Scale: 1:10,560

Printed at: 1:10,560



Surveyed 1880
 Revised 1902
 Edition N/A
 Copyright N/A
 Levelled N/A

Surveyed 1880
 Revised 1902
 Edition N/A
 Copyright N/A
 Levelled N/A



Produced by
 Groundsure Insights
 T: 08444 159000
 E: info@groundsure.com
 W: www.groundsure.com

© Crown copyright and database rights 2018 Ordnance Survey 100035207

Production date: 27 November 2023

Map legend available at:
www.groundsure.com/sites/default/files/groundsure_legend.pdf

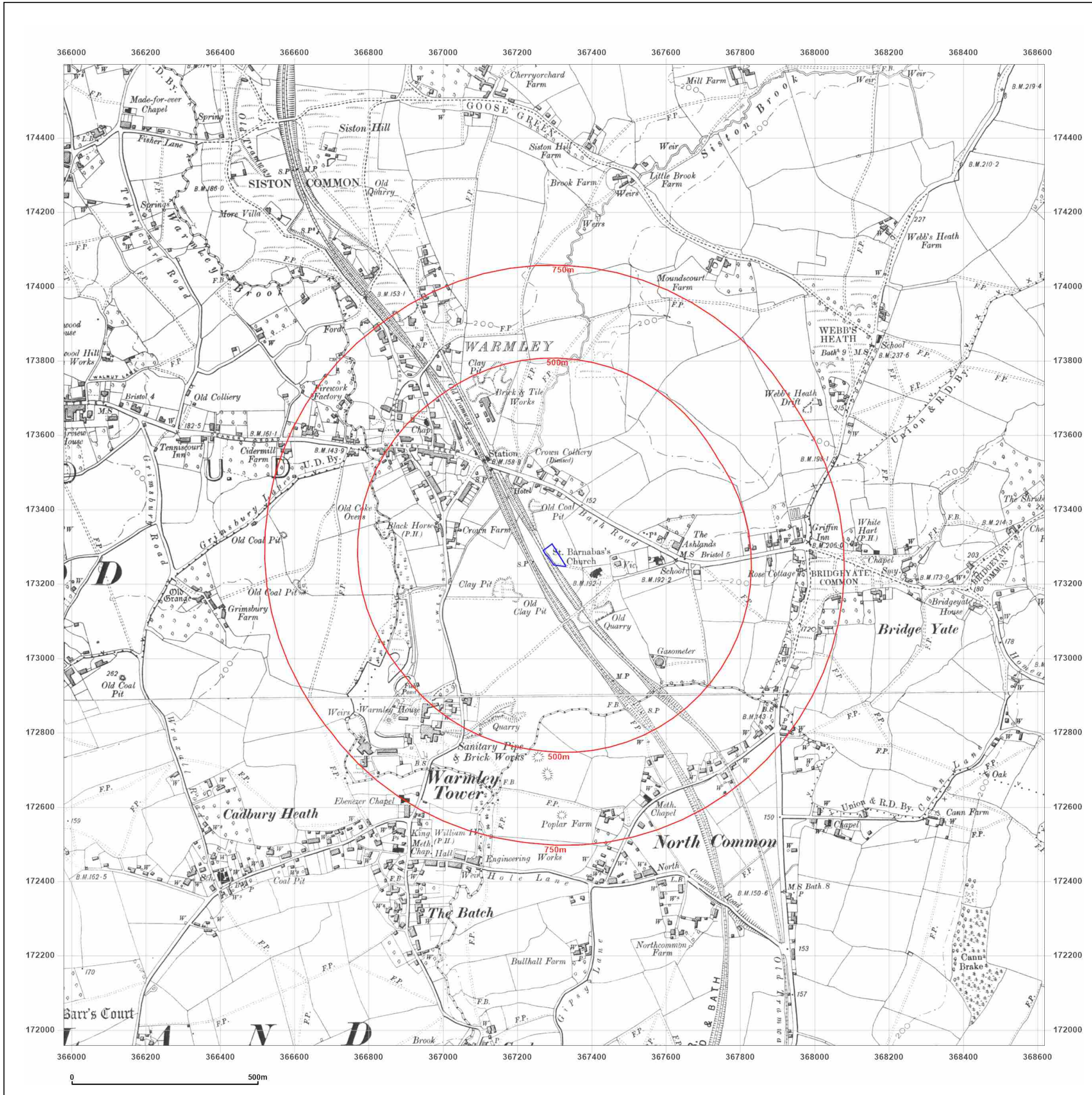

Site Details:

Land behind 22 to 34, GOLDNEY AVENUE, WARMLEY, BS30 5JG

Client Ref: OE-1702-1058-LS-272
Report Ref: GS-LAU-T4D-TR3-2M1
Grid Ref: 367298, 173277

Map Name: County Series

Map date: 1912

Scale: 1:10,560

Printed at: 1:10,560



Surveyed 1880
 Revised 1912
 Edition N/A
 Copyright N/A
 Levelled N/A

Surveyed 1880
 Revised 1912
 Edition N/A
 Copyright N/A
 Levelled N/A



Produced by
 Groundsure Insights
 T: 08444 159000
 E: info@groundsure.com
 W: www.groundsure.com

© Crown copyright and database rights 2018 Ordnance Survey 100035207

Production date: 27 November 2023

Map legend available at:
www.groundsure.com/sites/default/files/groundsure_legend.pdf

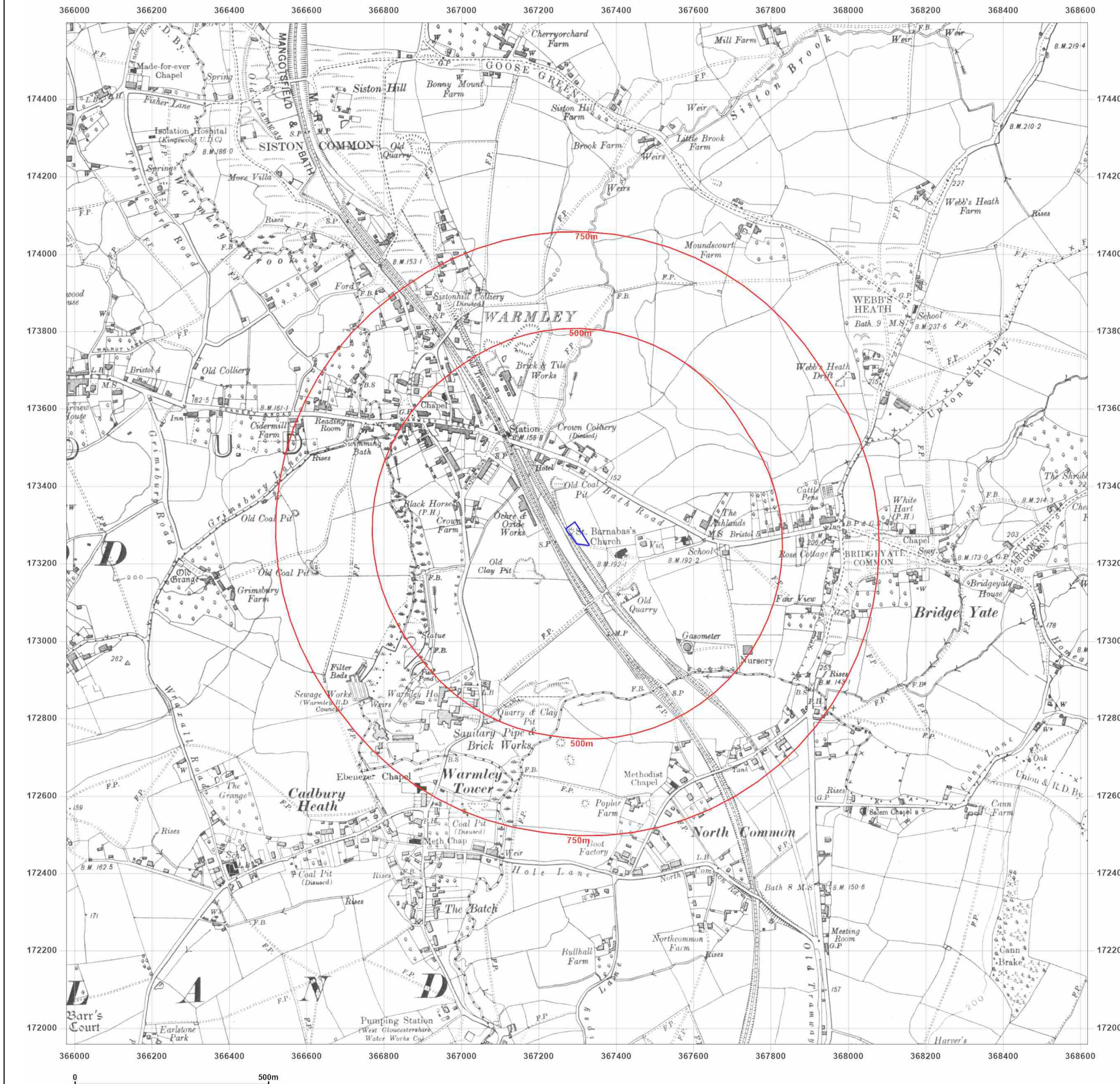

Site Details:

Land behind 22 to 34, GOLDNEY AVENUE, WARMLEY, BS30 5JG

Client Ref: OE-1702-1058-LS-272
Report Ref: GS-LAU-T4D-TR3-2M1
Grid Ref: 367298, 173277

Map Name: County Series

Map date: 1920-1921

Scale: 1:10,560

Printed at: 1:10,560



Surveyed 1882
 Revised 1921
 Edition N/A
 Copyright N/A
 Levelled N/A



Surveyed 1882
 Revised 1920
 Edition N/A
 Copyright N/A
 Levelled N/A



Produced by
 Groundsure Insights
 T: 08444 159000
 E: info@groundsure.com
 W: www.groundsure.com

© Crown copyright and database rights 2018 Ordnance Survey 100035207

Production date: 27 November 2023

Map legend available at:
www.groundsure.com/sites/default/files/groundsure_legend.pdf

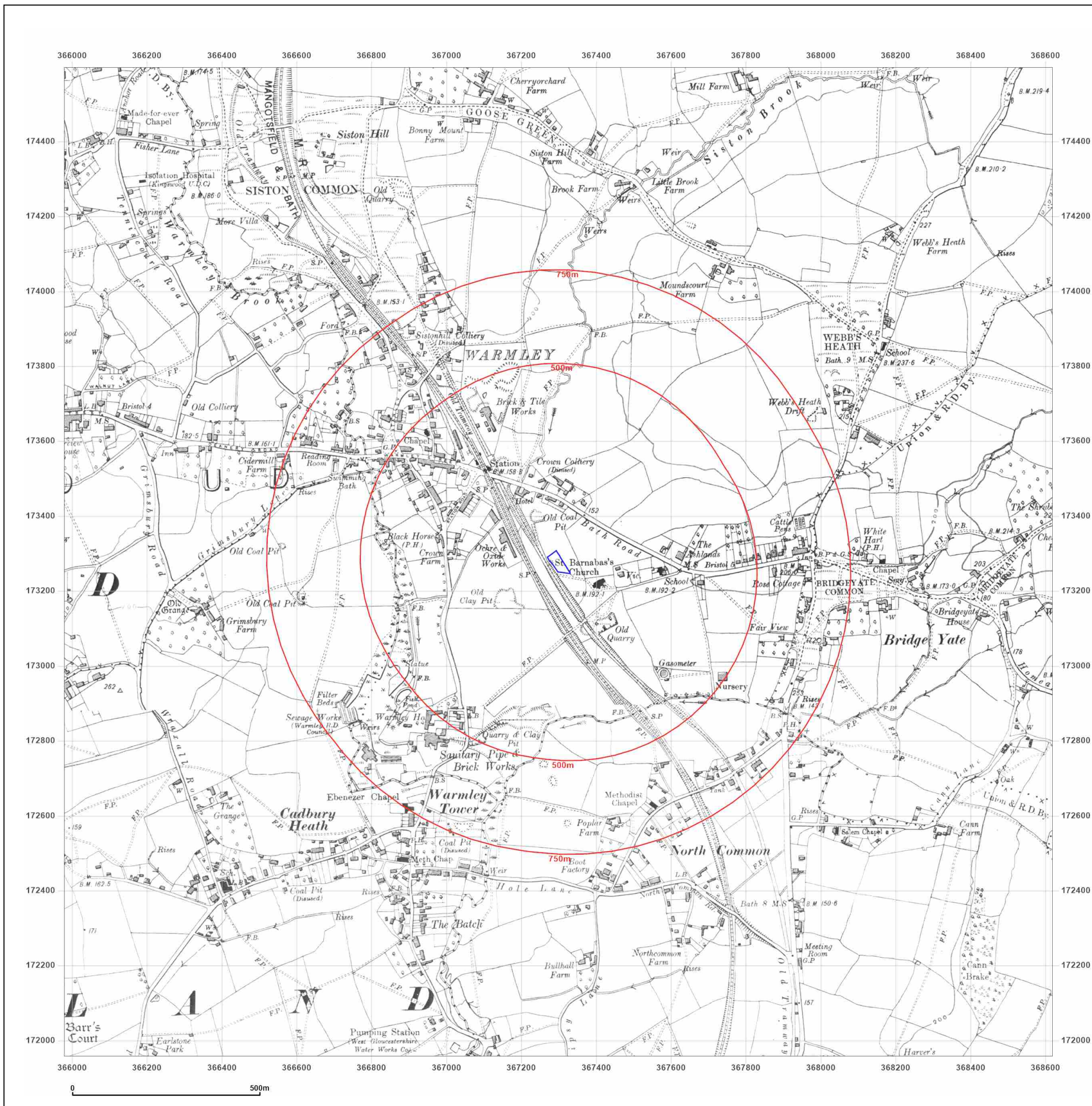

Site Details:

Land behind 22 to 34, GOLDNEY AVENUE, WARMLEY, BS30 5JG

Client Ref: OE-1702-1058-LS-272
Report Ref: GS-LAU-T4D-TR3-2M1
Grid Ref: 367298, 173277

Map Name: County Series

Map date: 1938

Scale: 1:10,560

Printed at: 1:10,560



Surveyed 1880
 Revised 1938
 Edition 1938
 Copyright N/A
 Levelled N/A

Surveyed N/A
 Revised 1938
 Edition N/A
 Copyright N/A
 Levelled N/A



Produced by
 Groundsure Insights
 T: 08444 159000
 E: info@groundsure.com
 W: www.groundsure.com

© Crown copyright and database rights 2018 Ordnance Survey 100035207

Production date: 27 November 2023

Map legend available at:
www.groundsure.com/sites/default/files/groundsure_legend.pdf

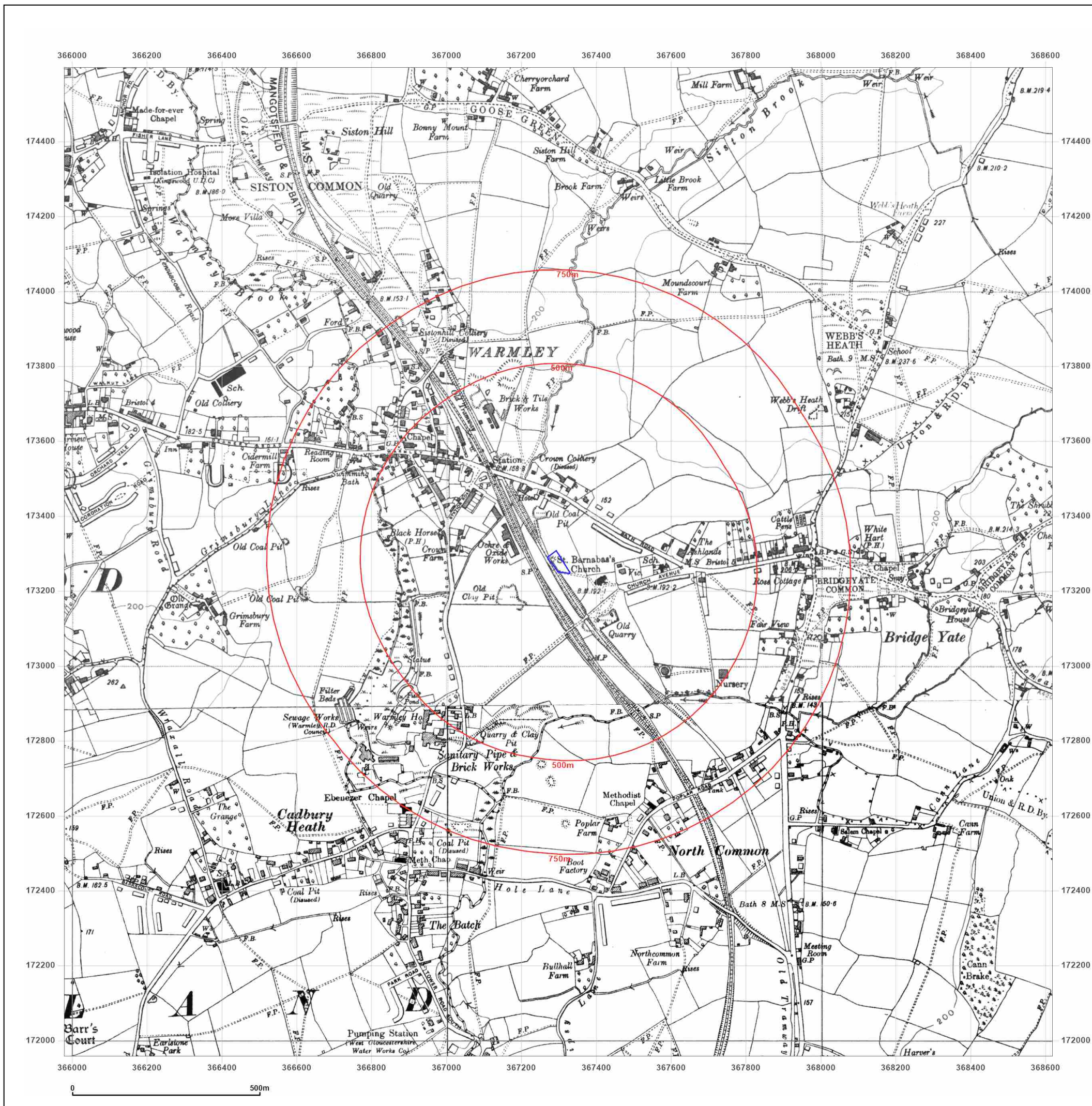

Site Details:

Land behind 22 to 34, GOLDNEY AVENUE, WARMLEY, BS30 5JG

Client Ref: OE-1702-1058-LS-272
Report Ref: GS-LAU-T4D-TR3-2M1
Grid Ref: 367298, 173277

Map Name: County Series

Map date: 1938

Scale: 1:10,560

Printed at: 1:10,560



Surveyed 1880
 Revised 1938
 Edition N/A
 Copyright N/A
 Levelled N/A

Surveyed 1880
 Revised 1938
 Edition N/A
 Copyright N/A
 Levelled N/A



Produced by
 Groundsure Insights
 T: 08444 159000
 E: info@groundsure.com
 W: www.groundsure.com

© Crown copyright and database rights 2018 Ordnance Survey 100035207

Production date: 27 November 2023

Map legend available at:
www.groundsure.com/sites/default/files/groundsure_legend.pdf

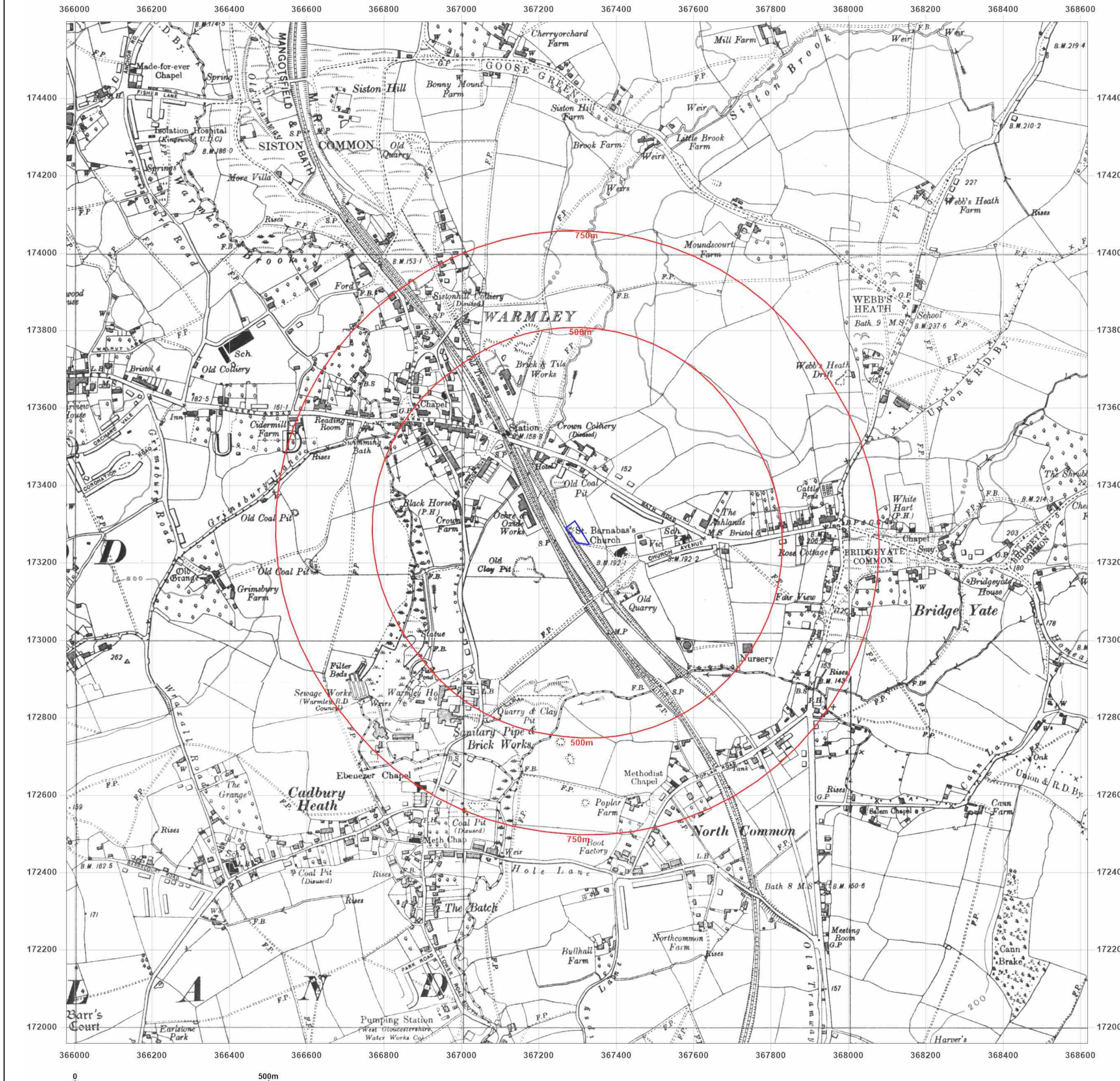

Site Details:

Land behind 22 to 34, GOLDNEY AVENUE, WARMLEY, BS30 5JG

Client Ref: OE-1702-1058-LS-272
Report Ref: GS-LAU-T4D-TR3-2M1
Grid Ref: 367298, 173277

Map Name: County Series

Map date: 1938

Scale: 1:10,560

Printed at: 1:10,560

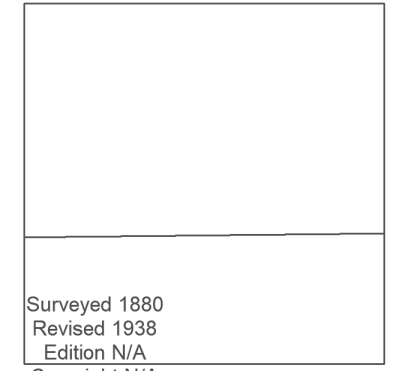
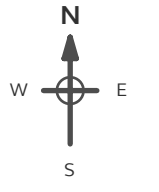

Surveyed 1880
 Revised 1938
 Edition N/A
 Copyright N/A
 Levelled N/A



Produced by
 Groundsure Insights
 T: 08444 159000
 E: info@groundsure.com
 W: www.groundsure.com

© Crown copyright and database rights 2018 Ordnance Survey 100035207

Production date: 27 November 2023

Map legend available at:
www.groundsure.com/sites/default/files/groundsure_legend.pdf

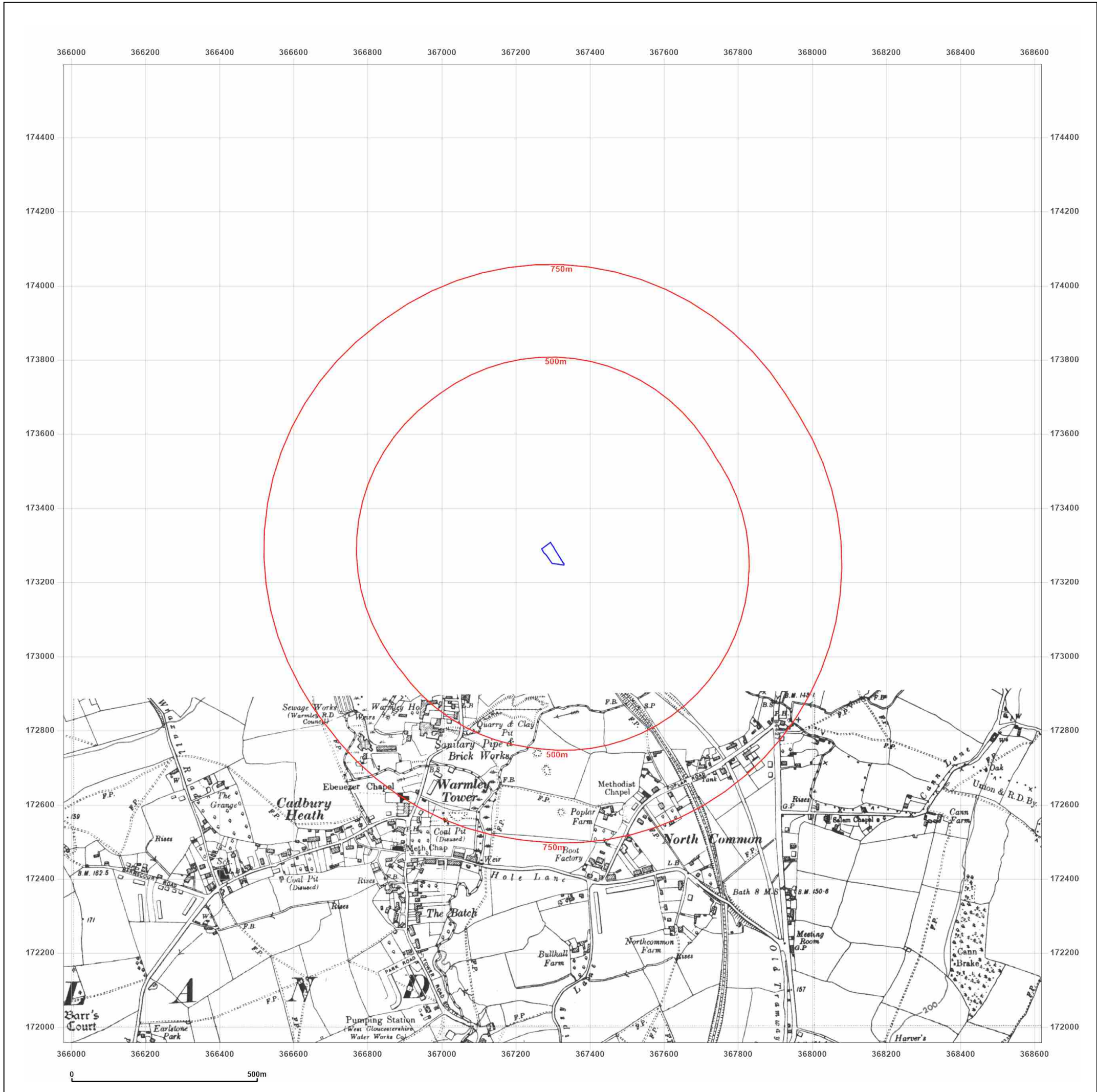

Site Details:

Land behind 22 to 34, GOLDNEY AVENUE, WARMLEY, BS30 5JG

Client Ref: OE-1702-1058-LS-272
Report Ref: GS-LAU-T4D-TR3-2M1
Grid Ref: 367298, 173277

Map Name: Provisional

Map date: 1953

Scale: 1:10,560

Printed at: 1:10,560



Surveyed 1953
 Revised 1953
 Edition N/A
 Copyright N/A
 Levelled N/A



Produced by
 Groundsure Insights
 T: 08444 159000
 E: info@groundsure.com
 W: www.groundsure.com

© Crown copyright and database rights 2018 Ordnance Survey 100035207

Production date: 27 November 2023

Map legend available at:
www.groundsure.com/sites/default/files/groundsure_legend.pdf



Site Details:

Land behind 22 to 34, GOLDNEY AVENUE, WARMLEY, BS30 5JG

Client Ref: OE-1702-1058-LS-272
Report Ref: GS-LAU-T4D-TR3-2M1
Grid Ref: 367298, 173277

Map Name: Provisional

Map date: 1969

Scale: 1:10,560

Printed at: 1:10,560



Surveyed 1969
 Revised 1969
 Edition N/A
 Copyright N/A
 Levelled N/A



Produced by
 Groundsure Insights
 T: 08444 159000
 E: info@groundsure.com
 W: www.groundsure.com

© Crown copyright and database rights 2018 Ordnance Survey 100035207

Production date: 27 November 2023

Map legend available at:
www.groundsure.com/sites/default/files/groundsure_legend.pdf



Site Details:

Land behind 22 to 34, GOLDNEY AVENUE, WARMLEY, BS30 5JG

Client Ref: OE-1702-1058-LS-272
Report Ref: GS-LAU-T4D-TR3-2M1
Grid Ref: 367298, 173277

Map Name: National Grid

Map date: 1983

Scale: 1:10,000

Printed at: 1:10,000



Surveyed 1980
 Revised 1983
 Edition N/A
 Copyright N/A
 Levelled N/A



Produced by
 Groundsure Insights
 T: 08444 159000
 E: info@groundsure.com
 W: www.groundsure.com

© Crown copyright and database rights 2018 Ordnance Survey 100035207

Production date: 27 November 2023

Map legend available at:
www.groundsure.com/sites/default/files/groundsure_legend.pdf

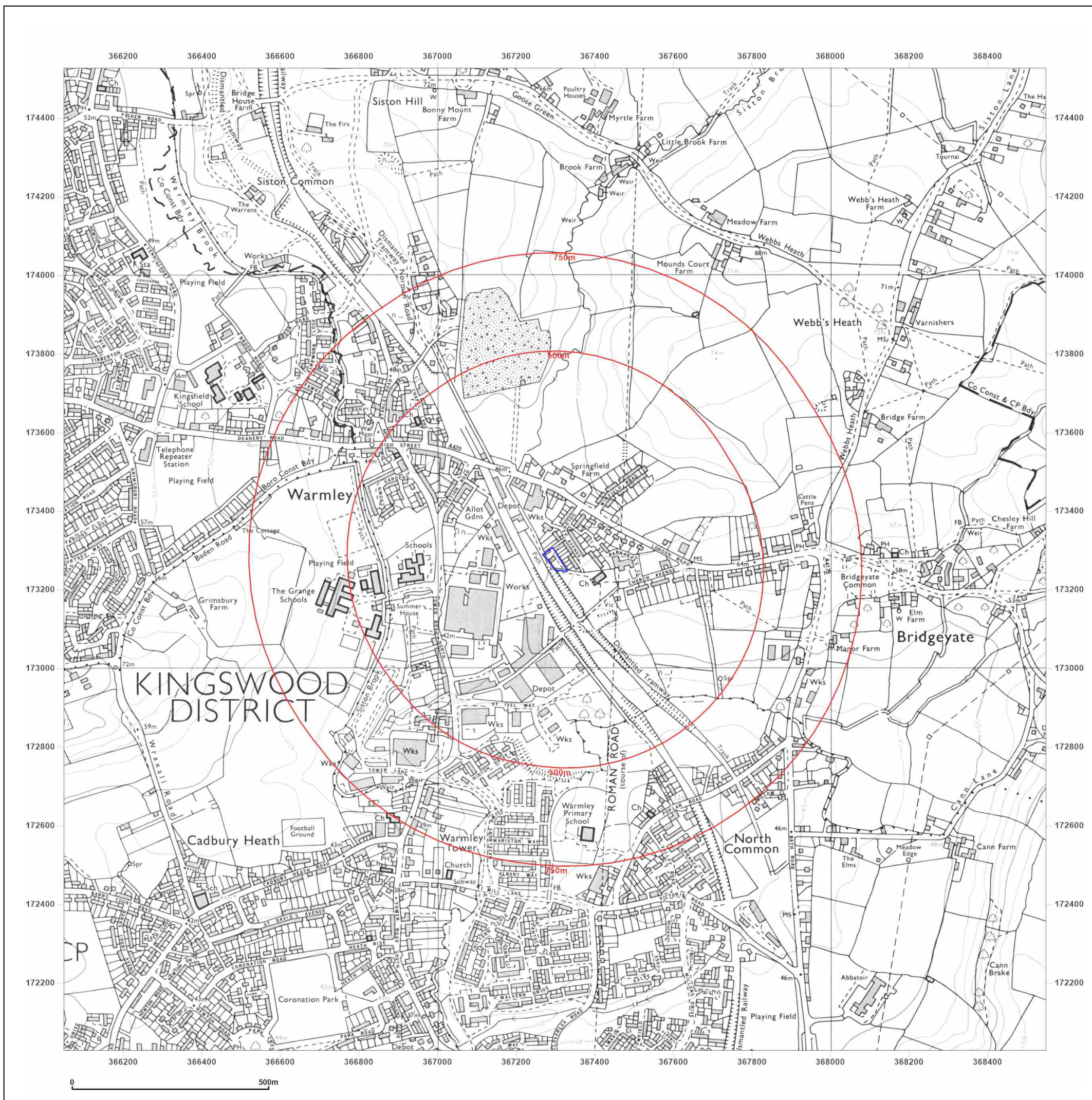

Site Details:

Land behind 22 to 34, GOLDNEY AVENUE, WARMLEY, BS30 5JG

Client Ref: OE-1702-1058-LS-272
Report Ref: GS-LAU-T4D-TR3-2M1
Grid Ref: 367298, 173277

Map Name: National Grid

Map date: 1991

Scale: 1:10,000

Printed at: 1:10,000



Surveyed 1991
 Revised 1991
 Edition N/A
 Copyright N/A
 Levelled N/A



Produced by
 Groundsure Insights
 T: 08444 159000
 E: info@groundsure.com
 W: www.groundsure.com

© Crown copyright and database rights 2018 Ordnance Survey 100035207

Production date: 27 November 2023

Map legend available at:
www.groundsure.com/sites/default/files/groundsure_legend.pdf



Site Details:

Land behind 22 to 34, GOLDNEY AVENUE, WARMLEY, BS30 5JG

Client Ref: OE-1702-1058-LS-272
Report Ref: GS-LAU-T4D-TR3-2M1
Grid Ref: 367298, 173277

Map Name: National Grid

Map date: 2001

Scale: 1:10,000

Printed at: 1:10,000

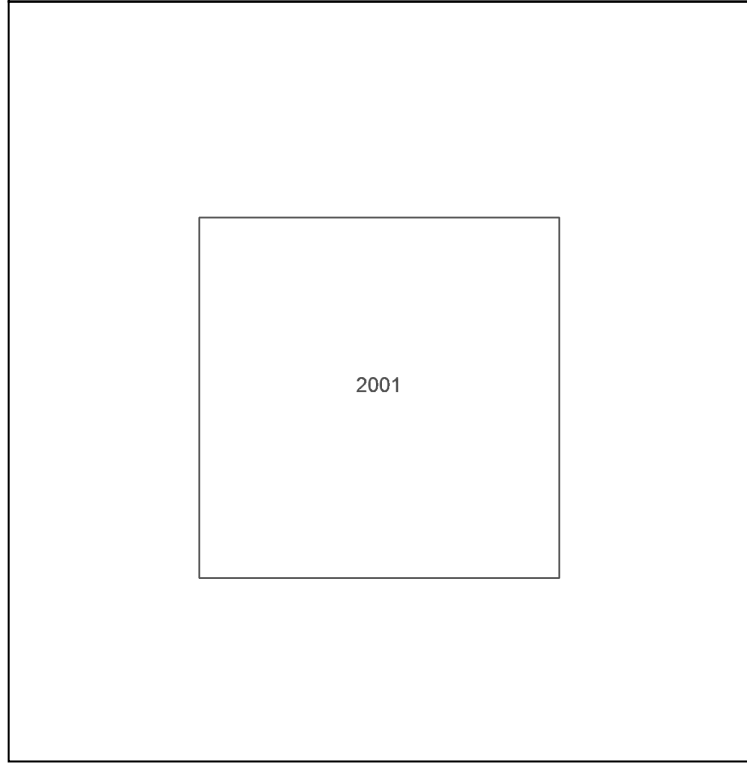

Produced by
 Groundsure Insights
 T: 08444 159000
 E: info@groundsure.com
 W: www.groundsure.com

© Crown copyright and database rights 2018 Ordnance Survey 100035207

Production date: 27 November 2023

Map legend available at:
www.groundsure.com/sites/default/files/groundsure_legend.pdf

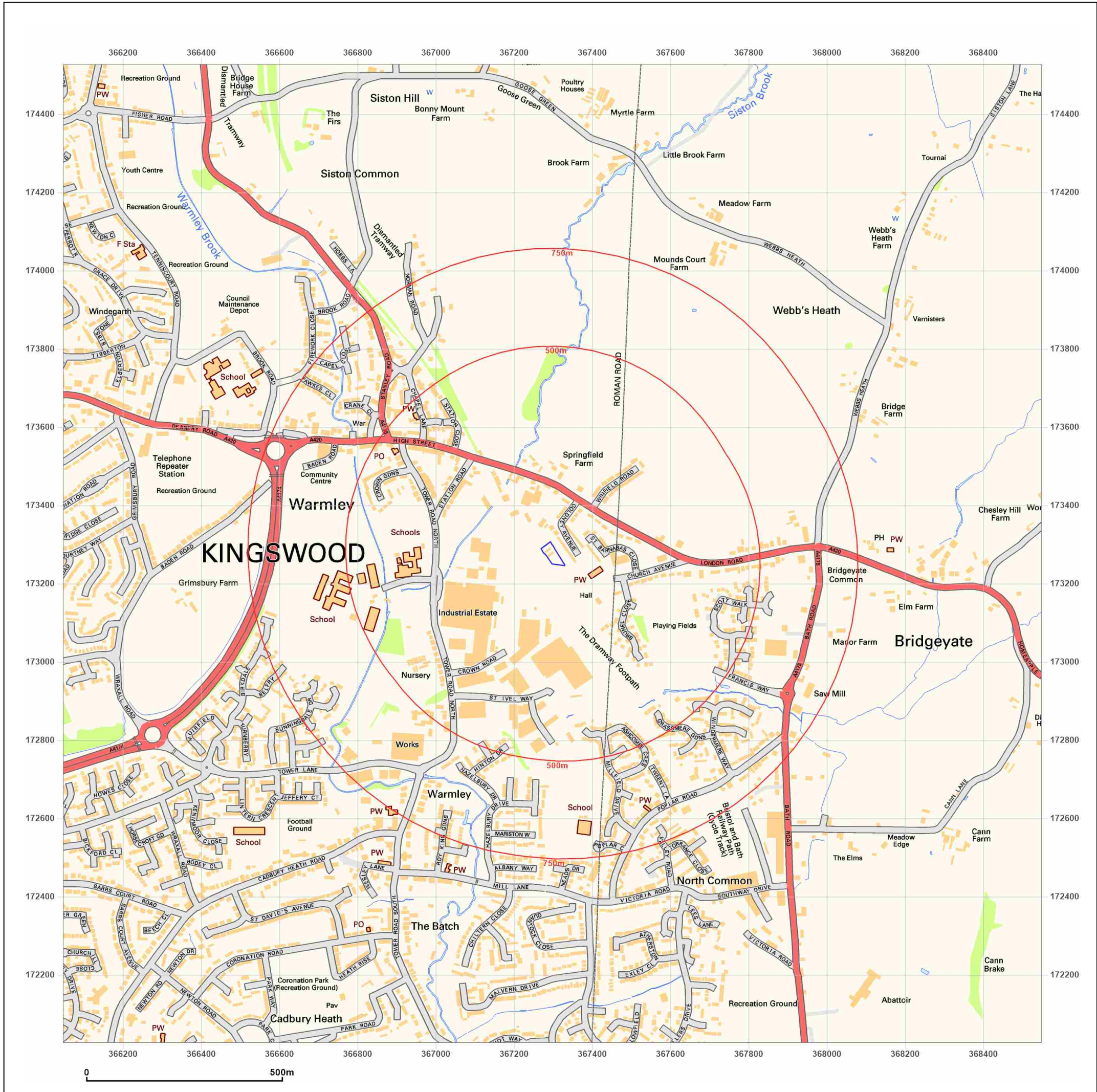

Site Details:

Land behind 22 to 34, GOLDNEY AVENUE, WARMLEY, BS30 5JG

Client Ref: OE-1702-1058-LS-272
Report Ref: GS-LAU-T4D-TR3-2M1
Grid Ref: 367298, 173277

Map Name: National Grid

Map date: 2010

Scale: 1:10,000

Printed at: 1:10,000

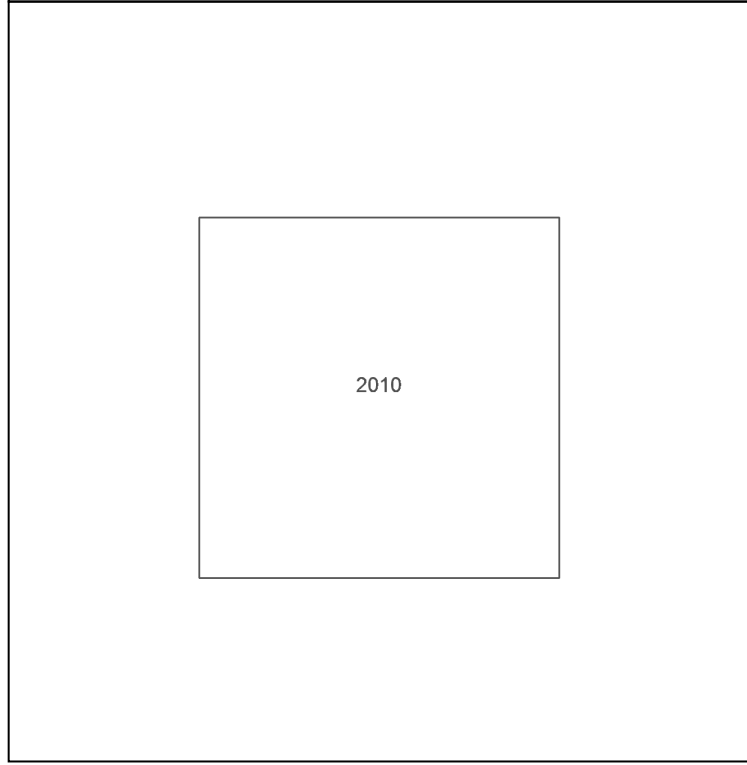
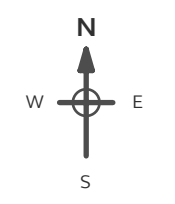

Produced by
 Groundsure Insights
 T: 08444 159000
 E: info@groundsure.com
 W: www.groundsure.com

© Crown copyright and database rights 2018 Ordnance Survey 100035207

Production date: 27 November 2023

Map legend available at:
www.groundsure.com/sites/default/files/groundsure_legend.pdf

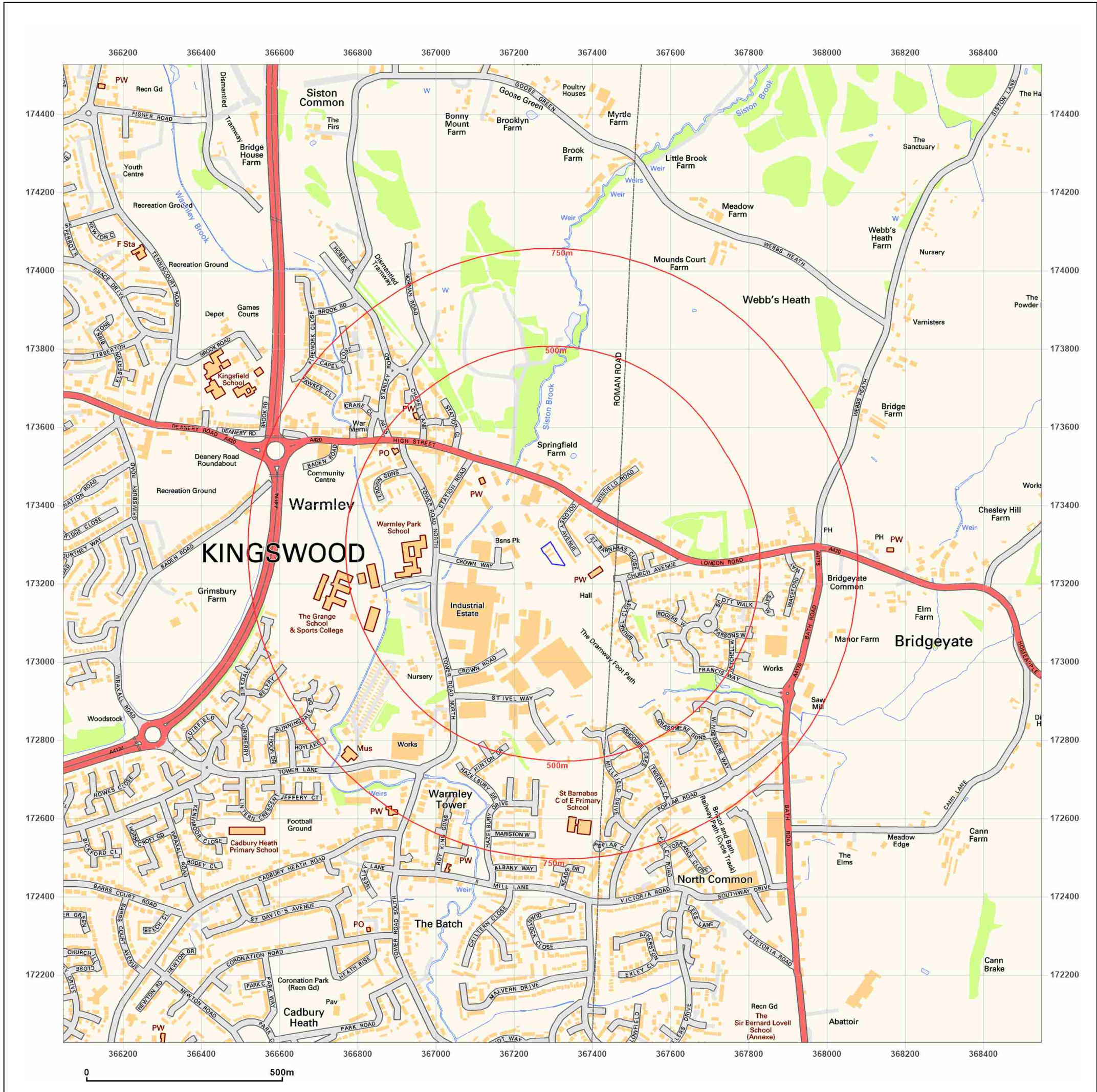

Site Details:

Land behind 22 to 34, GOLDNEY AVENUE, WARMLEY, BS30 5JG

Client Ref: OE-1702-1058-LS-272
Report Ref: GS-LAU-T4D-TR3-2M1
Grid Ref: 367298, 173277

Map Name: National Grid
Map date: 2023
Scale: 1:10,000
Printed at: 1:10,000

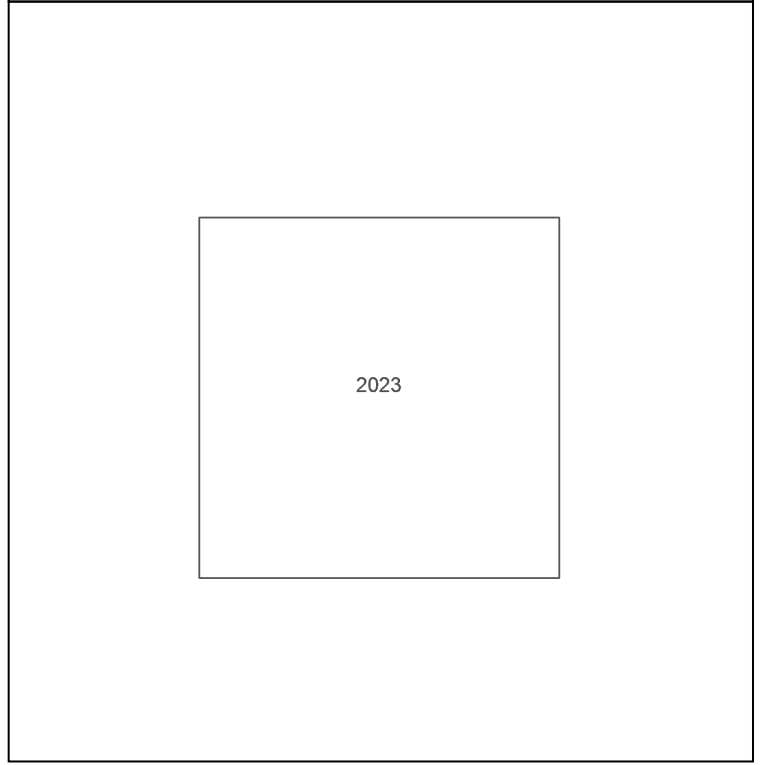
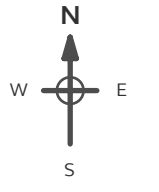

Powered by



Produced by
 Groundsure Insights
 T: 08444 159000
 E: info@groundsure.com
 W: www.groundsure.com

© Crown copyright and database rights 2018 Ordnance Survey 100035207

Production date: 27 November 2023

Map legend available at:
www.groundsure.com/sites/default/files/groundsure_legend.pdf

