

North Street

28

26

24

Old Schoolhouse

Proposed glazing

Proposed paving

Proposed retaining wall

Proposed first floor extension

Mountfield

Proposed home office

Willow hurdles & pleached hedge

Garages

Netherfield

20

18

Scale: 1/200



Old Schoolhouse

24 North Street Kingsclere

Client:
Mr & Mrs Harris

Site:
Old Schoolhouse 24 North
Street Kingsclere RG20 5QX

Project: Alterations, erection of
first floor rear extension &
erection of detached home office

Title:
Site Plan

Scale:
1/200

Dwg No:
SH/24/01

Drawn by:
FJD

Date:
Jan 2024

Revision:

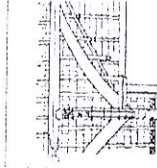

F J Dowling
NKS Ltd Co Ltd
Conservation & Design Consultant
The Unicorn
57 Eastgate Street
Bury St Edmunds
Suffolk IP33 1YR
Tel: 01284 615786
Mobile: 07887 714854
dowlingfrank@bt.com