

Notes:

Existing GIA: 438.25m²
External Stores: 15.96m²

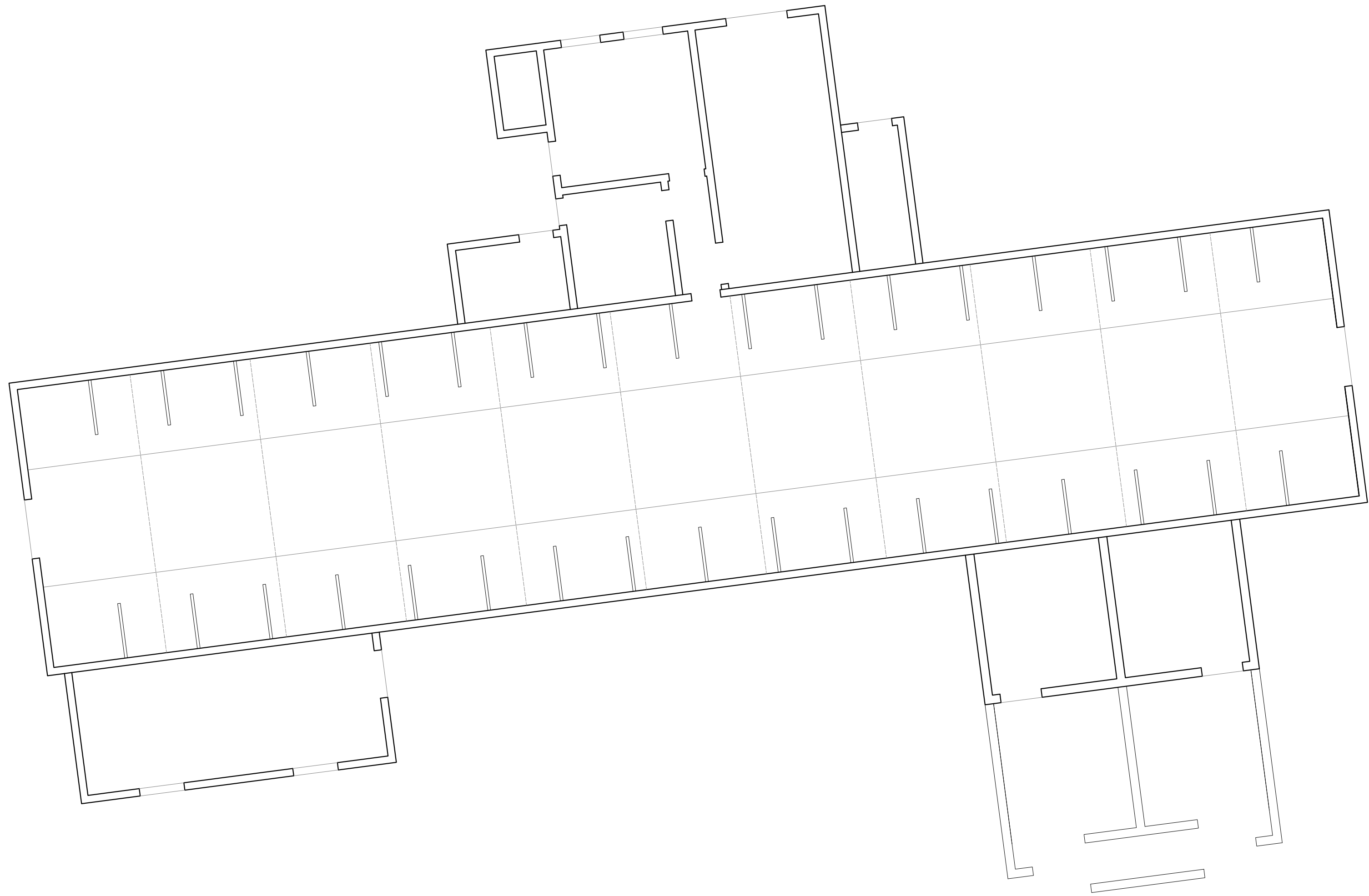

Issued for Planning

Revision:	Rev By:	Checked By:
A. 04.12.2023	RB	DD



01303 814 444
www.bloomfieldsltd.co.uk
drawing@bloomfieldsltd.co.uk

Client:
Mr D Groombridge

Project:
Conversion

Site Address:
Westcourt Lane
Shepherdswell
CT15 7PZ

Scale: 1:100 @ A2
Drawn By: RB

Date: 04.12.2023
Checked By: DD

Drawing Title:
Existing Floor Plans

St: | **Job No:** | **Drawing No:** | **Rev:**

P.3052.040.A

