

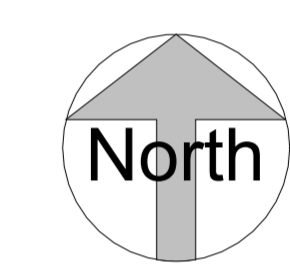

Email: citybuildingjoinery@gmail.com
Phone: 0796099959

- Site bounded as shown on drawings
- Public rights of way - none over the property boundry
- Existing trees as show on plans away from the proposed development
- Block paving amended to suit new layout, materials to match existing
- No boundry treatment proposed.



Existing Site Plan
1 : 200

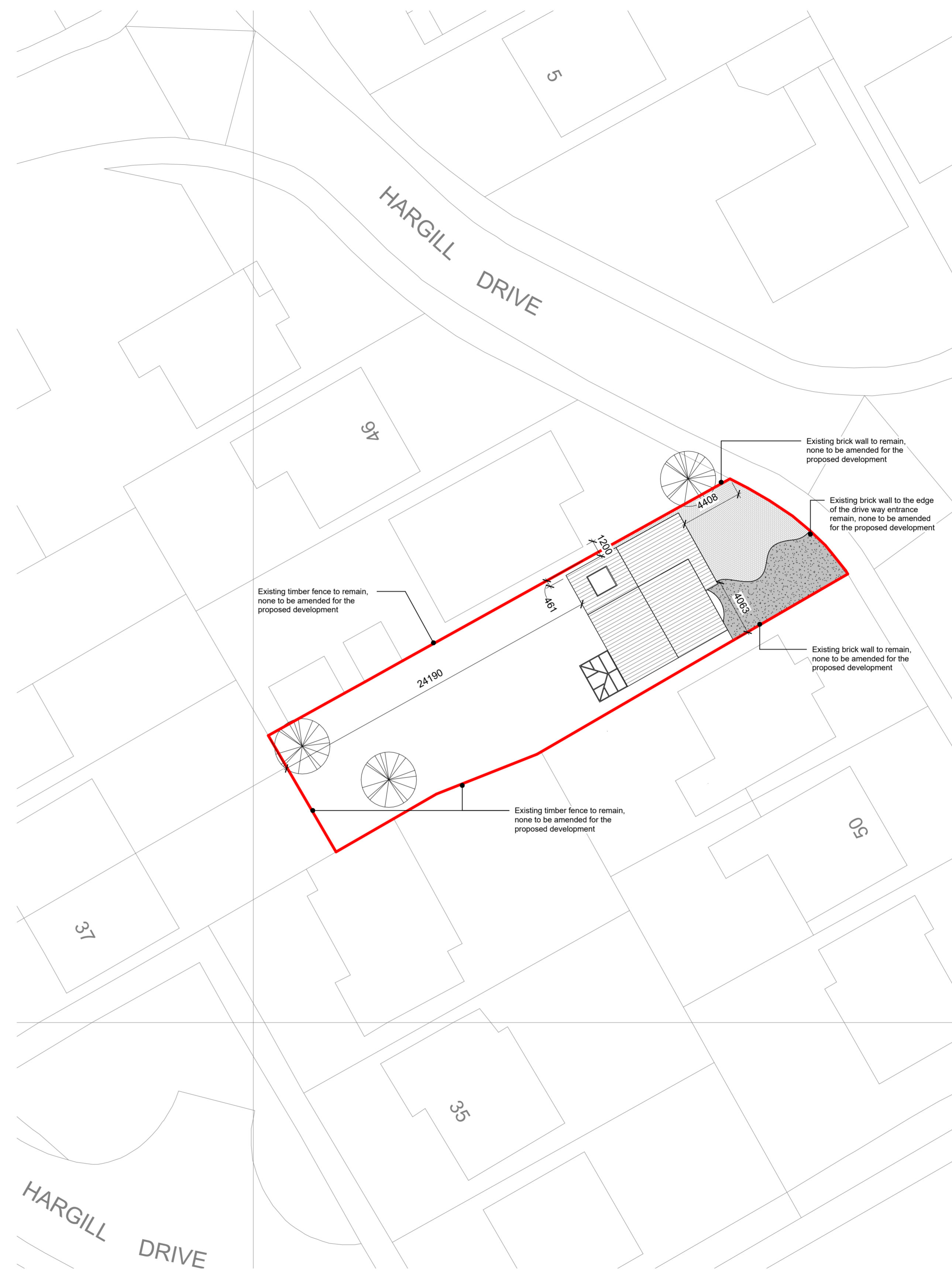

Proposed Site Plan
1 : 200

CLIENT
Mr & Mrs Johnson

PROJECT
**Proposed Two Storey Side Extension and Single Storey Front Extension
Washington**

DRAWING TITLE
Existing and Proposed Site Plan

SCALE @	DATE	DRAWN	CHECKED
1:200	08/03/2024	BRC	BC

DRAWING NUMBER	REVISION	SUITABILITY
P3500-0400	P01	S03