

This copy has been made by or with the authority of Midlothian Council pursuant to Section 47 of the Designs and Patents Act 1988. Unless that Act provides a relevant exception to copyright, the copy must not be copied without the prior permission of the copyright owner.



The copyright of the design remains with Low Carbon Studio Ltd. and may not be reproduced without their prior written consent. All dimensions are to be checked on site and the Architect notified of any discrepancies. Do not scale from this drawing for Constructional purposes.

NOTES:

Line indicates application boundary

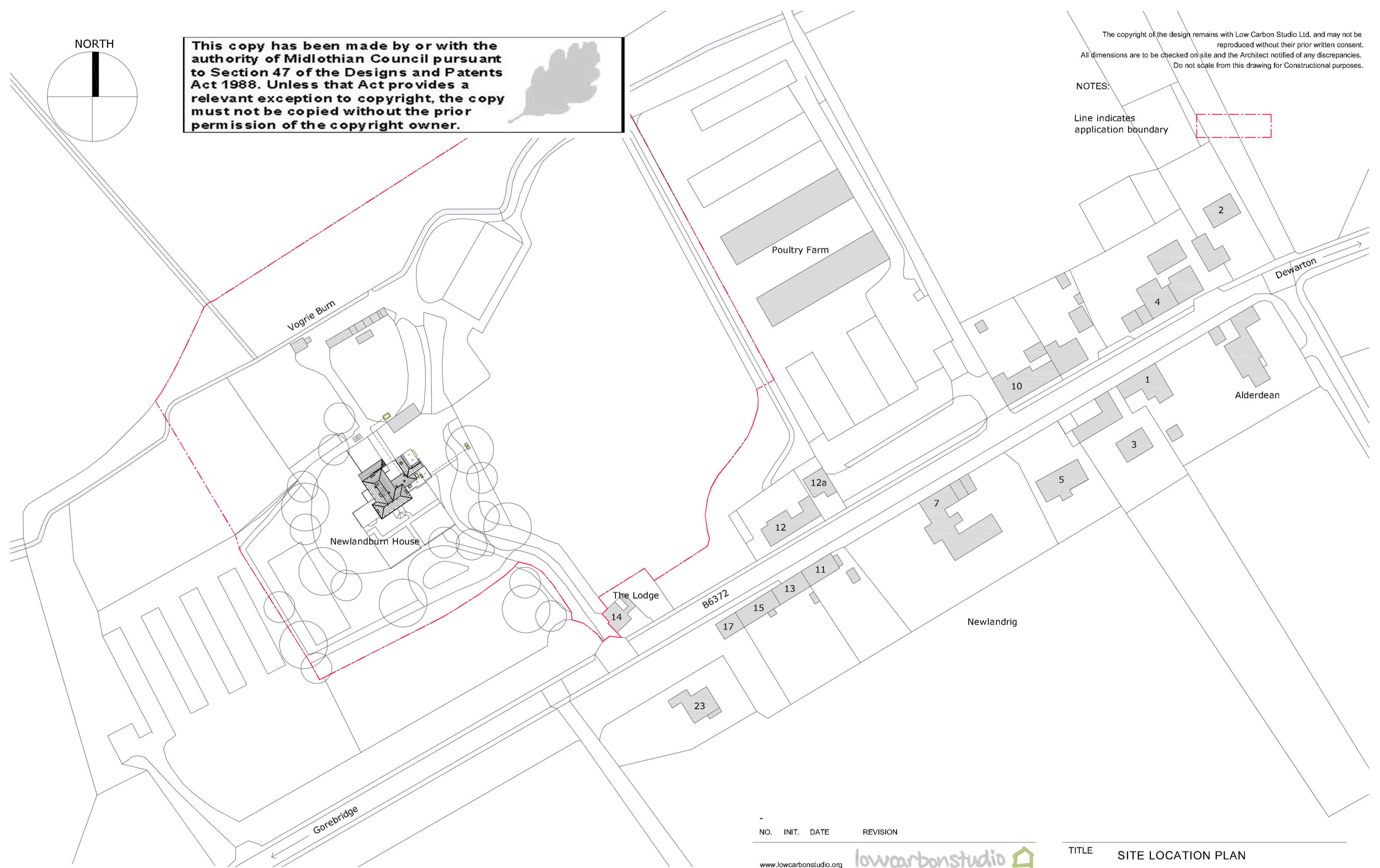

LOCATION PLAN
SCALE 1:1250@A3



NO.	INIT.	DATE	REVISION

www.lowcarbonstudio.org 

CLIENT FRANCIS KATAMBA & WANDA ADAM

PROJECT NEWLANDBURN HOUSE
ALTERATIONS TO EXSITING HOUSE

Denerigg / West Saltoun / East Lothian / EH34 5EJ / T 01875 341419

TITLE SITE LOCATION PLAN

DRAWN	CHECK	JOB No. /	Drwg No. /	Rev
CC		2311 / 000		
SCALE	DATE			
1:1250@A3	FEB 24			

mail@lowcarbonstudio.org