



The copyright of the design remains with Low Carbon Studio Ltd. and may not be reproduced without their prior written consent.
 All dimensions are to be checked on site and the Architect notified of any discrepancies.
 Do not scale from this drawing for Constructional purposes.

NOTES:

- Line indicates application boundary 
- Hatching indicates partitions doors and fittings to be removed 
- Extent of alterations 

This copy has been made by or with the authority of Midlothian Council pursuant to Section 47 of the Designs and Patents Act 1988. Unless that Act provides a relevant exception to copyright, the copy must not be copied without the prior permission of the copyright owner.

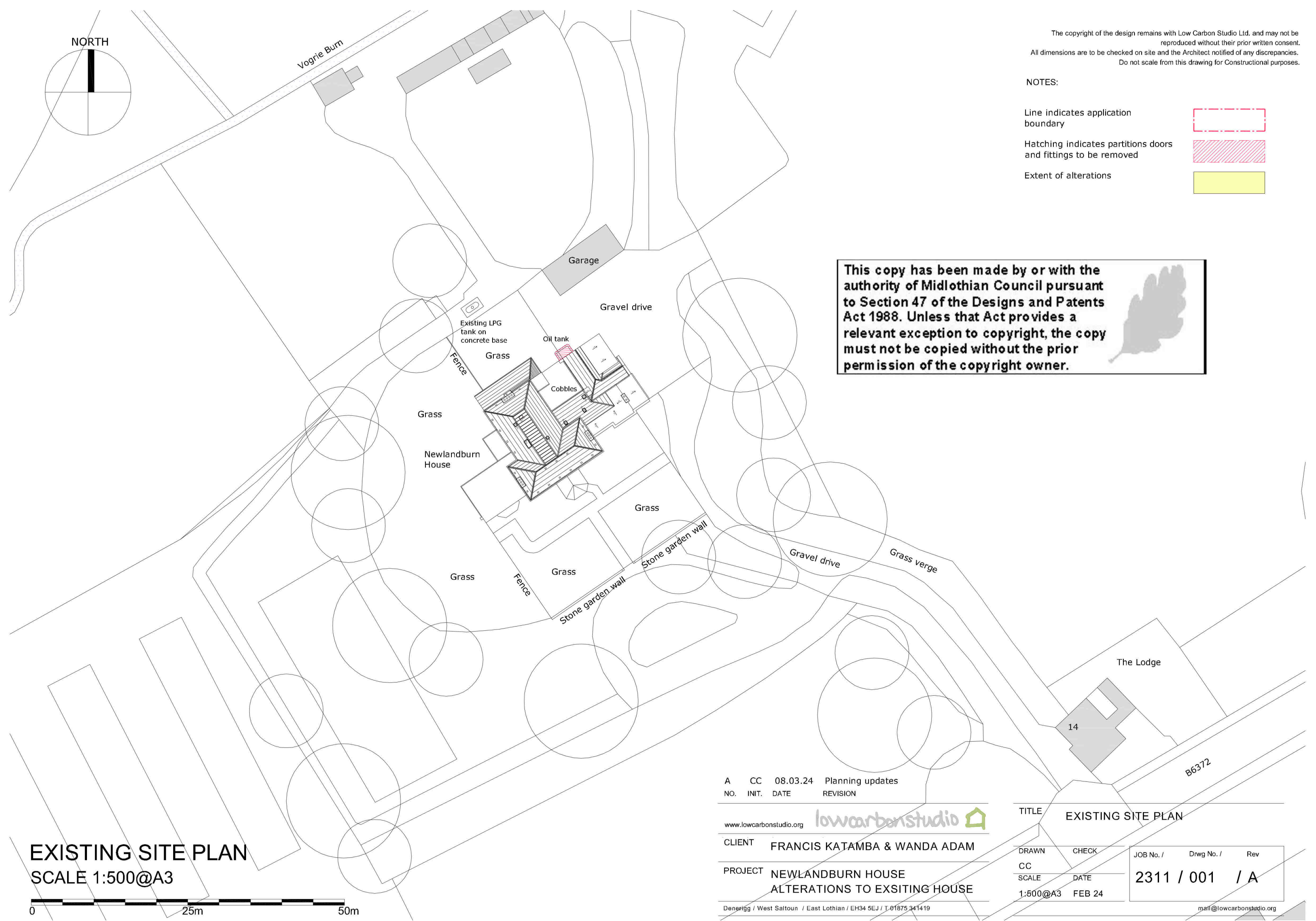
NORTH

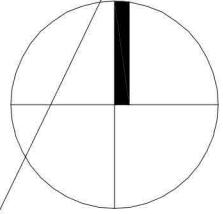

EXISTING SITE PLAN
 SCALE 1:500@A3



A	CC	08.03.24	Planning updates
NO.	INIT.	DATE	REVISION

www.lowcarbonstudio.org 

CLIENT FRANCIS KATAMBA & WANDA ADAM

PROJECT NEWLANDBURN HOUSE
 ALTERATIONS TO EXSITING HOUSE

Denerigg / West Saltoun / East Lothian / EH34 5EJ / T.01875 341419

TITLE EXISTING SITE PLAN

DRAWN	CHECK	JOB No. /	Drwg No. /	Rev
CC		2311 / 001	/ 001	/ A
SCALE	DATE			
1:500@A3	FEB 24			

mail@lowcarbonstudio.org