

PROPOSED GROUND FLOOR PLAN

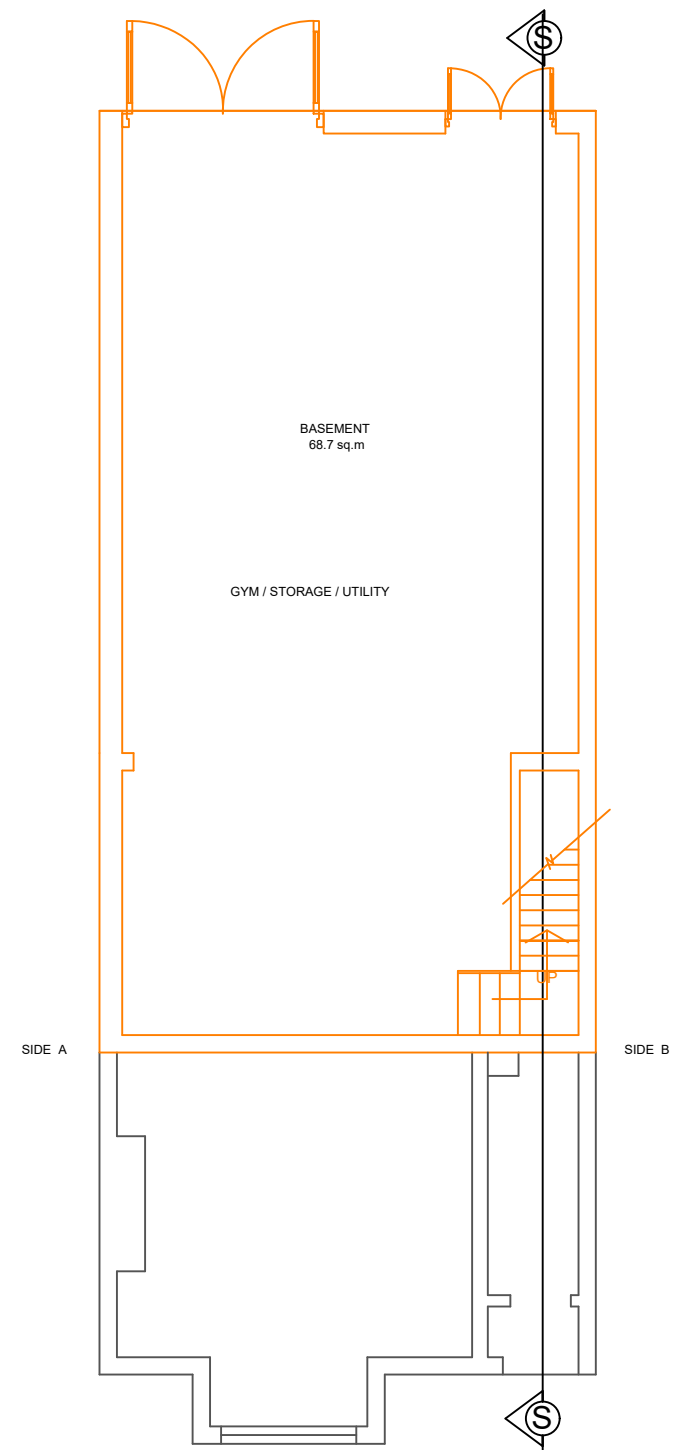

PROPOPOSED BASEMENT

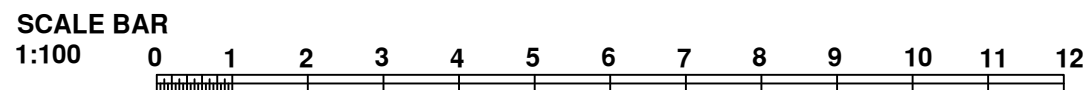

MEK TOWN PLANNING AND DESIGN CONSULTANTS LTD www.mektownplanningconsultants.co.uk mosesekole@gmail.com Tel. +44 - 7506-208449 14 CLIVE HOUSE, HADDO STREET, LONDON. SE10 9RH.	DRAWING TITLE PROPOSED FLOOR PLANS.		PROJECT TITLE EXTENSION TO EXISTING BASEMENT WITH SIDE INFILL.		
	SCALE 1:100	DATE FEB. 2024	DRWNG 10	NO. 10	SITE ADDRESS 57A PEMBROKE ROAD, ERITH, DA8 1BY.
	PAPER SIZE A - 3		REVISION		